

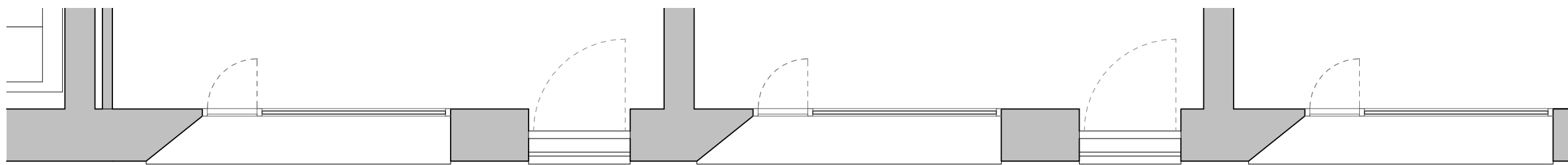

1 Building F: East Elevation

1 : 50



3 Building F: First Floor Plan

1 : 50

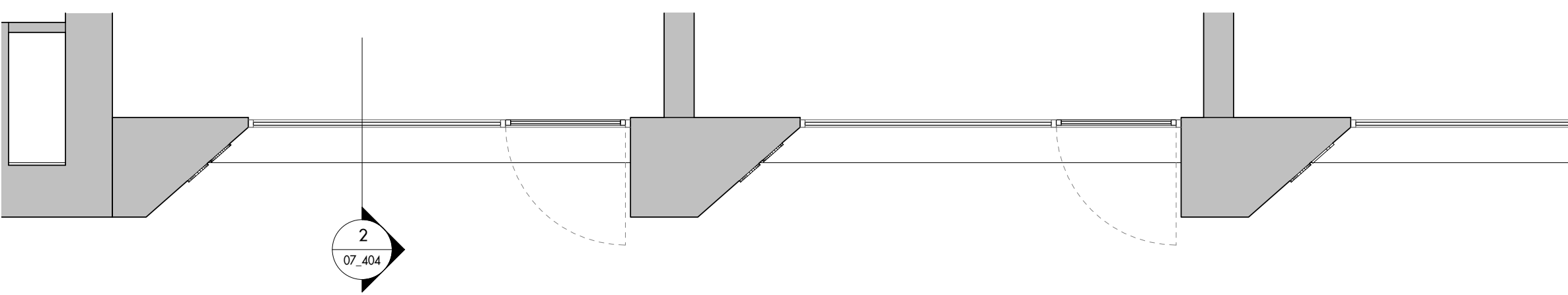

4 Building F: Ground Floor Plan

1 : 50

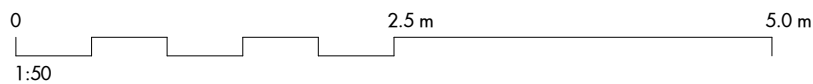

2 Building F: Section AA

1 : 50

Bay Study Key

1. Dark Grey Metal Balustrade
2. Not Used
3. Metal Window Frame
4. Light Grey Metal Balcony
5. Lightly coloured Brickwork (London Stock Brick)
6. Precast Concrete Lintel
7. Not Used
8. Metal Ribbed Panel
9. Not Used
10. Metal Window Frame with Openable Panel
11. Grilles
12. Glazing
13. Not Used
14. Dark Grey Metal Fascia to MVHR

REV	DATE	DESCRIPTION	CHKD
P1	30/06/17	ISSUED FOR PLANNING	MCd
P2	03/10/17	ISSUED FOR PLANNING AMENDMENTS	MCd
P3	07/20	ISSUED FOR PLANNING	HH
P4	28/02/25	ISSUED FOR PLANNING	HH

Figured dimensions are in millimetres unless noted otherwise. All dimensions and levels shall be verified on site before proceeding with works. Detailed site survey to be carried out to verify positions and level relationships with site features and ordinance survey. The Architect must be notified of any discrepancy. Boundaries are indicative only and are to be verified by others.

Allies & Morrison LLP is not responsible for any errors caused by the transmission, translation, software or computer systems. Allies & Morrison LLP is not responsible for nor shall be liable for the consequences of any use made of the drawings or models other than that for which they were produced by Allies & Morrison LLP for the Client.

All Intellectual Property Rights reserved

Allies and Morrison LLP
85 Southwark Street
London SE1 0HX
telephone 020 7921 0100
facsimile 020 7921 0101
email studio@alliesandmorrison.com

Camden Goods Yard : Building F
BAY STUDY 5/ EAST ELEVATION
BLOCK F BAY STUDIES
1095_07_07_404

A&M JOB No: 1095_08

SCALE 1 : 50 @A1 1 : 100 @A3

P4

Revision