

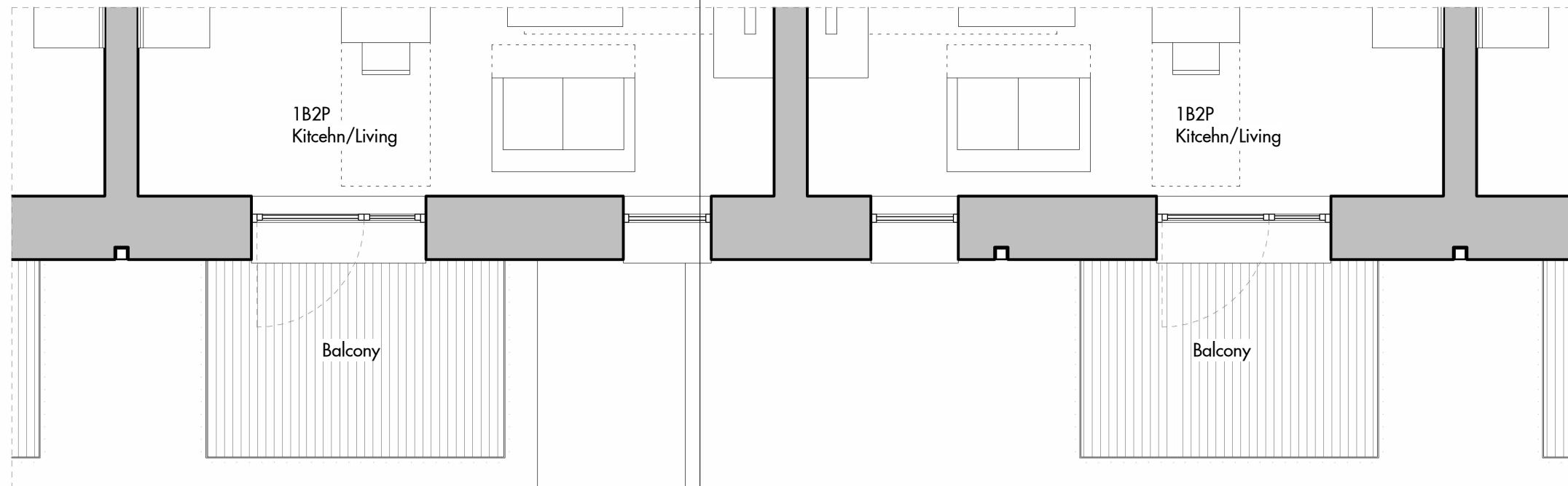

01 Block E2 - Main Building South Elevation - Bay Study
1 : 50



03 Block E2 - Main Building South Elevation - Level 02
1 : 50



04 Block E2 - Main Building South Elevation - Level 00
1 : 50

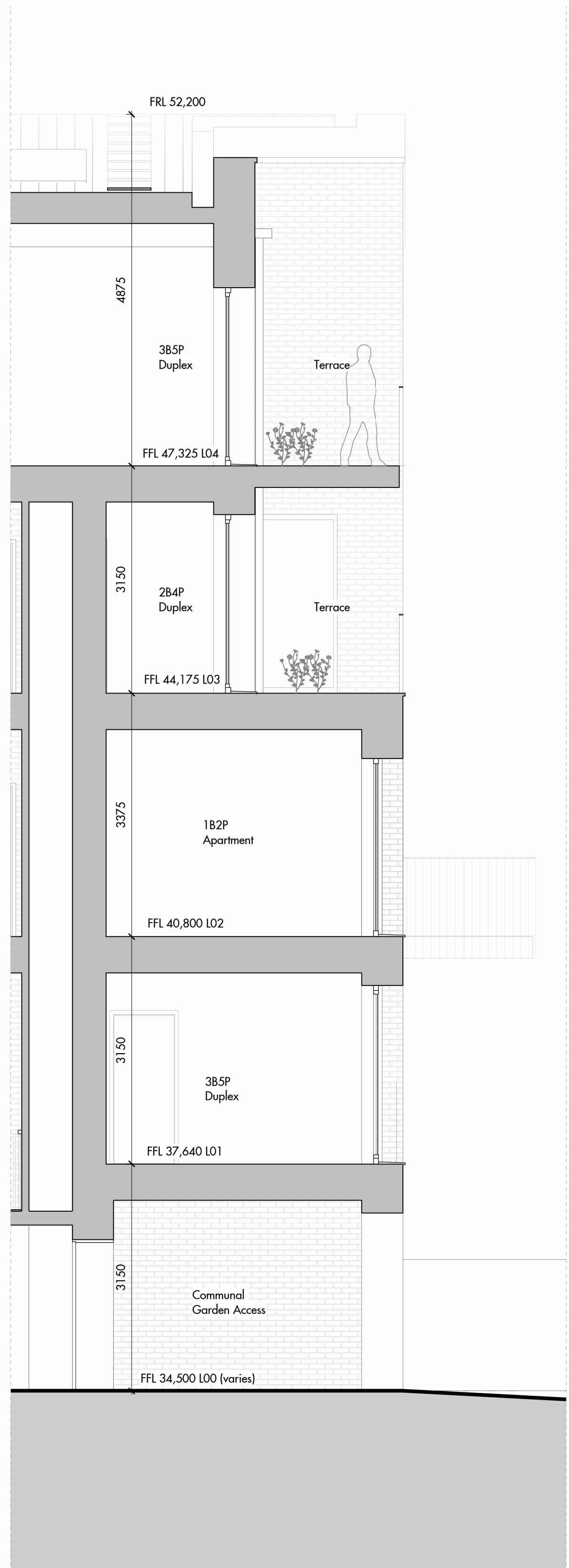

02 Block E2 - Main Building South Elevation - Section AA
1 : 50

- Bay Study Key
1. Pale grey metal coping
 2. Pale grey metal hopper
 3. Pale grey metal panel
 4. Light buff brick
 5. Grey metal balustrade
 6. Openeable double glazing
 7. Painted vertical timber cladding
 8. Light buff brick planter/cycle store

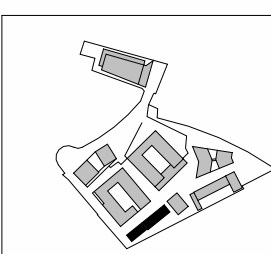
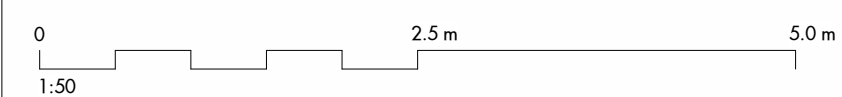

Figured dimensions are in millimetres unless noted otherwise. All dimensions and levels shall be verified on site before proceeding with works. Detailed site survey to be carried out to verify positions and level relationships with the features and ordinance survey. The Architect must be notified of any discrepancy. Boundaries are indicative only and are to be verified by others.

Allies and Morrison LLP is not responsible for any errors caused by the transmission, translation, software or computer systems. Allies and Morrison LLP is not responsible for nor shall be liable for the consequences of any use made of the drawings or models other than that for which they were produced by Allies and Morrison LLP for the Client.

All Intellectual Property Rights reserved

REV	DATE	DESCRIPTION	CKD
P1	30/06/17	ISSUED FOR PLANNING	MCd
P2	03/10/17	ISSUED FOR PLANNING AMENDMENTS	MCd
P3	28/02/25	ISSUED FOR PLANNING	FW

Allies and Morrison LLP
85 Southwark Street
London SE1 0HX
telephone 020 7921 0100
facsimile 020 7921 0101
email studio@alliesandmorrison.com

A&M JOB No: 1095

Camden Goods Yard : Building E2
SOUTH ELEVATION BAY STUDY
BLOCK E2 BAY STUDIES
1095_06_07_402

SCALE 1 : 50 @A1 1 : 100 @A3