

- GENERAL NOTES**
- This drawing is not to be scaled.
 - All dimensions & levels to be checked on site.
 - Figured dimensions to be taken on site in preference to isometric dimensions.
 - This Drawing is the copyright of the owners.
- KEY**
- SITE BOUNDARY
 - EXISTING FABRIC
 - PROPOSED NEW WALLS AND SLABS
 - STRUCTURES TO BE DEMOLISHED

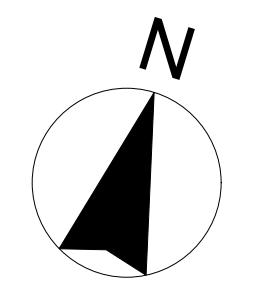

ALBANY STREET

1 CHESTER PLACE

CHESTER PLACE

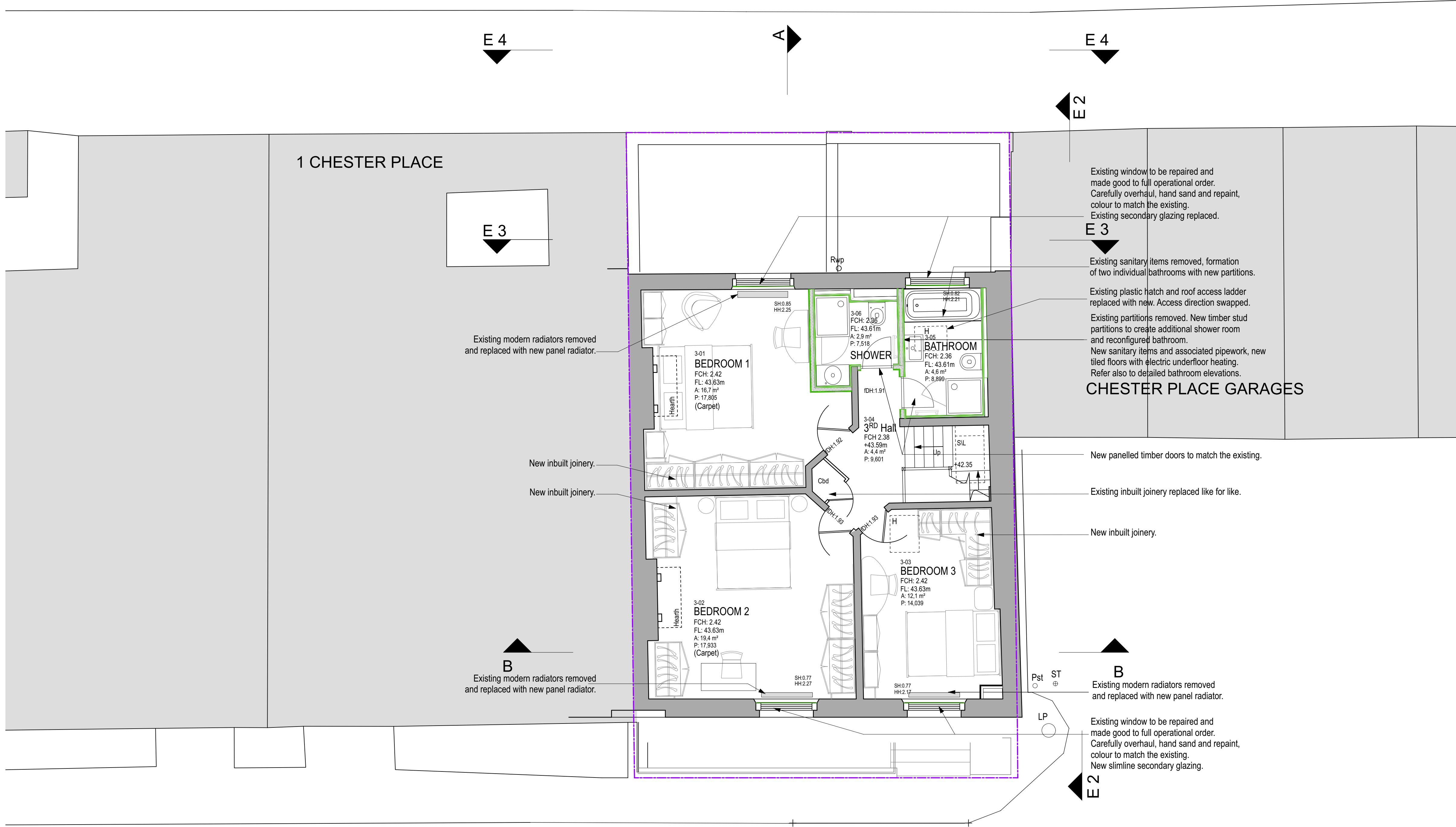

Existing window to be repaired and made good to full operational order. Carefully overhaul, hand sand and repaint, colour to match the existing. Existing secondary glazing replaced.

Existing sanitary items removed, formation of two individual bathrooms with new partitions.

Existing plastic hatch and roof access ladder replaced with new. Access direction swapped.

Existing partitions removed. New timber stud partitions to create additional shower room and reconfigured bathroom.

New sanitary items and associated pipework, new tiled floors with electric underfloor heating. Refer also to detailed bathroom elevations.

New panelled timber doors to match the existing.

Existing inbuilt joinery replaced like for like.

New inbuilt joinery.

Existing modern radiators removed and replaced with new panel radiator.

Existing window to be repaired and made good to full operational order. Carefully overhaul, hand sand and repaint, colour to match the existing. New slimline secondary glazing.

CHESTER PLACE GARAGES

1 2nd FLOOR as proposed
1:50

43

PLANNING APPLICATION AND LBC - AS PROPOSED 2025-02-11

structureHaus
consulting . engineering . designing

LONDON OFFICE 020 8940 7810
EXETER OFFICE 01392 363497
info@structurehaus.com
www.structurehaus.com

PROJECT
REFURBISHMENT OF GRADE 1 LISTED TERRACE
1 CHESTER PLACE
LONDON, NW1 4NB

CLIENT
Mr. + Mrs. Davies

DRAWING
3rd Floor - as proposed

SCALE
1: 50

2025L-1 Chester Place - as existing.rvt

REVISION		DATE	DETAILS	DRAWN	CHECKED
REV	DATE	DETAILS	DRAWN	CHECKED	DP
DRAWING NUMBER		REVISION			
02962L		3-05			
Drawn by	BM	Checked by	DP		
Date		Date			

ISO A1 ©Copyright