

01 EXISTING RAILING & PARAPET DETAIL
1:10 @ A1

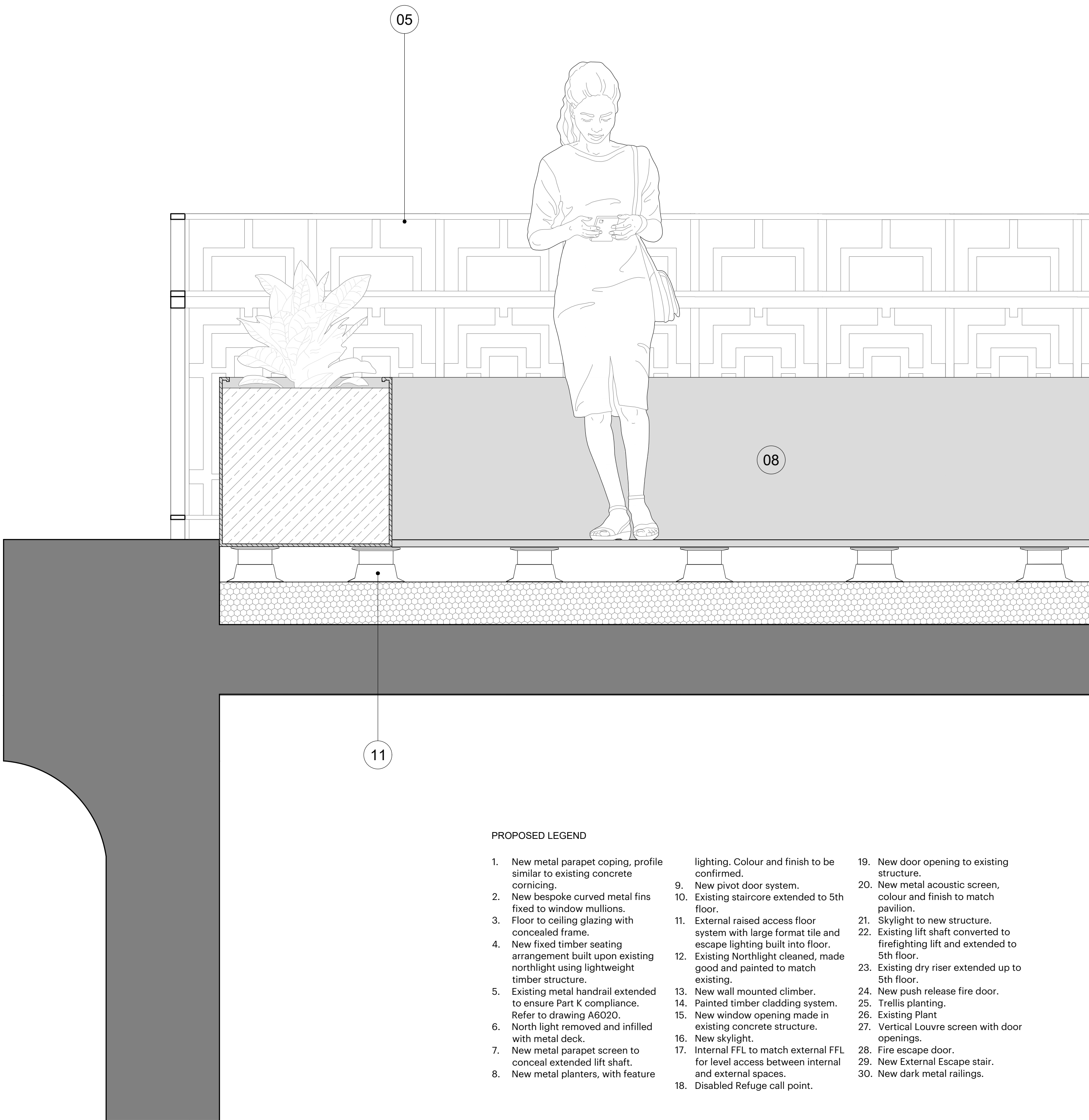

02 PROPOSED RAILING & PARAPET DETAIL
1:10 @ A1

PROPOSED LEGEND

- | | | |
|--|--|---|
| 1. New metal parapet coping, profile similar to existing concrete corncicing. | lighting. Colour and finish to be confirmed. | 19. New door opening to existing structure. |
| 2. New bespoke curved metal fins fixed to window mullions. | 9. New pivot door system. | 20. New metal acoustic screen, colour and finish to match pavilion. |
| 3. Floor to ceiling glazing with concealed frame. | 10. Existing staircore extended to 5th floor. | 21. Skylight to new structure. |
| 4. New fixed timber seating arrangement built upon existing northlight using lightweight timber structure. | 11. External raised access floor system with large format tile and escape lighting built into floor. | 22. Existing lift shaft converted to firefighting lift and extended to 5th floor. |
| 5. Existing metal handrail extended to ensure Part K compliance. Refer to drawing A6020. | 12. Existing Northlight cleaned, made good and painted to match existing. | 23. Existing dry riser extended up to 5th floor. |
| 6. North light removed and infilled with metal deck. | 13. New wall mounted climber. | 24. New push release fire door. |
| 7. New metal parapet screen to conceal extended lift shaft. | 14. Painted timber cladding system. | 25. Trellis planting. |
| 8. New metal planters, with feature | 15. New window opening made in existing concrete structure. | 26. Existing Plant |
| | 16. New skylight. | 27. Vertical Louvre screen with door openings. |
| | 17. Internal FFL to match external FFL for level access between internal and external spaces. | 28. Fire escape door. |
| | 18. Disabled Refuge call point. | 29. New External Escape stair. |
| | | 30. New dark metal railings. |

* Subject to latest survey information

Date	Rev	Reason for issue
31.01.2025	P1	ISSUED FOR PLANNING

Key Plan

0 0.1 0.2 0.3 0.4 0.5m

- | | | |
|--|---|--------------------|
| | - | Existing Structure |
| | - | Proposed Structure |

Disclaimer

dMFK Architects Ltd take no responsibility for dimensions obtained by scaling from this drawing. If no dimension is shown the recipient must ascertain the dimension specifically from the architect or by site measurement and may not rely on the drawing. Supply of the drawing in digital form is solely for convenience and no reliance may be placed on any data in digital form. All data must be checked against hard copy. This drawing is issued for design intent only and should not be used for construction unless stated.

Copyright: This drawing is the property of dMFK Architects Ltd. No disclosure or copy of it may be made without the written permission of dMFK Architects Ltd

Client

LAZARI INVESTMENTS LTD

Project

GREATER LONDON HOUSE
180 HAMPSTEAD ROAD, LONDON, NW1 7FB

Drawing Title

EXISTING & PROPOSED PARAPET/RAILING
DETAIL

dMFK

76 Charlotte Street, London. W1T 4QS
t: 0207 435 1144 e: info@dmmk.co.uk w: www.dmmk.co.uk

Drawn By	Checked By	Scale @ A1	Scale @ A3
JD	DR	1:10	1:20

	Project No.	Drawing No.	Revision
dMFK	2327	A6000	P1