

Notes
Unless indicated, this drawing is for information only and should not be used for construction. Do not scale, use figured dimensions only. All dimensions to be checked on site. This drawing should be printed and read at the original size, as stated. Cartwright Pickard Architects accepts no responsibility for errors that occur as a result of reviewing this drawing at any other size.

Cartwright Pickard Architects prepared this drawing using 2024.2 and does not accept liability for any loss or degradation of that information held in the drawing resulting from the translation from the original file format to any other file format or from the recipient's reading of it in any other programme or an earlier version of the programme referred to above. Cartwright Pickard Architects accepts no liability for use of this drawing by parties other than the party for whom it was prepared or for purposes other than those for which it was prepared.

DWG Issues
When this drawing is issued in DWG format it is an uncontrolled version and is provided to enable the recipient to prepare its own documents/drawings for which it is solely responsible. It is based on background information current at the time of issue.

Cartwright Pickard Architects accepts no liability for any alterations to, additions to or discrepancies arising out of changes to such background information which occur after it has been issued by Cartwright Pickard Architects.

Key Plan

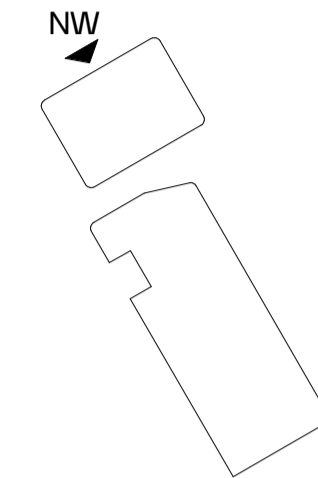

Drawing Revisions

Date:	Rev:	Note:	Check:
31.01.25	P01	Section 73 Application Submission	DR

CARTWRIGHT
PICKARD

Client
Regal Avenue Road Ltd.

Project
1016 | 100 Avenue Road

Building Name
Tower & Lower Building

Drawing Title
North-West Elevation - Eton Avenue

Scale
1: 200 @ A1

Drawing Created
July 2024

Revision
P01

Drawing No.
1016-CPA-ZZ-ZZ-DR-A-0602

London Office
1 Canal Side Studios
8-14 St Pancras Way
London NW1 0QG
Tel 020 7554 3830

© Cartwright Pickard Architects Ltd.

