

THIS DRAWING MUST NOT BE REPRODUCED WITHOUT PRIOR CONSENT.
DO NOT SCALE FROM THIS DRAWING - ALL DIMENSIONS TO BE CHECKED ON SITE
THIS DRAWING IS COPYRIGHT ©

GENERAL NOTES

- THIS DRAWING MAY NOT CONTAIN ALL DETAILS OF ALL SYSTEMS, MATERIALS, ANCILLARY ITEMS, ETC. SHOWN ON THIS DRAWING NECESSARY TO DESCRIBE A COMPLETE INSTALLATION. PROVIDE ALL DETAILS OF ALL SYSTEMS, MATERIALS, ANCILLARY ITEMS, ETC. NECESSARY TO PROVIDE, INSTALL, COMMISSION AND SET TO WORK A COMPLETE INSTALLATION THAT MEETS THE SPECIFIED DESIGN CRITERIA AND CAN BE MAINTAINED IN ACCORDANCE WITH THE DEFINED STANDARDS, GOOD INDUSTRY PRACTICE AND MANUFACTURERS' RECOMMENDATIONS AND INSTRUCTIONS.
- ALL IDENTIFIED CONFLICTS BETWEEN THIS DRAWING AND OTHER DRAWINGS AND SPECIFICATIONS ARE TO BE BROUGHT TO THE ATTENTION OF THE DESIGN TEAM FOR CLARIFICATION AND RESOLUTION.
- ALL IDENTIFIED ANOMALIES THAT EXIST ON THIS DRAWING ARE TO BE BROUGHT TO THE ATTENTION OF THE ENGINEER FOR CLARIFICATION AND RESOLUTION.
- THE COST OR LIABILITY OF ANY CONFLICTS OR ANOMALIES IN THE DRAWINGS WITH OTHER TENDER OR CONTRACT DOCUMENTS NOT BROUGHT TO THE ATTENTION OF THE DESIGN TEAM AND ENGINEER FOR CLARIFICATION AND RESOLUTION ARE DEEMED TO BE ACCEPTED AND INCLUDED BY THE CONTRACTOR.
- THE CONTENT OF THIS DRAWING IS INTENDED TO COMMUNICATE THE DESIGN INTENT OF THE BUILDING SERVICES SYSTEM(S) SHOWN ON THIS DRAWING.
- THE CONTRACTOR IS REFERRED TO THE MECHANICAL SERVICES SPECIFICATION FOR INSTRUCTION ON THE APPLICATION OF ALL CONTRACTOR DESIGN (WHEN REQUIRED) AND INSTALLATION STANDARDS, REGULATIONS, CODES OF PRACTICE, ETC.
- ALL SERVICE ROUTES, EQUIPMENT AND PLANT LOCATIONS AND MAINTENANCE SPACE SHOWN ON THIS DRAWING ARE INDICATIVE AND FOR INFORMATION ONLY. THE FABRICATION, WORKING OR INSTALLATION DRAWINGS SHALL DEFINE ALL REQUIRED SERVICE ROUTES, EQUIPMENT AND PLANT LOCATIONS AND MAINTENANCE SPACE IN ACCORDANCE WITH DEFINED STANDARDS, GOOD INDUSTRY PRACTICE AND MANUFACTURERS' RECOMMENDATIONS AND INSTRUCTIONS.
- THIS DRAWING IS NOT A CONSTRUCTION, FABRICATION, WORKING OR INSTALLATION DRAWING. THE CONTRACTOR IS REFERRED TO THE MECHANICAL SERVICES SPECIFICATION FOR INSTRUCTION ON THE PREPARATION AND CO-ORDINATION OF CONSTRUCTION, FABRICATION, WORKING OR INSTALLATION DRAWINGS.
- ALL PENETRATIONS THROUGH FLOOR SLABS, COLUMNS, BEAMS, BRACING AND LOAD BEARING WALLS ARE TO BE AGREED WITH THE STRUCTURAL ENGINEER PRIOR TO THE FORMATION OF SAID PENETRATION.
- FOR FINAL SERVICES SETTING OUT AND CO-ORDINATION, THE CONTRACTOR SHALL REFER TO THE ARCHITECTS LATEST INFORMATION.

PLANNING

| A | FEB.25 | PLANNING ISSUE |
|---|--------|----------------|
|---|--------|----------------|

| REV | DATE | DESCRIPTION |
|-----|------|-------------|
|-----|------|-------------|

TPS.

Taylor Project Services LLP

No.1 Cornhill
London EC3V 3ND
Tel 020 7743 6602
www.taylorprojectservices.com

| | |
|--------|---|
| CLIENT |  THE BEDFORD ESTATES 29a Montague Street London WC1B 5BL Tel: 0171 636 2885 Fax: 0171 265 3759 |
|--------|---|

| | |
|---------|---|
| PROJECT | 18 BLOOMSBURY SQUARE LONDON WC1A 2NS |
|---------|---|

| | |
|---------------|--|
| DRAWING TITLE | BASEMENT MECHANICAL SERVICES LAYOUT |
|---------------|--|

| | | | |
|-------|------|---------|----------|
| SCALE | 1:50 | DATE | 05.11.24 |
| DRAWN | D.F. | CHECKED | G.N.T. |

| | |
|----------------|-----------------|
| DRAWING STATUS | PLANNING |
|----------------|-----------------|

| | |
|--------------|---------|
| DATE PLOTTED | 18/2/25 |
|--------------|---------|

| | | | |
|-------------|--------------|----------|---|
| DRAWING NO. | TPS/2437/B/M | REVISION | A |
|-------------|--------------|----------|---|

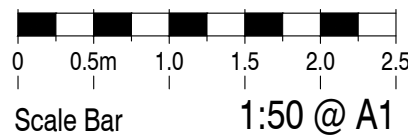
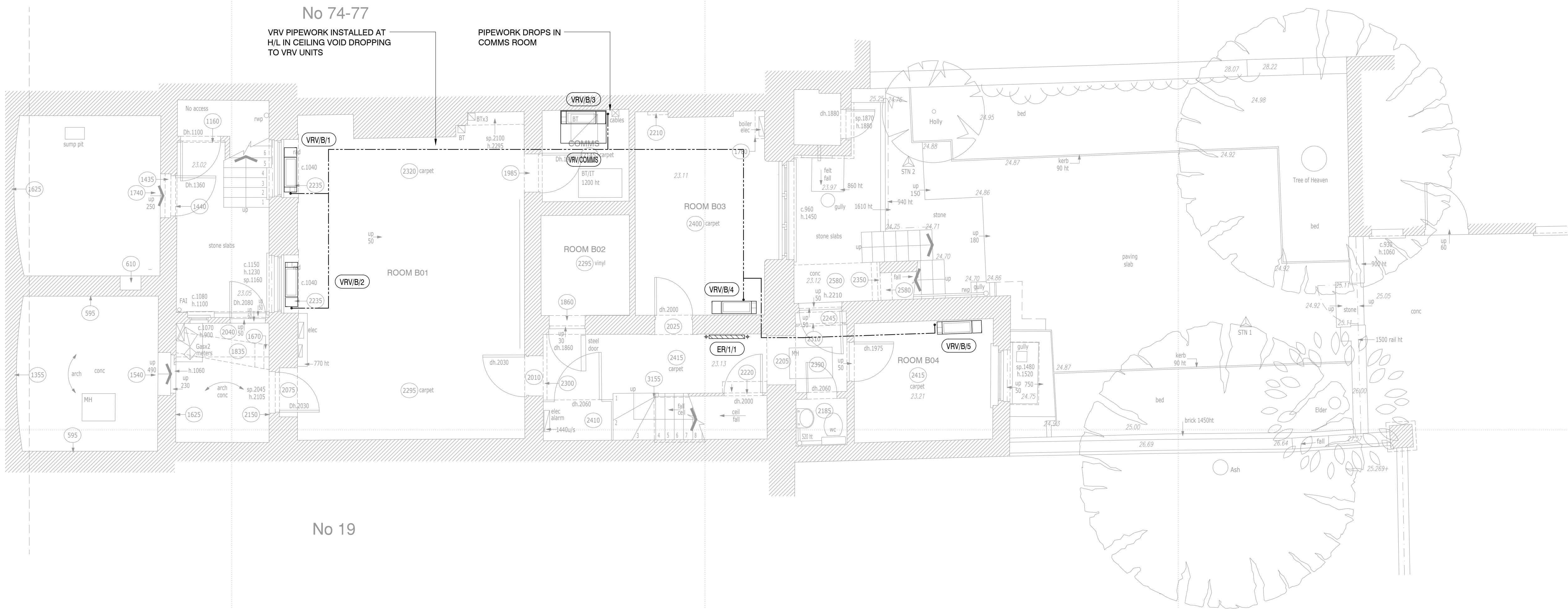

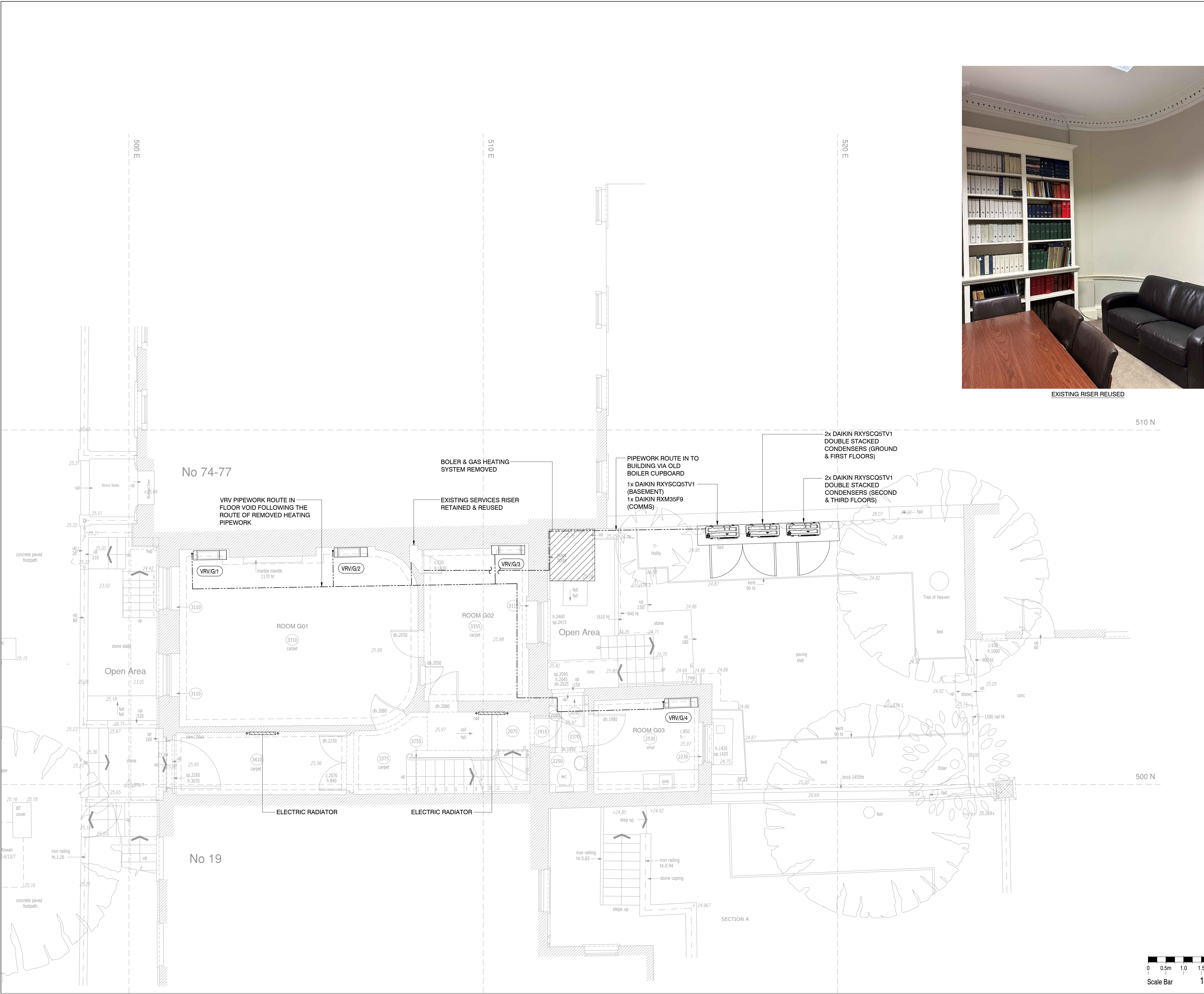

EXISTING RISER REUSED

- THIS DRAWING MUST NOT BE REPRODUCED WITHOUT PRIOR CONSENT.
DO NOT SCALE FROM THIS DRAWING - ALL DIMENSIONS TO BE CHECKED ON SITE
THIS DRAWING IS COPYRIGHT ©
- ### GENERAL NOTES
- THIS DRAWING MAY NOT CONTAIN ALL DETAILS OF ALL SYSTEMS, MATERIALS, ANCILLARY ITEMS, ETC. SHOWN ON THIS DRAWING NECESSARY TO DESCRIBE A COMPLETE INSTALLATION. PROVIDE ALL DETAILS OF ALL SYSTEMS, MATERIALS, ANCILLARY ITEMS, ETC. NECESSARY TO PROVIDE, INSTALL, COMMISSION AND SET TO WORK A COMPLETE INSTALLATION THAT MEETS THE SPECIFIED DESIGN CRITERIA AND CAN BE MAINTAINED IN ACCORDANCE WITH THE DEFINED STANDARDS, GOOD INDUSTRY PRACTICE AND MANUFACTURERS' RECOMMENDATIONS AND INSTRUCTIONS.
 - ALL IDENTIFIED CONFLICTS BETWEEN THIS DRAWING AND OTHER DRAWINGS AND SPECIFICATIONS ARE TO BE BROUGHT TO THE ATTENTION OF THE DESIGN TEAM FOR CLARIFICATION AND RESOLUTION.
 - ALL IDENTIFIED ANOMALIES THAT EXIST ON THIS DRAWING ARE TO BE BROUGHT TO THE ATTENTION OF THE ENGINEER FOR CLARIFICATION AND RESOLUTION.
 - THE COST OR LIABILITY OF ANY CONFLICTS OR ANOMALIES IN THE DRAWINGS WITH OTHER TENDER OR CONTRACT DOCUMENTS NOT BROUGHT TO THE ATTENTION OF THE DESIGN TEAM AND ENGINEER FOR CLARIFICATION AND RESOLUTION ARE DEEMED TO BE ACCEPTED AND INCLUDED BY THE CONTRACTOR.
 - THE CONTENT OF THIS DRAWING IS INTENDED TO COMMUNICATE THE DESIGN INTENT OF THE BUILDING SERVICES SYSTEM(S) SHOWN ON THIS DRAWING.
 - THE CONTRACTOR IS REFERRED TO THE MECHANICAL SERVICES SPECIFICATION FOR INSTRUCTION ON THE APPLICATION OF ALL CONTRACTOR DESIGN (WHEN REQUIRED) AND INSTALLATION STANDARDS, REGULATIONS, CODES OF PRACTICE, ETC.
 - ALL SERVICE ROUTES, EQUIPMENT AND PLANT LOCATIONS AND MAINTENANCE SPACE SHOWN ON THIS DRAWING ARE INDICATIVE AND FOR INFORMATION ONLY. THE FABRICATION, WORKING OR INSTALLATION DRAWINGS SHALL DEFINE ALL REQUIRED SERVICE ROUTES, EQUIPMENT AND PLANT LOCATIONS AND MAINTENANCE SPACE IN ACCORDANCE WITH DEFINED STANDARDS, GOOD INDUSTRY PRACTICE AND MANUFACTURERS' RECOMMENDATIONS AND INSTRUCTIONS.
 - THIS DRAWING IS NOT A CONSTRUCTION, FABRICATION, WORKING OR INSTALLATION DRAWING. THE CONTRACTOR IS REFERRED TO THE MECHANICAL SERVICES SPECIFICATION FOR INSTRUCTION ON THE PREPARATION AND CO-ORDINATION OF CONSTRUCTION, FABRICATION, WORKING OR INSTALLATION DRAWINGS.
 - ALL PENETRATIONS THROUGH FLOOR SLABS, COLUMNS, BEAMS, BRACING AND LOAD BEARING WALLS ARE TO BE AGREED WITH THE STRUCTURAL ENGINEER PRIOR TO THE FORMATION OF SAID PENETRATION.
 - FOR FINAL SERVICES SETTING OUT AND CO-ORDINATION, THE CONTRACTOR SHALL REFER TO THE ARCHITECTS LATEST INFORMATION.

PLANNING

| | | |
|--|--------------|----------------|
| A | FEB.25 | PLANNING ISSUE |
| REV | DATE | DESCRIPTION |
| <div><div>TPS.</div><div>Taylor Project Services LLP</div><div>No.1 Cornhill</div><div>London EC3V 3ND</div><div>Tel 020 7743 6602</div><div>www.taylorprojectservices.com</div></div> | | |
| <div><div>CLIENT</div><div><div></div><div><div>THE BEDFORD ESTATES</div><div>29a Montague Street London WC1B 5SL Tel: 020 7743 6602 Fax: 020 7743 6603</div></div></div></div> | | |
| <div><div>PROJECT</div><div>18 BLOOMSBURY SQUARE LONDON WC1A 2NS</div></div> | | |
| <div><div>DRAWING TITLE</div><div>GROUND FLOOR MECHANICAL SERVICES LAYOUT</div></div> | | |
| SCALE | 1:50 | DATE 05.11.24 |
| DRAWN | D.F. | CHECKED G.N.T. |
| <div><div>DRAWING STATUS</div><div>PLANNING</div></div> | | |
| DATE PLOTTED | 3/2/25 | |
| DRAWING NO. | TPS/2437/G/M | REVISION A |

THIS DRAWING MUST NOT BE REPRODUCED WITHOUT PRIOR CONSENT.
DO NOT SCALE FROM THIS DRAWING - ALL DIMENSIONS TO BE CHECKED ON SITE
THIS DRAWING IS COPYRIGHT ©

GENERAL NOTES

- THIS DRAWING MAY NOT CONTAIN ALL DETAILS OF ALL SYSTEMS, MATERIALS, ANCILLARY ITEMS, ETC. SHOWN ON THIS DRAWING NECESSARY TO DESCRIBE A COMPLETE INSTALLATION. PROVIDE ALL DETAILS OF ALL SYSTEMS, MATERIALS, ANCILLARY ITEMS, ETC. NECESSARY TO PROVIDE, INSTALL, COMMISSION AND SET TO WORK A COMPLETE INSTALLATION THAT MEETS THE SPECIFIED DESIGN CRITERIA AND CAN BE MAINTAINED IN ACCORDANCE WITH THE DEFINED STANDARDS, GOOD INDUSTRY PRACTICE AND MANUFACTURERS' RECOMMENDATIONS AND INSTRUCTIONS.
- ALL IDENTIFIED CONFLICTS BETWEEN THIS DRAWING AND OTHER DRAWINGS AND SPECIFICATIONS ARE TO BE BROUGHT TO THE ATTENTION OF THE DESIGN TEAM FOR CLARIFICATION AND RESOLUTION.
- ALL IDENTIFIED ANOMALIES THAT EXIST ON THIS DRAWING ARE TO BE BROUGHT TO THE ATTENTION OF THE ENGINEER FOR CLARIFICATION AND RESOLUTION.
- THE COST OR LIABILITY OF ANY CONFLICTS OR ANOMALIES IN THE DRAWINGS WITH OTHER TENDER OR CONTRACT DOCUMENTS NOT BROUGHT TO THE ATTENTION OF THE DESIGN TEAM AND ENGINEER FOR CLARIFICATION AND RESOLUTION ARE DEEMED TO BE ACCEPTED AND INCLUDED BY THE CONTRACTOR.
- THE CONTENT OF THIS DRAWING IS INTENDED TO COMMUNICATE THE DESIGN INTENT OF THE BUILDING SERVICES SYSTEM(S) SHOWN ON THIS DRAWING.
- THE CONTRACTOR IS REFERRED TO THE MECHANICAL SERVICES SPECIFICATION FOR INSTRUCTION ON THE APPLICATION OF ALL CONTRACTOR DESIGN (WHEN REQUIRED) AND INSTALLATION STANDARDS, REGULATIONS, CODES OF PRACTICE, ETC.
- ALL SERVICE ROUTES, EQUIPMENT AND PLANT LOCATIONS AND MAINTENANCE SPACE SHOWN ON THIS DRAWING ARE INDICATIVE AND FOR INFORMATION ONLY. THE FABRICATION, WORKING OR INSTALLATION DRAWINGS SHALL DEFINE ALL REQUIRED SERVICE ROUTES, EQUIPMENT AND PLANT LOCATIONS AND MAINTENANCE SPACE IN ACCORDANCE WITH DEFINED STANDARDS, GOOD INDUSTRY PRACTICE AND MANUFACTURERS' RECOMMENDATIONS AND INSTRUCTIONS.
- THIS DRAWING IS NOT A CONSTRUCTION, FABRICATION, WORKING OR INSTALLATION DRAWING. THE CONTRACTOR IS REFERRED TO THE MECHANICAL SERVICES SPECIFICATION FOR INSTRUCTION ON THE PREPARATION AND CO-ORDINATION OF CONSTRUCTION, FABRICATION, WORKING OR INSTALLATION DRAWINGS.
- ALL PENETRATIONS THROUGH FLOOR SLABS, COLUMNS, BEAMS, BRACING AND LOAD BEARING WALLS ARE TO BE AGREED WITH THE STRUCTURAL ENGINEER PRIOR TO THE FORMATION OF SAID PENETRATION.
- FOR FINAL SERVICES SETTING OUT AND CO-ORDINATION, THE CONTRACTOR SHALL REFER TO THE ARCHITECTS LATEST INFORMATION.



EXISTING RISER REUSED

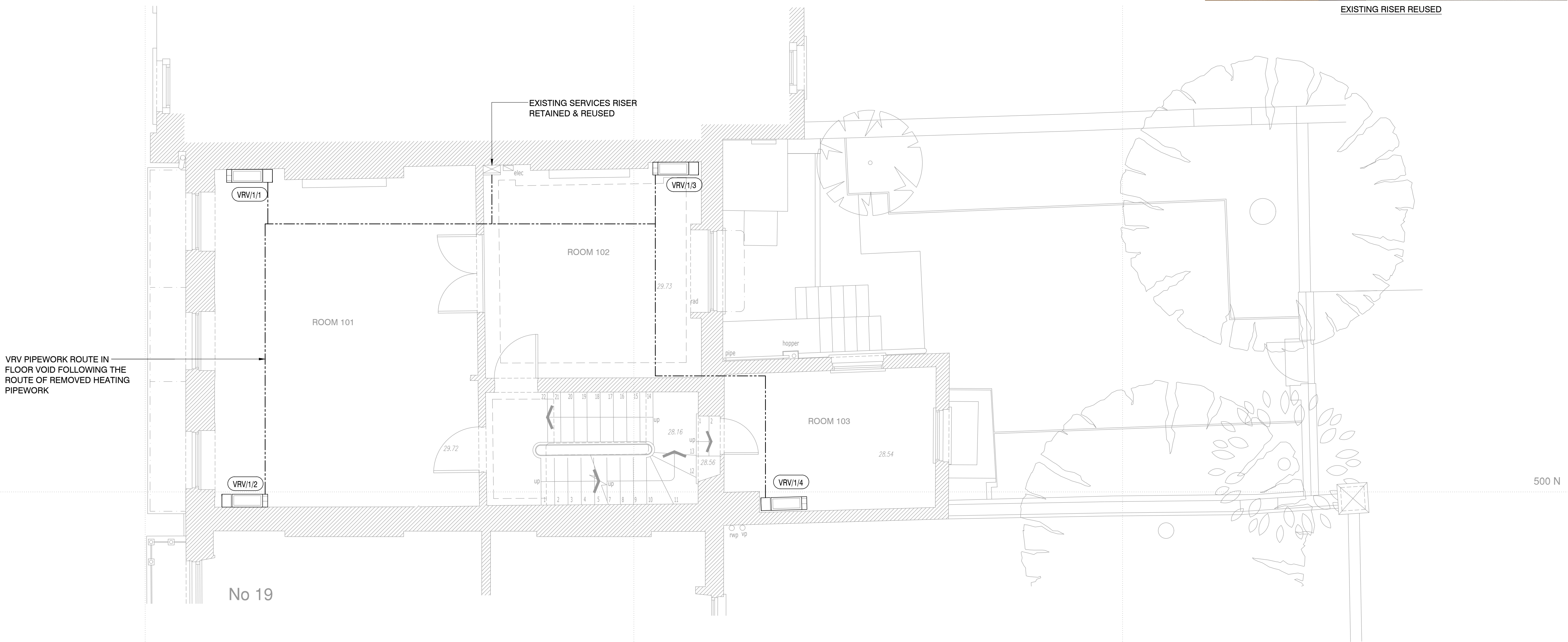

PLANNING

| | | |
|---|--------|----------------|
| 0 | NOV.24 | PLANNING ISSUE |
|---|--------|----------------|

| REV | DATE | DESCRIPTION |
|-----|------|-------------|
|-----|------|-------------|

TPS.

Taylor Project Services LLP

No.1 Cornhill
London EC3V 3ND
Tel 020 7743 6602
www.taylorprojectservices.com

CLIENT



**THE
BEDFORD
ESTATES**

29a Montague Street
London
WC1B 5BL
Tel: 0171 636 2885
Fax: 0171 265 3759

PROJECT

**18 BLOOMSBURY SQUARE
LONDON
WC1A 2NS**

DRAWING TITLE

**FIRST FLOOR
MECHANICAL SERVICES LAYOUT**

| | | | |
|-------|------|---------|----------|
| SCALE | 1:50 | DATE | 05.11.24 |
| DRAWN | - | CHECKED | - |

DRAWING STATUS

PLANNING

| | |
|--------------|--------|
| DATE PLOTTED | 3/2/25 |
|--------------|--------|

| | | | |
|-------------|--------------|----------|---|
| DRAWING NO. | TPS/2437/1/M | REVISION | 0 |
|-------------|--------------|----------|---|



- THIS DRAWING MUST NOT BE REPRODUCED WITHOUT PRIOR CONSENT.
DO NOT SCALE FROM THIS DRAWING - ALL DIMENSIONS TO BE CHECKED ON SITE
THIS DRAWING IS COPYRIGHT ©
- ### GENERAL NOTES
- THIS DRAWING MAY NOT CONTAIN ALL DETAILS OF ALL SYSTEMS, MATERIALS, ANCILLARY ITEMS, ETC. SHOWN ON THIS DRAWING NECESSARY TO DESCRIBE A COMPLETE INSTALLATION. PROVIDE ALL DETAILS OF ALL SYSTEMS, MATERIALS, ANCILLARY ITEMS, ETC. NECESSARY TO PROVIDE, INSTALL, COMMISSION AND SET TO WORK A COMPLETE INSTALLATION THAT MEETS THE SPECIFIED DESIGN CRITERIA AND CAN BE MAINTAINED IN ACCORDANCE WITH THE DEFINED STANDARDS, GOOD INDUSTRY PRACTICE AND MANUFACTURERS' RECOMMENDATIONS AND INSTRUCTIONS.
 - ALL IDENTIFIED CONFLICTS BETWEEN THIS DRAWING AND OTHER DRAWINGS AND SPECIFICATIONS ARE TO BE BROUGHT TO THE ATTENTION OF THE DESIGN TEAM FOR CLARIFICATION AND RESOLUTION.
 - ALL IDENTIFIED ANOMALIES THAT EXIST ON THIS DRAWING ARE TO BE BROUGHT TO THE ATTENTION OF THE ENGINEER FOR CLARIFICATION AND RESOLUTION.
 - THE COST OR LIABILITY OF ANY CONFLICTS OR ANOMALIES IN THE DRAWINGS WITH OTHER TENDER OR CONTRACT DOCUMENTS NOT BROUGHT TO THE ATTENTION OF THE DESIGN TEAM AND ENGINEER FOR CLARIFICATION AND RESOLUTION ARE DEEMED TO BE ACCEPTED AND INCLUDED BY THE CONTRACTOR.
 - THE CONTENT OF THIS DRAWING IS INTENDED TO COMMUNICATE THE DESIGN INTENT OF THE BUILDING SERVICES SYSTEM(S) SHOWN ON THIS DRAWING.
 - THE CONTRACTOR IS REFERRED TO THE MECHANICAL SERVICES SPECIFICATION FOR INSTRUCTION ON THE APPLICATION OF ALL CONTRACTOR DESIGN (WHEN REQUIRED) AND INSTALLATION STANDARDS, REGULATIONS, CODES OF PRACTICE, ETC.
 - ALL SERVICE ROUTES, EQUIPMENT AND PLANT LOCATIONS AND MAINTENANCE SPACE SHOWN ON THIS DRAWING ARE INDICATIVE AND FOR INFORMATION ONLY. THE FABRICATION, WORKING OR INSTALLATION DRAWINGS SHALL DEFINE ALL REQUIRED SERVICE ROUTES, EQUIPMENT AND PLANT LOCATIONS AND MAINTENANCE SPACE IN ACCORDANCE WITH DEFINED STANDARDS, GOOD INDUSTRY PRACTICE AND MANUFACTURERS' RECOMMENDATIONS AND INSTRUCTIONS.
 - THIS DRAWING IS NOT A CONSTRUCTION, FABRICATION, WORKING OR INSTALLATION DRAWING. THE CONTRACTOR IS REFERRED TO THE MECHANICAL SERVICES SPECIFICATION FOR INSTRUCTION ON THE PREPARATION AND CO-ORDINATION OF CONSTRUCTION, FABRICATION, WORKING OR INSTALLATION DRAWINGS.
 - ALL PENETRATIONS THROUGH FLOOR SLABS, COLUMNS, BEAMS, BRACING AND LOAD BEARING WALLS ARE TO BE AGREED WITH THE STRUCTURAL ENGINEER PRIOR TO THE FORMATION OF SAID PENETRATION.
 - FOR FINAL SERVICES SETTING OUT AND CO-ORDINATION, THE CONTRACTOR SHALL REFER TO THE ARCHITECTS LATEST INFORMATION.

PLANNING

| | | |
|---|--------|----------------|
| 0 | NOV.24 | PLANNING ISSUE |
|---|--------|----------------|

| REV | DATE | DESCRIPTION |
|-----|------|-------------|
|-----|------|-------------|

TPS.
Taylor Project Services LLP
No.1 Cornhill
London EC3V 3ND
Tel 020 7743 6602
www.taylorprojectservices.com

CLIENT

 **THE BEDFORD ESTATES**
29a Montague Street
London
WC1B 5BL
Tel: 020 7743 6602
Fax: 020 7743 6601

PROJECT

**18 BLOOMSBURY SQUARE
LONDON
WC1A 2NS**

DRAWING TITLE

**SECOND FLOOR
MECHANICAL SERVICES LAYOUT**

| | | | |
|----------------|--------------|---------|----------|
| SCALE | 1:50 | DATE | 05.11.24 |
| DRAWN | _ | CHECKED | _ |
| DRAWING STATUS | PLANNING | | |
| DATE PLOTTED | 18/2/25 | | |
| DRAWING NO. | TPS/2437/2/M | | |
| REVISION | 0 | | |

GENERAL NOTES

-

| | | |
|---|--------|----------------|
| 0 | NOV 24 | PLANNING ISSUE |
|---|--------|----------------|

| REV | DATE | DESCRIPTION |
|-----|------|-------------|
|-----|------|-------------|

Taylor Project Services LLP
No.1 Cornhill
London EC3V 3ND
Tel 020 7743 6602
www.taylorprojectservices.com

 **THE
BEDFORD
ESTATES**

29a Montague Street
London
WC1B 5BL
Tel: 0171 636 2885
Fax: 0171 255 1729

18 BLOOMSBURY SQUARE
LONDON
WC1A 2NS

THIRD FLOOR MECHANICAL SERVICES LAYOUT

DRAWING STATUS **PLANNING**

DATE PLOTTED 18/2/25

TPS/2437/3/M 0

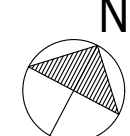

ROOF

THIRD FLOOR

SECOND FLOOR

FIRST FLOOR

GROUND

BASEMENT

RISER

(EXISTING RISER TO BE
RETAINED & REUSED)

ROOM 301

ROOM 302

ROOM 303

ROOM 201

ROOM 202

ROOM 203

ROOM 101

ROOM 102

ROOM 103

ROOM G01

ROOM G02

ROOM G03

ROOM B01

ROOM B02

ROOM B03

ROOM B04

COMMS ROOM

CU/COMMS

CU/B

CU/3

CU/2

CU/1

CU/G

VRV/G/1

VRV/G/2

VRV/G/3

VRV/G/4

VRV/B/1

VRV/B/2

VRV/B/3

VRV/B/4

VRV/B/5

i TOUCH CONTROLLER

(VRV/COMMS)

VRV/3/1

VRV/3/3

VRV/3/4

VRV/2/1

VRV/2/2

VRV/2/3

VRV/2/4

VRV/1/1

VRV/1/2

VRV/1/3

VRV/1/4

VRV/1/1

VRV/1/2

VRV/1/3

VRV/1/4

VRV/1/1

VRV/1/2

VRV/1/3

VRV/1/4

VRV/1/5

(VRV/COMMS)

* - ALL UNITS IN BASEMENT, GROUND FLOOR AND
FIRST FLOOR TO BE ENCLOSED IN JOINERY AS
DRAWING TPS/2437/VRV/J

THIS DRAWING MUST NOT BE REPRODUCED WITHOUT PRIOR CONSENT.
DO NOT SCALE FROM THIS DRAWING - ALL DIMENSIONS TO BE CHECKED ON SITE
THIS DRAWING IS COPYRIGHT ©

GENERAL NOTES

- THIS DRAWING MAY NOT CONTAIN ALL DETAILS OF ALL SYSTEMS, MATERIALS, ANCILLARY ITEMS, ETC. SHOWN ON THIS DRAWING NECESSARY TO DESCRIBE A COMPLETE INSTALLATION. PROVIDE ALL DETAILS OF ALL SYSTEMS, MATERIALS, ANCILLARY ITEMS, ETC. NECESSARY TO PROVIDE, INSTALL, COMMISSION AND SET TO WORK A COMPLETE INSTALLATION THAT MEETS THE SPECIFIED DESIGN CRITERIA AND CAN BE MAINTAINED IN ACCORDANCE WITH THE DEFINED STANDARDS, GOOD INDUSTRY PRACTICE AND MANUFACTURERS' RECOMMENDATIONS AND INSTRUCTIONS.
- ALL IDENTIFIED CONFLICTS BETWEEN THIS DRAWING AND OTHER DRAWINGS AND SPECIFICATIONS ARE TO BE BROUGHT TO THE ATTENTION OF THE DESIGN TEAM FOR CLARIFICATION AND RESOLUTION.
- ALL IDENTIFIED ANOMALIES THAT EXIST ON THIS DRAWING ARE TO BE BROUGHT TO THE ATTENTION OF THE ENGINEER FOR CLARIFICATION AND RESOLUTION.
- THE COST OR LIABILITY OF ANY CONFLICTS OR ANOMALIES IN THE DRAWINGS WITH OTHER TENDER OR CONTRACT DOCUMENTS NOT BROUGHT TO THE ATTENTION OF THE DESIGN TEAM AND ENGINEER FOR CLARIFICATION AND RESOLUTION ARE DEEMED TO BE ACCEPTED AND INCLUDED BY THE CONTRACTOR.
- THE CONTENT OF THIS DRAWING IS INTENDED TO COMMUNICATE THE DESIGN INTENT OF THE BUILDING SERVICES SYSTEM(S) SHOWN ON THIS DRAWING.
- THE CONTRACTOR IS REFERRED TO THE MECHANICAL SERVICES SPECIFICATION FOR INSTRUCTION ON THE APPLICATION OF ALL CONTRACTOR DESIGN (WHEN REQUIRED) AND INSTALLATION STANDARDS, REGULATIONS, CODES OF PRACTICE, ETC.
- ALL SERVICE ROUTES, EQUIPMENT AND PLANT LOCATIONS AND MAINTENANCE SPACE SHOWN ON THIS DRAWING ARE INDICATIVE AND FOR INFORMATION ONLY. THE FABRICATION, WORKING OR INSTALLATION DRAWINGS SHALL DEFINE ALL REQUIRED SERVICE ROUTES, EQUIPMENT AND PLANT LOCATIONS AND MAINTENANCE SPACE IN ACCORDANCE WITH DEFINED STANDARDS, GOOD INDUSTRY PRACTICE AND MANUFACTURERS' RECOMMENDATIONS AND INSTRUCTIONS.
- THIS DRAWING IS NOT A CONSTRUCTION, FABRICATION, WORKING OR INSTALLATION DRAWING. THE CONTRACTOR IS REFERRED TO THE MECHANICAL SERVICES SPECIFICATION FOR INSTRUCTION ON THE PREPARATION AND CO-ORDINATION OF CONSTRUCTION, FABRICATION, WORKING OR INSTALLATION DRAWINGS.
- ALL PENETRATIONS THROUGH FLOOR SLABS, COLUMNS, BEAMS, BRACING AND LOAD BEARING WALLS ARE TO BE AGREED WITH THE STRUCTURAL ENGINEER PRIOR TO THE FORMATION OF SAID PENETRATION.
- FOR FINAL SERVICES SETTING OUT AND CO-ORDINATION, THE CONTRACTOR SHALL REFER TO THE ARCHITECTS LATEST INFORMATION.
- ALL FUSED CONNECTION UNITS TO VRV UNITS ARE TO BE UNSWITCHED.

PLANNING

| | | |
|---|--------|----------------|
| 0 | NOV.24 | PLANNING ISSUE |
|---|--------|----------------|

| REV | DATE | DESCRIPTION |
|-----|------|-------------|
|-----|------|-------------|

TPS.

Taylor Project Services LLP

No.1 Cornhill
London EC3V 3ND
Tel 020 7743 6602
www.taylorprojectservices.com

CLIENT



PROJECT

18 BLOOMSBURY SQUARE
LONDON
WC1A 2NS

DRAWING TITLE

VRV SCHEMATIC

| | | | |
|-------|--------|------|----------|
| SCALE | N.T.S. | DATE | 05.11.24 |
|-------|--------|------|----------|

| | | | |
|-------|---|---------|---|
| DRAWN | _ | CHECKED | _ |
|-------|---|---------|---|

DRAWING STATUS

PLANNING

| | |
|--------------|----------|
| DATE PLOTTED | 19/11/24 |
|--------------|----------|

| | | | |
|-------------|---------------------|----------|---|
| DRAWING NO. | TPS/2437/SCH/M/VRVS | REVISION | 0 |
|-------------|---------------------|----------|---|

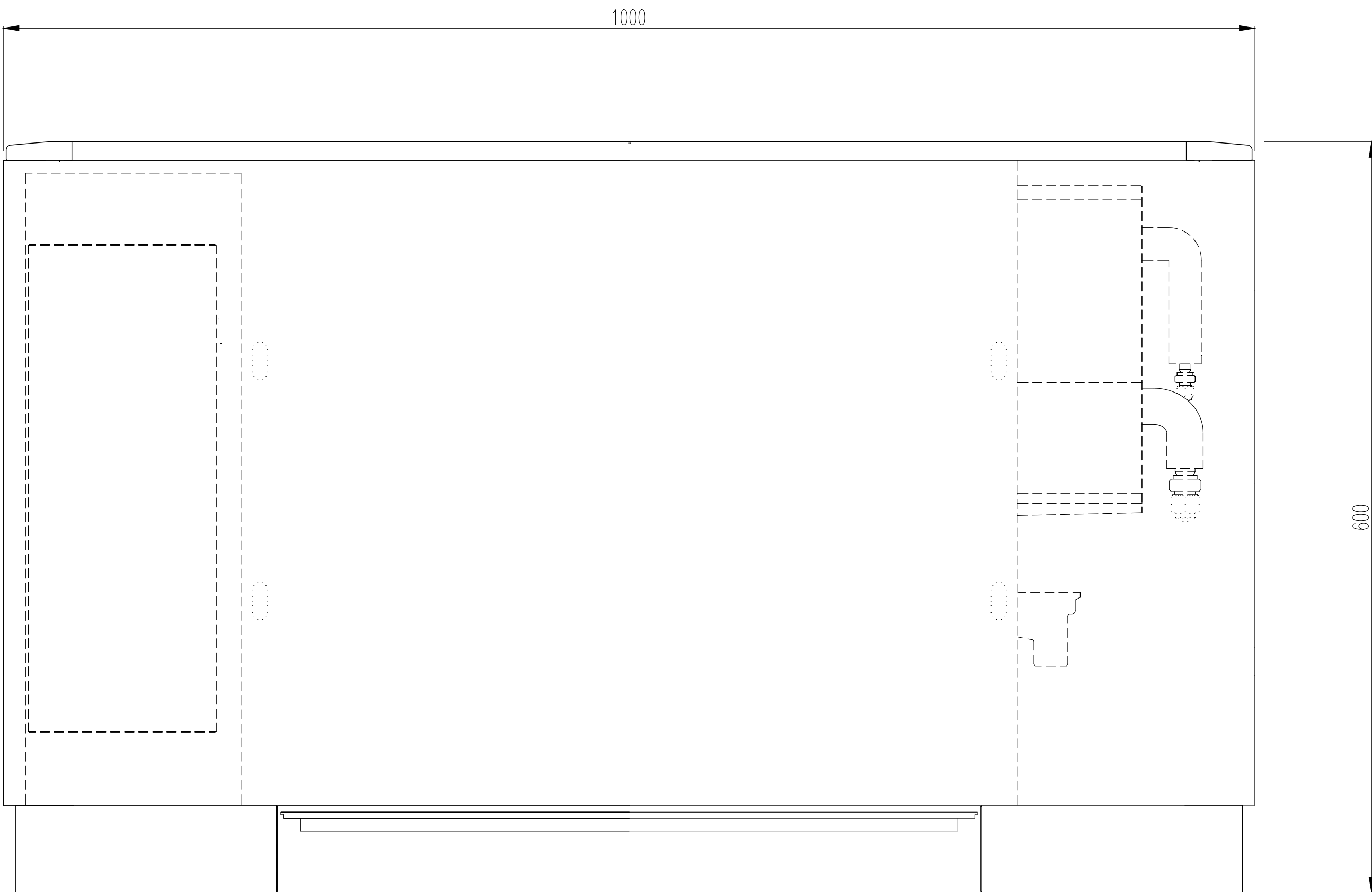

FRONT VIEW

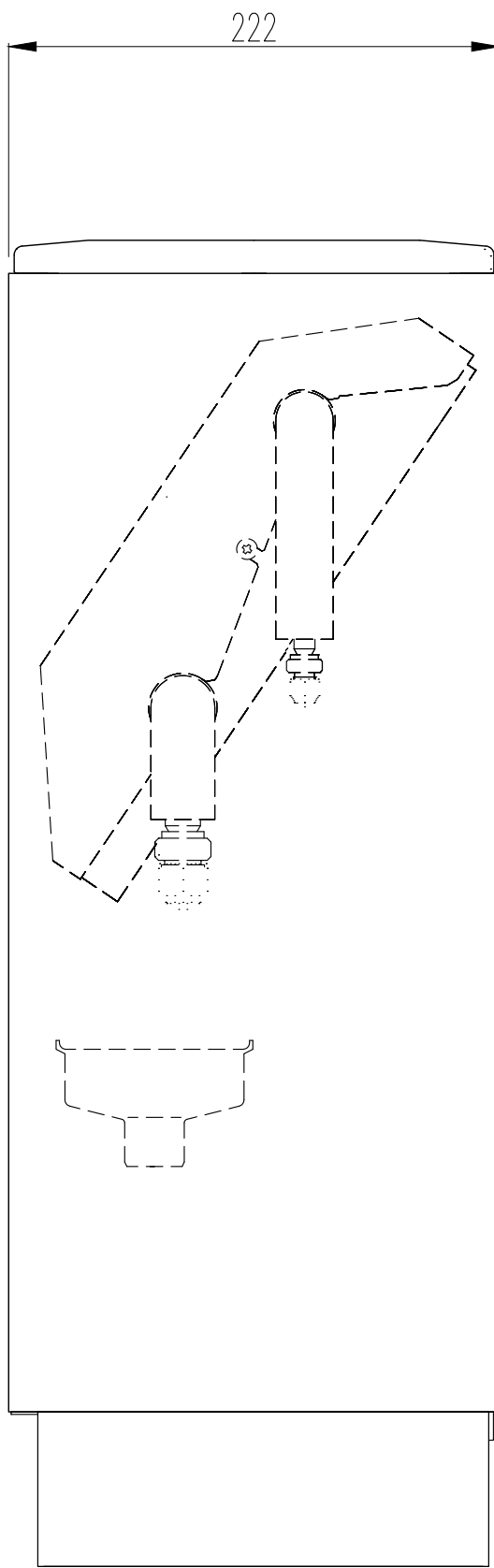

SECTION

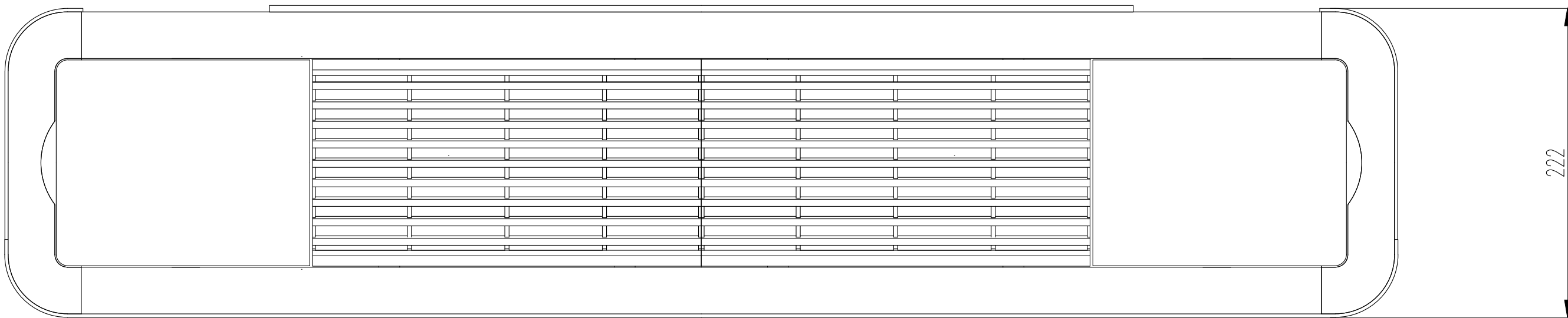

PLAN

NOTE:
BASEMENT SECOND
& THIRD FLOORS ONLY

- THIS DRAWING MUST NOT BE REPRODUCED WITHOUT PRIOR CONSENT.
DO NOT SCALE FROM THIS DRAWING - ALL DIMENSIONS TO BE CHECKED ON SITE
THIS DRAWING IS COPYRIGHT ©
- GENERAL NOTES**
- THIS DRAWING MAY NOT CONTAIN ALL DETAILS OF ALL SYSTEMS, MATERIALS, ANCILLARY ITEMS, ETC. SHOWN ON THIS DRAWING NECESSARY TO DESCRIBE A COMPLETE INSTALLATION. PROVIDE ALL DETAILS OF ALL SYSTEMS, MATERIALS, ANCILLARY ITEMS, ETC. NECESSARY TO PROVIDE, INSTALL, COMMISSION AND SET TO WORK A COMPLETE INSTALLATION THAT MEETS THE SPECIFIED DESIGN CRITERIA AND CAN BE MAINTAINED IN ACCORDANCE WITH THE DEFINED STANDARDS, GOOD INDUSTRY PRACTICE AND MANUFACTURERS' RECOMMENDATIONS AND INSTRUCTIONS.
 - ALL IDENTIFIED CONFLICTS BETWEEN THIS DRAWING AND OTHER DRAWINGS AND SPECIFICATIONS ARE TO BE BROUGHT TO THE ATTENTION OF THE DESIGN TEAM FOR CLARIFICATION AND RESOLUTION.
 - ALL IDENTIFIED ANOMALIES THAT EXIST ON THIS DRAWING ARE TO BE BROUGHT TO THE ATTENTION OF THE ENGINEER FOR CLARIFICATION AND RESOLUTION.
 - THE COST OR LIABILITY OF ANY CONFLICTS OR ANOMALIES IN THE DRAWINGS WITH OTHER TENDER OR CONTRACT DOCUMENTS NOT BROUGHT TO THE ATTENTION OF THE DESIGN TEAM AND ENGINEER FOR CLARIFICATION AND RESOLUTION ARE DEEMED TO BE ACCEPTED AND INCLUDED BY THE CONTRACTOR.
 - THE CONTENT OF THIS DRAWING IS INTENDED TO COMMUNICATE THE DESIGN INTENT OF THE BUILDING SERVICES SYSTEM(S) SHOWN ON THIS DRAWING.
 - THE CONTRACTOR IS REFERRED TO THE MECHANICAL SERVICES SPECIFICATION FOR INSTRUCTION ON THE APPLICATION OF ALL CONTRACTOR DESIGN (WHEN REQUIRED) AND INSTALLATION STANDARDS, REGULATIONS, CODES OF PRACTICE, ETC.
 - ALL SERVICE ROUTES, EQUIPMENT AND PLANT LOCATIONS AND MAINTENANCE SPACE SHOWN ON THIS DRAWING ARE INDICATIVE AND FOR INFORMATION ONLY. THE FABRICATION, WORKING OR INSTALLATION DRAWINGS SHALL DEFINE ALL REQUIRED SERVICE ROUTES, EQUIPMENT AND PLANT LOCATIONS AND MAINTENANCE SPACE IN ACCORDANCE WITH DEFINED STANDARDS, GOOD INDUSTRY PRACTICE AND MANUFACTURERS' RECOMMENDATIONS AND INSTRUCTIONS.
 - THIS DRAWING IS NOT A CONSTRUCTION, FABRICATION, WORKING OR INSTALLATION DRAWING. THE CONTRACTOR IS REFERRED TO THE MECHANICAL SERVICES SPECIFICATION FOR INSTRUCTION ON THE PREPARATION AND CO-ORDINATION OF CONSTRUCTION, FABRICATION, WORKING OR INSTALLATION DRAWINGS.
 - ALL PENETRATIONS THROUGH FLOOR SLABS, COLUMNS, BEAMS, BRACING AND LOAD BEARING WALLS ARE TO BE AGREED WITH THE STRUCTURAL ENGINEER PRIOR TO THE FORMATION OF SAID PENETRATION.
 - FOR FINAL SERVICES SETTING OUT AND CO-ORDINATION, THE CONTRACTOR SHALL REFER TO THE ARCHITECTS LATEST INFORMATION.

PLANNING

| | | |
|-----|--------|----------------|
| 0 | NOV.24 | PLANNING ISSUE |
| REV | DATE | DESCRIPTION |

TPS.
Taylor Project Services LLP
No.1 Cornhill
London EC3V 3ND
Tel 020 7743 6602
www.taylorprojectservices.com

CLIENT



**THE
BEDFORD
ESTATES**

29a Montague Street
London
WC1B 5BL
Tel: 0171 636 2885
Fax: 0171 265 3759

| |
|--|
| PROJECT |
| 18 BLOOMSBURY SQUARE LONDON WC1A 2NS |

| |
|------------------------------|
| DRAWING TITLE |
| TYPICAL VRV CASING DETAIL |

| | | | |
|----------------|-----------------|---------|---------------|
| SCALE | N.T.S. | DATE | 05.11.24 |
| DRAWN | _ | CHECKED | _ |
| DRAWING STATUS | PLANNING | | |
| DATE PLOTTED | 19/11/24 | | |
| DRAWING NO. | TPS/2437/M/VRVC | | REVISION 0 |

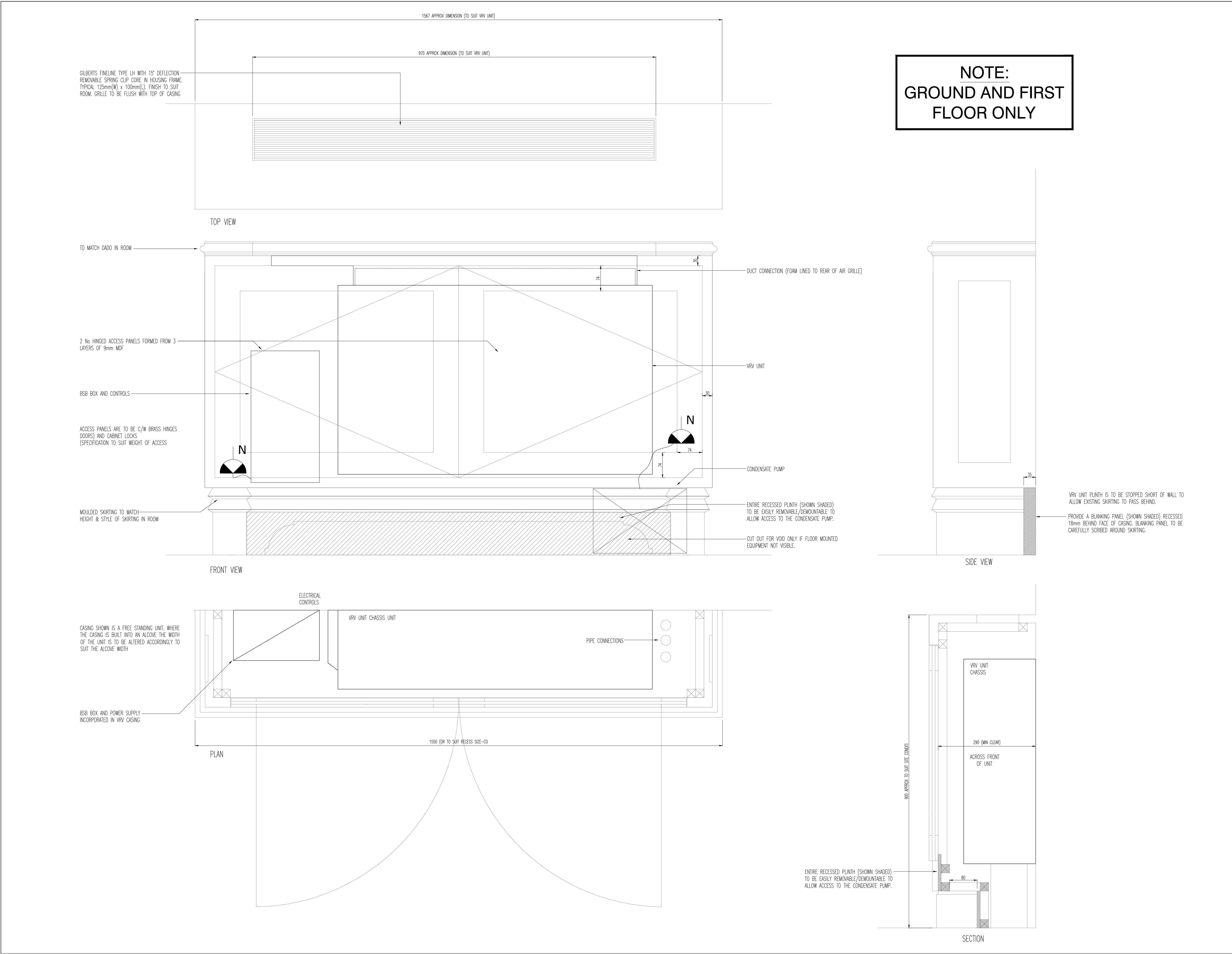

| | | |
|---|--------|----------------|
| THIS DRAWING MUST NOT BE REPRODUCED WITHOUT PRIOR CONSENT. DO NOT SCALE FROM THIS DRAWING - ALL DIMENSIONS TO BE CHECKED ON SITE THIS DRAWING IS COPYRIGHT © | | |
| GENERAL NOTES | | |
| 1. THIS DRAWING MAY NOT CONTAIN ALL DETAILS OF ALL SYSTEMS, MATERIALS, ANCILLARY ITEMS, ETC. SHOWN ON THIS DRAWING NECESSARY TO DESCRIBE A COMPLETE INSTALLATION. PROVIDE ALL DETAILS OF ALL SYSTEMS, MATERIALS, ANCILLARY ITEMS, ETC. NECESSARY TO PROVIDE, INSTALL, COMMISSION AND SET TO WORK A COMPLETE INSTALLATION THAT MEETS THE SPECIFIED DESIGN CRITERIA AND CAN BE MAINTAINED IN ACCORDANCE WITH THE DEFINED STANDARDS, GOOD INDUSTRY PRACTICE AND MANUFACTURERS' RECOMMENDATIONS AND INSTRUCTIONS. | | |
| 2. ALL IDENTIFIED CONFLICTS BETWEEN THIS DRAWING AND OTHER DRAWINGS AND SPECIFICATIONS ARE TO BE BROUGHT TO THE ATTENTION OF THE DESIGN TEAM FOR CLARIFICATION AND RESOLUTION. | | |
| 3. ALL IDENTIFIED ANOMALIES THAT EXIST ON THIS DRAWING ARE TO BE BROUGHT TO THE ATTENTION OF THE ENGINEER FOR CLARIFICATION AND RESOLUTION. | | |
| 4. THE COST OR LIABILITY OF ANY CONFLICTS OR ANOMALIES IN THE DRAWINGS WITH OTHER TENDER OR CONTRACT DOCUMENTS NOT BROUGHT TO THE ATTENTION OF THE DESIGN TEAM AND ENGINEER FOR CLARIFICATION AND RESOLUTION ARE DEEMED TO BE ACCEPTED AND INCLUDED BY THE CONTRACTOR. | | |
| 5. THE CONTENT OF THIS DRAWING IS INTENDED TO COMMUNICATE THE DESIGN INTENT OF THE BUILDING SERVICES SYSTEM(S) SHOWN ON THIS DRAWING. | | |
| 6. THE CONTRACTOR IS REFERRED TO THE MECHANICAL SERVICES SPECIFICATION FOR INSTRUCTION ON THE APPLICATION OF ALL CONTRACTOR DESIGN (WHEN REQUIRED) AND INSTALLATION STANDARDS, REGULATIONS, CODES OF PRACTICE, ETC. | | |
| 7. ALL SERVICE ROUTES, EQUIPMENT AND PLANT LOCATIONS AND MAINTENANCE SPACE SHOWN ON THIS DRAWING ARE INDICATIVE AND FOR INFORMATION ONLY. THE FABRICATION, WORKING OR INSTALLATION DRAWINGS SHALL DEFINE ALL REQUIRED SERVICE ROUTES, EQUIPMENT AND PLANT LOCATIONS AND MAINTENANCE SPACE IN ACCORDANCE WITH DEFINED STANDARDS, GOOD INDUSTRY PRACTICE AND MANUFACTURERS' RECOMMENDATIONS AND INSTRUCTIONS. | | |
| 8. THIS DRAWING IS NOT A CONSTRUCTION, FABRICATION, WORKING OR INSTALLATION DRAWING. THE CONTRACTOR IS REFERRED TO THE MECHANICAL SERVICES SPECIFICATION FOR INSTRUCTION ON THE PREPARATION AND CO-ORDINATION OF CONSTRUCTION, FABRICATION, WORKING OR INSTALLATION DRAWINGS. | | |
| 9. ALL PENETRATIONS THROUGH FLOOR SLABS, COLUMNS, BEAMS, BRACING AND LOAD BEARING WALLS ARE TO BE AGREED WITH THE STRUCTURAL ENGINEER PRIOR TO THE FORMATION OF SAID PENETRATION. | | |
| 10. FOR FINAL SERVICES SETTING OUT AND CO-ORDINATION, THE CONTRACTOR SHALL REFER TO THE ARCHITECTS LATEST INFORMATION. | | |
| PLANNING | | |
| 0 | NOV.24 | PLANNING ISSUE |
| REV | DATE | DESCRIPTION |
| TPS. Taylor Project Services LLP No.1 Cornhill London EC3V 3ND Tel 020 7743 6602 www.taylorprojectservices.com | | |
| CLIENT THE BEDFORD ESTATES 29a Montague Street London WC1B 5BL Tel: 0171 636 2885 Fax: 0171 265 3759 | | |
| PROJECT 18 BLOOMSBURY SQUARE LONDON WC1A 2NS | | |
| DRAWING TITLE TYPICAL VRV JOINERY CASING DETAIL | | |
| SCALE | N.T.S. | DATE 05.11.24 |
| DRAWN | _ | CHECKED _ |
| DRAWING STATUS PLANNING | | |
| DATE PLOTTED 19/11/24 | | |
| DRAWING NO. TPS/2437/M/VRVJ | | REVISION 0 |