

Ormonde Court, 10-14 Belsize Grove NW3 4UP

Application for T1, T4, T5 and T13

No.	Name	Height (m)	Crown spread (m)	Age Class	Physiological Condition	Structural Condition	Observations	Recommendation	Priority	Insp Freq
1	Lime	16	6	M	Good	Good	Epicormic growth obscuring base. Crown close to Ormonde Court and adjacent building. Dense growth from previous pollarding.	Re-pollard to previous points removing 3m of growth to keep tree at a size suitable for location and as part of regular maintenance.	3	12
2	Elder	3	4	MA	Poor	Poor	Heavily decayed tree resting on wall.	Fell to ground level.	3	12
3	Malus	9	4	MA	Good	Good	No major defects visible.	No work required.	N/A	12
4	Sycamore	14	8	M	Good	Good	Ivy to 10m, crown extending into neighbouring property.	Remove ivy and crown reduce by 2m to keep tree at a size suitable for location and as part of regular maintenance.	3	12
5	Sycamore	18	10	M	Fair	Good	Ivy to 6m, small amounts of major dead wood. Crown extending into communal garden and neighbouring property. Wall leaning due to close proximity of tree.	Remove ivy and crown reduce by 3m to keep tree at a size suitable for location and as part of regular maintenance.	3	12

13	Lime	16	7	M	Good	Good	Original pollard points at 4m with included bark and possible decay. Dense regrowth from most recent pollard points.	Re-pollard to previous points removing 3m of growth to keep at a size suitable for location and as part of regular maintenance.	3	12
----	------	----	---	---	------	------	--	---	---	----

6. Site Map

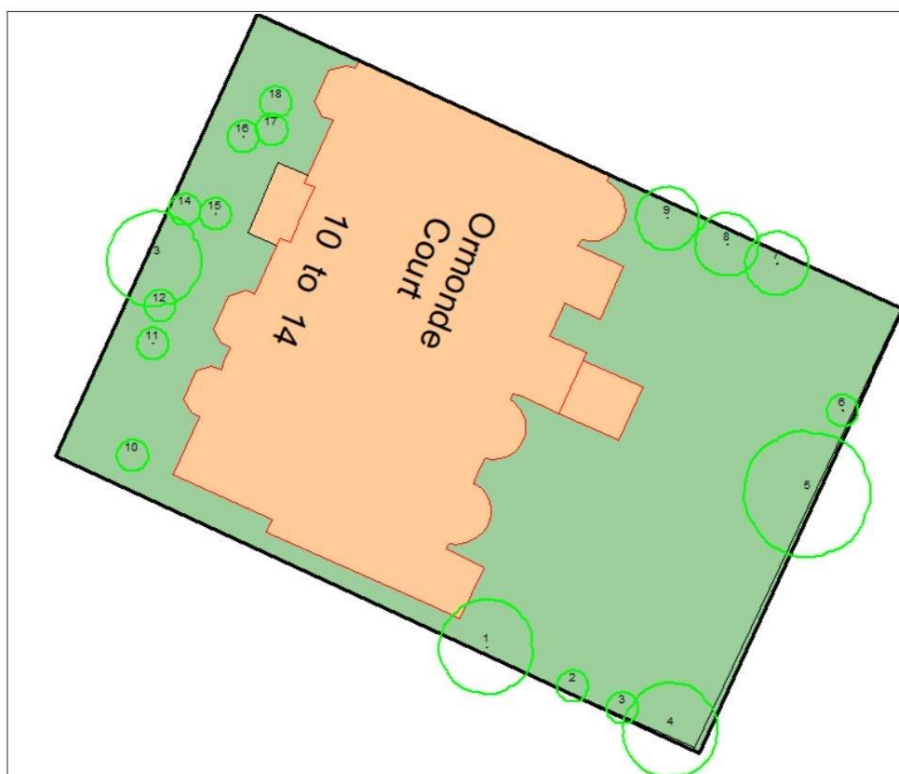



T1



T4



T5



T13