

**General Notes**

- All dimensions to be verified on site
- To be read in conjunction with all relevant documents
- In the event of discrepancy notify the Architect immediately
- Note that not all elements of the drawing may be to exact scale. All dimensions not explicitly marked should be verified either on site or with the Architect
- For Planning purposes only; subject to further detailed technical design, structural design, M&E design, Building Control approval.
- Based on measured survey by Aimcon Surveys; drainage survey information by Dyno Rod
- This document is copyright of Hugh Cullum Architects Ltd

**Issue Status**

- SK Sketch
- D Design
- T Tender
- E Existing Condition
- P Permissions
- C Contract

**Revisions**

rev	note	date	(drawn by/checked by)
( )	: Preliminary Issue for Information	19.12.23	(TS/H/C)
(A)	: Roof information added	20.02.24	(TS/H/C)
(B)	: Revised after Client Meeting	26.03.24	(TS/H/C)
(C)	: For Review	08.10.24	(TS/H/C)
(D)	: For Review	12.02.25	(TS/H/C)
(E)	: Issued for Planning	17.02.25	(TS/H/C)

Indicates existing structure

Indicates proposed structure

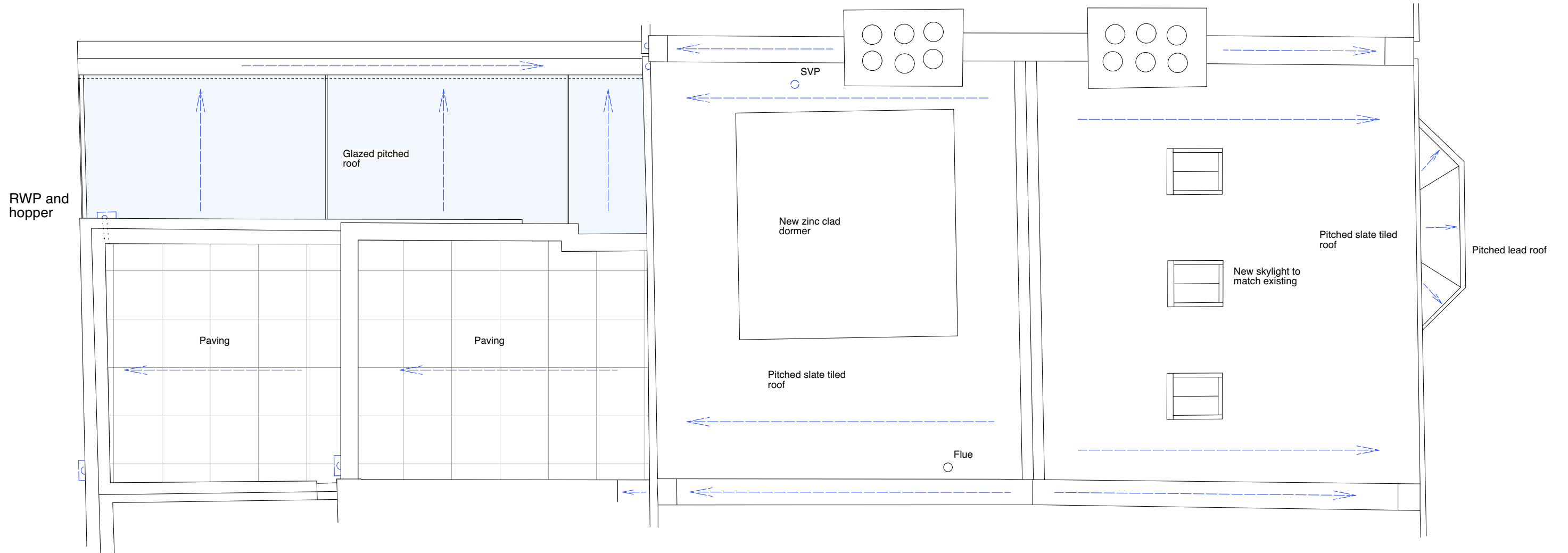

As Proposed - Roof Plan

**HUGH CULLUM ARCHITECTS LTD**  
 15 Rona Road  
 Bloomsbury Design  
 61b Judd Street  
 London WC1H 9QT  
 t 020 7383 7647  
 f 020 7387 7645  
 mail@hughcullum.com

**As Proposed**  
 General Arrangement  
 Roof Plan  
 1:25@A1, 1:50@A3  
 December 2023  
**RR015 - P105 (E)**