



- General Notes**
- All dimensions to be verified on site
 - To be read in conjunction with all relevant documents
 - In the event of discrepancy notify the Architect immediately
 - Note that not all elements of the drawing may be to exact scale. All dimensions not explicitly marked should be verified either on site or with the Architect
 - For Planning purposes only; subject to further detailed technical design, structural design, M&E design, Building Control approval.
 - Based on measured survey by Aimcon Surveys; drainage survey information by Dyno Rod
 - This document is copyright of Hugh Cullum Architects Ltd

- Issue Status**
- SK Sketch
 - D Design
 - T Tender
 - E Existing Condition
 - P Permissions
 - C Contract

Revisions

rev	note	date	(drawn by/checked by)
(.)	: Preliminary Issue for Information	19.12.23	(TS/HC)
(A)	: Dimensions added	20.02.24	(TS/HC)
(B)	: Issued to Structural Engineer	14.03.24	(TS/HC)
(C)	: For Review	08.10.24	(TS/HC)
(D)	: Issued for Planning	17.02.25	(TS/HC)

 Indicates areas of demolition shown in elevation

 Indicates areas of demolition shown in section

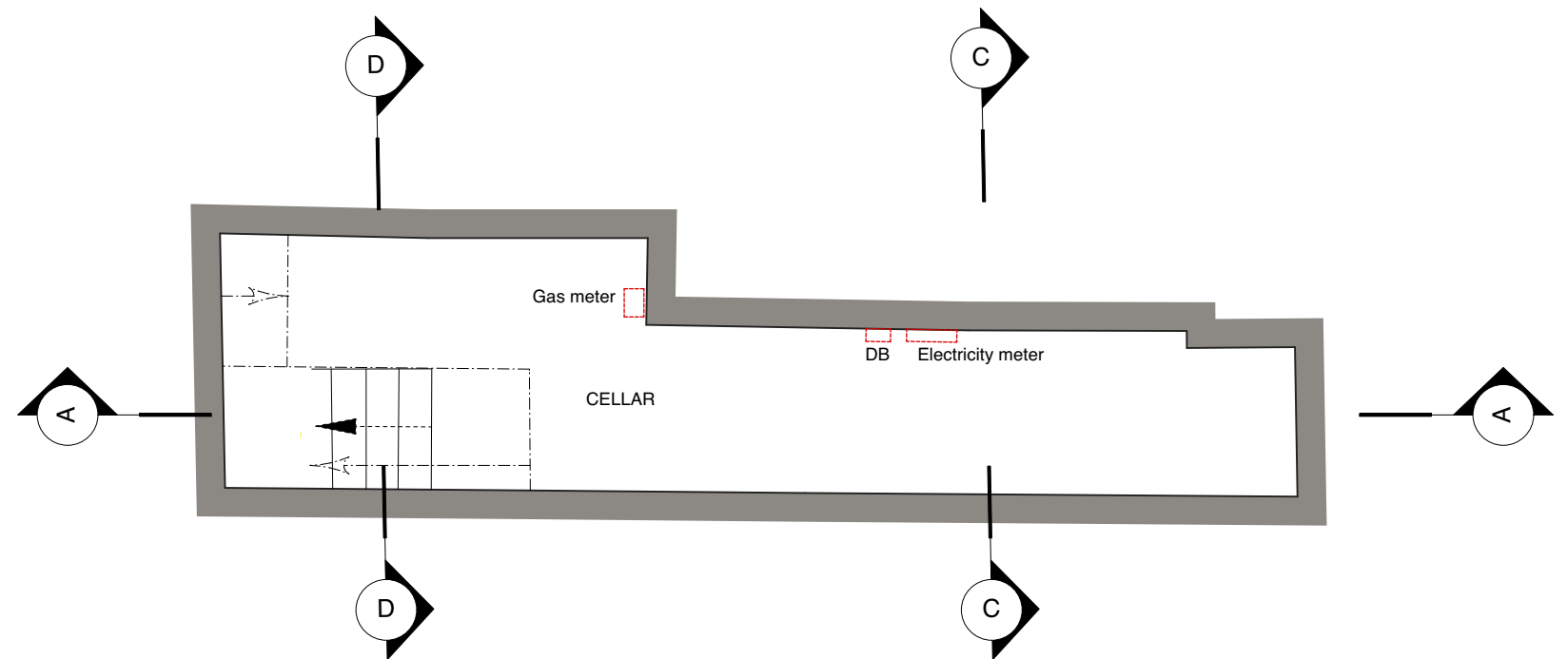

As Existing - Basement Plan