

Exterior side of acoustic board painted Mink Frost.

DE PROPOSED WINDOW EXTERNAL ELEVATION  
1:5@A1, 1:10@A3

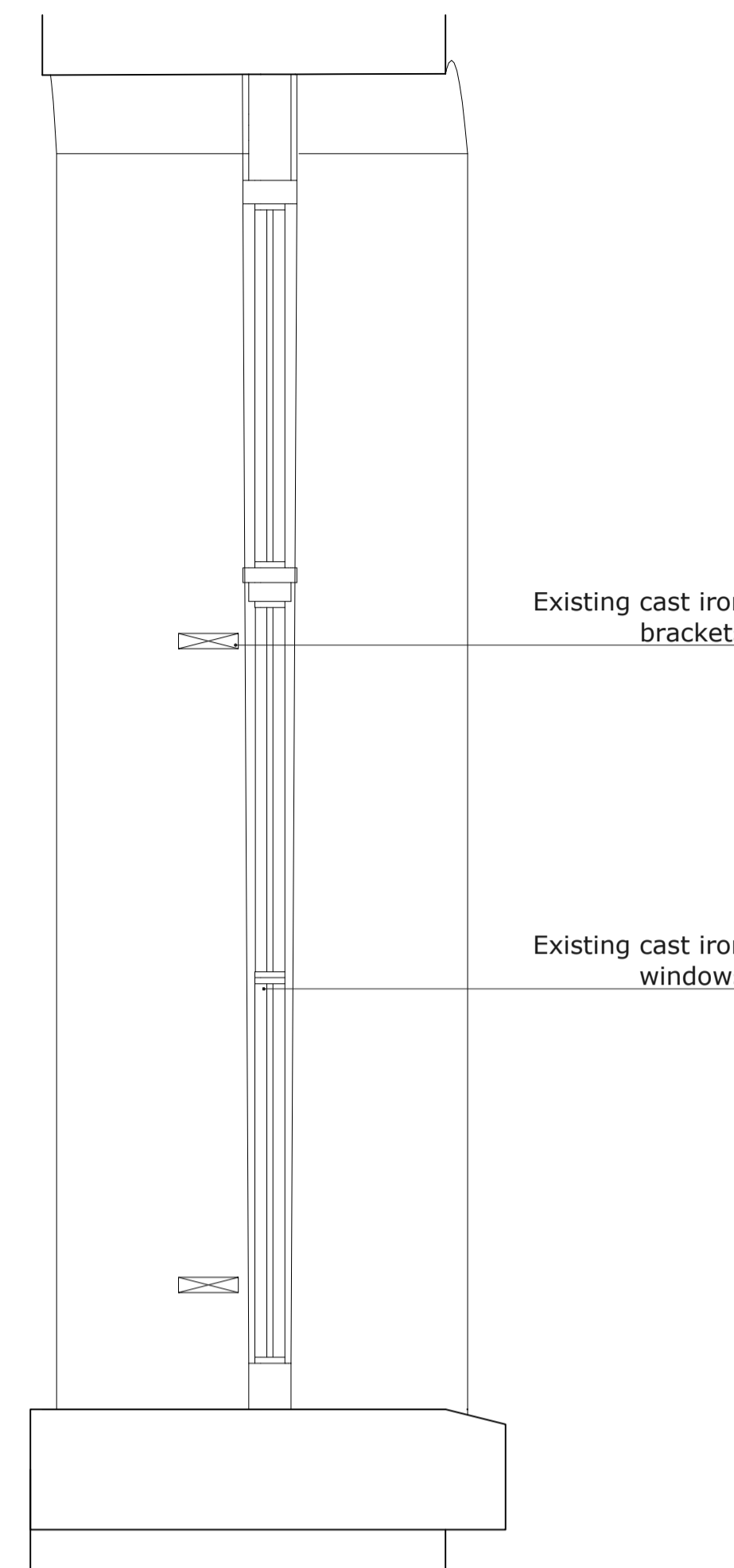

Existing cast iron brackets

Existing cast iron windows

DE EXISTING WINDOW SECTION  
1:5@A1, 1:10@A3

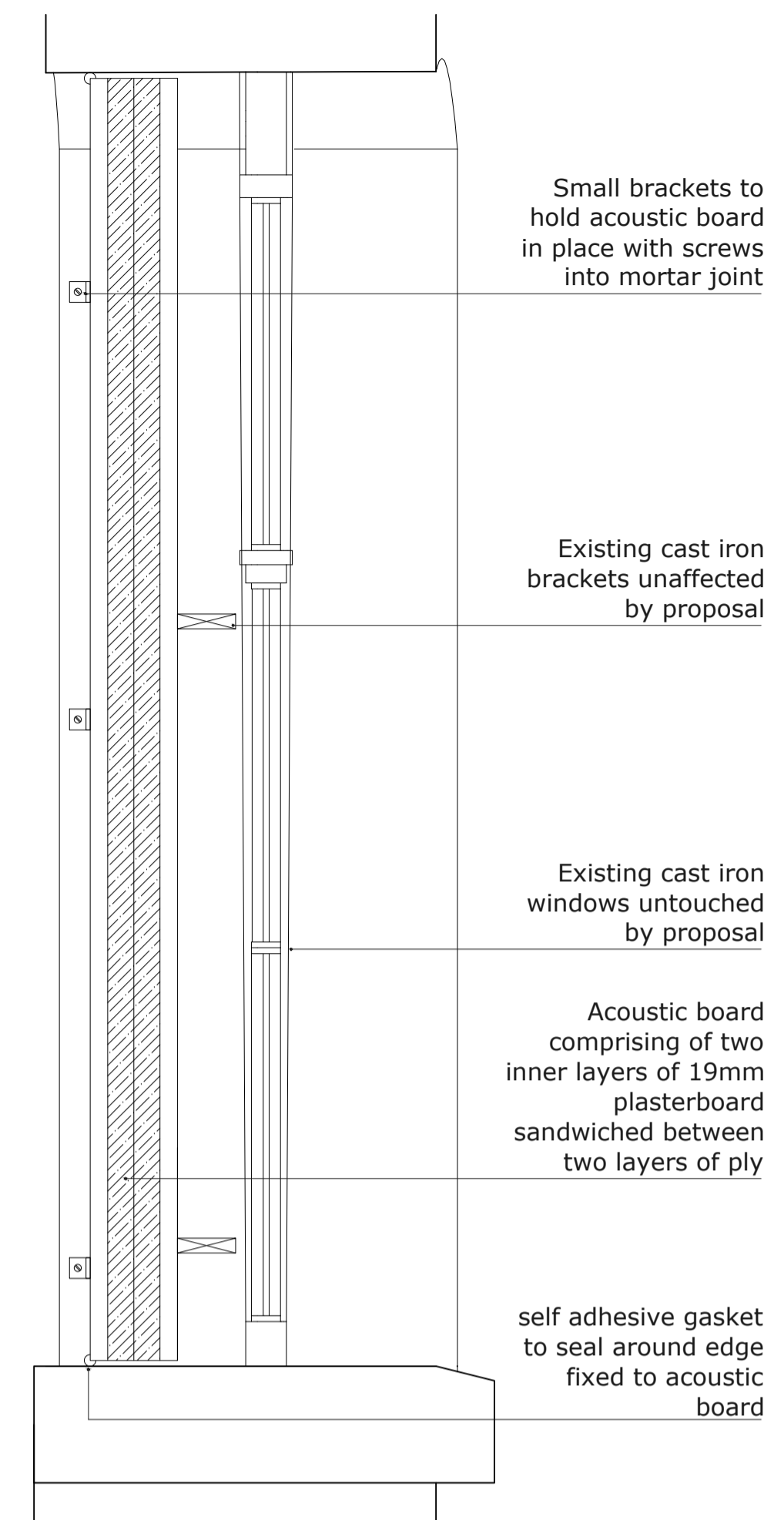

Small brackets to hold acoustic board in place with screws into mortar joint

Existing cast iron brackets unaffected by proposal

Existing cast iron windows untouched by proposal

Acoustic board comprising of two inner layers of 19mm plasterboard sandwiched between two layers of ply

self adhesive gasket to seal around edge fixed to acoustic board

DE PROPOSED WINDOW SECTION  
1:5@A1, 1:10@A3

This drawing is the property of DC Architecture+Design Ltd, and they reserve the copyright. DC+Partners is the trading name of DC Architecture+Design Ltd. The drawing is issued on the condition that it is not copied, reproduced, retained or disclosed, in whole or part, to any unauthorised person without the consent from DC Architecture+Design Ltd. Figures and dimensions are to be taken in preference to those scaled. The contractor is to verify all dimensions and conditions on site.

NOTES:

**THIS DETAIL HAS BEEN PUT TOGETHER WITH REFERENCE TO APPLICATION NO. 2022/1722/P & 2022/1798/L**

**ALL FIXINGS INTO BRICKWORK TO BE INTO MORTAR JOINTS**

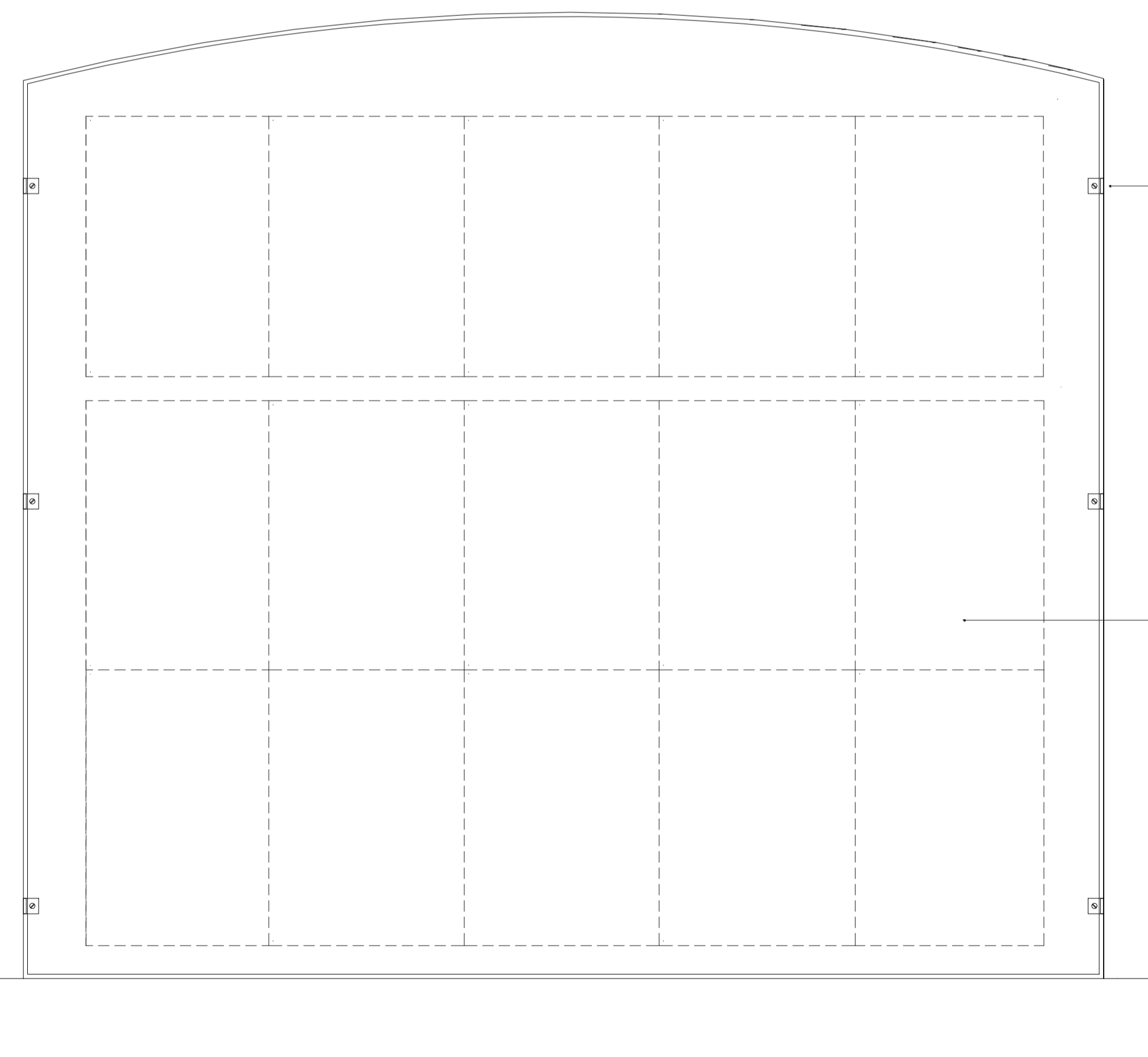

Small brackets to hold acoustic board in place with screws into mortar joint

Interior side of acoustic board painted Black

DE PROPOSED WINDOW INTERNAL ELEVATION  
1:5@A1, 1:10@A3



Existing cast iron window to be unaffected by the proposals

Existing cast iron brackets to be unaffected by the proposals

DE EXISTING WINDOW INTERNAL PHOTO  
NTS

## PLANNING

REVISIONS

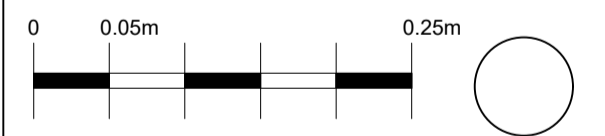

Project:  
LIVE ODYSSEY  
CAMDEN STABLES

Client:  
LIVE ODYSSEY PROMOTIONS

Scale:  
1:5 @A1 / 1:10 @A3

Title:  
WINDOW SOUNDPROOFING  
DETAIL

Drawing Number:  
LOP001\_DE\_A\_(31)001

Date: 21.11.2024  
Drawn by: CF  
Approved by: XX