

Schedule of Works Key:	
to be read in conjunction with schedule 383(SL) Listed Building Consent Schedule of Works, section 01, sheet 260	
01	01.260.01 - Paintwork to retained ground floor curved shopfront glazing to be stripped back ready for redecoration
02	01.260.02 - Paintwork to retained first floor curved shopfront glazing to be stripped back ready for redecoration
03	01.260.03 - Existing roof finishes to 21 Southampton Row to be removed back to plywood deck
04	01.260.04 - Existing key clamp handrail guarding to be removed and store for reuse
05	01.260.05 - Existing rooftop plant to be removed completely
06	01.260.06 - Non original GRP chimneys to be retained
07	01.260.07 - Lift car and associated services to be removed entirely, and rooftop lift motor room to be demolished completely.
08	01.260.08 - Existing flat roof to Vernon + Sicilian House to be removed entirely, including waterproofing and woodwool roofing panels back to existing retained steel beams below
09	01.260.09 - Non original velux rooflight to be removed
10	01.260.10 - 5th floor mansard roof of Vernon & Sicilian House to be demolished to allow for new rooftop extension
11	01.260.11 - Existing windows to Sicilian Avenue to be retained, existing paintwork to be stripped back ready for redecoration, plus existing secondary glazing to be removed
12	01.260.12 - Existing dormers and windows to Sicilian Avenue to be retained, existing paintwork to be stripped back ready for redecoration, plus existing secondary glazing to be removed
13	01.260.13 - Existing doors to Vernon/Sicilian House to be retained, redecorated and fixed back in open position
14	01.260.14 - Existing shop front glazing and doors to be retained and protected throughout works, to be redecorated
15	01.260.15 - Existing non original lift overrun to be carefully taken down to allow new core to be installed, then rebuilt as existing

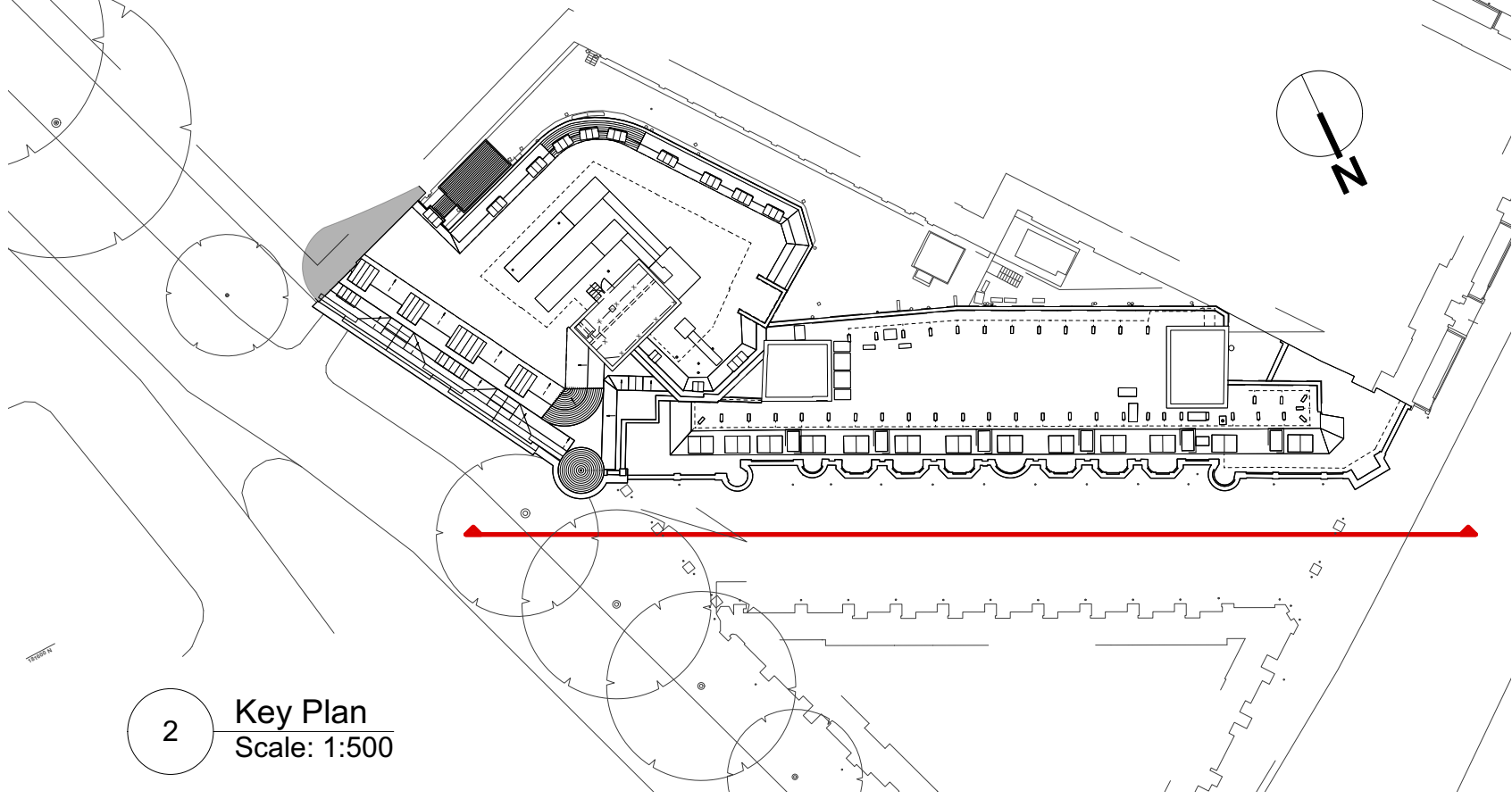

1 Vernon & Sicilian House Demolition North East Context Elevation
Scale: 1:100

0 5m 10m 20m

All dimensions to be checked on site prior to commencement of any works, and/or preparation of any shop drawings. Sizes of and dimensions to any structural or services elements are indicative only. See structural and service engineers drawings for actual sizes / dimensions. This drawing to be read in conjunction with all other Architects drawings, specifications and other Consultants' information. All proprietary systems shown on this drawing are to be installed strictly in accordance with the Manufacturers/Suppliers recommended details. Any discrepancies between information shown on this drawing and any other contract information or manufacturers/suppliers recommendations is to be brought to the attention of the Architect.	Revision	Date	Amendment	Date	Project			Job Ref.	halebrown architects	
	PL-1	22/07/2022	Issued for Planning	Jan 2021	Vernon, Sicilian Hse/21 Southampton Row			383		
	PL-2	01/03/2023	Revisions as per agreed amendments	Scale	Drawn	Check	Title			
	PL-3	07/02/2025	Revisions as per agreed amendments.	1:100 @A1	KP	DT	Vernon & Sicilian House Demolition NE Context Elevation			
				Status	Client Ref		Drwg. no.	Rev.		
				PLANNING	EDR		383 (DE) 260	PL-3		
				Hale Brown Architects Ltd. Unit 1.04, Edinburgh House, 170 Kennington Lane, London, SE11 5DP						
				T: 020 3735 7442		E: mail@halebrown.com		W: www.halebrown.com		