

- Wind loading calculations have been carried out based on site specific data and the building dimensions. Where modules have not been located within **Zones F & G** this is due to the project specific wind loading calculations.
- The **Green Line** identifies a **1000mm** boundary from the inside of the roof perimeter. This is the minimum distance BauderSOLAR PV panels should be installed from the roof edge.
- The **Magenta Line (where illustrated)** identifies an indicative mansafe system, or handrail, **1800mm** from the roof perimeter. Should this not be required please consult Bauder Ltd.
- Minimum **1000mm** has been allowed for around all roof access hatches, AOV's, upstands, mechanical plant etc. for maintenance purposes/access.
- * Numerous site specific factors can influence inverter specification. Inverters and optimisers specified are for guidance purposes only. MCS Accredited PV Contractor to confirm exact specification prior to installation.

Bauder Solar G Light - Solarwatt module

Key:

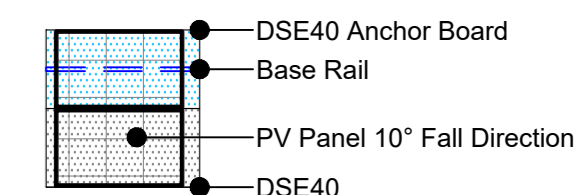

Windzones Key:

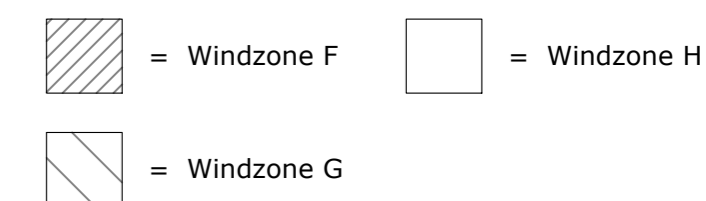

Important notice: Modules installed in zones F & G will be subject to significantly higher windloads than zone H. Where possible, all modules should be located minimum 1m from any roof plant, upstands or roof openings. Please contact Bauders technical office before re-locating any modules

Design Information

Short Mounting Rails:	9
Long Mounting Rails:	4
Type of Optimizer:	N/A
Area of PV Panels:	39.96 m2
General Information	
Total power DC:	9.00 kWp
BAUDER System type:	Bauder Solar G Light
Module type:	Classic M 3.0 Pure(450wp)
Module amount:	20 Units
Azimuth:	15° SW & 105° SW

All Dimensions, positions of Rooflights and Outlets/SVP's/mansafe systems are to be checked on site by the installing contractor for clashes BEFORE the PV design is ordered.

Rev	Date	Description	Drawn By
4	26.11.24	Client plan updated.	DAM
3	25.11.24	Layout revised for rwp positions.	DAM
2	07.02.24	Updated Roof Plan	CD
1	16.01.24	Mansafe Removed, E/W Panels	CD



UK OFFICE
Bauder Limited
 70 Landseer Road, Ipswich,
 Suffolk IP3 0DH,
 England.
Tel: +44 (0)1473 257671
Fax: +44 (0)1473 230761
Email: technical@bauder.co.uk
 bauder.co.uk

IRELAND OFFICE
Bauder Limited
 O'Duffy Centre, Cross Lane,
 Carrickmacross, Co. Monaghan,
 Ireland.
Tel: +353 (0)42 9692 333
Fax: +353 (0)42 9692 839
Email: technical@bauder.ie
 bauder.ie

Installing contractor is responsible for checking this scheme against architects drawings/site requirements and to advise Bauder immediately of any discrepancies. Orders placed against this drawing reference assume approval of this scheme. Any materials required over and above the quantities given, will be charged accordingly.

Contract Name:
 4 Oak Hill Park, London, NW3 7LG

Bauder Solar G Light PV Layout Plan

Contract No:	B235536/1
Drawing No:	B235536PV - 20240104
Designed to Drawing No:	G402 Roof Plan
Scale:	N.T.S
Drawn By:	CD
Date:	04.01.24

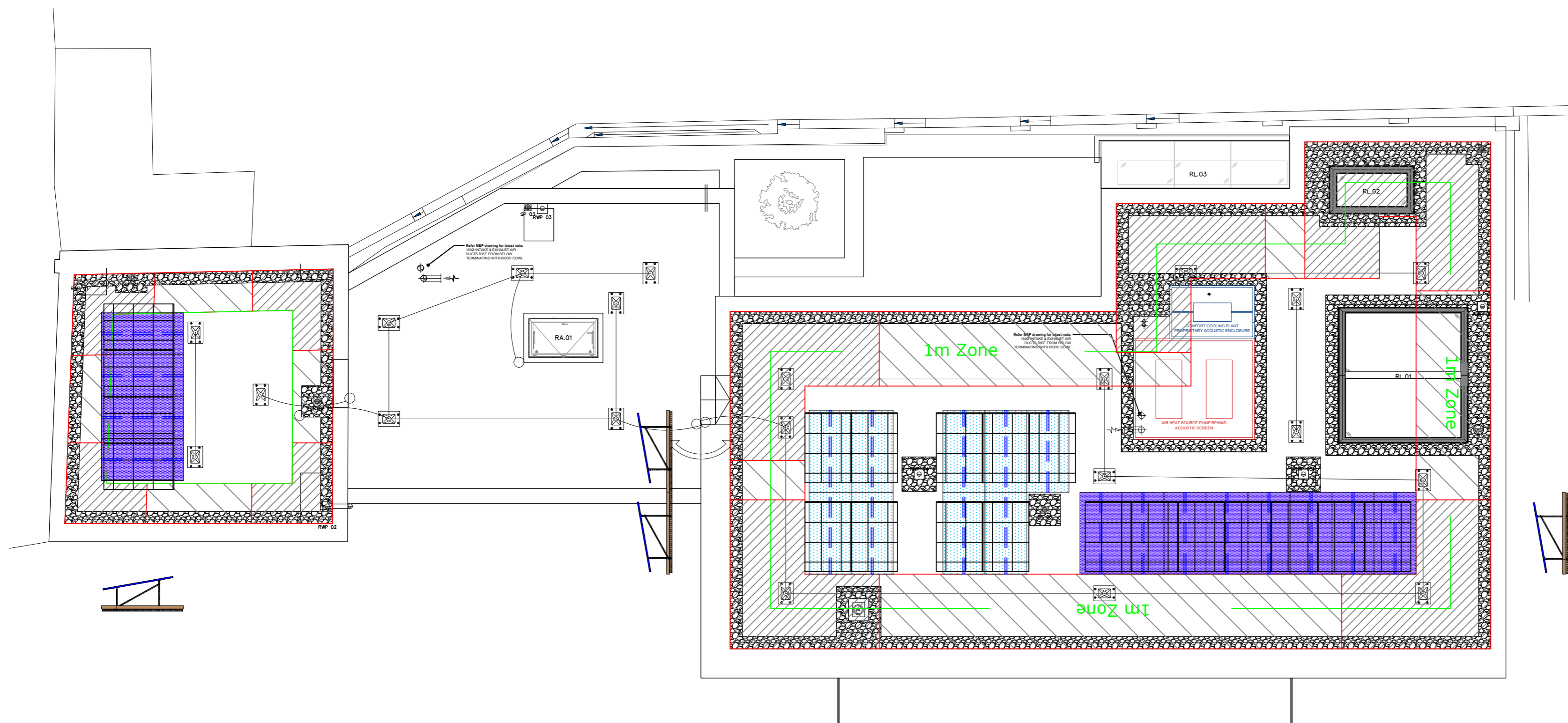

Roof Area Name:	Roof Height:	Membrane Type:	No. Panels:	No. Mounts:	No. Weld Sleeves:	Inverter Type 1: See Note Above *	Inverter Type 2: See Note Above *
Larger Green Roof	8m	BTGRS	16	17	N/A	SOL-8.0-5G-DT-DC x1	-
Smaller Green Roof	8m	BTGRS	4	4	-	-	-
Total Parts Required:	-	-	20	21	N/A		

Required Ballast In Kg/m²:

