

A
607 Elevation A 1:25

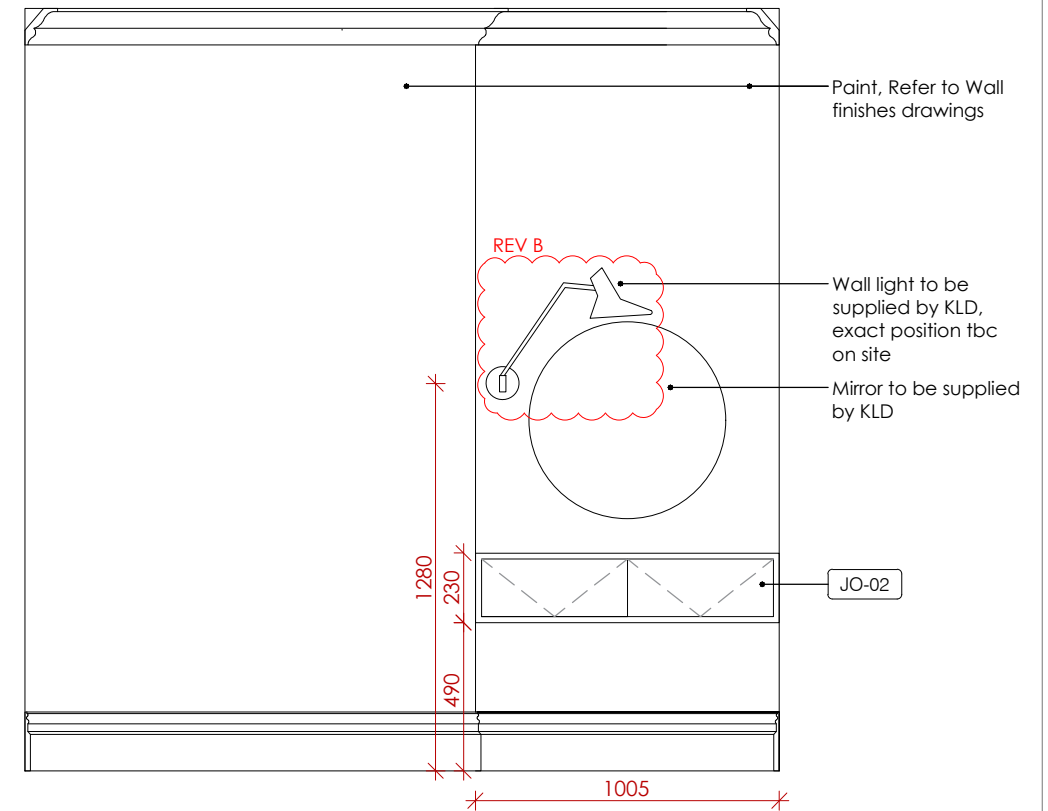

B
607 Elevation B 1:25

JOINERY WARE SPECIFICATION

| | |
|-------|--|
| JO-01 | Headboard as per concept image with upholstered middle section, with 2x bedside drawers on push catch. All in stained oak to match KLD sample. |
| JO-02 | Wall mounted dressing table in stained oak to match KLD sample, with 2x drawers on push catch |

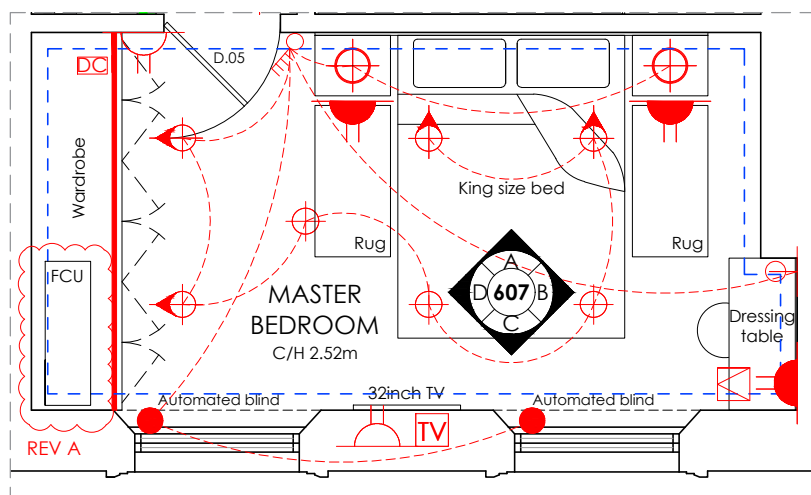

607 Floorplan 1:50

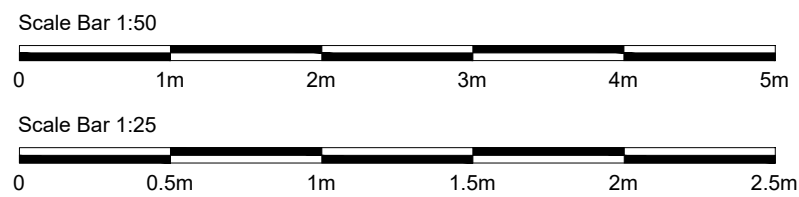

KLD DESIGN INTENT ONLY DRAWING. PLEASE NOTE ALL DIMENSIONS ARE APPROXIMATE AND SUBJECT TO SITE SURVEY.

ALL DRAWINGS ARE SUBJECT TO COST AGREEMENT BEFORE WORKS COMMENCE.



607 Headboard Concept Image NTS

| | | |
|---|--------------------------------------|---------------|
| Rev: | Description: | Date: |
| B | MB Wall light updated and moved | 08/01/25 |
| A | Padded headboard added and FCU added | 13/12/24 |
| Title: Master Bedroom Proposed Elevations | | |
| Kathryn Levitt Design KATHRYN LEVITT DESIGN LTD Goodwin House, 5 Union court, Richmond London, Surrey TW9 1AA Tel 020 8948 1223 e: ideas@kathrynlevittdesign.com | | |
| Client: Ms Elizabeth Owens | | |
| Property Site: Charrington Street | | |
| Job No: 1690 | Drawing No: 607 | Revision: B |
| Scale: 1:50, 1:25@A3 | Date: 25.09.24 | Drawn by: ERB |
| Status: For Discussion | | |
| <small>Dimensions to be verified on site. Figured dimensions to be taken in preference to those scaled. This drawing is the property of Kathryn Levitt Design Ltd. Copyright is reserved by them and the drawing is issued on the condition that it is not copied, reproduced, retained or disclosed to any unauthorised person either wholly or in part without the consent in writing of Kathryn Levitt Design Ltd. Registered in England and Wales No. 4986703 Registered Office 1 Park Road, Hampton Wick, Kingston Upon Thames, Surrey KT1 4AS</small> | | |