

A
653.1 Elevation A 1 : 25

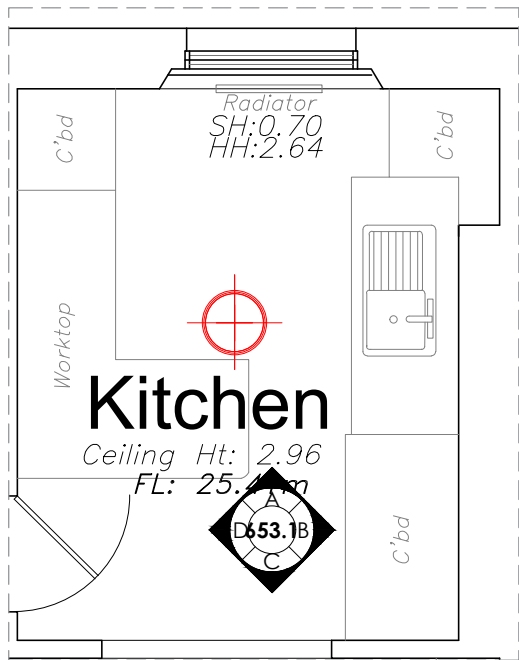

653.1 Floorplan 1 : 50



653.1 Existing Photo NTS

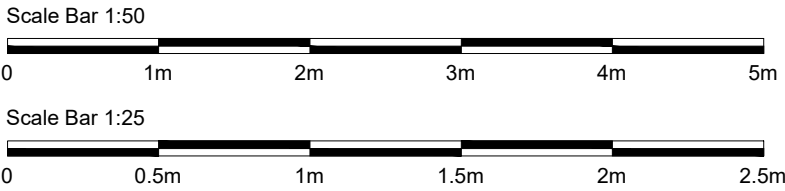

Rev:	Description:	Date:
Title: Kitchen Existing Elevations		
<div><div>Kathryn Levitt Design</div><div>KATHRYN LEVITT DESIGN LTD Goodwin House, 5 Union court, Richmond London, Surrey TW9 1AA Tel 020 8948 1223 e: ideas@kathrynlevittdesign.com</div></div>		
Client: Ms Elizabeth Owens		
Property Site: Charrington Street		
Job No: 1690	Drawing No: 653.1	Revision: 0
Scale: 1:50,1:25 @A3	Date: 25.09.24	Drawn by: ERB
Status: For Discussion		
<small>Dimensions to be verified on site. Figured dimensions to be taken in preference to those scaled This drawing is the property of Kathryn Levitt Design Ltd. Copyright is reserved by them and the drawing is issued on the condition that it is not copied, reproduced, retained or disclosed to any unauthorised person either wholly or in part without the consent in writing of Kathryn Levitt Design Ltd. Registered in England and Wales No. 4986703 Registered Office 1 Park Road, Hampton Wick, Kingston Upon Thames, Surrey KT1 4AS</small>		