

601 Floorplan 1:50

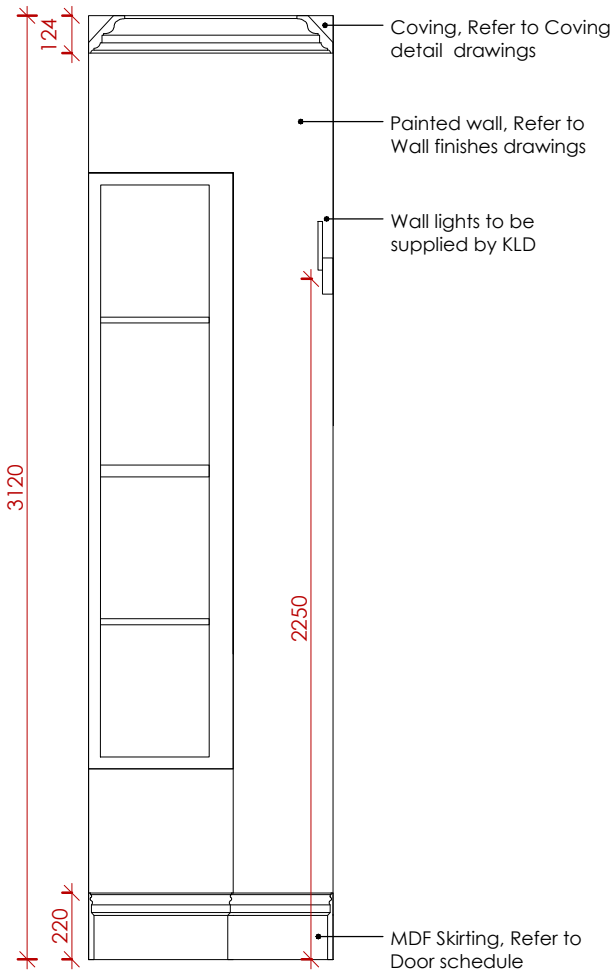

601 A Elevation A 1:25

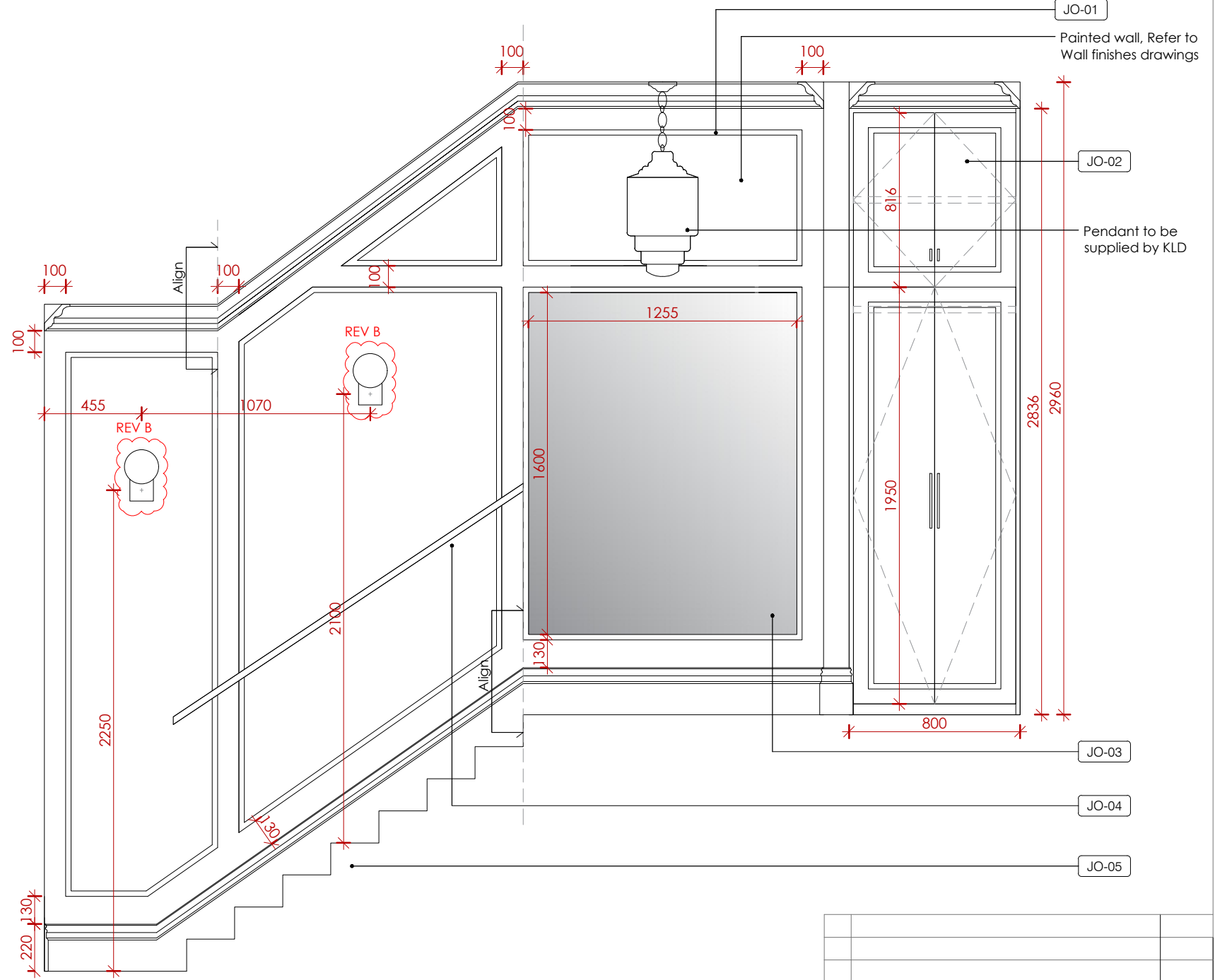

601 B Elevation B 1:25

JOINERY SPECIFICATION

JO-01	Astragal MDF Panel Moulding, Skirting World, Width 25, Thickness 15mm, Painted to match wall colour
JO-02	Coat cupboard with hinged doors with Astragal MDF Panel moulding, width 25, Thickness 15mm. Externals sprayed in matt lacquer to match F&B Banoha No. 298, Internals in XyloClear tbc. Upper unit with 1x internal adjustable shelf, Tall unit with 1x Clothes rail in bronze. Handles - Upper unit - Joseph Giles, CP1149: Rolled & Hammered T-Bar Cabinet Pull with Round Rose in Mid antique brass waxed, Tall unit - Joseph Giles CH1012: Rolled & Hammered Cabinet Handle, 256mm, in Mid antique brass waxed
JO-03	Silver mirror glued to the wall within mouldings, exact dimensions tbc on site

JO-04	New minimal handrail, sprayed in matt lacquer to match F&B Cornforth white No. 228, Estate eggshell
JO-05	Main staircase to be retained. Existing carpet to be removed. Risers, threads and stringers to be made good where necessary and painted in F&B Wevet, Estate Eggshell. Runner as per floor finishes drawing.

KLD DESIGN INTENT ONLY DRAWING. PLEASE NOTE ALL DIMENSIONS ARE APPROXIMATE AND SUBJECT TO SITE SURVEY.

ALL DRAWINGS ARE SUBJECT TO COST AGREEMENT BEFORE WORKS COMMENCE.

Rev:	Description:	Date:
B	Existing fuse box shown, Wall lights updated	08/01/25
A	Window treatment and staircase comment added	13/12/24

Title: First Floor Proposed Entrance and Common Parts Elevations

Kathryn Levitt Design
 KATHRYN LEVITT DESIGN LTD
 Goodwin House, 5 Union court, Richmond
 London, Surrey TW9 1AA
 Tel 020 8948 1223
 e: ideas@kathrynlevittdesign.com

Client: Ms Elizabeth Owens

Property Site: Charrington Street

Job No: 1690 Drawing No: 601 Revision: B

Scale: 1:50, 1:25@A3 Date: 25.09.24 Drawn by: ERB

Status: For Discussion

Dimensions to be verified on site. Figured dimensions to be taken in preference to those scaled
 This drawing is the property of Kathryn Levitt Design Ltd. Copyright is reserved by them and the drawing is issued on the condition that it is not copied, reproduced, retained or disclosed to any unauthorised person either wholly or in part without the consent in writing of Kathryn Levitt Design Ltd.
 Registered in England and Wales No. 4986703
 Registered Office 1 Park Road, Hampton Wick, Kingston Upon Thames, Surrey KT1 4AS