

EXISTING SECTION 1.100

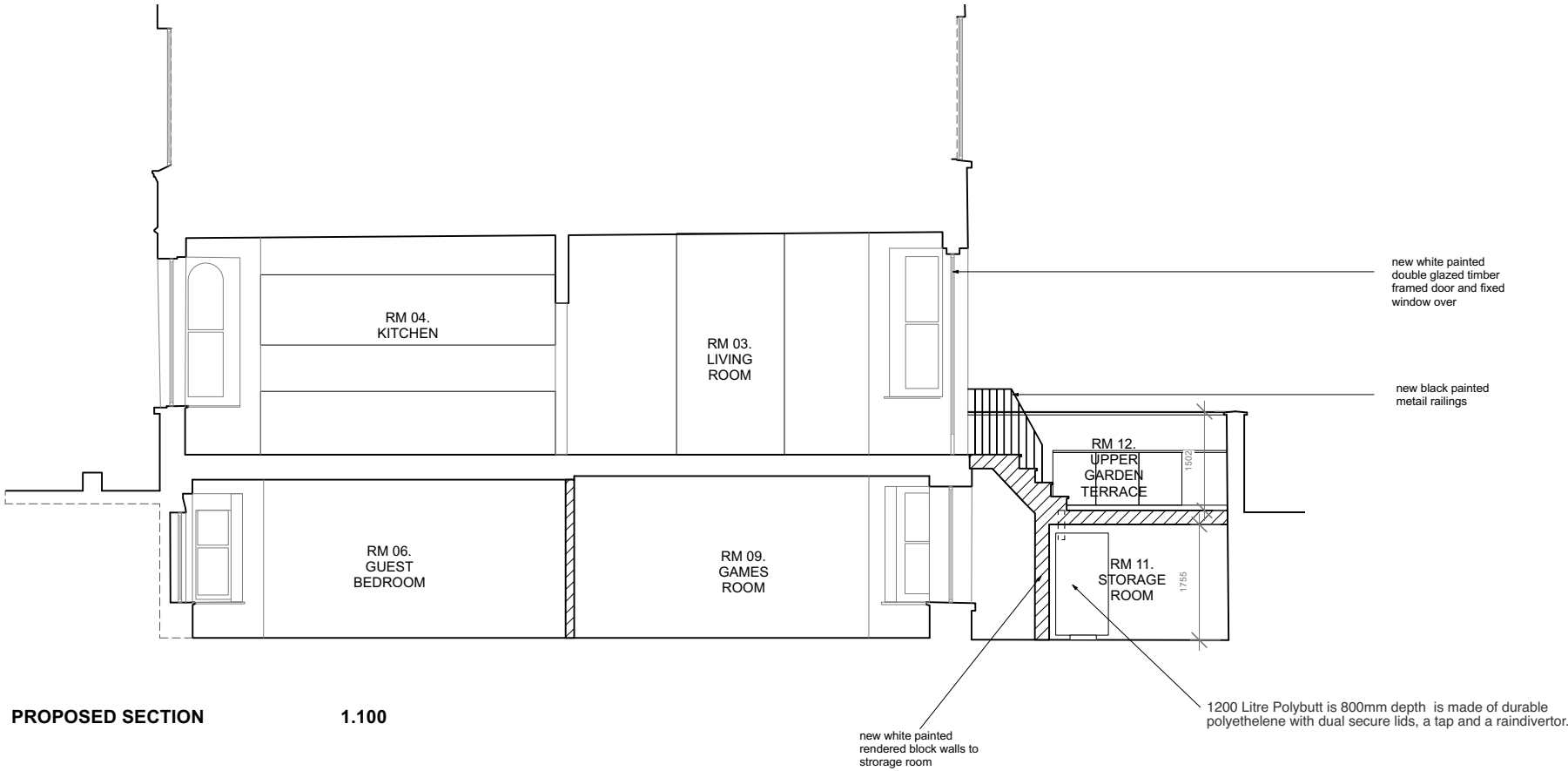

PROPOSED SECTION 1.100



ISSUE:	DATE:	COMMENT:
B	JANUARY 2025	ISSUE FOR PLANNING
A	OCTOBER 2024	ISSUE FOR CONCEPT FEASIBILITY
-	JULY 2024	ISSUE FOR CONCEPT FEASIBILITY

CALLENDER
HOWORTH
INTERIOR & ARCHITECTURAL DESIGN

Studio: +44 (0) 20 7336 8560 www.callenderhoworth.com

Job no. 1273	Job title 74, Fairhazel Gardens, London, Camden, NW6 3SR		
Drawing no. 301	Drawing title EXISTING & PROPOSED SECTION		
Scale 1:100	Size A3	Drawn ML	Revision B

All works to be in accordance with relevant standards, British building codes, and other relevant codes, and with manufacturers recommendations and instructions. All dimensions to be checked on site. Do not scale from this drawing.