

Notes

Site Boundary

01 Proposed flat roof ADV  
1m<sup>2</sup> clear opening area

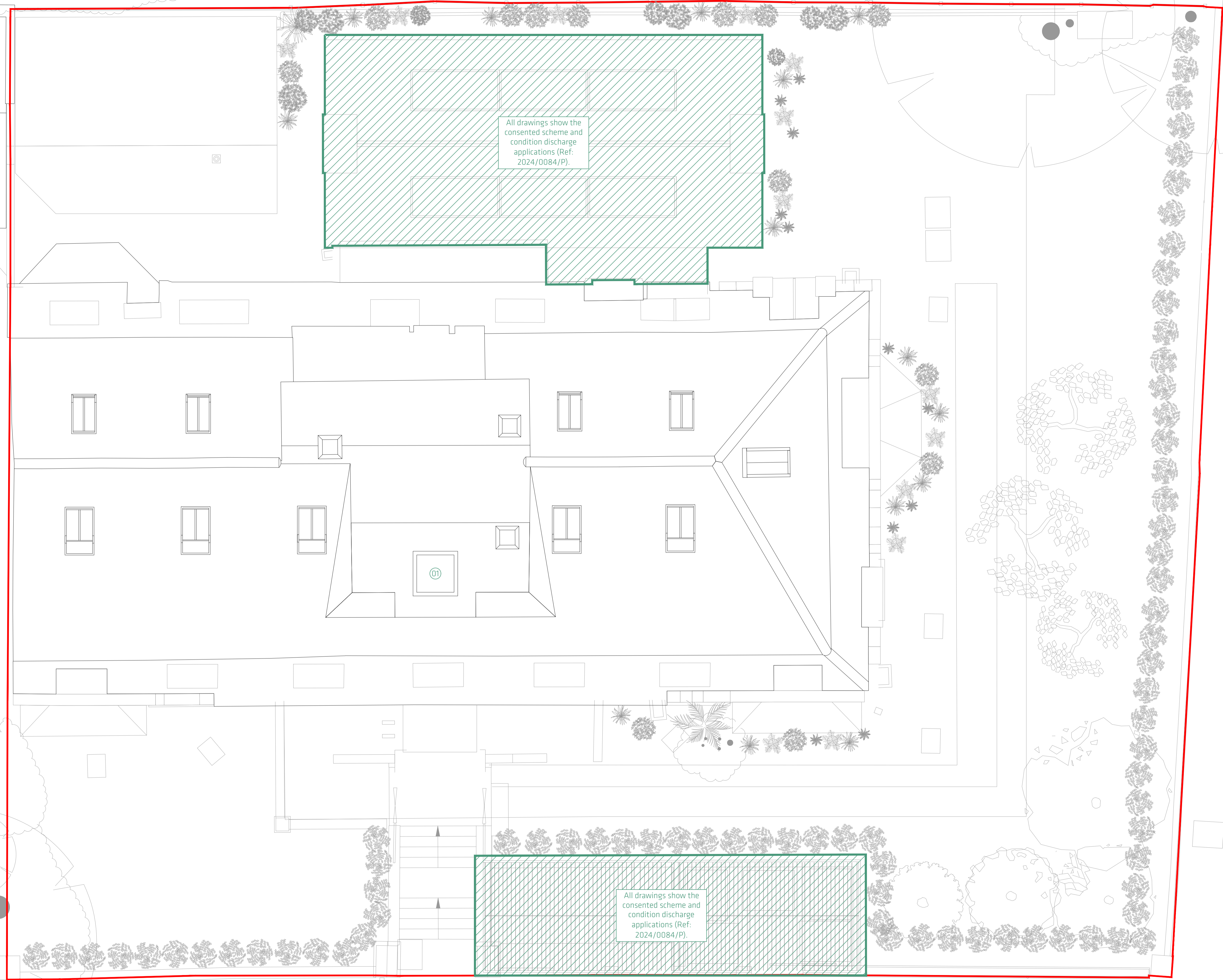

All drawings show the  
consented scheme and  
condition discharge  
applications (Ref:  
2024/0084/P).

All drawings show the  
consented scheme and  
condition discharge  
applications (Ref:  
2024/0084/P).

- 1. Do not scale this drawing.
- 2. For structural dimensions and details see Structural Engineers drawings.
- 3. All dimensions to be checked on site prior to commencement of any works or preparation of any shop drawings.
- 4. All errors in co-ordinates, levels and dimensions, are to be reported to the Architect.
- 5. All temporary works to be responsibility of the contractor.
- 6. This drawing to be read in conjunction with all relevant Architect's drawings and specifications and with other Consultant's information.

Revision	Date	Description	Revision	Date	Description
01	18.10.24	Issued for Planning			
02	18.10.24	Issued for Planning			

**new-works**  
Cocoa 406, The Biscuit Factory, SE16 4DG  
020 7318 8187 studio@new-works.net  
new-works.net  
© New Works (Architecture) Ltd

PROJECT	Orman Court		
TITLE	Proposed Roof Plan		
DWG No.	1915 (PL)472	REVISION	02
DATE	13.10.24	SCALE	1:500(A1)

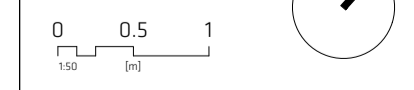

R