

Strip Out Key

- ALT-111 Removal of Internal Non-Structural Masonry Walls
- ALT-112 Removal of Internal PVC Walls
- ALT-113 Removal of Internal Plasterboard Partition
- ALT-114 Removal of Internal Plasterboard Skings to Solid Walls
- ALT-115 Removal of Internal Wall Linings to Concealed Fireplace/Chimney breast
- ALT-116 Removal of Non-Thermally-Breaking Secondary Glazing
- ALT-117 Removal of Internal Doorsets
- ALT-118 Removal of Wall Access Panels
- ALT-119 Removal of Wall Panels
- ALT-120 Removal of Wall Access Panels
- ALT-121 Removal of Kitchen Filtrage
- ALT-122 Removal of Kitchen Filtrage
- ALT-123 Removal of Kitchen Filtrage
- ALT-124 Removal of Kitchen Filtrage
- ALT-125 Removal of Kitchen Filtrage
- ALT-126 Removal of Kitchen Filtrage
- ALT-127 Removal of Kitchen Filtrage
- ALT-128 Removal of Kitchen Filtrage
- ALT-129 Removal of Kitchen Filtrage
- ALT-130 Removal of Kitchen Filtrage
- ALT-131 Removal of Kitchen Filtrage
- ALT-132 Removal of Kitchen Filtrage
- ALT-133 Removal of Kitchen Filtrage
- ALT-134 Removal of Kitchen Filtrage
- ALT-135 Removal of Kitchen Filtrage
- ALT-136 Removal of Kitchen Filtrage
- ALT-137 Removal of Kitchen Filtrage
- ALT-138 Removal of Kitchen Filtrage
- ALT-139 Removal of Kitchen Filtrage
- ALT-140 Removal of Kitchen Filtrage
- ALT-141 Removal of Kitchen Filtrage
- ALT-142 Removal of Kitchen Filtrage
- ALT-143 Removal of Kitchen Filtrage
- ALT-144 Removal of Kitchen Filtrage
- ALT-145 Removal of Kitchen Filtrage
- ALT-146 Removal of Kitchen Filtrage
- ALT-147 Removal of Kitchen Filtrage
- ALT-148 Removal of Kitchen Filtrage
- ALT-149 Removal of Kitchen Filtrage
- ALT-150 Removal of Kitchen Filtrage
- ALT-151 Removal of Kitchen Filtrage
- ALT-152 Removal of Kitchen Filtrage
- ALT-153 Removal of Kitchen Filtrage
- ALT-154 Removal of Kitchen Filtrage
- ALT-155 Removal of Kitchen Filtrage
- ALT-156 Removal of Kitchen Filtrage
- ALT-157 Removal of Kitchen Filtrage
- ALT-158 Removal of Kitchen Filtrage
- ALT-159 Removal of Kitchen Filtrage
- ALT-160 Removal of Kitchen Filtrage
- ALT-161 Removal of Kitchen Filtrage
- ALT-162 Removal of Kitchen Filtrage
- ALT-163 Removal of Kitchen Filtrage
- ALT-164 Removal of Kitchen Filtrage
- ALT-165 Removal of Kitchen Filtrage
- ALT-166 Removal of Kitchen Filtrage
- ALT-167 Removal of Kitchen Filtrage
- ALT-168 Removal of Kitchen Filtrage
- ALT-169 Removal of Kitchen Filtrage
- ALT-170 Removal of Kitchen Filtrage
- ALT-171 Removal of Kitchen Filtrage
- ALT-172 Removal of Kitchen Filtrage
- ALT-173 Removal of Kitchen Filtrage
- ALT-174 Removal of Kitchen Filtrage
- ALT-175 Removal of Kitchen Filtrage
- ALT-176 Removal of Kitchen Filtrage
- ALT-177 Removal of Kitchen Filtrage
- ALT-178 Removal of Kitchen Filtrage
- ALT-179 Removal of Kitchen Filtrage
- ALT-180 Removal of Kitchen Filtrage
- ALT-181 Removal of Kitchen Filtrage
- ALT-182 Removal of Kitchen Filtrage
- ALT-183 Removal of Kitchen Filtrage
- ALT-184 Removal of Kitchen Filtrage
- ALT-185 Removal of Kitchen Filtrage
- ALT-186 Removal of Kitchen Filtrage
- ALT-187 Removal of Kitchen Filtrage
- ALT-188 Removal of Kitchen Filtrage
- ALT-189 Removal of Kitchen Filtrage
- ALT-190 Removal of Kitchen Filtrage
- ALT-191 Removal of Kitchen Filtrage
- ALT-192 Removal of Kitchen Filtrage
- ALT-193 Removal of Kitchen Filtrage
- ALT-194 Removal of Kitchen Filtrage
- ALT-195 Removal of Kitchen Filtrage
- ALT-196 Removal of Kitchen Filtrage
- ALT-197 Removal of Kitchen Filtrage
- ALT-198 Removal of Kitchen Filtrage
- ALT-199 Removal of Kitchen Filtrage
- ALT-200 Removal of Kitchen Filtrage

- Existing wall/structure to remain
 - Not in Scope
 - Area in Scope
- Elements to Retain:**
- Retain all wall mouldings, chair rails
 - Retain ceiling cornice where there are non-vented beams or walls
 - Retain sash and glazing ceiling
 - Temporary retain structures, until sign off
- Demolition and Strip-Out Risk Elimination Notes:**
- Unprotected Void:**
- Guarding to all service voids and lift doors to be provided by the contractor.
 - At least one of the lift shafts remain operational during the whole of strip out period for occupants.
- Information Provided for Hazard Control:**
- Strip out drawings showing clear locations assumed from archive drawings.
- Fall From Height:**
- Design measures taken to reduce / eliminate risk
 - Temporary guarding to all unprotected roof edges required
- Information Provided for Hazard Control:**
- Strip out drawings identify unprotected roof edges.
- Fire Escape:**
- Strip out drawings identify escape route to be maintained at all times.
- Operational Precautions:**
- Design measures taken to reduce / eliminate risk
 - Services to be retained / power supplies to be maintained to be identified prior to strip out
- Information Provided for Hazard Control:**
- Lift will remain operational during the whole of the strip out period.
- Asbestos:**
- Design measures taken to reduce / eliminate risk
 - Management Asbestos Survey information issued with tender.
 - Management Asbestos Survey to be carried out by strip out contractor prior to any work.
 - Management Asbestos Survey results available prior to works commencing.
- Notes:**
- All existing windows to be retained and protected during works.
 - See fire Services Engineers Scope, Drawings and Specifications for services strip out.
 - Read in conjunction with BHP's Site Inspection Report
 - Refer to the Structural Engineer prior to removing any masonry walls
 - Ensure gas and lift cores fire compartmentation is maintained throughout works.
 - Specialist contractor to assess perimeter walls mould moisture
 - All existing windows to be retained and to be protected during works
 - To be read in conjunction with JRA specifications
 - To be read in conjunction with Structural Engineers information and requirements



This document and its design content is © John Robertson Architects Ltd. It shall remain in copyright with all other associated project information including models, specifications, schedules and related consultants documents. Do not scale from documents. All dimensions to be checked on site. Immediately report any discrepancies, errors or omissions on this document to the Originator. If in doubt ASK.

Rev Date Dwn Chk Description
 P01 24/01/2023 SY LM Block F-H Strip Out Pack

Rev Date Dwn Chk Description

Rev Date Dwn Chk Description

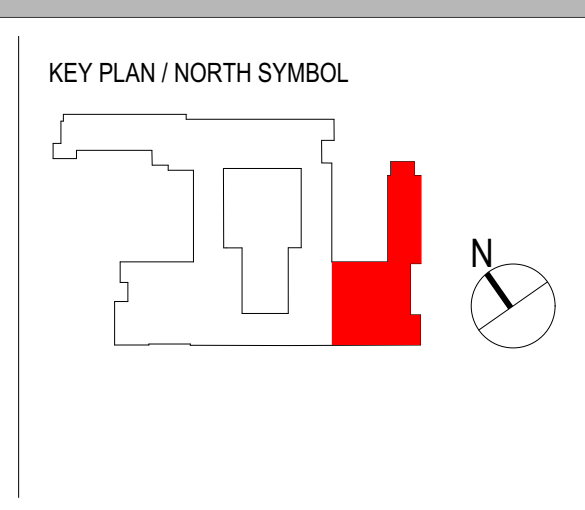

JRA
 John Robertson Architects
 111 Southwark Street,
 London, SE1 1UF
 02076335100
 www.jra.co.uk
 enquiries@jra.co.uk

Project
Tavistock House V32-V35
 London

Client
British Medical Association
 BMA House, Tavistock Square London
 WC1H 9EP United Kingdom
 0200 123 1233
 bma@bma.org.uk

Drawing Title
Basement Strip Out Plan

Scale 1:100 @ A0 Internal Project No. 1998

Dwg No. **1998-JRA-32-BF-DR-A-0549**

Suitability S2

Revision FOR INFORMATION

P01

Source File: BMA001_STB0027 - BMA House - Revs for Architect 27/11/2018 - BMA House 1998_BMA-02-ZZ-M2-A-001_BMA House Team Model_WORKSTREAM