

# STUDIO 309

E: info@studio309.co.uk

Studio 309 Ltd is a company registered in England and Wales (Company no. 15747917).

Registered Office Address: First Floor Office, 3 Hornton Place, London, W8 4LZ

**THIS DRAWING IS NOT TO BE USED FOR CONSTRUCTION.**

NB: This drawing is for illustrative purposes only and all details are TBC subject to confirmation by door manufacturer. Further detail to be submitted as part of application 2024/5053/NEW or by future submission for discharge of condition(s).

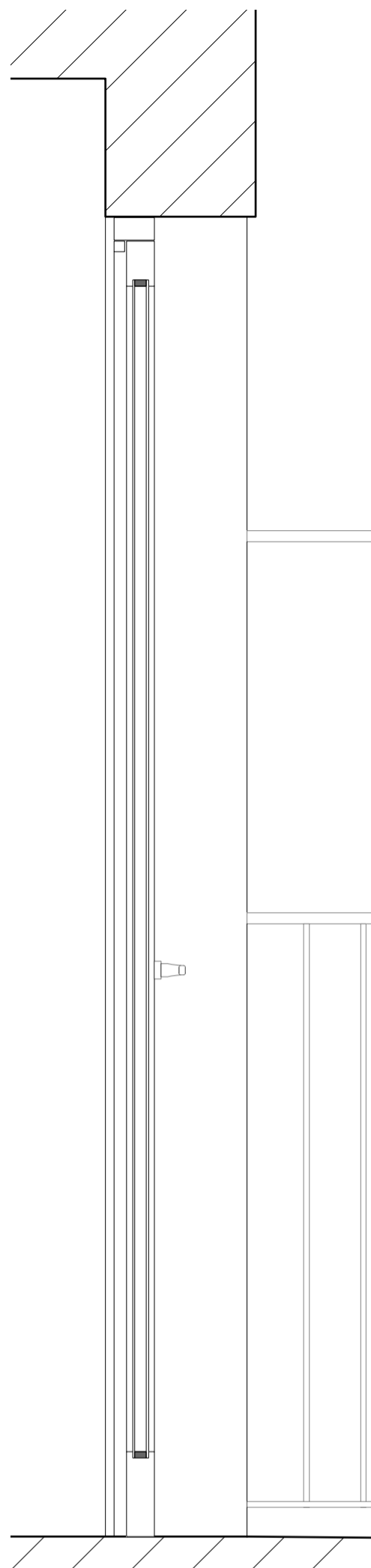
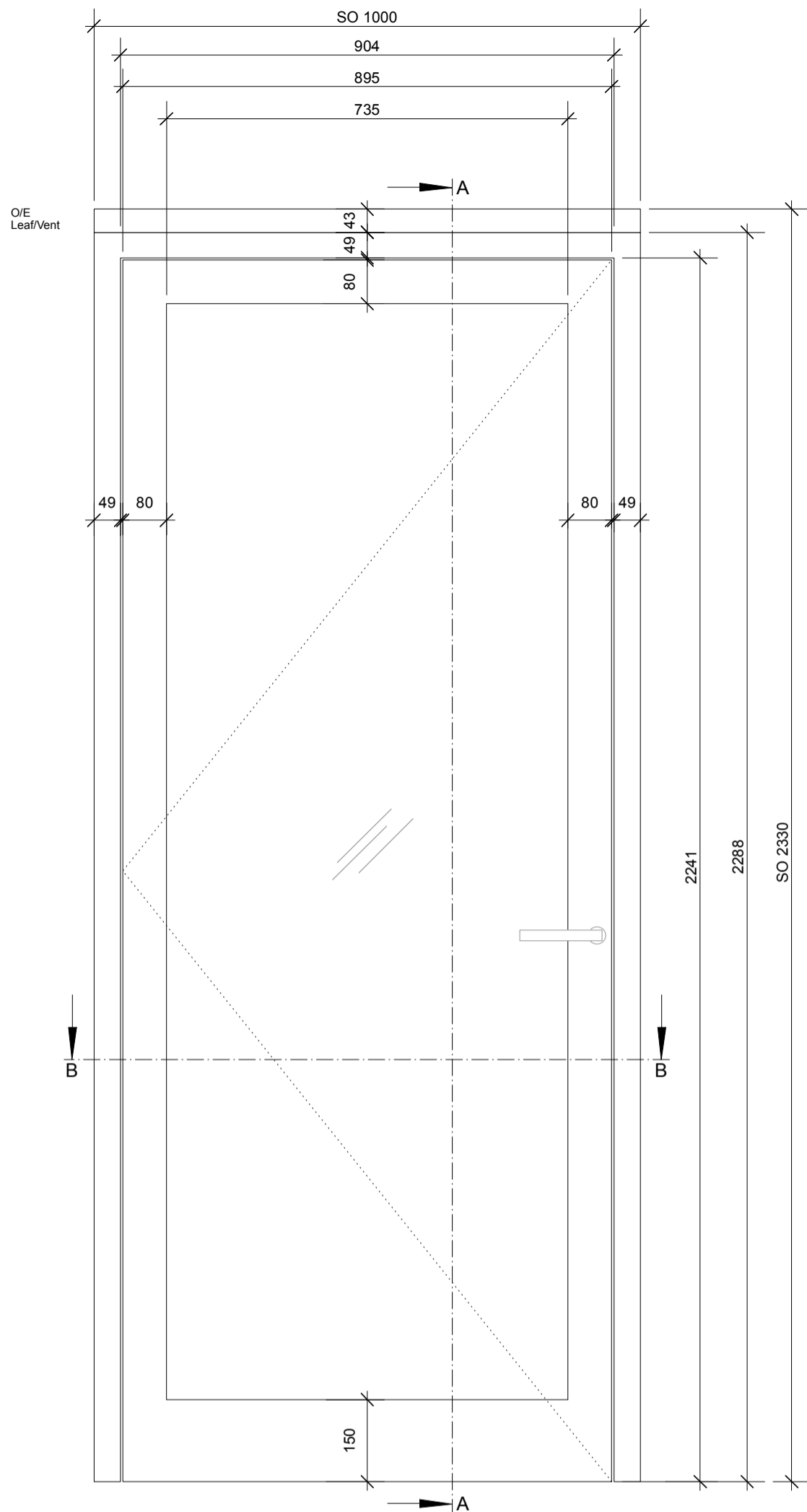

1 EXTERNAL ELEVATION  
Scale: 1:10

2 SECTION A-A  
Scale: 1:10

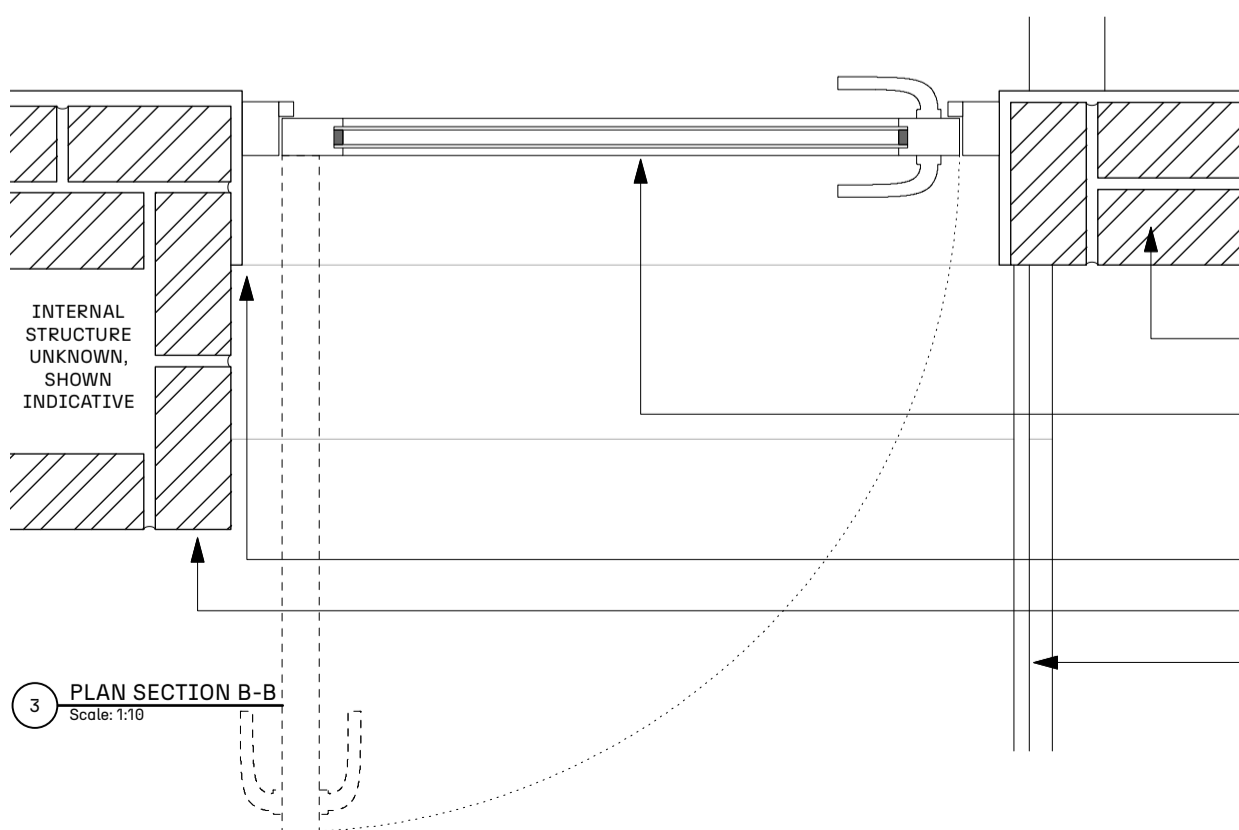

3 PLAN SECTION B-B  
Scale: 1:10

- SOLID BRICKWORK WALLS TO MAIN HOUSE WITH RENDERED REVEAL TO DOOR OPENING
- NEW TIMBER DOOR TO MANUFACTURER'S DETAIL. TIMBER FRAME PAINED WHITE WITH DOUBLE GLAZED PANEL. INDICATIVE DETAIL AND DIMENSIONS SHOWN.
- RENDERED REVEAL
- FAIRFACED BRICKWORK CHIMNEY
- NEW METAL RAILING

**PROJECT ADDRESS:**  
161 ARLINGTON ROAD  
LONDON  
NW1 7ET

**DRAWING REF:**  
001C-050

**DRAWING NAME:**  
PROPOSED  
FIRST  
FLOOR DOOR  
DETAIL

**DRAWING INFO:**  
DATE 24.01.2025  
PAGE SIZE A3  
SCALE 1:10  
REV A

**REVISION INFO:**  
24.01.2025  
Rev.A Issued for Comment  
29.01.2025  
Rev.A Issued for Planning

This drawing is distributed under copyright and must not be reproduced or copied without the written permission of Studio 309 Ltd. All dimensions, areas, and levels are approximate and to be confirmed on site. This drawing is not to be used for the purpose of calculating areas for valuation.