

If the centre of the neighbour's window lies on the extension side of both of the 45° lines (on plan and elevation), then the more detailed BRE tests are required. Otherwise, daylight and sunlight levels are unlikely to be adversely affected because light will continue to be received either over the roof, or beyond the end of the extension.

45 degree test

The 45° test is used to check extensions that are perpendicular to a window - as in the example below.

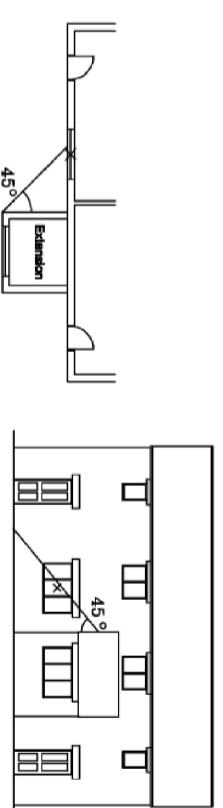

REAR ELEVATION

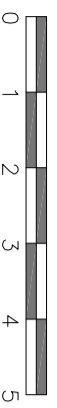

Drawings and calculations are to be approved by Building Control prior to the commencement of any work. No responsibility will be taken by the design team without the written approval by the Local Authority or an approved Inspector.

TITLE	PROPOSED DRAWINGS	ADDRESS	LOWER GROUND FLOOR FLAT 24 WINCHESTER ROAD, NW3 3NT
CLIENT	Mr. J. WOOLLEY	SCALE	1:100 @ A3
		DRAWING NO.	241215/08
		DATE	DEC 2024
		REV.	