

1 GF BALUSTRADE - PLAN RHS & LHS
6015 1:20 @ A1

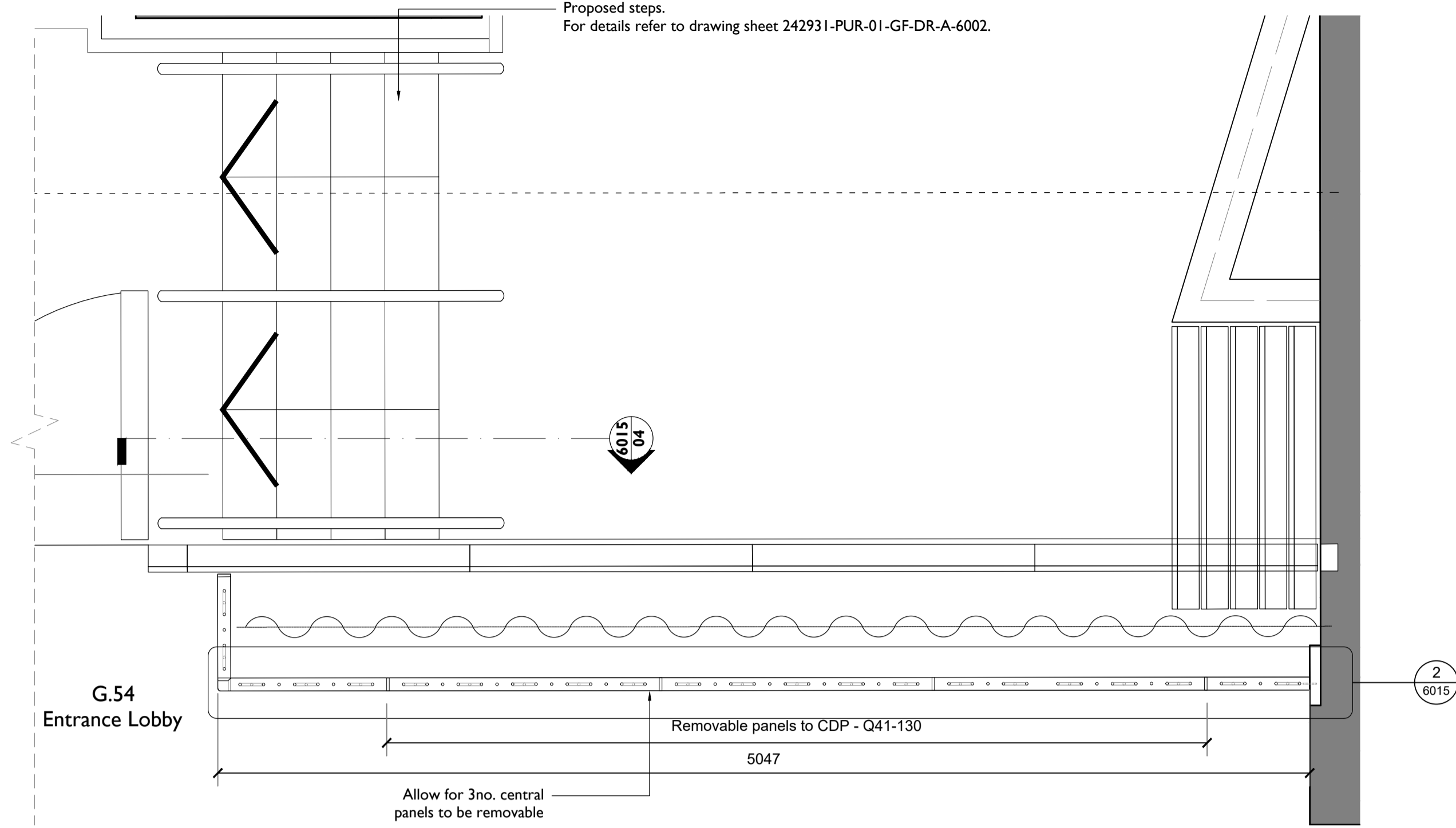

2 GF BALUSTRADE - PLAN LHS & RHS
6015 1:20 @ A1

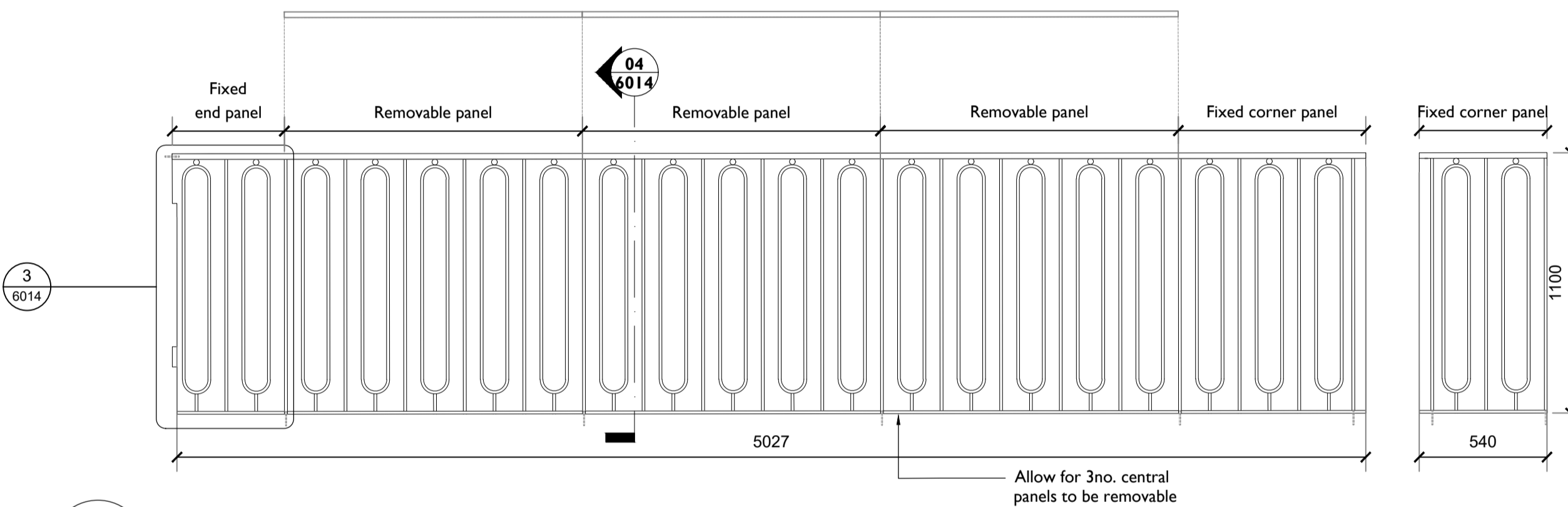

3 GF BALUSTRADE - ELEVATION RHS & LHS
6015 1:20 @ A1

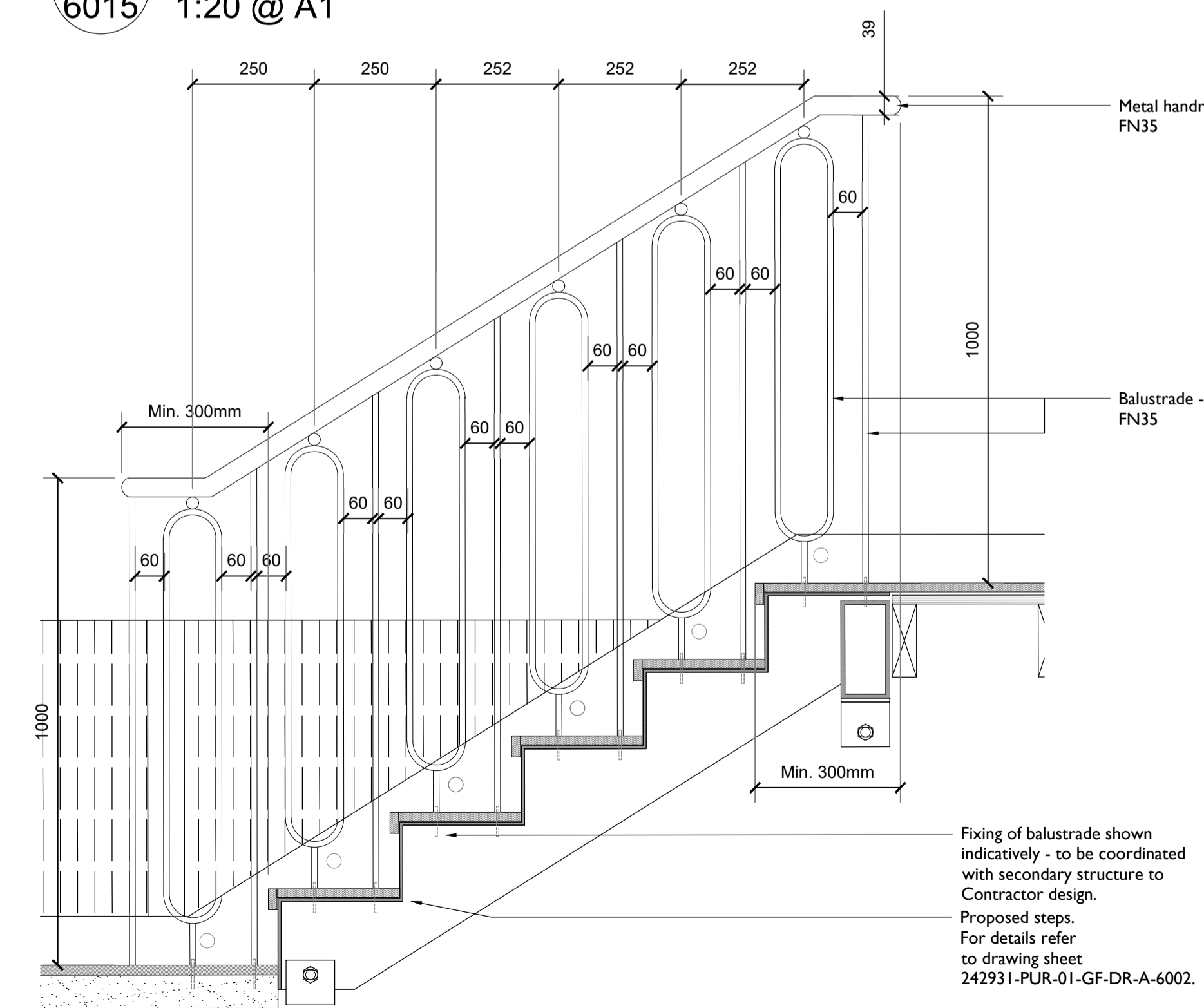
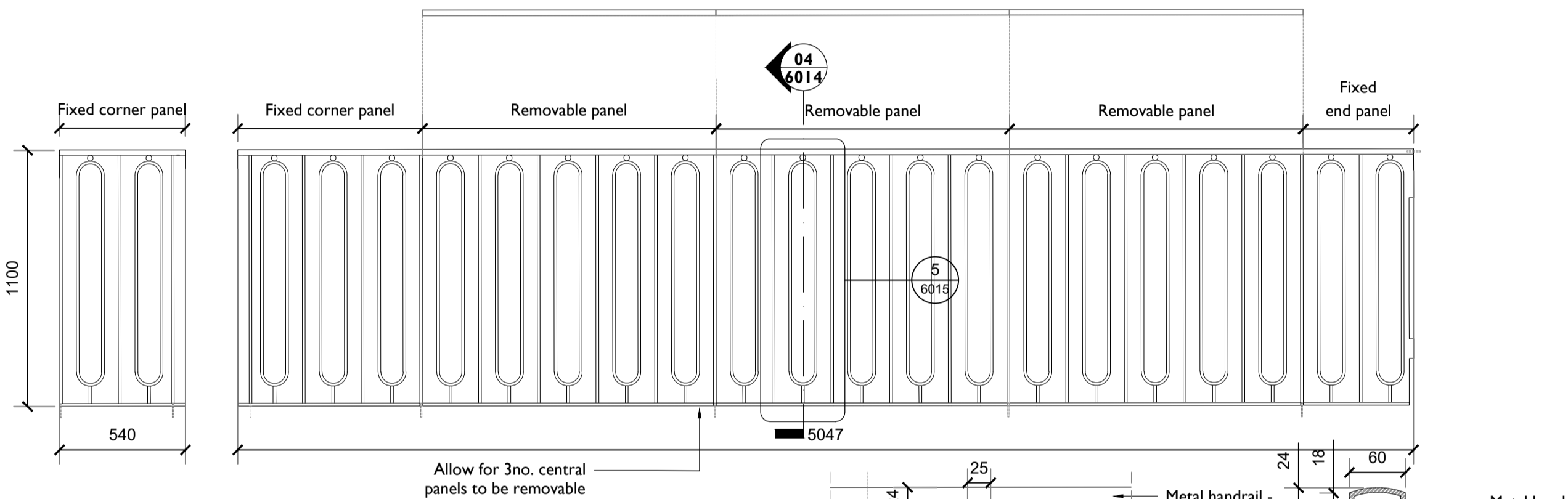

4 GF BALUSTRADE - SIDE ELEVATION
6015 1:10 @ A1

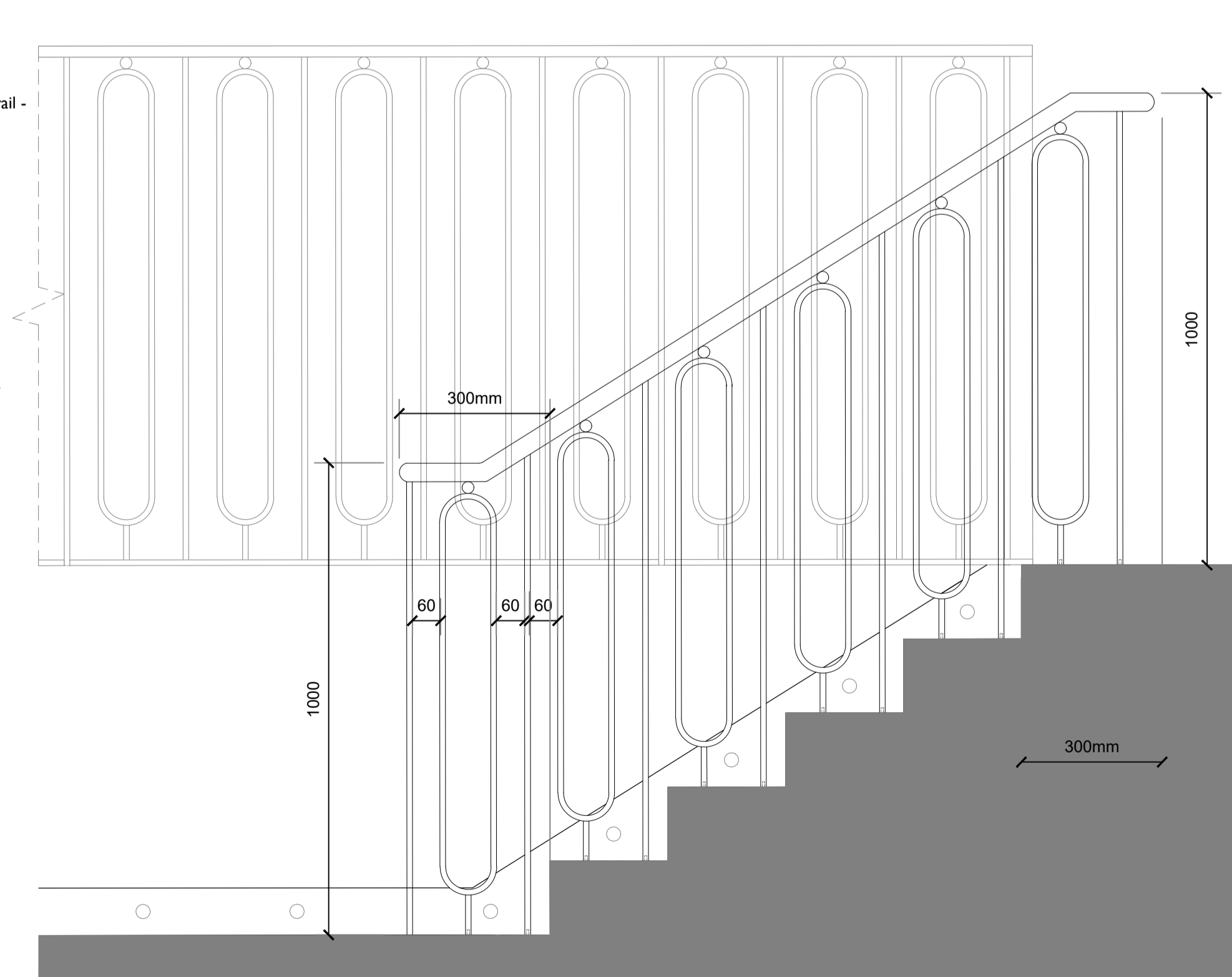

5 GF BALUSTRADE - SIDE ELEVATION
6015 1:10 @ A1

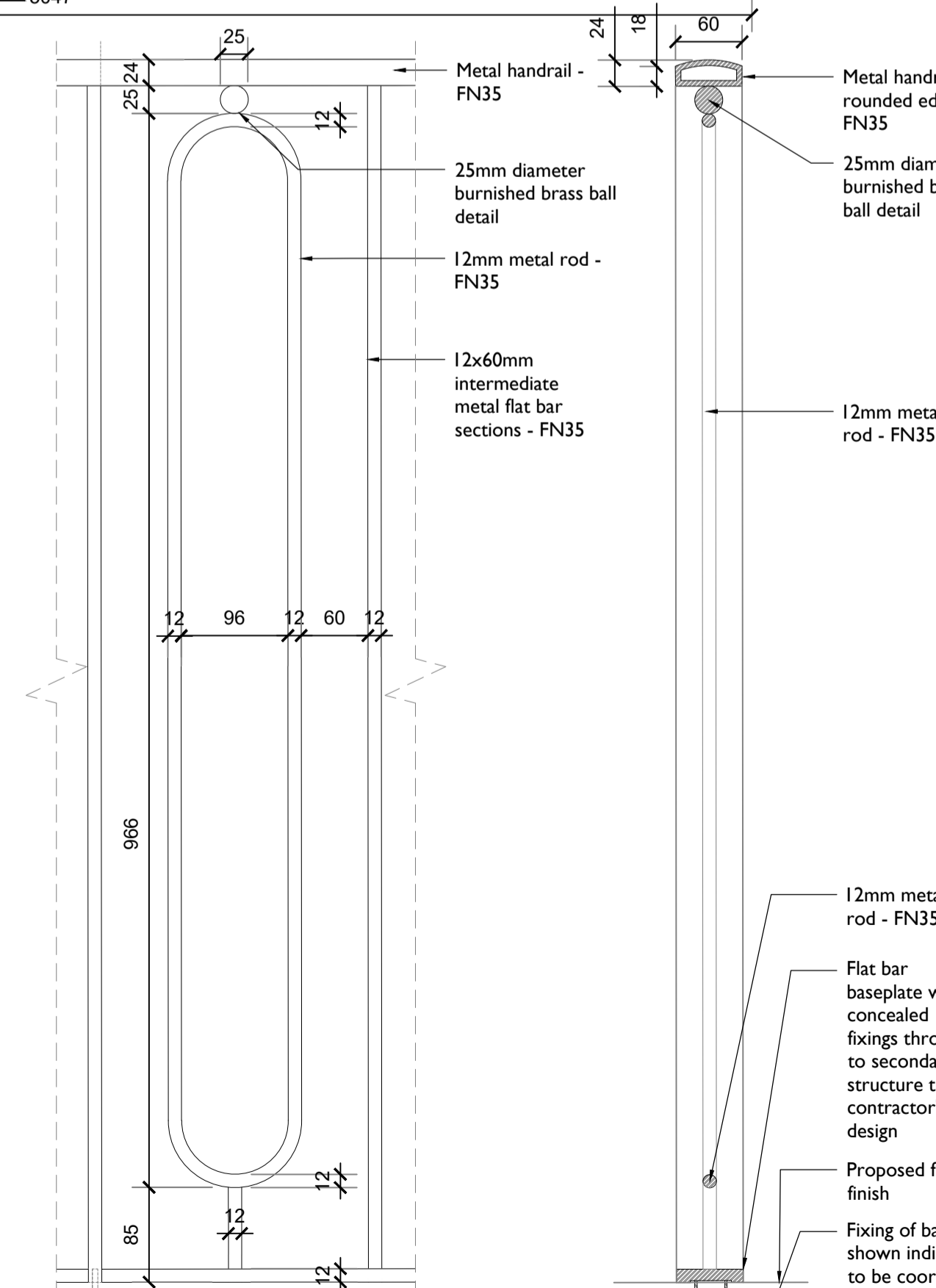

6 ELEVATION DETAIL
6015 1:5 @ A1

Notes:
Drawings are based on survey data and may not accurately represent what is physically present.
Do not scale from this drawing. All dimensions are to be verified on site before proceeding with the work.
All dimensions are in millimetres unless noted otherwise.
Purcell shall be notified in writing of any discrepancies.
All digital Information within this DWG format file is the copyright of Purcell Architecture Limited and is for information purposes only. No digital information may be reused or reproduced by any party for any purpose without written permission.

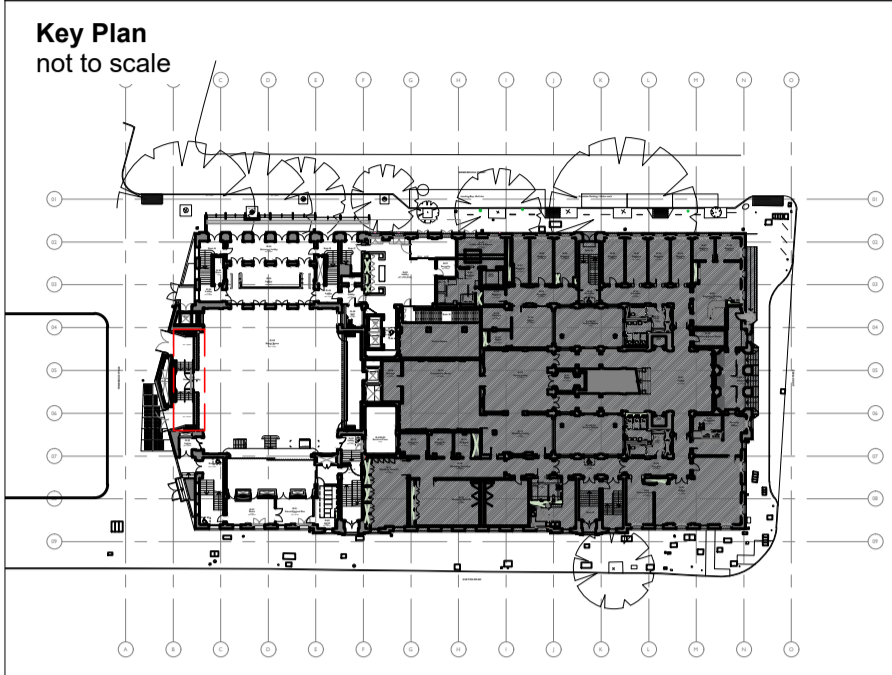

Notes:
This drawing captures design intent only. All dimensions are to be checked on site and manufacturer's drawings and loading calculations are to be submitted for approval prior to construction. Metal & glazed railings and fixings to be designed to meet the loading, deflection and impact requirements set out in BS6180:2011 for installation in 'Areas susceptible to overcrowding - assembly areas'

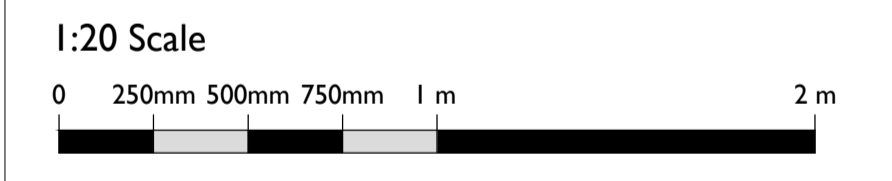
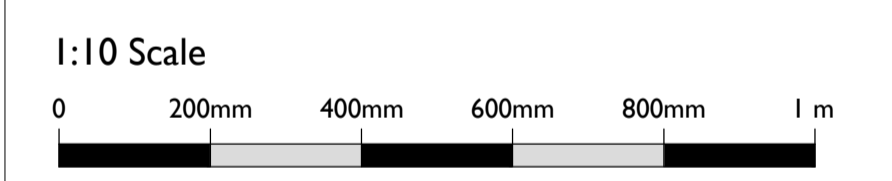

C01	30.08.2024	SM	OB	Client design update
REV	DATE	BY	CHK	DESCRIPTION

CLIENT
Il Bottaccio

PROJECT
Camden Town Hall Tenant Fitout

JOB NUMBER
242931

PURCELL

TITLE
DETAIL - Camden Centre Balustrade

SIZE
A1L

SCALE
As Indicated

REV
SUITABILITY/REASON FOR ISSUE
Work in Progress

DRAWING NUMBER
242931-PUR-01-XX-DR-A-6015

PURCELL IS THE REGISTERED TRADE NAME FOR PURCELL ARCHITECTURE LTD AND ALL SUBSIDIARY COMPANIES AND IS REGISTERED IN THE UNITED KINGDOM, EUROPEAN UNION, HONG KONG, CHINA AND AUSTRALIA.
© PURCELL 2024 www.purcell.com