

SCREEN 02

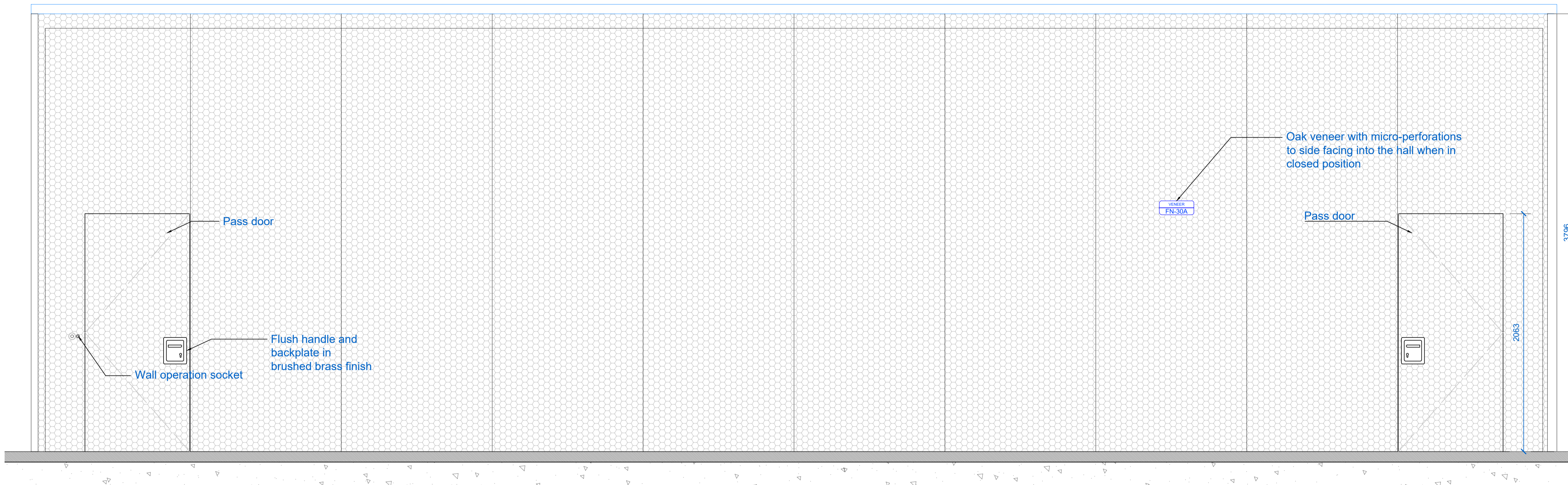

1 EVENT SPACE FOLDING PARTITION ELEVATION  
6005 1:20

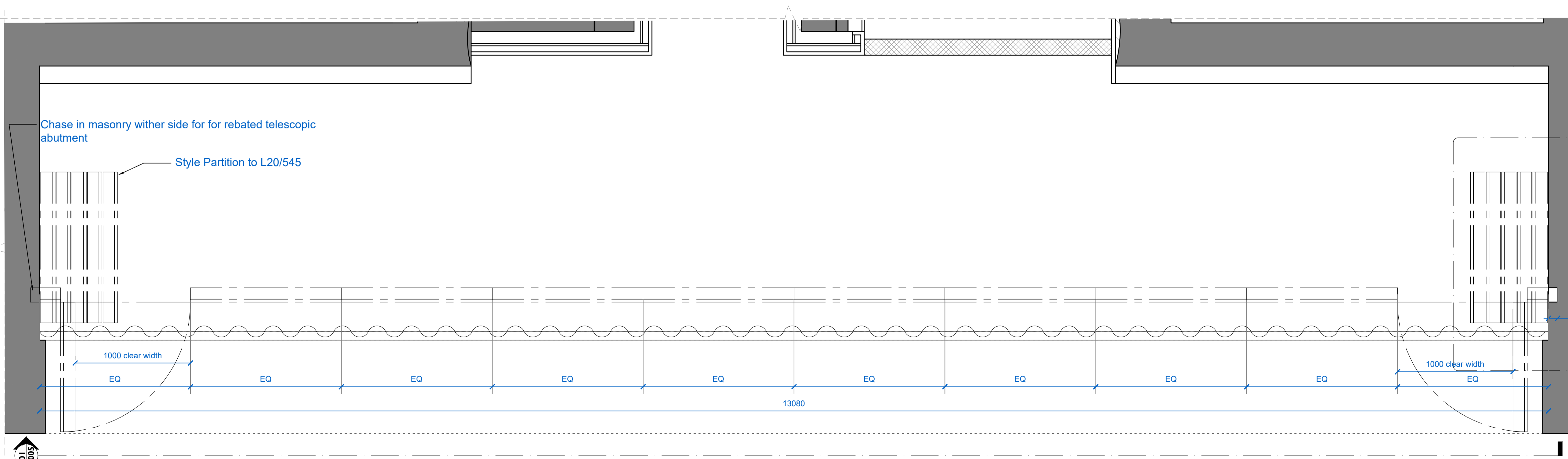

2 EVENT SPACE FOLDING PARTITION PLAN  
6005 1:20

**Notes:**  
 Drawings are based on survey data and may not accurately represent what is physically present.  
 Do not scale from this drawing. All dimensions are to be verified on site before proceeding with the work.  
 All dimensions are in millimetres unless noted otherwise.  
 Purcell shall be notified in writing of any discrepancies.

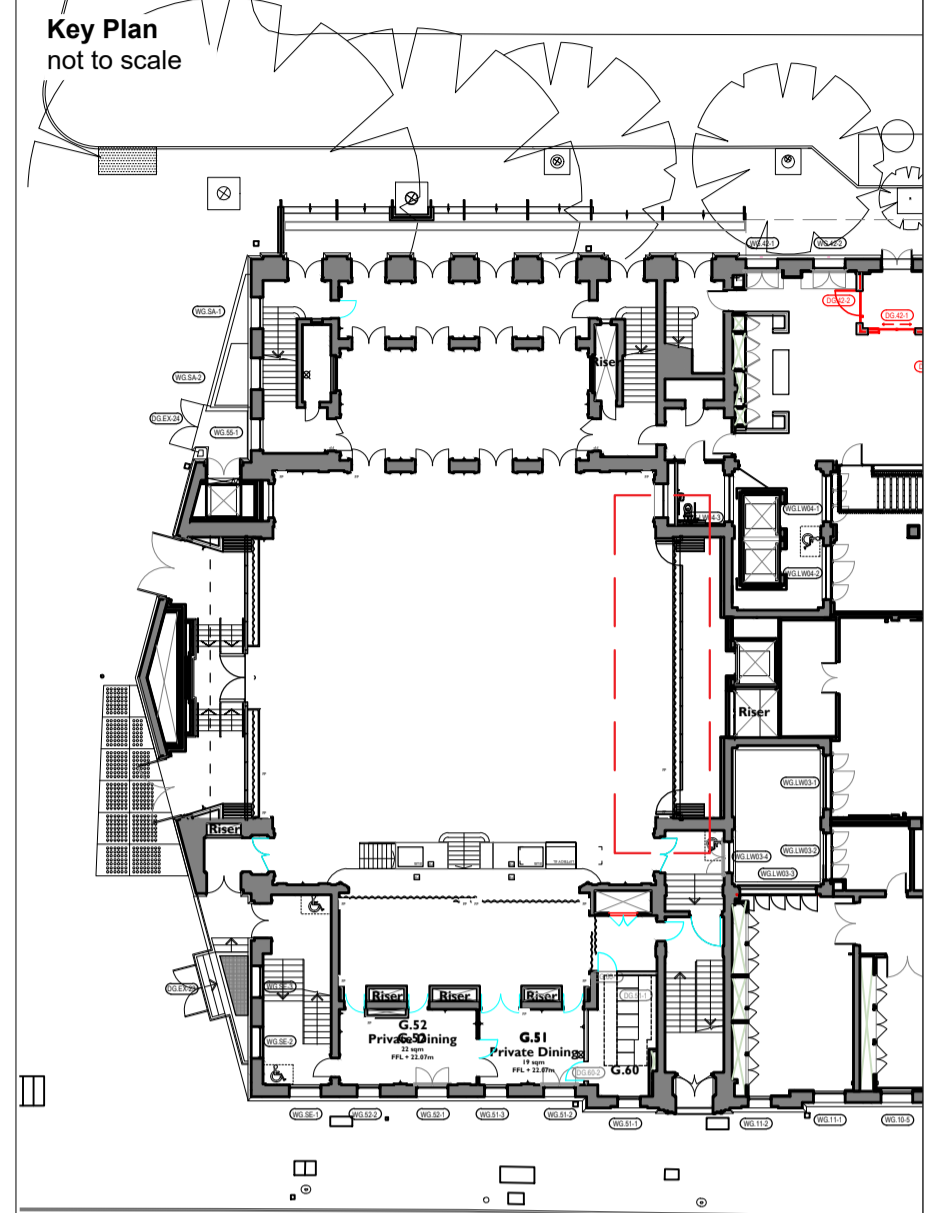

REV	DATE	BY	CHK	DESCRIPTION
C02	30.08.24	OB	OB	UPDATED FOR SIDE ACCESS DOORS
C01	14.06.24	ML	NS	STAGE 4 ISSUE

CLIENT  
**Il Bottaccio**  
 PROJECT  
**Camden Town Hall Tenant Fitout**  
 JOB NUMBER  
**242931**

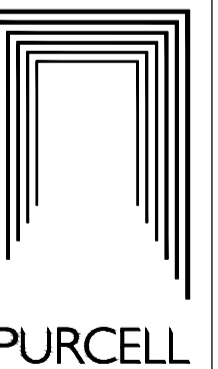

TITLE  
**EVENT SPACE MOVABLE PARTITION GA PLAN**

SIZE SCALE  
 A1L 1:20

REV SUITABILITY/REASON FOR ISSUE  
**C02 A4 - Technical Design Approved**

DRAWING NUMBER  
**242931-PUR-01-GF-DR-A-6005**

PURCELL® IS THE REGISTERED TRADE NAME FOR PURCELL ARCHITECTURE LTD AND ALL SUBSIDIARY COMPANIES AND IS REGISTERED IN THE UNITED KINGDOM, EUROPEAN UNION, HONG KONG, CHINA AND AUSTRALIA. © PURCELL 2024. www.purcell.com