

Existing Bridge

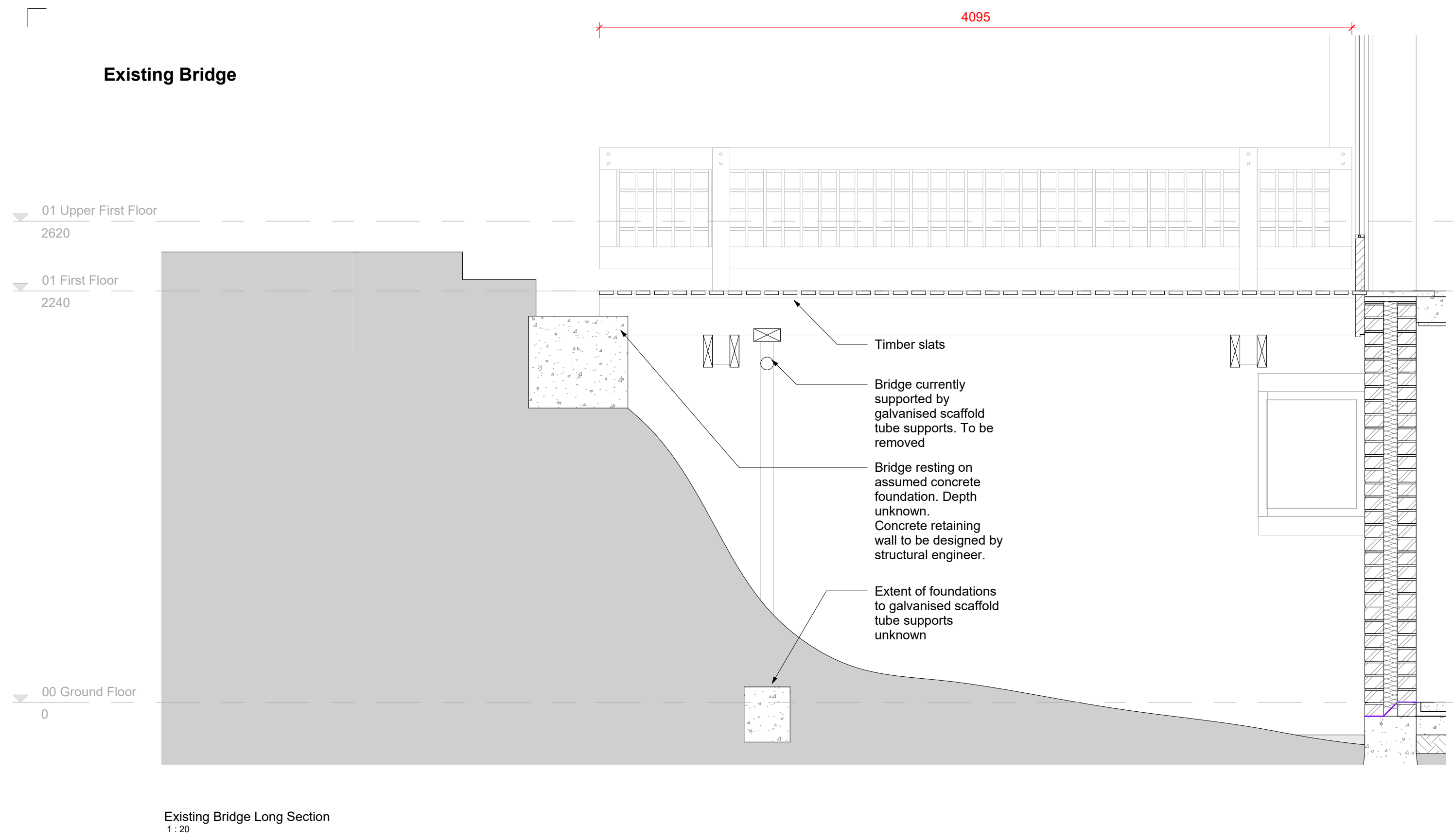

Existing Bridge Long Section
1:20

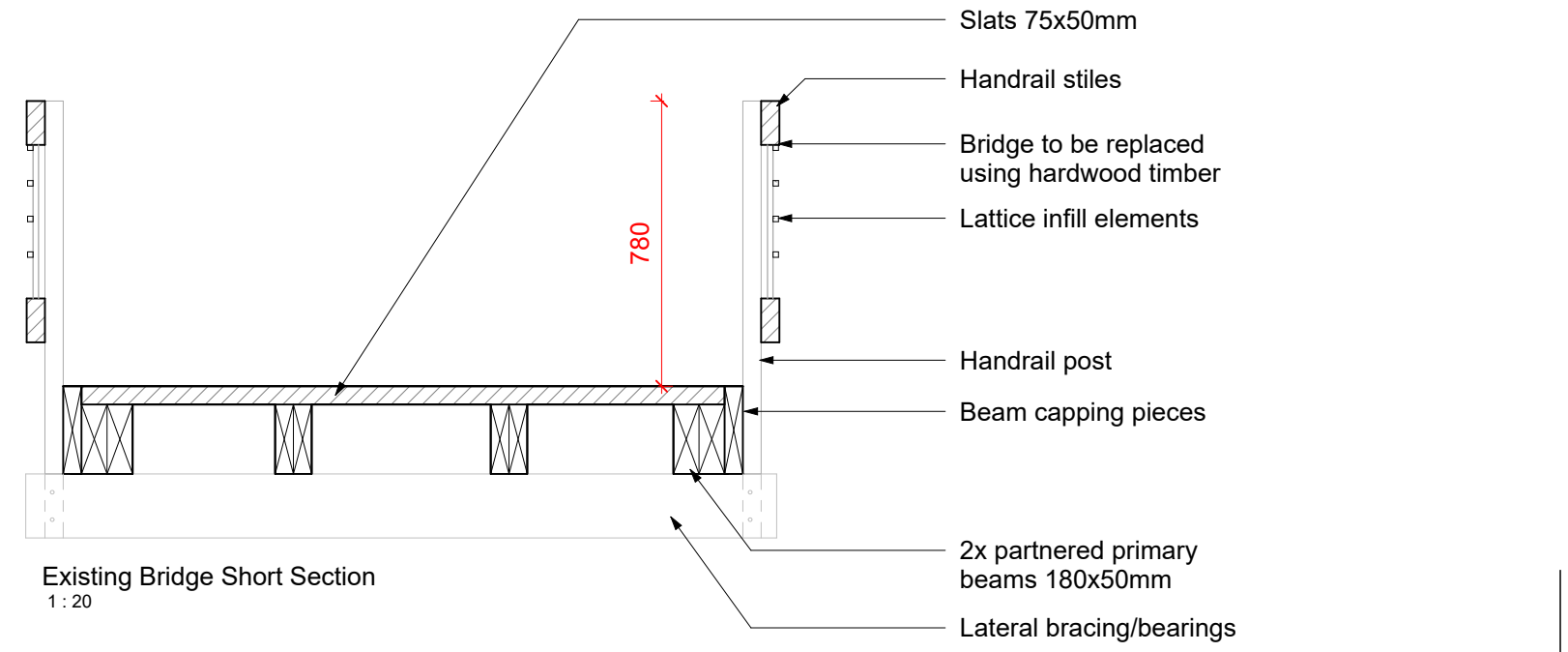

Existing Bridge Short Section
1:20

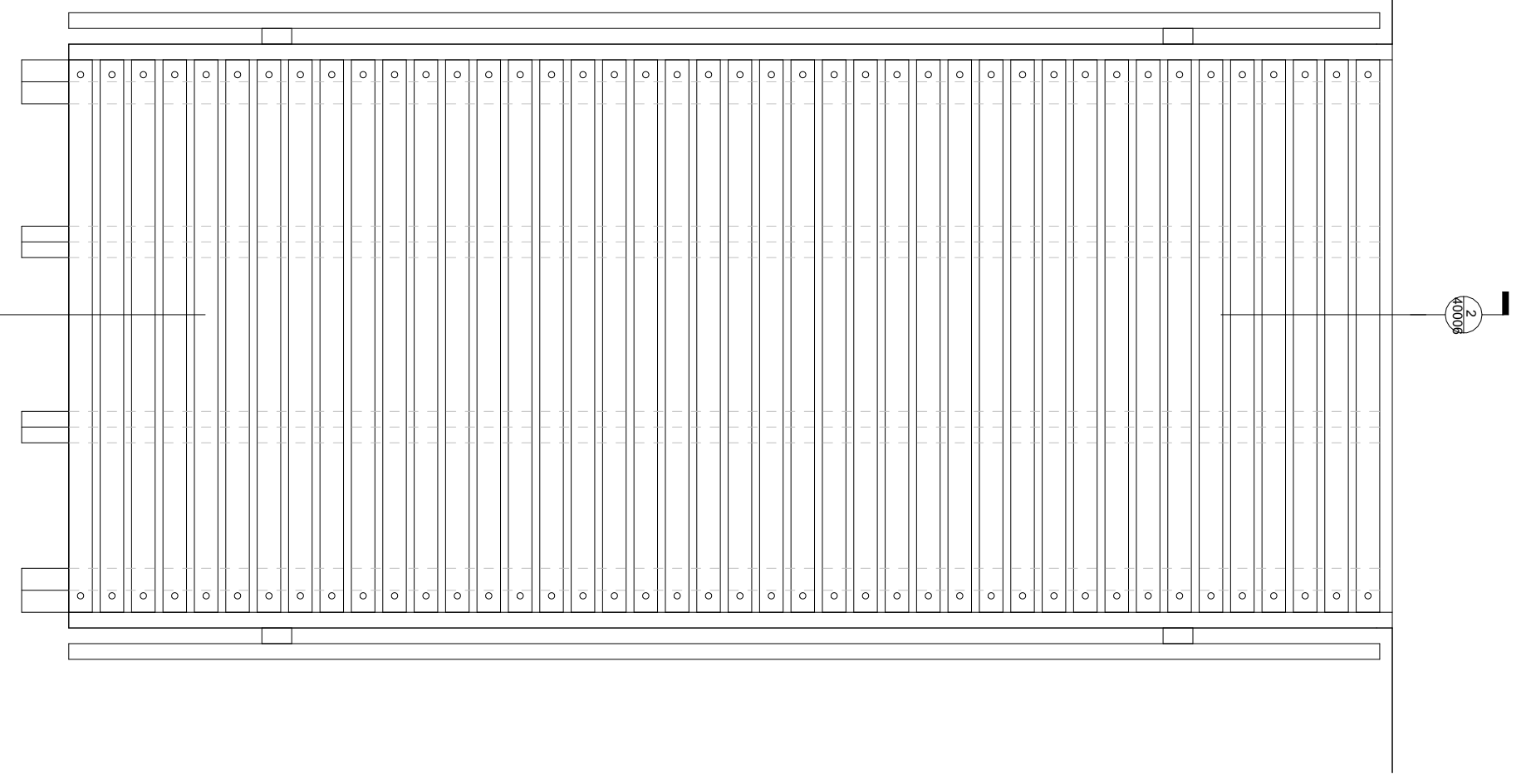

Existing Bridge Plan Detail
1:20

Drawing Notes
 1. Do not scale this drawing.
 2. All dimensions must be checked on site and any discrepancies verified with the architect.
 3. Unless shown otherwise, all dimensions are to structural surfaces.
 4. All work must comply with relevant building Standards and Building Regulations requirements. Drawing errors and omissions to be reported to the architect

Approximate dimensions of accessible timber elements from Six Heritage timber survey page 9.

- Upper rail ~120 x 50mm
- Lower rail ~120 x 50mm
- Handrail stiles ~120 x 50mm
- Lattice infill elements ~15 x 15mm
- Handrail posts ~100 x 50mm
- Slats ~75 x 50mm
- Beam capping pieces ~230 x 50mm
- Partnered primary beams ~180 x 50mm (x2)
- Lateral bracing/bearings ~180 x 50mm
- Primary beam plate ~145 x 70mm
- Later bearer ~145 x 70mm

Proposed Iroko Bridge

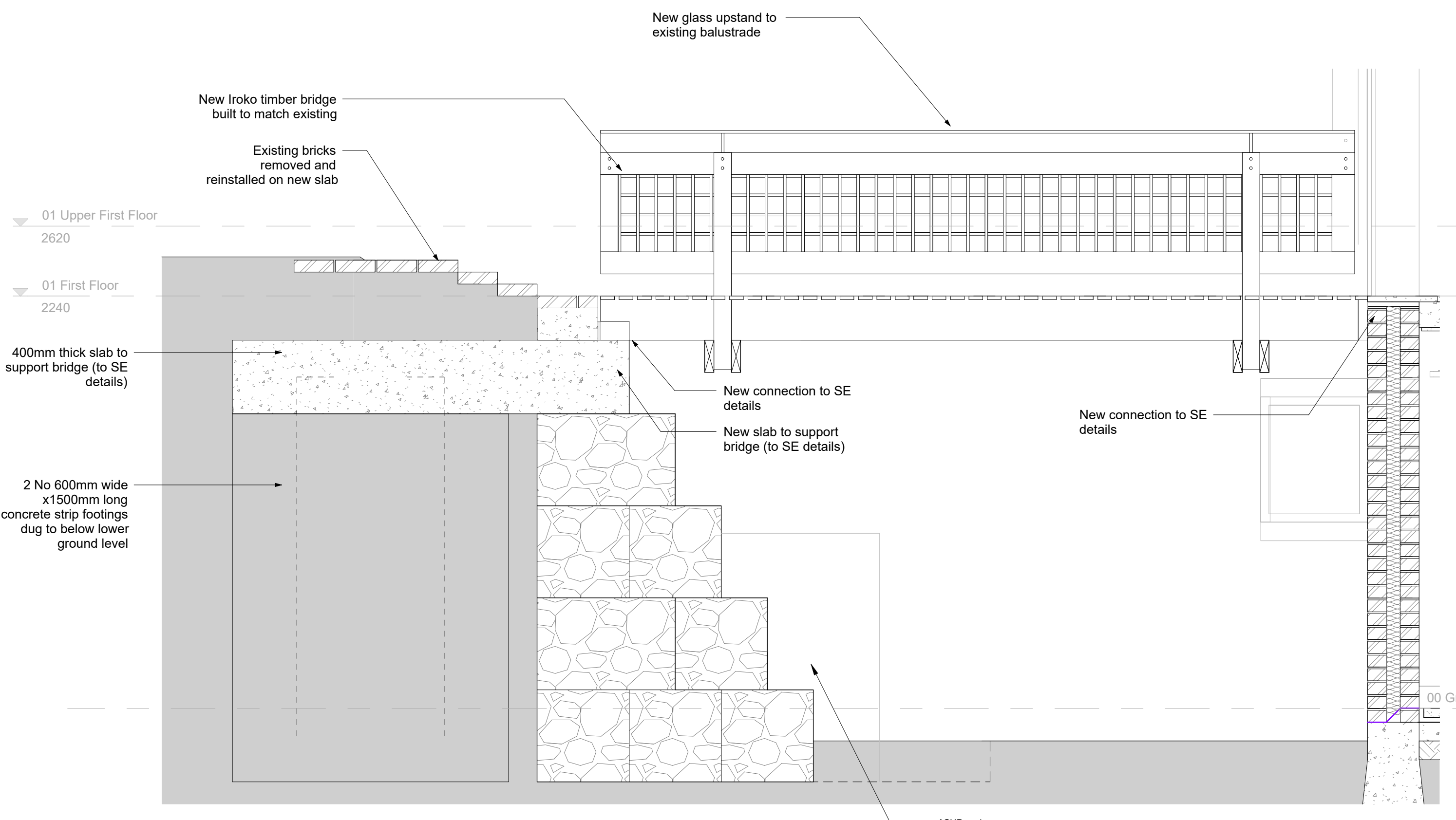

Proposed Bridge Long Section
1:20

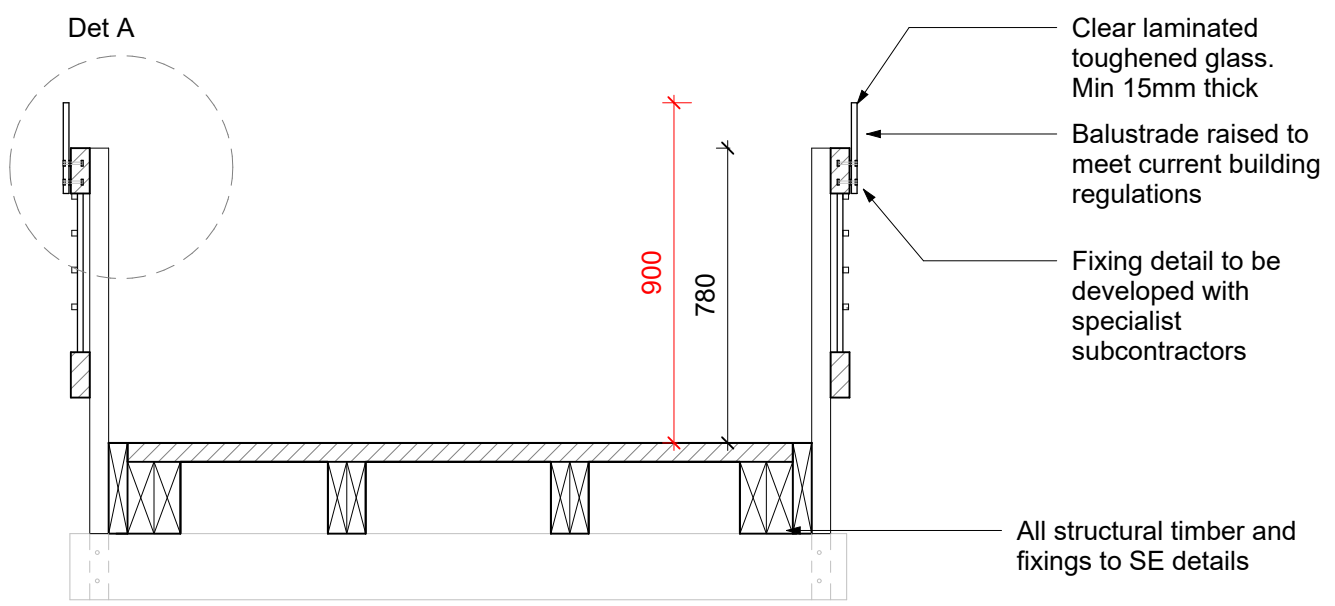

Proposed Bridge Short Section
1:20

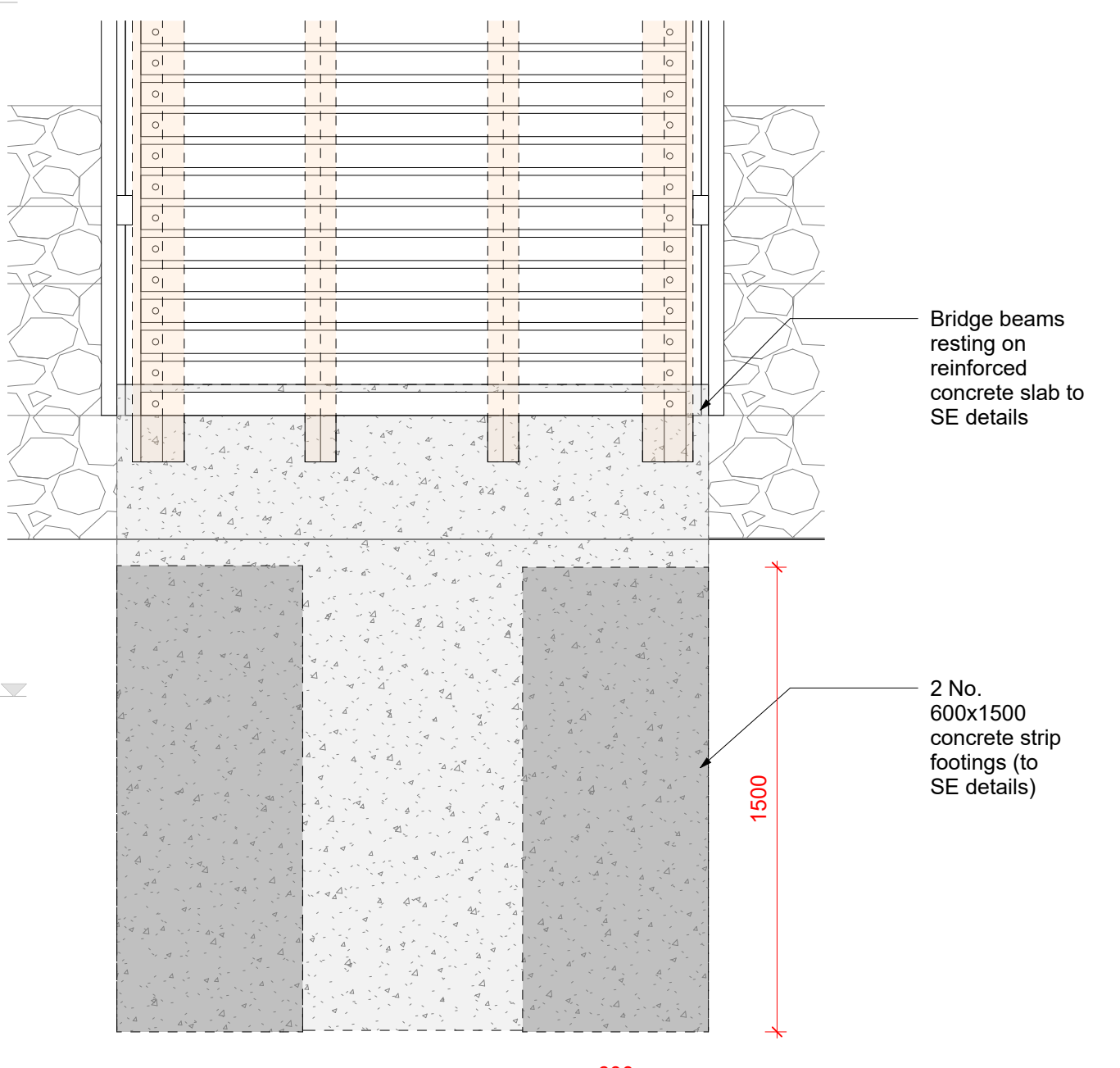

Bridge Foundations Plan
1:20

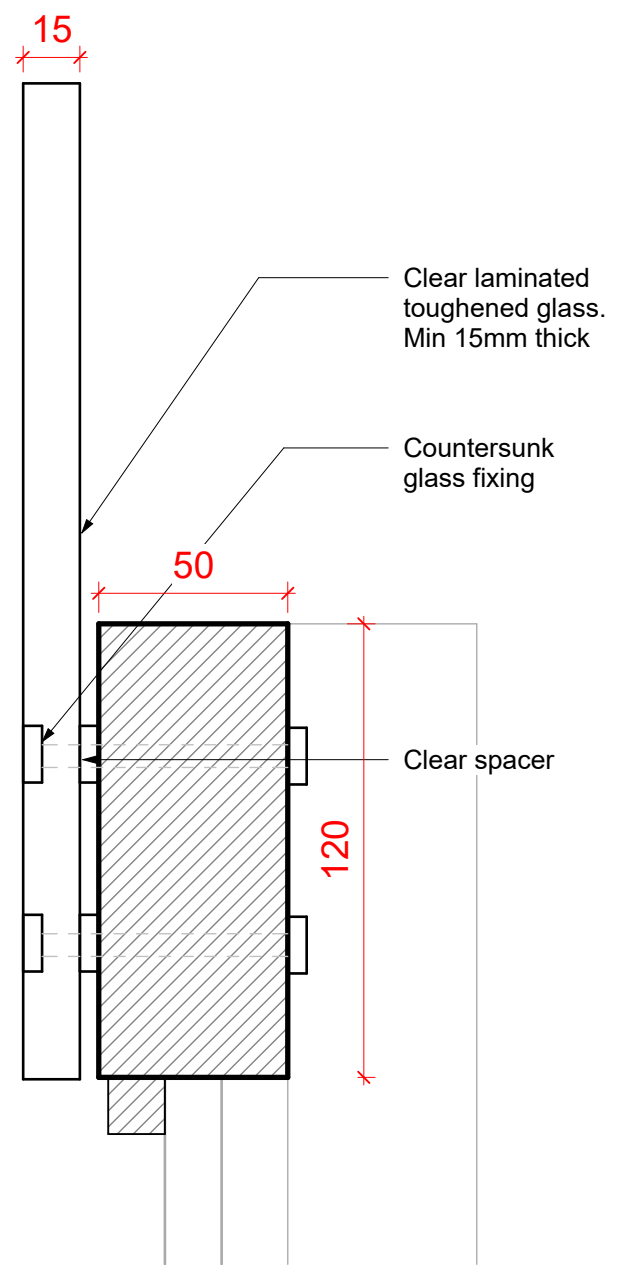

Glass to timber bridge - Det A
1:2

PD1 24.01.25 Discharge of Planning Conditions

rev	date	note

CODE	SUITABILITY DESCRIPTION

STATUS	PURPOSE OF ISSUE
	TENDER

MAP 3rd Floor
 99-101 Farringdon Road
 London, EC1R 3BT
 tel: 020 7096 5007
 email: studio@map-architecture.co.uk

PROJECT NO:

2306

PROJECT

31 South Hill Park

TITLE
Bridge details

CLIENT
Mark Sutcliffe

DRAWN BY	CHECKED BY	DATE
KS	JT	20.12.24

SCALE (@ A1)	PROJECT NUMBER
As indicated	2306

DRAWING NUMBER	REV
40006	PD1