

AD APPLICATION  
SITE ADDRESS  
237-247 TOTTENHAM COURT ROAD, LONDON, W1T 1QS

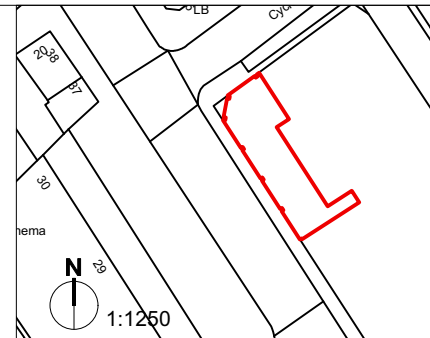
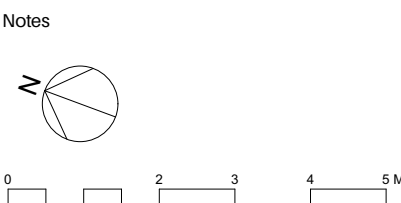

P00	07/01/2025	ISSUED FOR PLANNING
P00	19/12/2024	ISSUED FOR PLANNING
REV	DATE	DESCRIPTION

RY	PT
NK	CHK
BY	

Project Farmer J Tottenham Court Road			
Drawing Proposed Ground Floor Plan			
Job Number 24035	Drawing Number 201000	Rev P00	
Drawn NK	Date 07/01/2025	Status PLANNING	Scale @ A3 1:100
Do not scale from this drawing. All dimensions are to be checked on site. This drawing is to be read in conjunction with all consultants information.			



**Holland Harvey** Architects  
Unit 1.4  
1-5 Vyner Street  
London E2 9DG  
hello@hollandharvey.com  
+44 203 327 0340

Client  
  
Farmer J