

17 Kemplay Road NW3 1TA

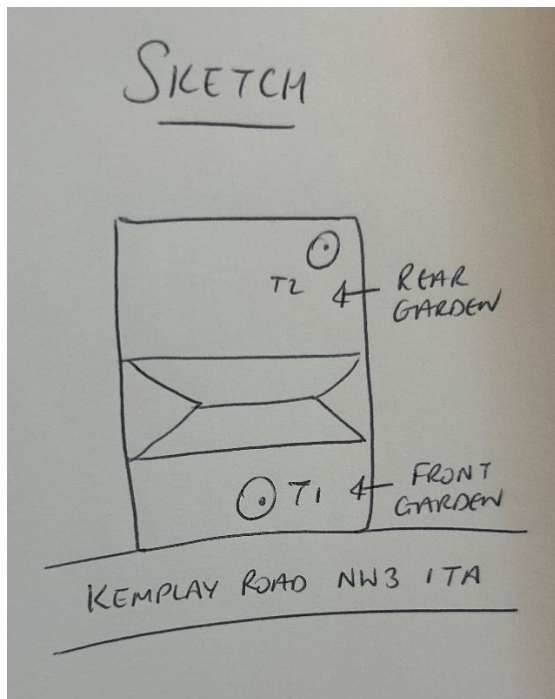

T1: Silver birch



T2: Prunus

T1: Silver birch (14m): Crown lift over road to give 5m clearance to avoid obstruction on the road

T2: Prunus (6m): Reduce height by 1m, thin by 30% and shape to keep tree at a size suitable for its location and as part of regular maintenance