

Proposed Sash Windows

1:20 Elevation / 1:2 Section@A3

Front elevation lower ground floor lightwell

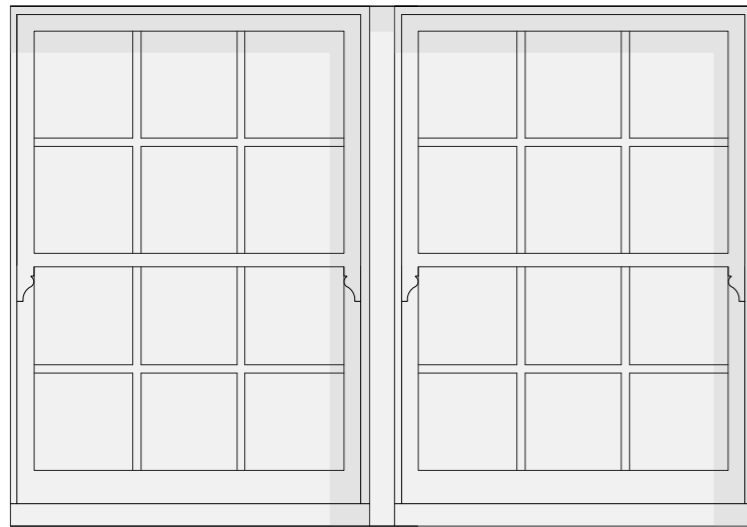

To be read in conjunction with elevation drawing 546-201

Top floor replacement dormer windows (4no.)

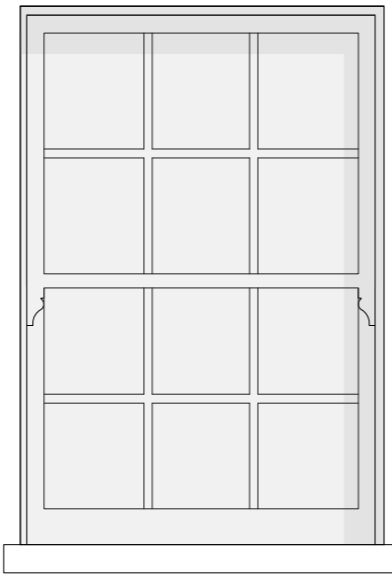

To be read in conjunction with elevation drawings 546-107&8

Proposed Sash Windows

1:2 Top Section@A3

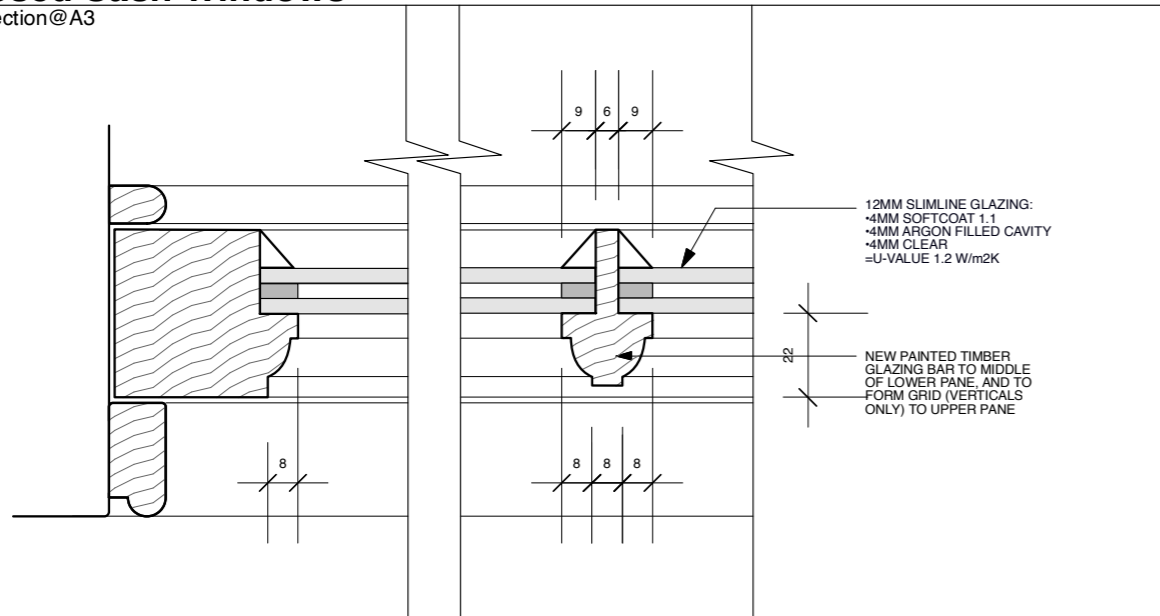

Windows to be handmade by joiner; specialist bespoke item and not an off the shelf item. No 'product' or 'manufacturer' here to state, except for the glazing, details of which are provided.

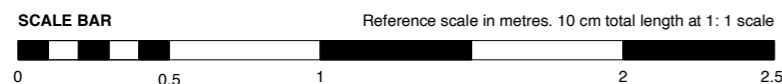
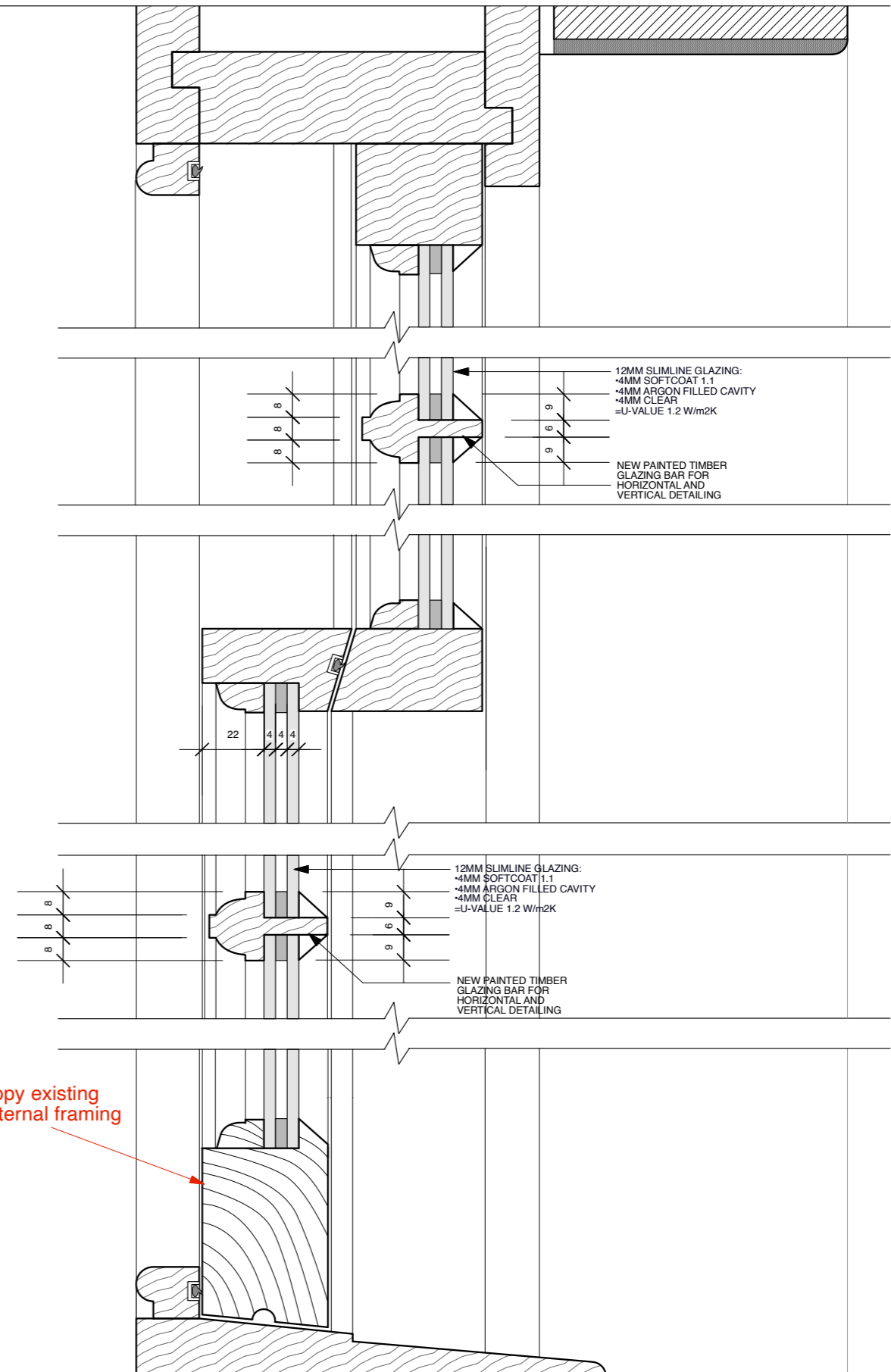

Rev. Comments

PLANNING

Project **23 DELANCEY STREET • CAMDEN • NW1 7NP**

Drawing Title **NEW SASH WINDOWS PROPOSED**

Dwg No. **546-202**

Revision

Scale **1:20/1:2@A3**

Date **DEC 2024**

Drawn by **ES**

ATELIERwest
 ARCHITECTS

0203 587 7227 • 126 New Kings Road • London • SW6 4LZ
 info@atelierwest.co.uk www.atelierwest.co.uk

Do not scale from this drawing. Use figured dimensions only. Any discrepancies are to be reported to AW Ltd immediately. Prior to the execution of the works on site all dimensions to be verified on site before any work is put in hand.