

The contractor is responsible to ensure that no products are to be utilised that do not comply with relevant British and/or European Standards and/or Codes of Practice, COSHH Regulations, Construction Regulations, or which are known or suspected at the time of product selection and/or construction to be deleterious to health and safety or to the durability of the work or not in accordance with good building practices.
The contractor is responsible for checking dimensions, tolerances, levels and references. This drawing/model is to be read in conjunction with all relevant Other Project Team Members' or specialists' drawings/models/any Federated Model. Any discrepancy is to be notified to Baily Garner LLP and is to be rectified before proceeding with the works on site or shop drawings. Where an item is covered by drawings to different scales, the larger scale drawing is to be worked to.
Any rights (including copyright) in this drawing/model and any proprietary work contained therein belong to Baily Garner LLP and may only be used in accordance with the license granted to the Employer and with attribution to Baily Garner LLP.
The drawing to be read in conjunction with Document Suitability Codes page or at www.bailygarner.co.uk/disclaimer/

A1

External Wall Insulation Types

External Wall Insulation Type 01

External Wall Insulation Type 02

Please refer to 21000 series for full information of EWI design and specifications.

Please refer to Structherm Project Specification '11578.S001 (EWI E1) NSC-R-SIL-LR (P2)' document for full EWI specification.

Unit Types

Please refer to 16000 series for full unit type layout information.

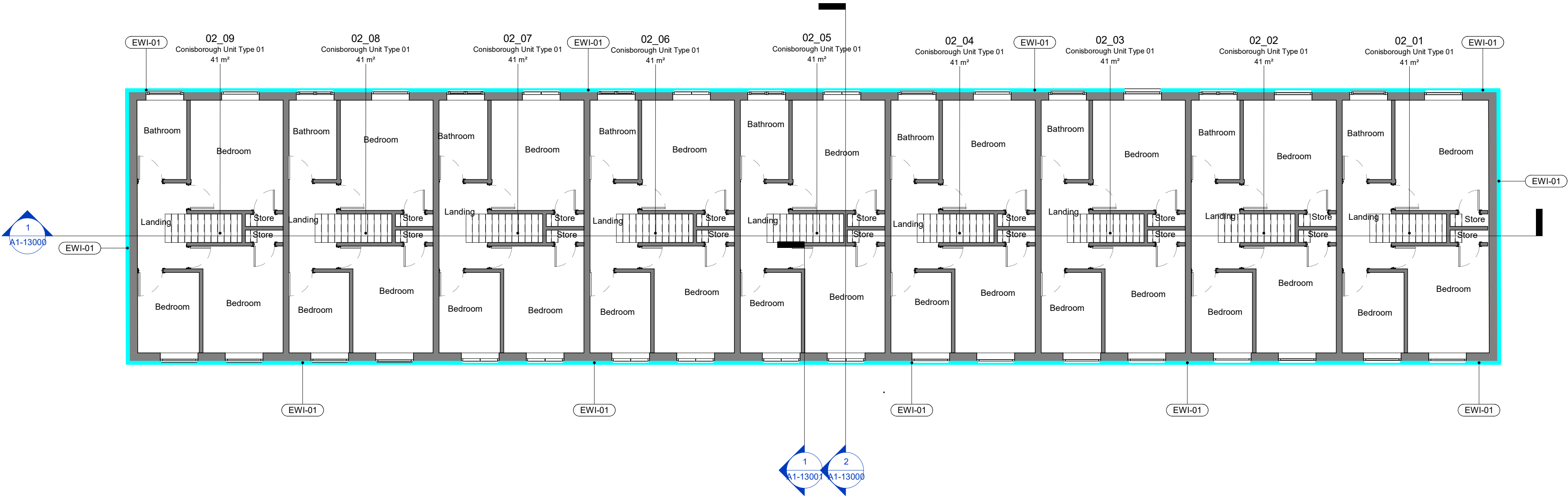

1 - Proposed Conisborough Second Floor Plan

1 : 100



Conisborough Site Plan

1 : 1000

P06	Tender Drawings	24/07/2024
P05	Planning Issue	23/06/2024
P04	Planning Issue	03/05/2024
P03	Preliminary Issue to Client	26/04/2024
P02	Preliminary Issue to Client	12/04/2024
P01	Preliminary Issue to Client	27/03/2024
Rev	Description	Date

	BAILY GARNER		LONDON HEAD OFFICE 148-149 ELTHAM HILL LONDON, SE9 6DY t. 020 834 1000 e. general@bailygarner.co.uk
	CLIENT		Contact Camden Reception 5 Pancras Square London N1C 4AG t. 020 7874 4444
EMPLOYER			

PROJECT ADDRESS

Camden Street
London
NW1 0LY

PROJECT NAME

Curnock Estate-Retrofit Works

DRAWING TITLE

Proposed Second Floor & Roof Plan w/ EWI Strategy

SUITABILITY CODE

D2 - Suitable for Tender

SCALE		DRAWN	CHECKED	APPROVED		DATE	
1:100		FG	GS	BLR		24/07/2024	
PROJ NO	AUTHOR	VOLUME	LEVEL	DOCTYP	ROLE	DRW NO	REV NO
35120	BGL	A1	ZZ	DR	A	12001	P06

2 - Proposed Conisborough Roof Plan

1 : 100

