

- Only for use by GoldenSword Design Consultancy and Site Services LTD.
- This drawing is in millimeters
- All dimensions are to be checked on site.
- This drawing is to be read in conjunction with the supplied GoldenSword Guide, as well as any other relevant documents / drawings. Any discrepancies or variations are to be notified to the project management team in writing before the affected work commences.
- The workmanship and materials of all trades and building operations shall comply with the recommendations of British Standard (BS)8000 and with Approved Document to support Regulation 7 (current edition). All design and construction is to be in accordance with the construction (Design and Management) Regulations 2015.

The drawing is copyright of GoldenSword Design LTD. This drawing shall not be scaled. All dimensions are in mm unless otherwise stated. All dimensions shall be checked on site prior to commencing the works and any discrepancies to be reported to GoldenSword Design LTD. All works shall conform to the current edition of the building regulations and other statutory requirements. All materials and workmanship shall conform with the relevant British Standard specifications and codes of practice. If this drawing forms part of an application for planning permission, it shall not be used for any other purpose without the express permission of GoldenSword Design LTD. This drawing may incorporate information from other professionals.

GoldenSword Design LTD cannot accept responsibility for the integrity and accuracy of such information. Any clarification and/or additions that are required appertaining to such information should be sought from the relevant profession or their appointment representative. Drawings, specifications and schedules are to be read in conjunction with the following where applicable: Employer's Requirements documents, Agreements to Lease, Structural Engineer's drawings and specifications, Civil Engineer's drawings and specifications, Survey Drawings, Party Wall/Boundary Awards. Other specialist design consultant's requirements as appointed by the Main Contractor. Other specialist design sub-contractor's requirements as appointed by the Main Contractor.

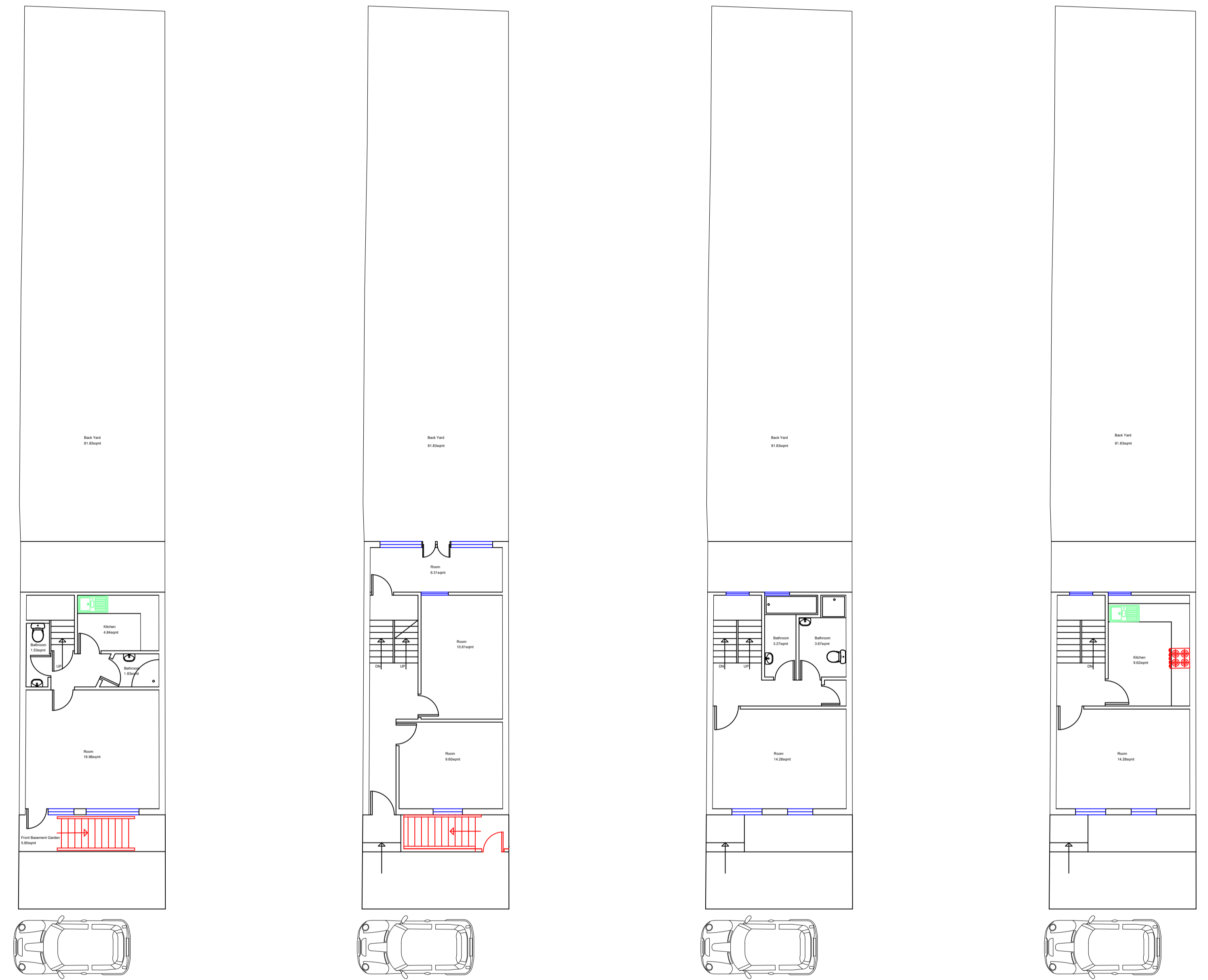

Proposed Basement Floor

Proposed Ground Floor

Proposed First Floor

Proposed Second Floor

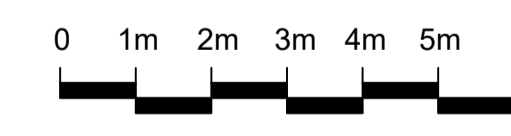

GoldenSword Design LTD
 Office Address:
 Innova Business Park, Electric Ave, London, United Kingdom, EN3 7GD
 Post Address:
 286 Hertford Road, London, United Kingdom, N9 7HD
 Telephone: 07402584297
 Email:
 goldensworddesign@gmail.com

138 Bayham Street NW1 0BA

Layout 1

A1 Print

1:100

NW1 003