

Existing First Floor Plan

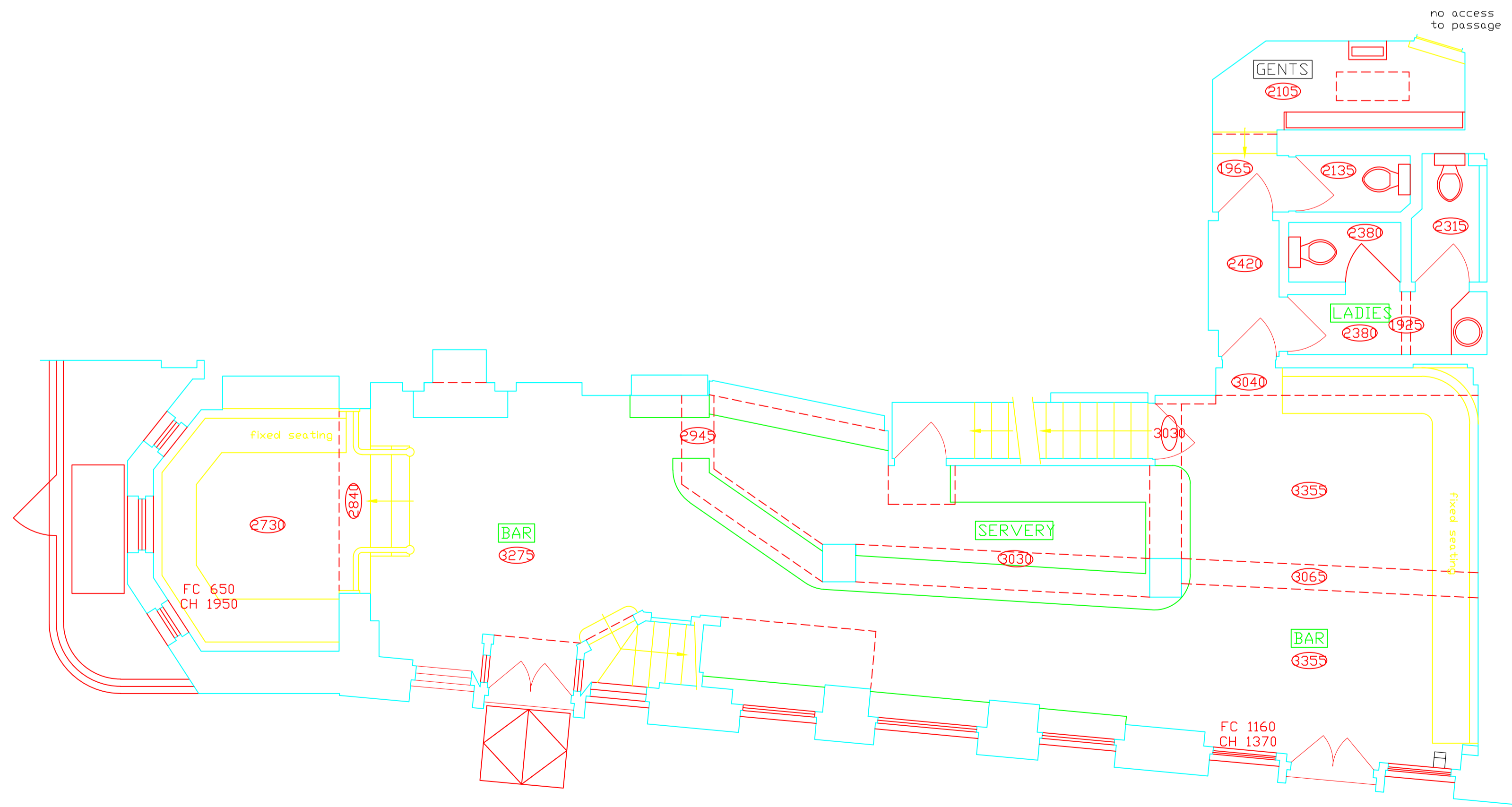

Existing Ground Floor Plan

FUSION BY DESIGN
 All design work and information provided on this drawing must under NO circumstances be reproduced in any form without the prior written approval by Fusion by design.
NOTE TO ALL CONTRACTORS:-
 Under NO circumstances must dimensions be scaled from this drawing. All contractors must be responsible for taking and checking all dimensions upon visiting site. All contractors must advise the DESIGNER immediately, in writing, of any discrepancies.
 This drawing is to be read in conjunction with the bill of quantities / specification and any related drawing. The contractor must ensure that all items detailed on this drawing are included when tendering even if not covered by the specification. The Designer must be advised in writing of all such items. Any discrepancies between drawings and specification must be resolved with the Designer prior to commencing works.
 All structural work must be carried out in strict accordance with the drawing and calculations provided by the appointed Structural Engineer. All structural work must be inspected at all relevant stages by both the Structural Engineer and Building Inspector, any changes or alterations must have their express written approval. Any costs incurred due to either claims for damages, loss of trade, etc by failing to do so will be the sole liability of the contractor.
 All works must be carried out in strict accordance with all Local Authority, British & European Standards. If in doubt, it is the responsibility of the contractor to contact all relevant parties.

**AS BUILT
 APRIL 2015**

REV / 25.03.15 ISSUED FOR INFORMATION CD

Revision



Client:
YOUNG & CO'S

Job Title:
**THE QUEENS,
 49 Regents Park Road, NW1 8XD**

Drawing Title:
**EXISTING PLAN
 GROUND & FIRST FLOORS**

Scale 1:50 @ A1	Drawing No 3138 - 01	Revision /
Date FEB 15		
Drawn By CD		