



1 Crestfield Street

5 Crestfield Street

- Recessed brick panel
- Covered loggia accessible via student communal rooms
- Pigmented precast concrete lintel
- Window w/ bronze finish frame
- Guarding w/ bronze finish
- Perforated ventilation panel w/ bronze finish frame
- Brick wall
- Angled brick wall
- Pigmented precast concrete cross
- Entrance door to church cafe and reception area at grade of Crestfield Street
- Angled brick wall
- Entrance door to student accommodation and first floor meeting rooms
- Pigmented precast concrete lintel
- Metal gate

Site Boundary

Site Boundary

- Notes:
- Do not scale from this drawing.
  - All dimensions to be verified prior to the commencement of any work or the production of any shop drawings.
  - Matthew Lloyd Architects (MLA) shall be notified in writing of any discrepancies.
  - Survey and boundaries indicative only.
  - Proposals are subject to utilities surveys and specialist consultants' input & coordination.
  - Any areas indicated are approximate and indicative only.
  - Where an item is covered by drawings in different scales the larger scale drawing is to be worked to.
  - Drawing to be read in conjunction with relevant consultant's drawings and specifications.
  - Where MLA services on a project do not include for site inspections and work surveys, MLA do not warrant that 'as built' issue drawings are a complete and accurate record of what has been built.
  - MLA shall not be liable for the consequences of any use, misuse or variation of this drawing for any purpose other than that for which it was originally prepared.
  - This title block is copyright of MLA and should not be used, removed, or altered without permission and clear identification.

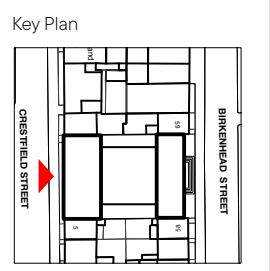

For material key please refer to Elevation Detail Drawings:  
 PL230 - Bay Studies, Crestfield Street Elevation  
 PL231 - Bay Studies, Birkenhead Street Elevation

PL01 11/12/2024 Issued for Planning

PLANNING



Matthew Lloyd Architects  
 1B The Hangar  
 Perseverance Works  
 38 Kingland Road  
 London E2 8DD  
 T 020 7613 1934  
 email: mail@matthewlloyd.co.uk  
 www.matthewlloyd.co.uk ©2022

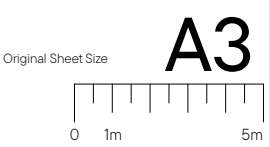

Date	Scale	Checked by	Drawn by
Dec-24	1:200 @ A3	ML	DY
Project KING'S CROSS METHODIST CHURCH WCIH 8BW			
Drawing title PROPOSED ELEVATION - WEST			
Reference	Drawg No.	Rev.	
KXMC	PL223	PL01	