

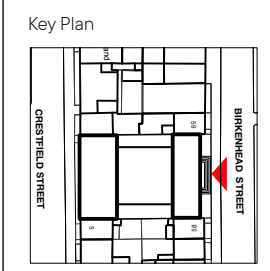

- Notes:
1. Do not scale from this drawing.
 2. All dimensions to be verified prior to the commencement of any work or the production of any shop drawings.
 3. Matthew Lloyd Architects (MLA) shall be notified in writing of any discrepancies.
 4. Survey and boundaries indicative only.
 5. Proposals are subject to utilities surveys and specialist consultants' input & coordination.
 6. Any areas indicated are approximate and indicative only.
 7. Where an item is covered by drawings in different scales the larger scale drawing is to be worked to.
 8. Drawing to be read in conjunction with relevant consultant's drawings and specifications.
 9. Where MLA services on a project do not include for site inspections and work surveys, MLA do not warrant that 'as built' issue drawings are a complete and accurate record of what has been built.
 10. MLA shall not be liable for the consequences of any use, misuse or variation of this drawing for any purpose other than that for which it was originally prepared.
 11. This title block is copyright of MLA and should not be used, removed, or altered without permission and clear identification.



For material key please refer to Elevation Detail Drawings:

PL230 - Bay Studies, Crestfield Street Elevation

PL231 - Bay Studies, Birkenhead Street Elevation

PL01 11/12/2024 Issued for Planning

PLANNING

Client:

Matthew Lloyd Architects

1B The Hangar
Perseverance Works
38 Kingland Road
London E2 8DD
T 020 7613 1934
email: mail@matthewlloyd.co.uk
www.matthewlloyd.co.uk ©2022

Original Sheet Size **A3**

Date	Scale	Checked by	Drawn by
Dec-24	1:200 @ A3	ML	DY
Project			
KING'S CROSS METHODIST CHURCH WC1H 8BW			
Drawing title			
PROPOSED ELEVATION - EAST			
Reference	Drawg No.	Rev.	
KXMC	PL221	PL01	