

Proposed Fittings

	Surface mounted wall lamp
	Surface mounted Emergency wall lamp
	Surface mounted spotlight
	Surface mounted emergency exit signage
	Multiple light switch
	Light switch

Colour Legend

- Blue colour indicates new fittings cabled to existing power position, and with no need of new fixing points.
- Purple colour indicates new fittings cabled to new power provisions, or to existing power but needing new fixing points.

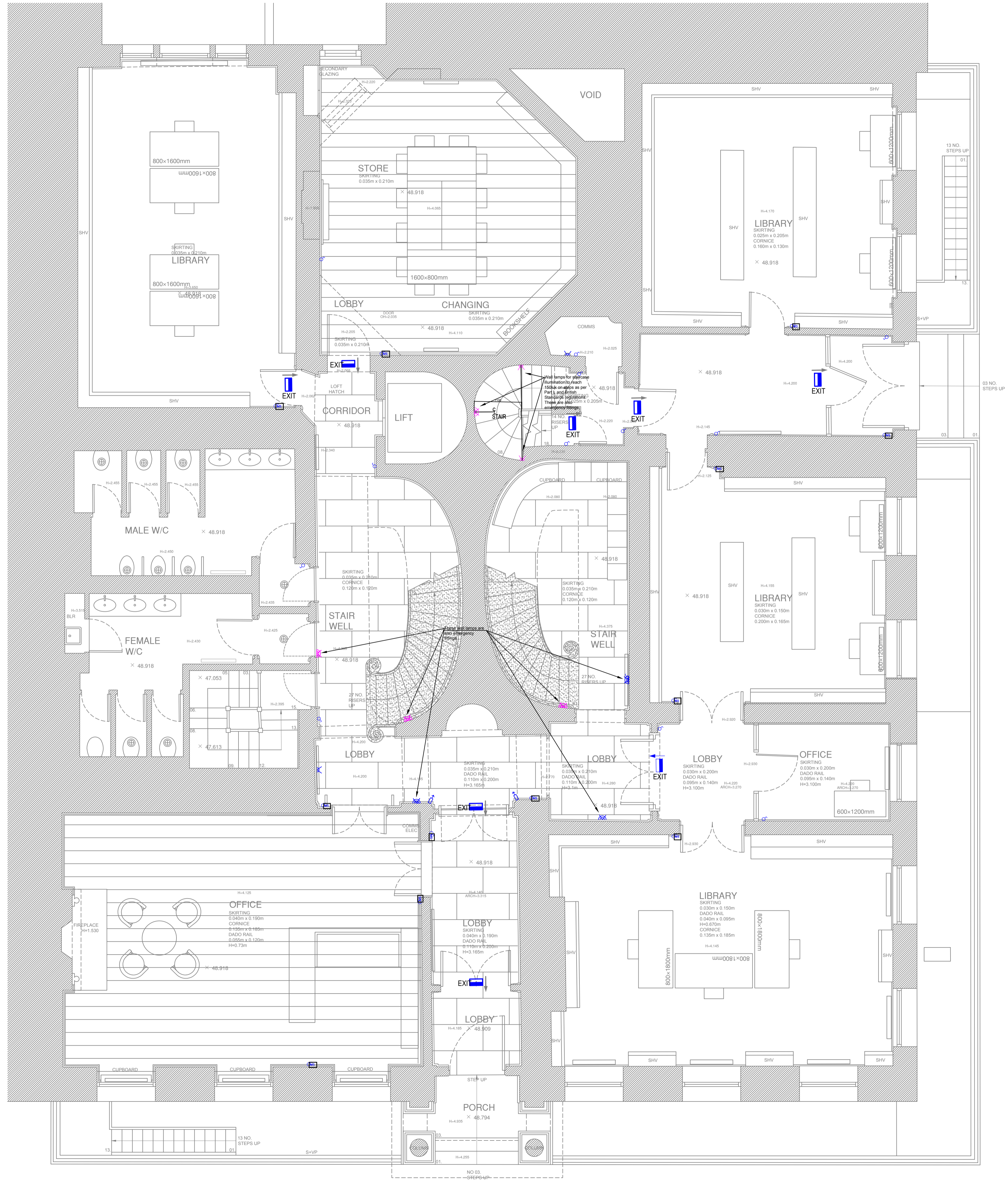

Revision

Rev	Date	Revision	Draw	Check

- This drawing is an Outline Design showing the approximate location of the proposed devices. Where existing points are being reused, these have been indicated in the drawings.
 - All details as available at this stage have been included with the application. If the proposal materially differs from the outline design included here because of site conditions that will become evident only after opening up works are undertaken, a new LDC application will be submitted. Additional details, if required, can be provided as a Discharge of Conditions if required.
 - This drawing indicates design intent only and shall not be used as an installation or working drawing.
 - Existing routes and penetrations will be utilised wherever feasible. Where new routes/penetrations are required these have been highlighted in the drawings.

- Where chasing into wall plaster is required, chasing will be done carefully with hand tools only, in non-decorative, flat areas only and to the minimum extent required. All replastering work will be done to match the existing adjacent plaster, and informed by plaster analysis for specifications.
 - Where penetrations through joists are required, existing penetrations will be reused, and where this is not possible, new limited penetrations will be undertaken for cable runs only.
 - Where existing light fittings are removed, all plaster surfaces will be repaired in a like for like manner, matching to the adjacent plaster.
 - Existing skirtings, dado panelling and dado rails should not be removed or damaged.

Federica Cammarota Design Studio

Via Antonio Bertoloni 1-E
 00197 Roma
 info@federicacammarota.com
 www.federicacammarota.com

Project name: **GHI** Project number: **FC_12**

Client: **German Historical Institute Of London**

Plan: **Proposed Low Level Plan** Drawing title: **GF LLP-P**
 Revision: **N/A**

Date: **17/12/2024**
 Scale: **1:50 A1/ 1:100 A3**
 Drawn/Checked: **FC/FC**
 Approved: **N/A**
 Drawing name: **FC_12_GF_LL-P**

Proposed Fittings

	Surface mounted track light for vertical libraries illumination. High light quality and colour rendering index, light intensity achieving 200lux on vertical surfaces as required by library lighting regulations. Track fixing points installed on timber joists, not on the lath.
	Suspended track light for vertical libraries illumination. High light quality and colour rendering index, light intensity achieving 200lux on vertical surfaces as required by library lighting regulations. Fixed to the ceiling at least 0.2m. Track fixing points installed on timber joists, not on the lath.
	Suspended track light for gallery illumination, with dedicated lights for artwork hanging on the walls. High light quality, high colour rendering index, optics adjustable to art dimension. Also providing door area illumination at entrances, and general lighting in the room as required by reception area lighting regulations. Track fixing points installed on timber joists, not on the lath.
	Surface mounted light
	Pendant light

Colour Legend

- Blue colour indicates new fittings cabled to existing power position, and with no need of new fixing points.
- Purple colour indicates new fittings cabled to new power provisions.
- Pink colour indicates new fittings cabled to existing power provisions, but needing new fixing points.

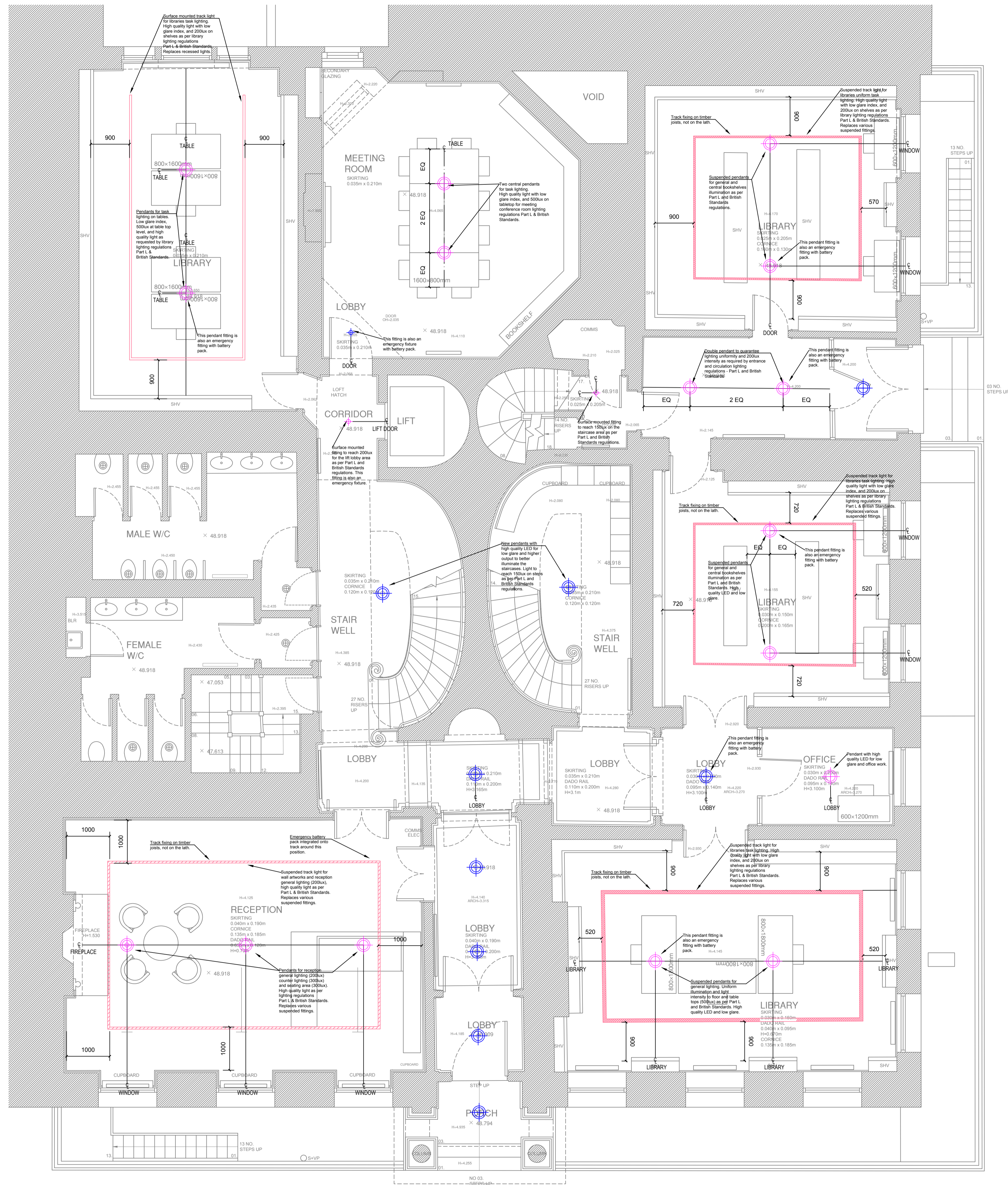

Revision

Rev.	Date	Revision	Draw	Check

This drawing is an Outline Design showing the approximate location of the proposed devices. Where existing points are being reused, these have been indicated in the drawings. All details as available at this stage have been included with the application. If the proposal materially differs from the outline design included here because of site conditions that will become evident only after opening up works are undertaken, a new LBC application will be submitted. Additional details, if required, can be provided as a Discharge of Condition if required. This drawing indicates design intent only and shall not be used as an installation or working drawing. Existing routes and penetrations will be utilised wherever feasible. Where new routes/penetrations are required these have been highlighted in the drawings.

- Where chasing into wall plaster is required, chasing will be done carefully with hand tools only, in non-decorative, flat areas only and to the minimum extent required. All replastering work will be done to match the existing adjacent plaster, and informed by plaster analysis for specifications.
- Where penetrations through joists are required, existing penetrations will be reused, and where this is not possible, new limited penetrations will be undertaken for cable runs only.
- Where existing light fittings are removed, all plaster surfaces will be repaired in a like for like manner, matching to the adjacent plaster.
- Existing skirtings, dado panelling and dado rails should not be removed or damaged.

Federica Cammarota Design Studio

Via Antonio Bertoloni 1-E
00197 Roma
info@federicacammarota.com
www.federicacammarota.com

Project name: Project number:
GHI: FC_12

Client:
German Historical Institute
Of London

Plan: Drawing title:
RCP: GF RCP-P
Proposed: Revision:
Reflected: N/A
Ceiling Plan:

Date: 17/12/2024
Scale: 1:50 A1/ 1:100 A3
Drawn/Checked: FC/FC
Approved: N/A
Drawing name: FC_12_GF_RCP-P

Proposed Fittings

	Surface mounted wall-lamp
	Surface mounted Emergency wall-lamp
	Recessed uplight Fitting installed as in detail D3-H
	High quality picture light of different lengths to follow the libraries layout in the room. High level light quality providing a vertical light wash of 4 metres. Light provides 200lux on vertical library plan for library use and work as required by the lighting libraries requirement. Fitting fixed to a rail positioned on top of the libraries as in detail D1-H.
	Surface mounted spotlight for conference lighting to the speaker Fitting installed as in detail D5-H
	Surface mounted emergency exit signage

Colour Legend

- Blue colour indicates new fittings cabled to existing power provision, and with no need of new fixing points.
- Purple colour indicates new fittings cabled to new power provisions.
- Pink colour indicates new fittings cabled to existing power provisions, but needing new fixing points.

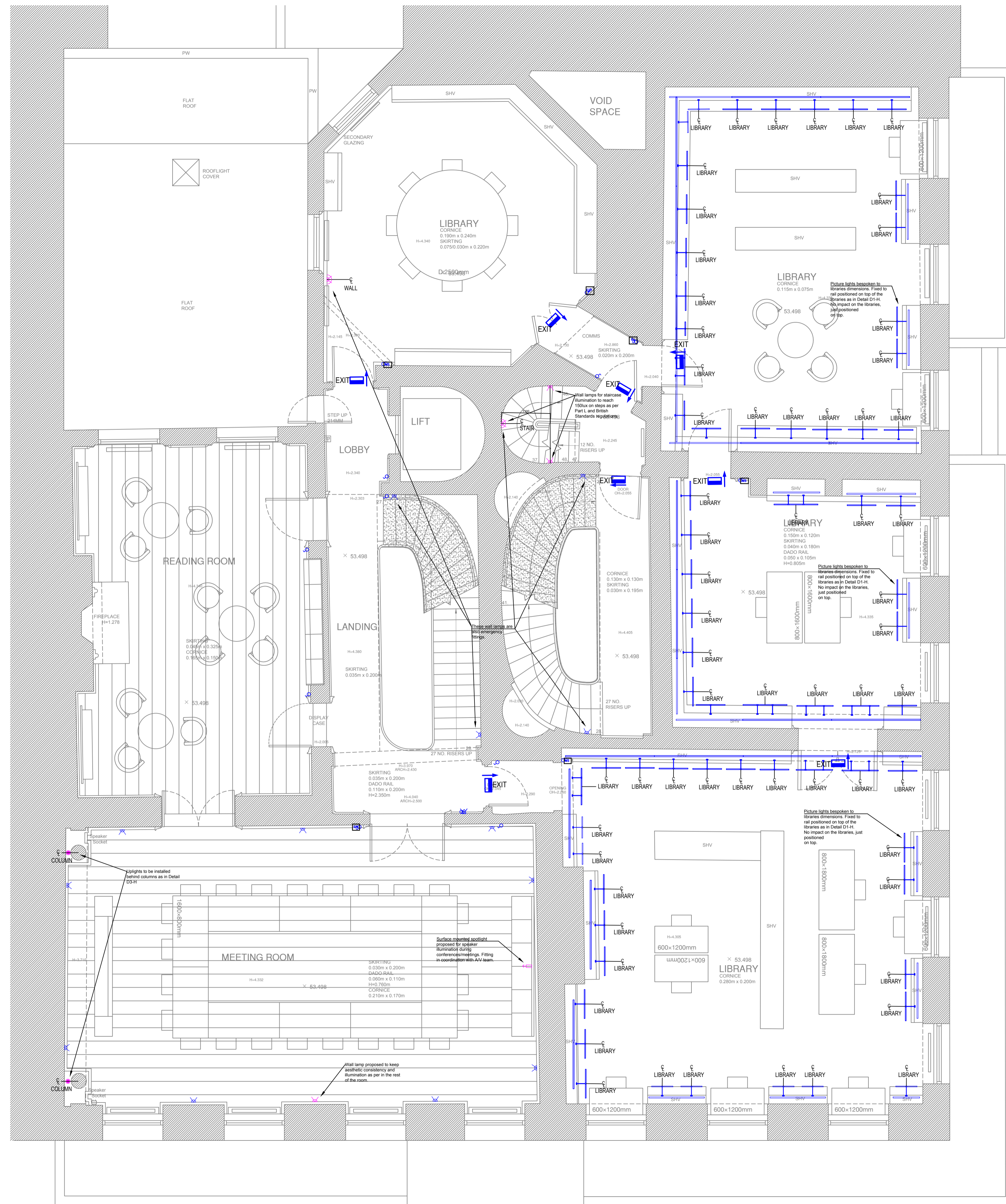

Revision

Rev.	Date	Revision	Draw	Check

- This drawing is an Outline Design showing the approximate location of the proposed devices. Where existing points are being reused, these have been indicated in the drawings.
- All details as available at this stage have been included with the application. If the proposal materially differs from the outline design included here because of site conditions that will become evident only after opening up works are undertaken, a new LDC application will be submitted. Additional details, if required, can be provided as a Discharge of Condition if required.
- This drawing indicates design intent only and shall not be used as an installation or working drawing.
- Existing routes and penetrations will be utilised wherever feasible. Where new routes/penetrations are required these have been highlighted in the drawings.
- Where chasing into wall plaster is required, chasing will be done carefully with hand tools only, in non-decorative, flat areas only and to the minimum extent required. All replastering work will be done to match the existing adjacent plaster, and informed by plaster analysis for specifications.
- Where penetrations through joists are required, existing penetrations will be reused, and where this is not possible, new limited penetrations will be undertaken for cable runs only.
- Where existing light fittings are removed, all plaster surfaces will be repaired in a like for like manner, matching to the adjacent plaster.
- Existing skirtings, dado panelling and dado rails should not be removed or damaged.

Federica Cammarota Design Studio

Via Antonio Bertoloni 1-E
00197 Roma
info@federicacamarrotadstudio.com
www.federicacamarrotadstudio.com



Project name: GH1
Project number: FC_12

Client: German Historical Institute Of London



Plan: LLP
Proposed: Low Level Plan
Drawing title: 1F LLP-P
Revision: N/A

Date: 17/12/2024
Scale: 1:50 A1/ 1:100 A3
Drawn/Checked: NM/FC
Approved: N/A
Drawing name: FC_12_1F_LLP-P

Proposed Fittings

	Suspended track light for vertical libraries illumination. High light quality and colour rendering index, light intensity achieving 200lux on vertical surfaces as required by library lighting regulations. Fixed to the ceiling as detail D2-14.
	Surface mounted light
	Pendant light. Some of these on the plan are also Emergency fittings.

Colour Legend

-  Blue colour indicates new fittings cabled to existing power position, and with no need of new fixing points.
-  Purple colour indicates new fittings cabled to new power provisions.
-  Pink colour indicates new fittings cabled to existing power provisions, but needing new fixing points.

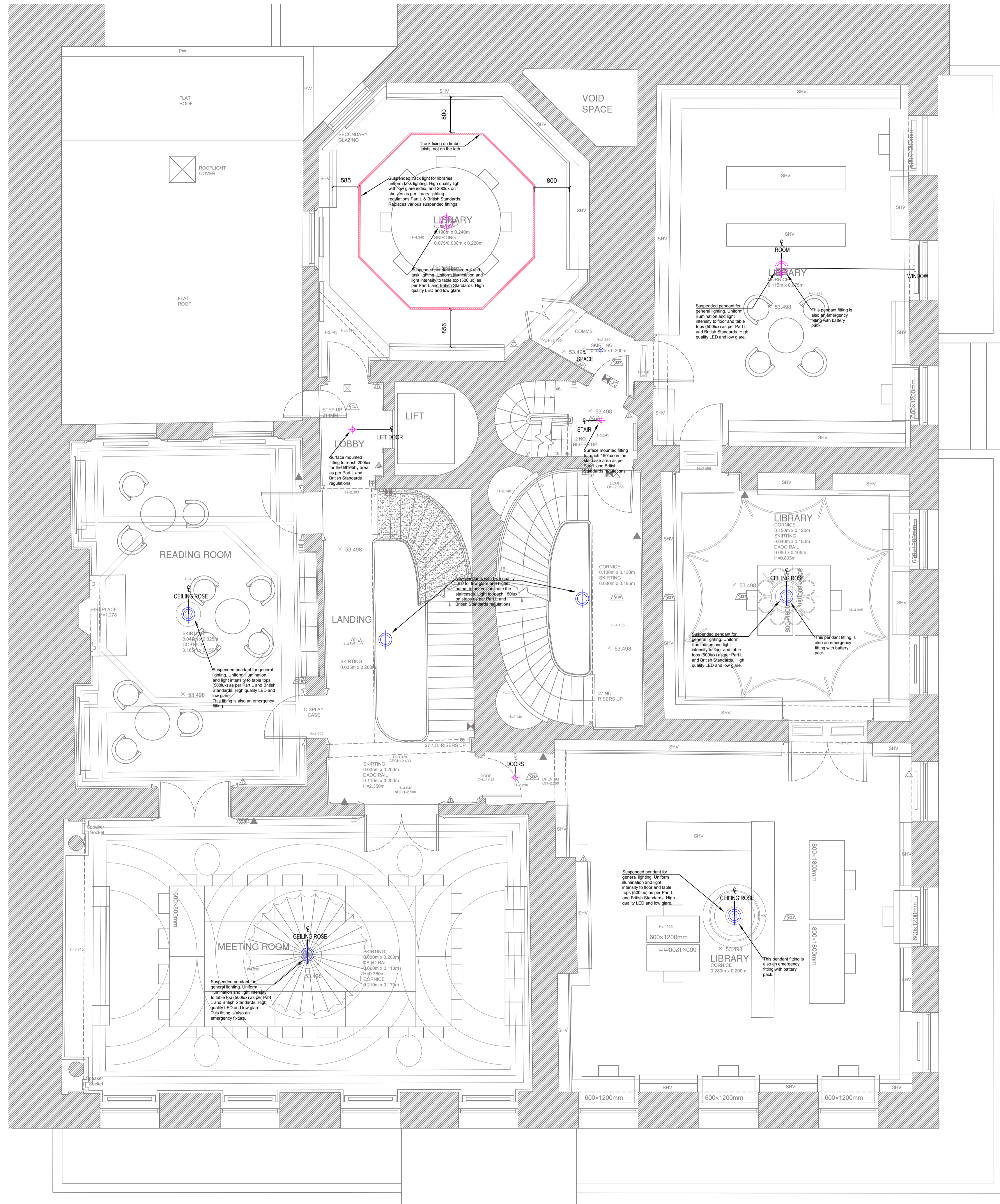

Revision

Rev.	Date	Revision	Draw	Check

- This drawing is an Outline Design showing the approximate location of the proposed devices. Where existing points are being reused, these have been indicated in the drawings.
- All details as available at this stage have been included with the application. If the proposal materially differs from the outline design included here because of site conditions that will become evident only after opening up works are undertaken, a new LDC application will be submitted. Additional details, if required, can be provided as a Discharge of Condition if required.
- This drawing indicates design intent only and shall not be used as an installation or working drawing.
- Existing routes and penetrations will be utilised wherever feasible. Where new routes/penetrations are required these have been highlighted in the drawings.

- Where chasing into wall plaster is required, chasing will be done carefully with hand tools only, in non-decorative, flat areas only and to the minimum extent required. All replastering work will be done to match the existing adjacent plaster, and informed by plaster analysis for specifications.
- Where penetrations through joists are required, existing penetrations will be reused, and where this is not possible, new limited penetrations will be undertaken for cable runs only.
- Where existing light fittings are removed, all plaster surfaces will be repaired in a like for like manner, matching to the adjacent plaster.
- Existing skirting, dado paneling and dado rails should not be removed or damaged.

Federica Cammarota Design Studio

Via Antonio Bertoloni 1-E
00197 Roma
info@federicacammarota.com
www.federicacammarota.com

Project name Project number





GHI FC_12

Client
German Historical Institute
Of London

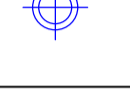

Plan Drawing title
RCP 1F RCP-P
Existing Revision
Proposed N/A
Ceiling Plan

Date 17/12/2024
Scale 1:50 A1/ 1:100 A3
Drawn/Checked MN/FC
Approved N/A
Drawing name FC_12_1F_RCP-P

Proposed Fittings

	Surface mounted track light for vertical libraries illumination. High light quality and colour rendering index, light intensity achieving 200lux on vertical surfaces as required by library lighting regulations.
	Surface mounted light
	Pendant light
	Surface mounted downlight for general office lighting. Some of these on the plan are also Emergency fittings.
	Surface mounted emergency exit signage

Colour Legend

-  Blue colour indicates new fittings cabled to existing power position, and with no need of new fixing points.
-  Purple colour indicates new fittings cabled to new power provisions, or to existing power but needing new fixing points.
-  Pink colour indicates new fittings cabled to existing power provisions, but needing new fixing points.



Revision

Rev.	Date	Revision	Draw	Check

- This drawing is an Outline Design showing the approximate location of the proposed devices. Where existing points are being reused, these have been indicated in the drawings.
- All details as available at this stage have been included with the application. If the proposal materially differs from the outline design included here because of site conditions that will become evident only after opening up works are undertaken, a new LDC application will be submitted. Additional details, if required, can be provided as a Discharge of Condition if required.
- This drawing indicates design intent only and shall not be used as an installation or working drawing. Existing routes and penetrations will be utilised wherever feasible. Where new routes/penetrations are required these have been highlighted in the drawings.
- Where chasing into wall plaster is required, chasing will be done carefully with hand tools only, in non-decorative, flat areas only and to the minimum extent required. All replastering work will be done to match the existing adjacent plaster, and informed by plaster analysis for specifications.
- Where penetrations through joists are required, existing penetrations will be reused, and where this is not possible, new limited penetrations will be undertaken for cable runs only.
- Where existing light fittings are removed, all plaster surfaces will be repaired in a like for like manner, matching to the adjacent plaster.
- Existing skirtings, dado panelling and dado rails should not be removed or damaged.

Federica Cammarota Design Studio

Via Antonio Bertoloni 1-E
00197 Roma
info@federicacammarota.com
www.federicacammarota.com

Project name Project number

GHI FC_12

Client
German Historical Institute
Of London

Plan Drawing title
RCP 2F RCP-P
Proposed Revision
Reflected N/A
Ceiling Plan

Date 17/12/2023
Scale 1:50 A1/ 1:100 A3
Drawn/Checked NM/FC
Approved N/A
Drawing name FC_12_2F_RCP-P

Proposed Fittings

⬇		Surface mounted wall lamp
⚡		Surface mounted Emergency wall lamp

Colour Legend

- Blue colour indicates new fittings cabled to existing power position, and with no need of new fitting points.
- Purple colour indicates new fittings cabled to new power provisions, or to existing power but needing new fitting points.

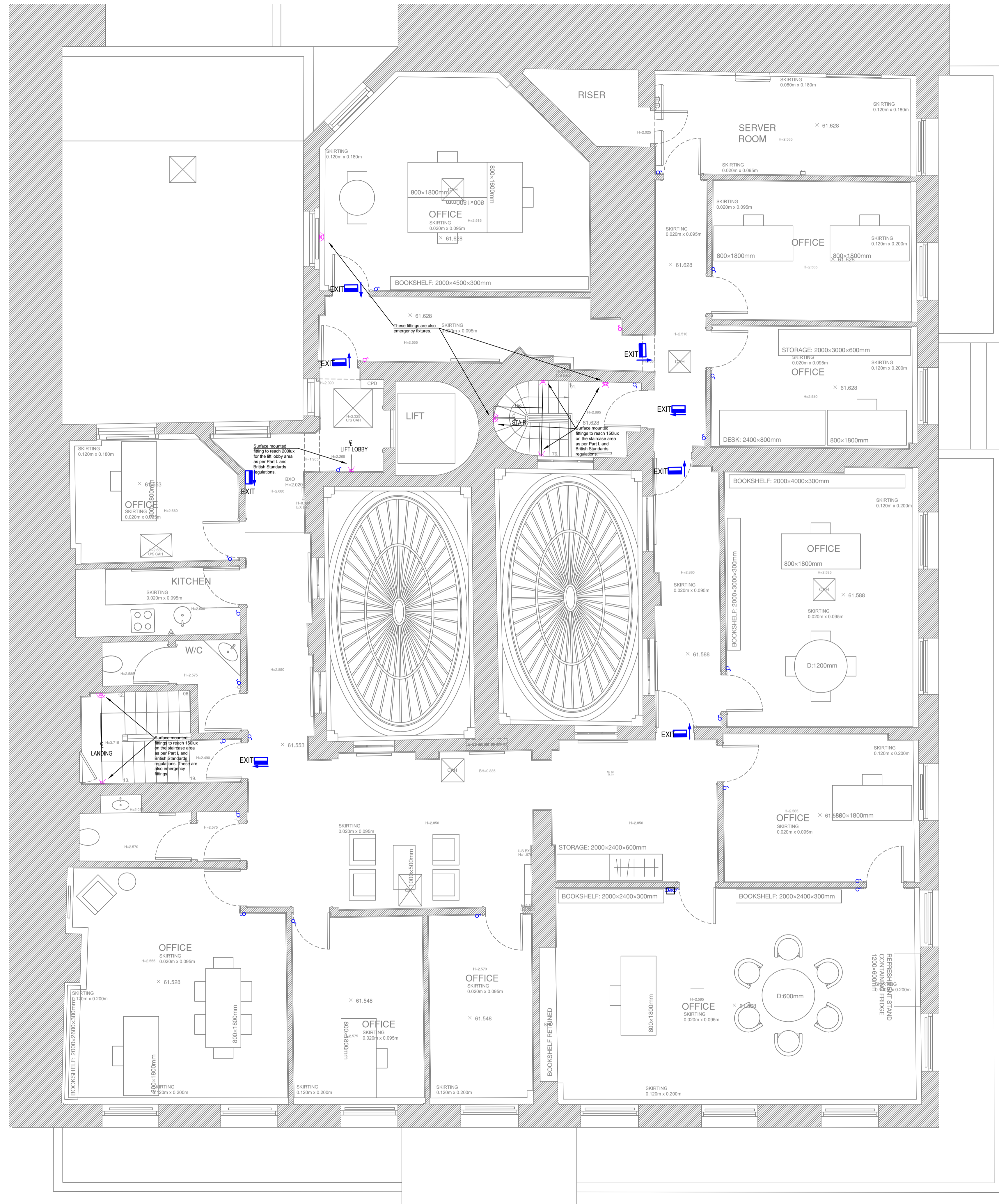

Revision

Rev.	Date	Revision	Draw	Check

- This drawing is an Outline Design showing the approximate location of the proposed devices. Where existing points are being reused, these have been indicated in the drawings.
- All details as available at this stage have been included with the application. If the proposal materially differs from the outline design included here because of site conditions that will become evident only after opening up works are undertaken, a new LRC application will be submitted. Additional details, if required, can be provided as a Discharge of Condition if required.
- This drawing indicates design intent only and shall not be used as an installation or working drawing.
- Existing routes and penetrations will be utilised wherever feasible. Where new routes/penetrations are required these have been highlighted in the drawings.
- Where chasing into wall plaster is required, chasing will be done carefully with hand tools only, in non-decorative, flat areas only and to the minimum extent required. All replastering work will be done to match the existing adjacent plaster, and informed by plaster analysis for specifications.
- Where penetrations through joists are required, existing penetrations will be reused, and where this is not possible, new limited penetrations will be undertaken for cable runs only.
- Where existing light fittings are removed, all plaster surfaces will be repaired in a like for like manner, matching to the adjacent plaster.
- Existing skirtings, dado panelling and dado rails should not be removed or damaged.

Federica Cammarota Design Studio

Via Antonio Bertoloni 1-E
00197 Roma
info@federicacammarota.com
www.federicacammarota.com







Project name: **GHI** Project number: **FC_12**

Client: **German Historical Institute Of London**



Plan: **LLP** Drawing title: **3F LLP-P**
Proposed: **Low Level Plan** Revision: **N/A**

Date: **17/12/2024**
Scale: **1:50 A1/ 1:100 A3**
Drawn/Checked: **NM/FC**
Approved: **N/A**
Drawing name: **FC_12_3F_LLP-P**

Proposed Fittings

	Suspended linear pendant for task lighting. Two suspension cables.
	Surface mounted ceiling light. Some of these on the plan are also Emergency fittings.
	Pendant light
	Surface mounted downlight for general office and corridor lighting. Some of these on the plan are also Emergency fittings.
	Recessed small technical downlight for general office lighting
	Surface mounted linear light for enhancement of the glass domes
	Surface mounted emergency exit signage

Colour Legend

-  Blue colour indicates new fittings cabled to existing power points, and with no need of new wiring points.
-  Purple colour indicates new fittings cabled to new power provisions, or to existing power but needing new wiring points.

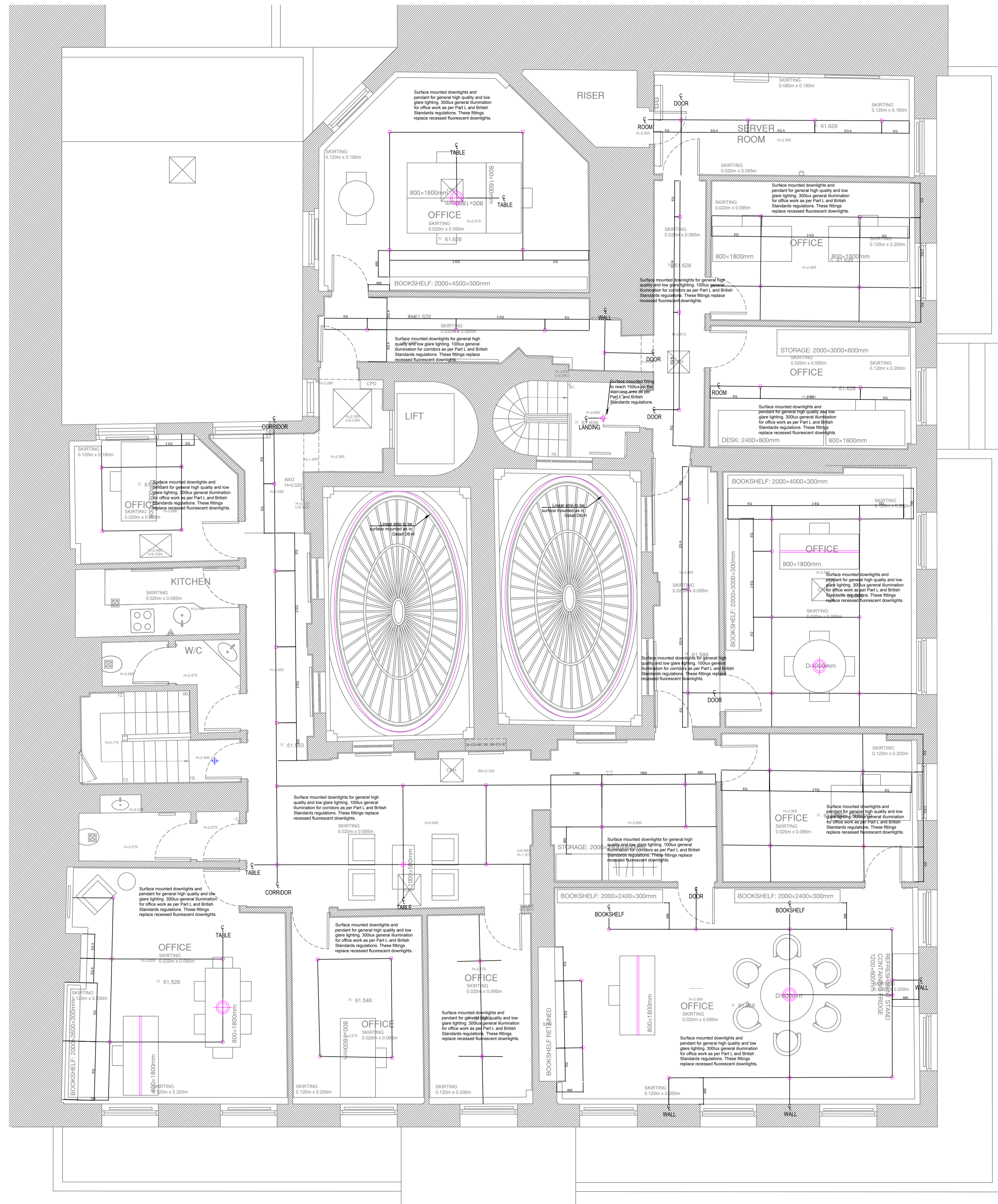

Revision

Rev.	Date	Revision	Draw	Check

- This drawing is an Outline Design showing the approximate location of the proposed devices. Where existing points are being reused, these have been indicated in the drawings.
- All details as available at this stage have been included with the application. If the proposal materially differs from the outline design included here because of site conditions that will become evident only after opening up works are undertaken, a new LBC application will be submitted. Additional details, if required, can be provided as a Discharge of Condition if required.
- This drawing indicates design intent only and shall not be used as an installation or working drawing.
- Existing routes and penetrations will be utilised wherever feasible. Where new routes/penetrations are required these have been highlighted in the drawings.
- Where chasing into wall plaster is required, chasing will be done carefully with hand tools only, in non-decorative, flat areas only and to the minimum extent required. All replastering work will be done to match the existing adjacent plaster, and informed by plaster analysis for specifications.
- Where penetrations through joists are required, existing penetrations will be reused, and where this is not possible, new limited penetrations will be undertaken for cable runs only.
- Where existing light fittings are removed, all plaster surfaces will be repaired in a like for like manner, matching to the adjacent plaster.
- Existing skirtings, dado panelling and dado rails should not be removed or damaged.

Federica Cammarota Design Studio

Via Antonio Bertoloni 1-E
00197 Roma
info@federicacammarota.com
www.federicacammarota.com

Project name: GH1
Project number: FC_12

Client: German Historical Institute Of London

Plan: RCP
Proposed: Reflected
Ceiling Plan

Drawing title: 3F RCP-P
Revision: N/A

Date: 17/12/2024
Scale: 1:50 A1/ 1:100 A3
Drawn/Checked: NM/FC
Approved: N/A
Drawing name: FC_12_3F_RCP-P