

THIS DRAWING IS INDICATIVE AND REPRESENTS ONLY THE DESIGN INTENT, THE CONTRACTOR MUST PRODUCE FULLY CO-ORDINATED WORKING / INSTALLATION DRAWINGS AS REFERRED TO IN THE CONTRACT DOCUMENTATION

HEATING NOTES

- DO NOT SCALE FROM THIS DRAWING. ALL DIMENSIONS INDICATED ARE IN MILLIMETERS
- DRAWING TO BE READ IN CONJUNCTION WITH SPECIFICATION, DOCUMENTATION, DRAWINGS & ALL RELEVANT BRITISH STANDARD DOCUMENTS
- THE HEATING INSTALLATION SHALL COMPLY WITH THE REQUIREMENTS OF BS EN 12828:2012, BS EN 12831:2017 AND THE BUILDING REGULATIONS 2010.
- ALL FITTINGS, PIPEWORK, PLANT & EQUIPMENT TO BE INSTALLED, REGULATED & TESTED IN ACCORDANCE WITH THE MANUFACTURERS PRINTED INSTRUCTIONS.
- ALL HIGH POINTS IN SYSTEM TO INCLUDE AUTOMATIC AIR VALVE & ALL LOW POINTS INCLUDE A DRAIN OFF COCK.
- ALL PIPEWORK TO BE ADEQUATELY SUPPORTED THROUGHOUT ITS LENGTH.
- ALL PIPES PASSING THROUGH FIRE STOP BARRIERS TO BE SLEEVED BEYOND THE BARRIER TO A MINIMUM LENGTH OF 300mm WITH BARRIER FIRE STOP MATERIAL.
- ALL FINAL CONNECTIONS TO TOWEL RAILS / RADIATORS TO BE 15mmØ STAINLESS STEEL OR CHROMED COPPER UNLESS OTHERWISE STATED.
- ALL PIPEWORK WITHIN NON ACCESSIBLE CEILINGS & WITHIN FLOOR TRENCHES TO BE FULLY WELDED/BRAZED.
- EXISTING RADIATORS TO BE REPLACED WITH EQUAL OR GREATER HEAT OUTPUT THAN CURRENTLY INSTALLED.
- VALIDATION FOR PIPE WORK ROUTES, WATER FLOW RATE, TEMPERATURE AND PRESSURE WOULD BE REQUIRED PRIOR TO ANY WORKS.
- THE CONTRACTOR SHOULD PROVIDE 2 OPTIONS FOR REPLACING THE EXISTING RADIATORS.
OPTION 1- DRAIN DOWN THE SYSTEM, RECONNECT NEW RADIATORS INCLUDING FLUSHING THE SYSTEM AND COMMISSION.
OPTION 2- LOCALIZED FREEZING THE PIPE WORKS AND REPLACE THE RADIATORS.
- FINAL RADIATOR SELECTION TO BE COORDINATED AND CONFIRMED WITH THE ARCHITECT.
- OPENING UP FLOORS WOULD BE REQUIRED TO SURVEY THE EXTENT OF PIPE ROUTING BEFORE REPLACING EXISTING RADIATORS.
- ANY NEW PROPOSED PIPE ROUTE TO BE AGREED.
- THIS DRAWING SHOULD BE READ WITH THE EXISTING AND PROPOSED RADIATOR SCHEDULE.
- CONTRACTOR TO INVESTIGATE EXISTING REFRIGERANT PIPE ROUTE AND PROPOSED THE NEW REFRIGERANT PIPE ROUTE

LEGEND

- EXISTING RADIATOR AND RELEVANT PIPEWORK CONNECTION TO BE STRIPPED OUT AND MAKE REDUNDANT.
- NEW PROPOSED RADIATOR TO REPLACED EXISTING PIPEWORK, NEW PIPEWORK CONNECTION AND MODIFICATION REQUIRED.
- NEW RADIATOR - NEW PIPEWORK CONNECTION REQUIRED FROM THE NEAREST LTHW BRANCH.
- EXISTING RADIATOR TO BE STRIPPED OUT AND REPLACED WITH NEW RADIATOR, NEW PIPEWORK CONNECTION AND MODIFICATION REQUIRED.
- R.XX.XX TOWEL RAIL / RADIATOR REFERENCE
- S SPACE TEMPERATURE SENSOR
- T SPACE THERMOSTAT
- FAN COIL / VRF UNIT

ABBREVIATIONS

- LL LOW LEVEL
- MIL MID LEVEL
- HIL HIGH LEVEL
- DFA DROP FROM ABOVE
- DTB DROP TO BELOW
- RFB RISE FROM BELOW
- RTA RISE TO ABOVE

P02	TENDER ISSUE	VK	YE	05.09.23	
P01	PRELIMINARY ISSUE	VK	YE	10.08.23	
REV	DESCRIPTION	BY	CHK	APP	DATE

Project Status: **LBC SUBMISSION**

The Multi-disciplinary Engineering Consultancy

h HARLEY HADDOW

Unit A2, Hatchers Yard, 9 Tanner Street
London, SE1 3LE
T 44 (0) 203 735 5060
E london@harleyhaddow.com
Edinburgh | Glasgow | London | Manchester
harleyhaddow.com
Association for Consultancy and Engineering Member Firm

Project: 310311
**GERMAN HISTORICAL INSTITUTE
17 BLOOMSBURY SQUARE**

Drawing Title:
GROUND FLOOR EXISTING MECHANICAL STRIP OUT LAYOUT

Scale @ A1	Date	Engineer	Revision
1:50	JULY 23	YE	
Drawing No.	310311-HAH-XX-00-D-M-05611		P02

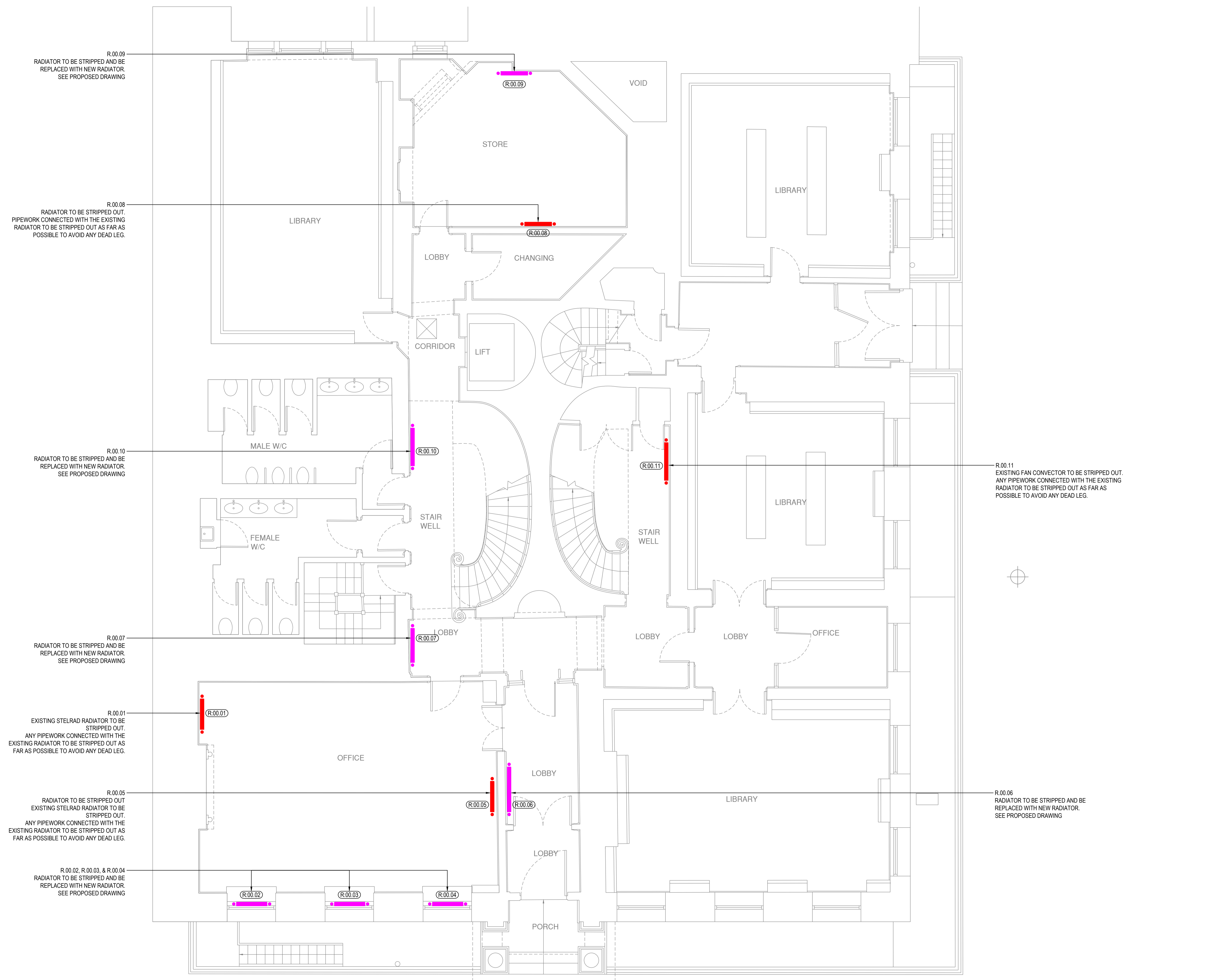







THIS DRAWING IS INDICATIVE AND REPRESENTS ONLY THE DESIGN INTENT. THE CONTRACTOR MUST PRODUCE FULLY CO-ORDINATED WORKING / INSTALLATION DRAWINGS AS REFERRED TO IN THE CONTRACT DOCUMENTATION

HEATING NOTES

- DO NOT SCALE FROM THIS DRAWING. ALL DIMENSIONS INDICATED ARE IN MILLIMETERS
- DRAWING TO BE READ IN CONJUNCTION WITH SPECIFICATION, DOCUMENTATION, DRAWINGS & ALL RELEVANT BRITISH STANDARD DOCUMENTS
- THE HEATING INSTALLATION SHALL COMPLY WITH THE REQUIREMENTS OF BS EN 12828:2012, BS EN 12831:2017 AND THE BUILDING REGULATIONS 2010.
- ALL FITTINGS, PIPEWORK, PLANT & EQUIPMENT TO BE INSTALLED, REGULATED & TESTED IN ACCORDANCE WITH THE MANUFACTURERS PRINTED INSTRUCTIONS.
- ALL HIGH POINTS IN SYSTEM TO INCLUDE AUTOMATIC AIR VALVE & ALL LOW POINTS INCLUDE A DRAIN OFF COCK.
- ALL PIPEWORK TO BE ADEQUATELY SUPPORTED THROUGHOUT ITS LENGTH.
- ALL PIPES PASSING THROUGH FIRE STOP BARRIERS TO BE SLEEVED BEYOND THE BARRIER TO A MINIMUM LENGTH OF 300mm WITH BARRIER FIRE STOP MATERIAL.
- ALL FINAL CONNECTIONS TO TOWEL RAILS / RADIATORS TO BE 15mmØ STAINLESS STEEL OR CHROMED COPPER UNLESS OTHERWISE STATED.
- ALL PIPEWORK WITHIN NON ACCESSIBLE CEILINGS & WITHIN FLOOR TRENCHES TO BE FULLY WELDED/BRAZED.
- EXISTING RADIATORS TO BE REPLACED WITH EQUAL OR GREATER HEAT OUTPUT THAN CURRENTLY INSTALLED.
- VALIDATION FOR PIPE WORK ROUTES, WATER FLOW RATE, TEMPERATURE AND PRESSURE WOULD BE REQUIRED PRIOR TO ANY WORKS.
- THE CONTRACTOR SHOULD PROVIDE 2 OPTIONS FOR REPLACING THE EXISTING RADIATORS.
OPTION 1- DRAIN DOWN THE SYSTEM, RECONNECT NEW RADIATORS INCLUDING FLUSHING THE SYSTEM AND COMMISSION.
OPTION 2- LOCALIZED FREEZING THE PIPE WORKS AND REPLACE THE RADIATORS.
- FINAL RADIATOR SELECTION TO BE COORDINATED AND CONFIRMED WITH THE ARCHITECT.
- OPENING UP FLOORS WOULD BE REQUIRED TO SURVEY THE EXTENT OF PIPE ROUTING BEFORE REPLACING EXISTING RADIATORS.
- ANY NEW PROPOSED PIPE ROUTE TO BE AGREED.
- THIS DRAWING SHOULD BE READ WITH THE EXISTING AND PROPOSED RADIATOR SCHEDULE.
- CONTRACTOR TO INVESTIGATE EXISTING REFRIGERANT PIPE ROUTE AND PROPOSED THE NEW REFRIGERANT PIPE ROUTE

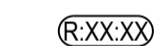
LEGEND

-  EXISTING RADIATOR AND RELEVANT PIPEWORK CONNECTION TO BE STRIPPED OUT AND MAKE REDUNDANT.
-  NEW PROPOSED RADIATOR TO REPLACED EXISTING PIPEWORK. NEW PIPEWORK CONNECTION AND MODIFICATION REQUIRED.
-  NEW RADIATOR - NEW PIPEWORK CONNECTION REQUIRED FROM THE NEAREST LTHW BRANCH.
-  EXISTING RADIATOR TO BE STRIPPED OUT AND REPLACED WITH NEW RADIATOR. NEW PIPEWORK CONNECTION AND MODIFICATION REQUIRED.
-  TOWEL RAIL / RADIATOR REFERENCE
-  SPACE TEMPERATURE SENSOR
-  SPACE THERMOSTAT
-  FAN COIL / VRF UNIT

ABBREVIATIONS

- L/L LOW LEVEL
- M/L MID LEVEL
- H/L HIGH LEVEL
- DFA DROP FROM ABOVE
- DTB DROP TO BELOW
- RFB RISE FROM BELOW
- RTA RISE TO ABOVE

P02	TENDER ISSUE	VK	YE	05.09.23	
P01	PRELIMINARY ISSUE	VK	YE	10.08.23	
REV	DESCRIPTION	BY	CHK	APP	DATE

Project Status:
LBC SUBMISSION

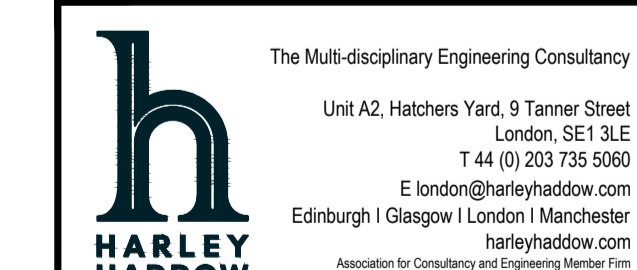

The Multi-disciplinary Engineering Consultancy
Unit A2, Hatchers Yard, 9 Tanner Street
London, SE1 3LE
T 44 (0) 203 735 5060
E london@harleyhaddow.com
Edinburgh | Glasgow | London | Manchester
harleyhaddow.com
harleyhaddow.com
Association for Consultancy and Engineering Member Firm

Project: 310311
**GERMAN HISTORICAL INSTITUTE
17 BLOOMSBURY SQUARE**

Drawing Title:
FIRST FLOOR EXISTING MECHANICAL STRIP OUT LAYOUT

Scale @ A1	Date	Engineer
1:50	JULY 23	YE

Drawing No.	Revision
310311-HAH-XX-01-D-M-05611	P02

