

1 G.49 LOBBY - EXISTING GA PLAN
6410 1:50 @ A1

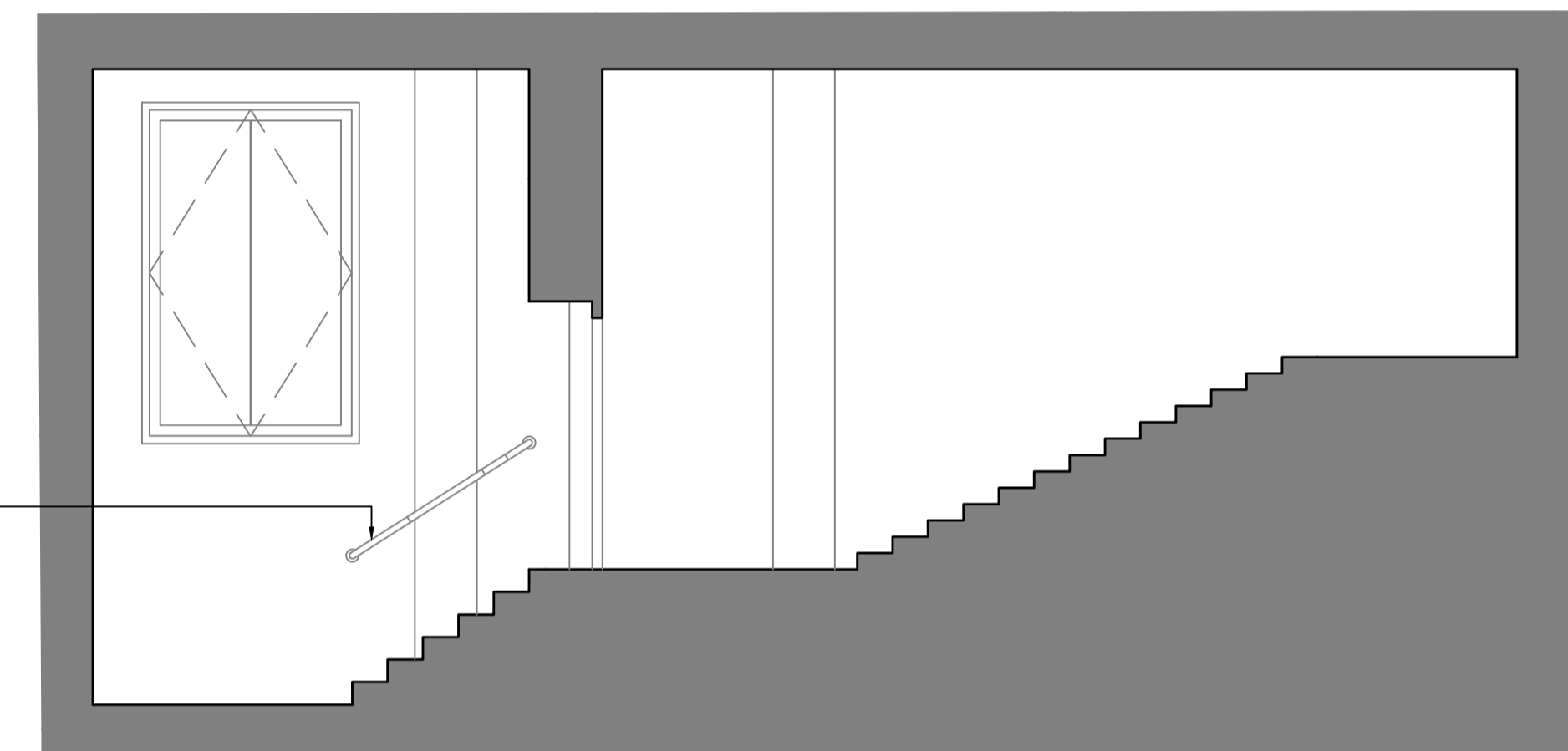

3 G.45 LOBBY - EXISTING ELEVATION
6410 1:50 @ A1

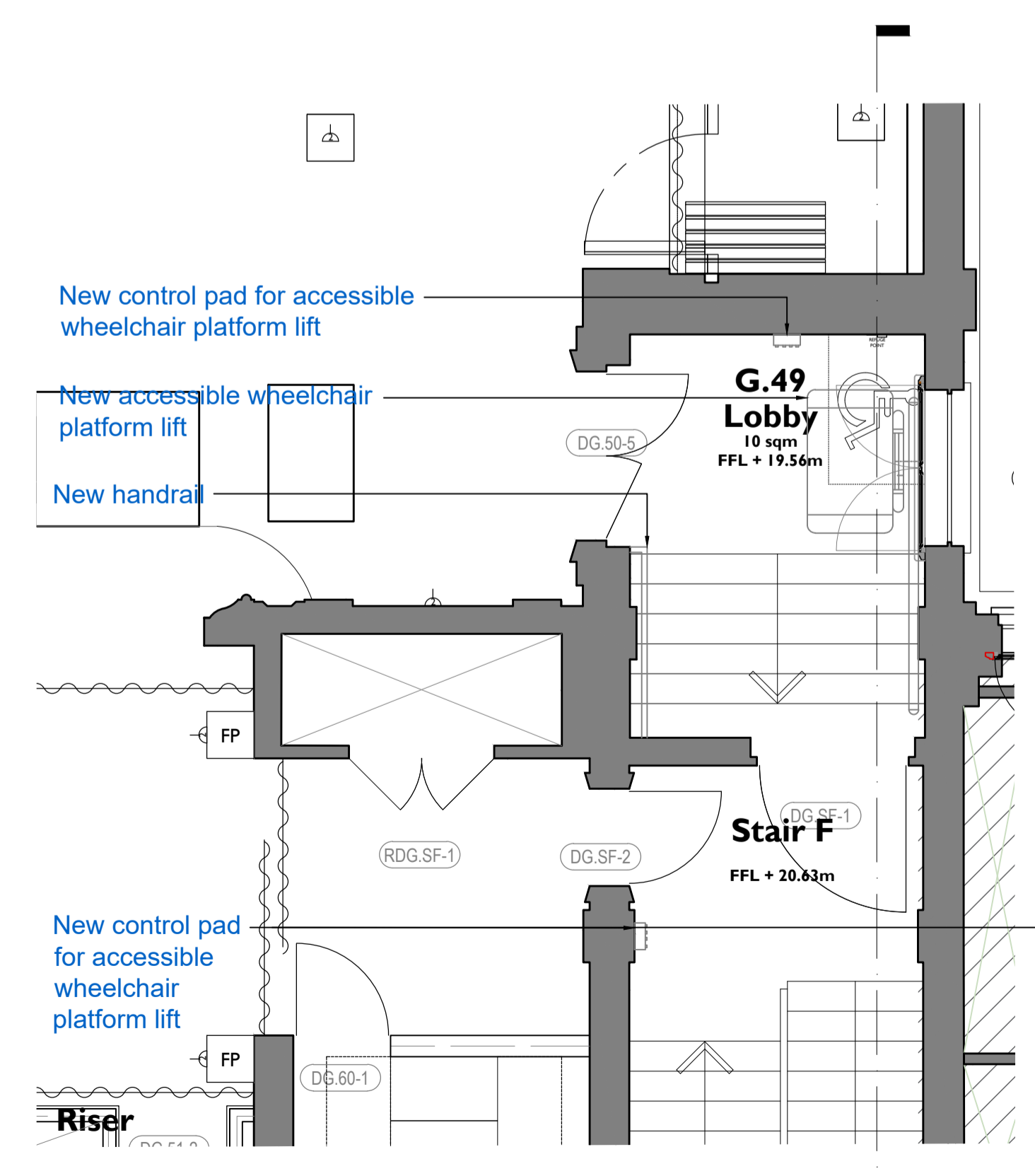

2 G.45 LOBBY - PROPOSED GA PLAN
6410 1:50 @ A1

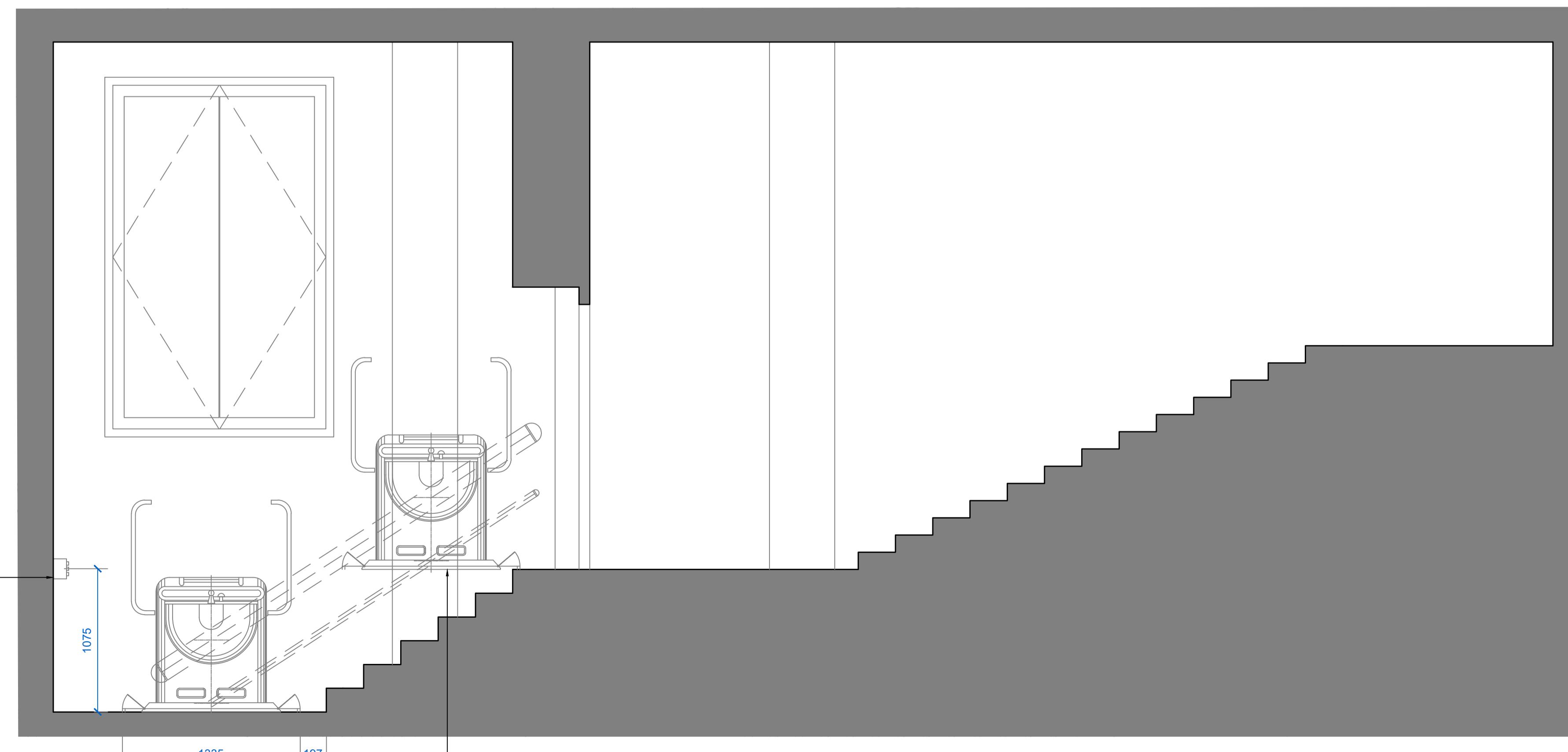

4 G.45 LOBBY - PROPOSED ELEVATION
6410 1:25 @ A1

Notes:
 Drawings are based on survey data and may not accurately represent what is physically present.
 Do not scale from this drawing. All dimensions are to be verified on site before proceeding with the work.
 All dimensions are in millimetres unless noted otherwise.
 Purcell shall be notified in writing of any discrepancies.

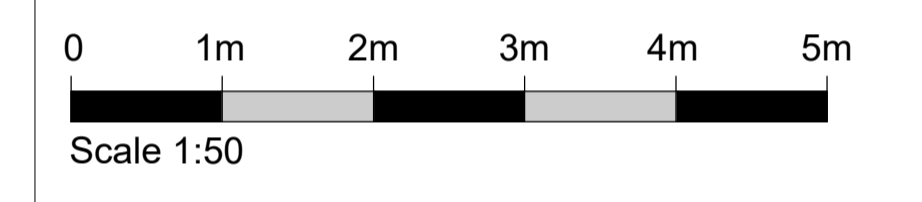
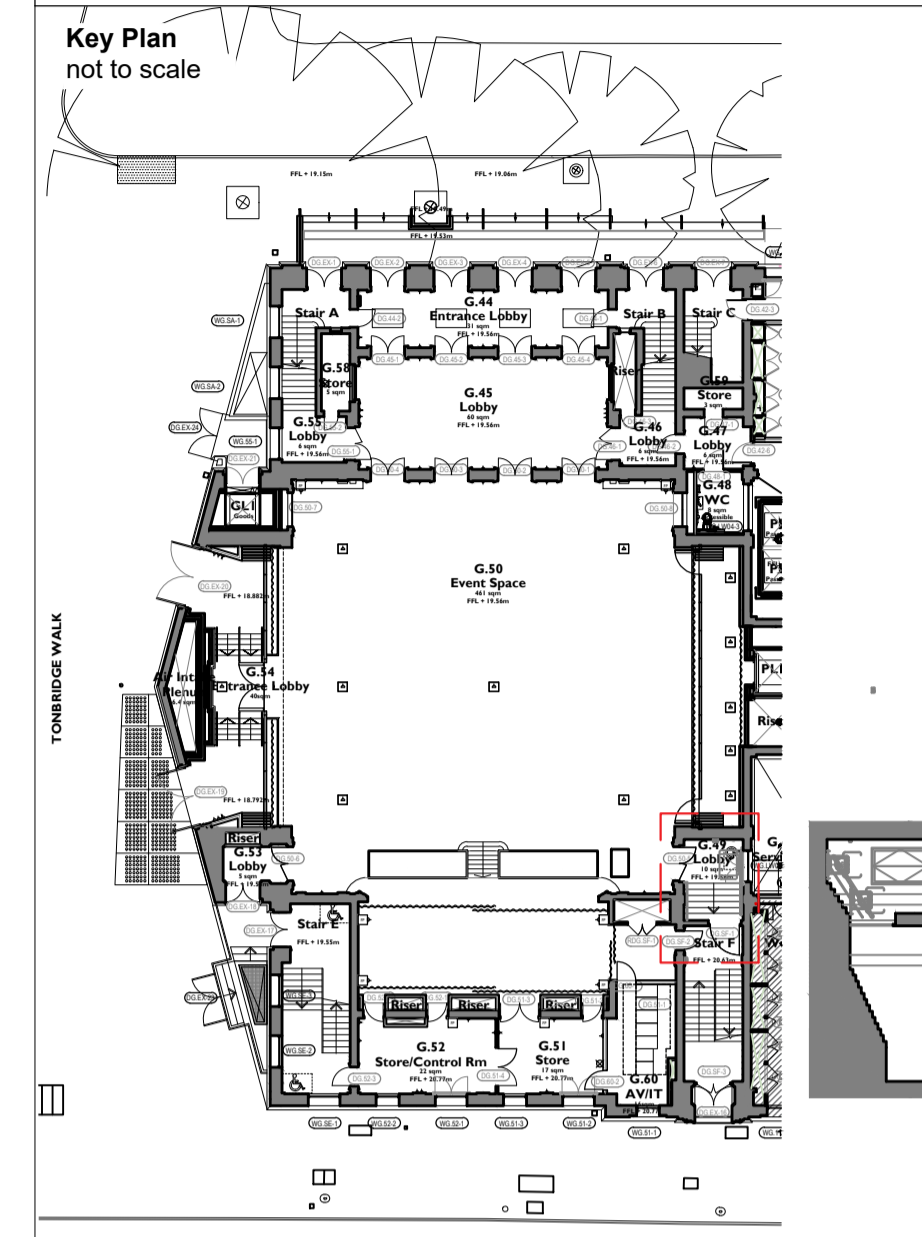

REV	DATE	BY	CHK	DESCRIPTION
P01	12.12.24	DZ	JE	For LBC

CLIENT
Il Bottaccio
 PROJECT
Camden Town Hall Tenant Fitout
 JOB NUMBER
242931

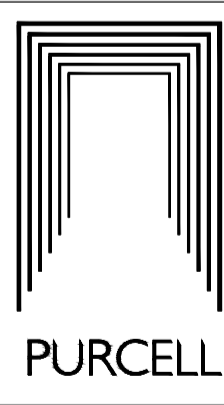

TITLE
G.49 LOBBY - Addition of new accessible wheelchair platform lift

SIZE SCALE
 A1L 1:25 / 1:50

REV SUITABILITY/REASON FOR ISSUE
P01 S4 - For Review and Authorisation

DRAWING NUMBER
242931-PUR-01-GF-DR-A-6410

PURCELL® IS THE REGISTERED TRADE NAME FOR PURCELL ARCHITECTURE LTD AND ALL SUBSIDIARY COMPANIES AND IS REGISTERED IN THE UNITED KINGDOM, EUROPEAN UNION, HONG KONG, CHINA AND AUSTRALIA. © PURCELL 2024. www.purcell.com