

Existing doors replaced with upgraded acoustic doors. Refer to drawings:

- 242931-PUR-01-GF-DR-A-1001
- 242931-PUR-01-GF-DR-A-6062
- 242931-PUR-01-GF-DR-A-6063
- 242931-PUR-01-GF-DR-A-6064
- 242931-PUR-01-GF-DR-A-6065

G.45 Lobby replacing exist parquet floor with marble. Refer to drawings:

- 242931-PUR-01-GF-DR-A-6210

G.45 Lobby retaining existing wall poster boxes and placing 8 No. freestanding floor fixed digital wayfinding screens and floor boxes in skirting to each screen. Refer to drawings:

- 242931-PUR-01-GF-DR-A-6060
- 242931-PUR-01-GF-DR-A-6061

G.49 Lobby Moving existing handrail to opposite wall and addition of new wheelchair platform lift. Refer to drawings:

- 242931-PUR-01-GF-DR-A-6410

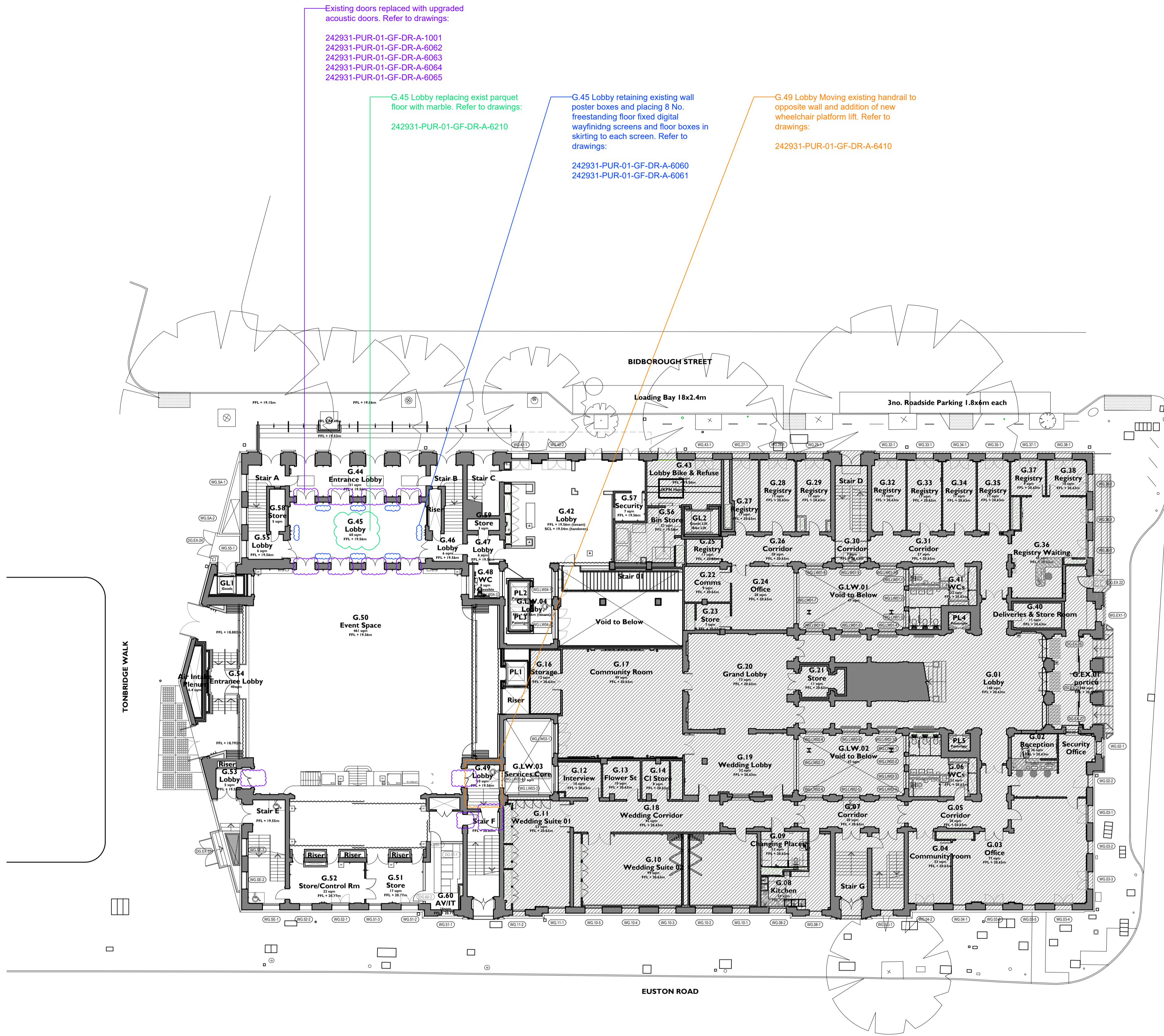

Notes:

Drawings are based on survey data and may not accurately represent what is physically present.

Do not scale from this drawing. All dimensions are to be verified on site before proceeding with the work.

All dimensions are in millimetres unless noted otherwise.

Purcell shall be notified in writing of any discrepancies.

Key Plan
not to scale

1:200 Scale



P01	20.12.24	DZ	OB	For LBC
REV	DATE	BY	CHK	DESCRIPTION

CLIENT
Il Bottaccio

PROJECT
Camden Town Hall Tenant Fitout

JOB NUMBER
242931

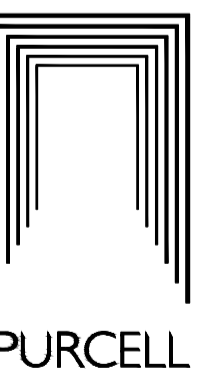

TITLE
PROPOSED GROUND FLOOR PLAN

SIZE SCALE
A1L 1:200

REV SUITABILITY/REASON FOR ISSUE
P01 S4 - For Review and Authorisation

DRAWING NUMBER
242931-PUR-01-GF-DR-A-9201