

PLAN WITH ROOF REMOVED

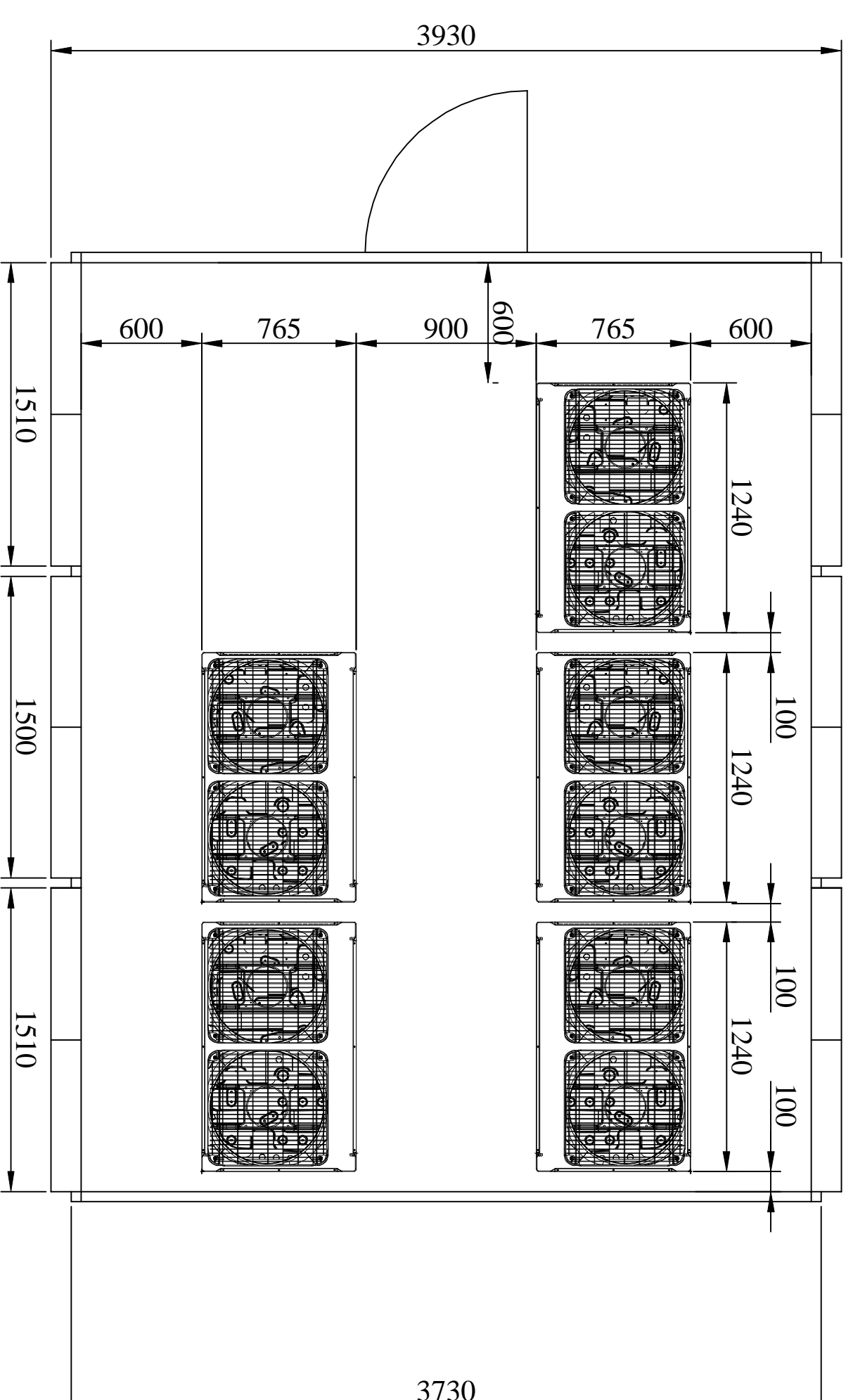

SPECIFICATION

Acoustic Housing around the following condensing units

- 3 number Daikin type REYA20A units
- 1 number Daikin type REYA16A units
- 1 number Daikin type REYA14A units

And will comprising the following.

- Type WSD150 Acoustic Intake Louvres
- Type WSD150 Acoustic Exhaust Louvres
- Type ESD50 Acoustic Panels
- Type ESD50 Access Door
- Pentapost Frame

Finish to be painted to a standard RAL colour.

Louvres to have birdmesh guards to the rear face.

Pressure loss to be 30Pa against a total duty of 20, 1m3/s.

END SECTION

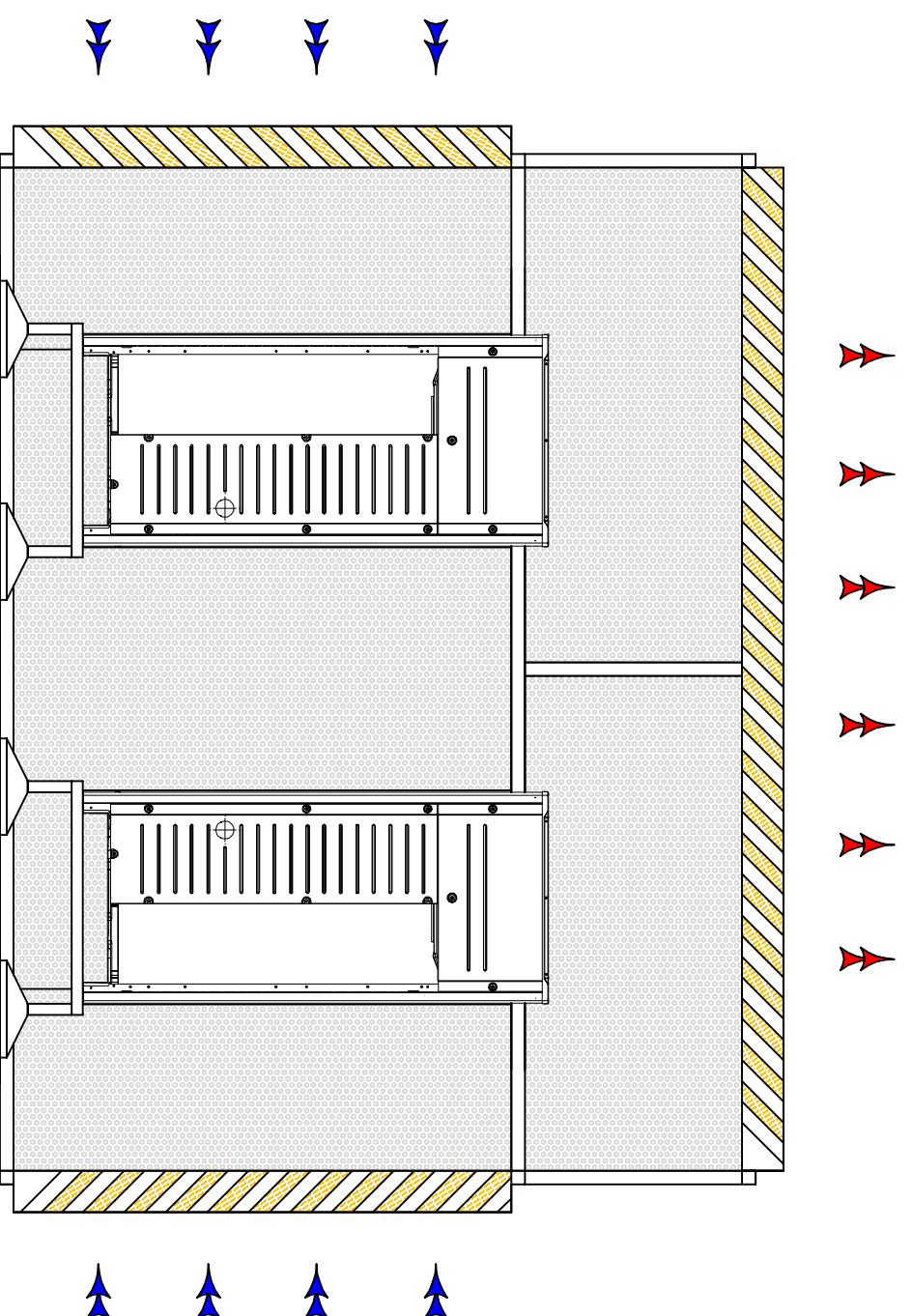

PLAN

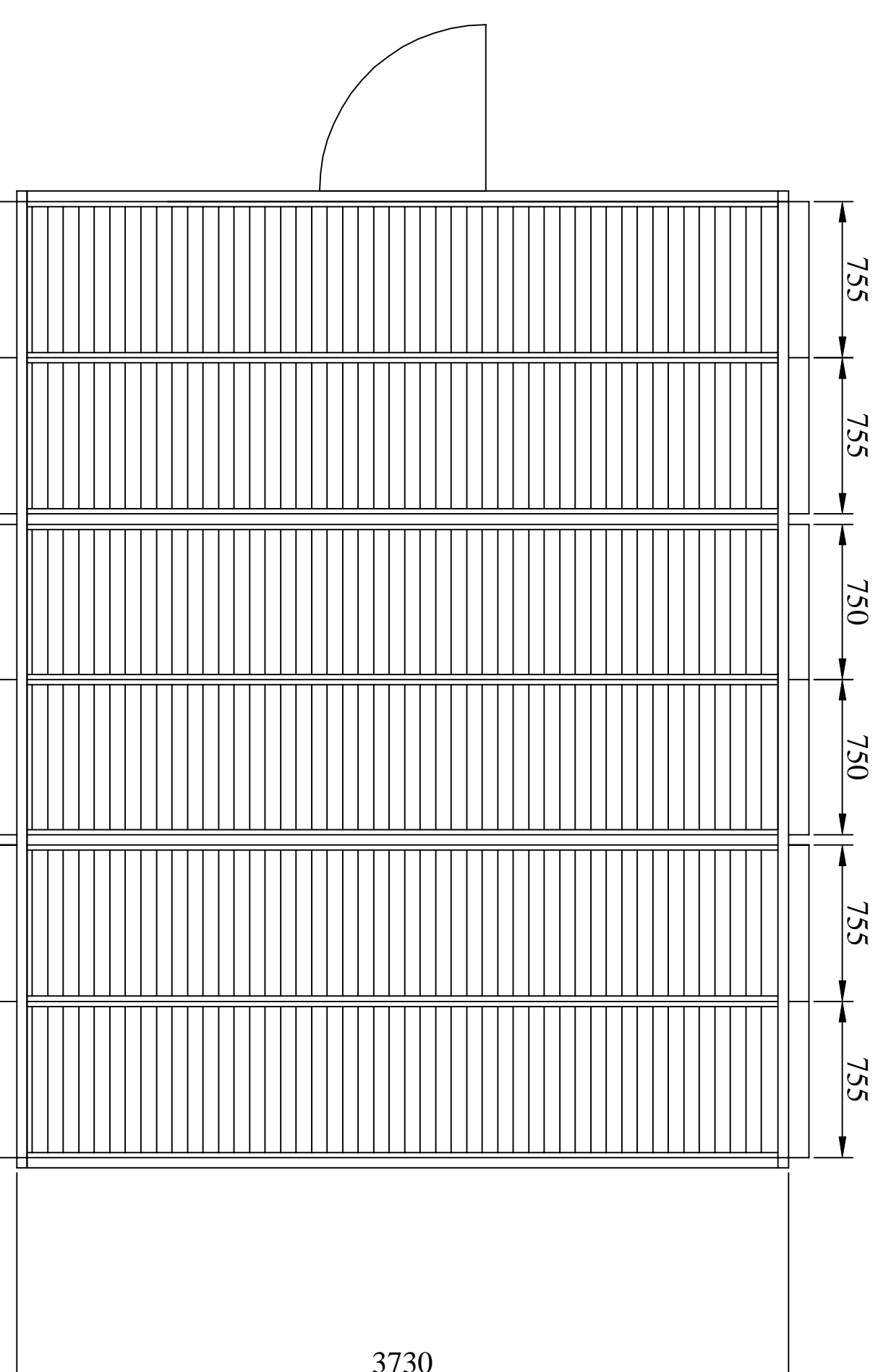

LEFT HAND END VIEW

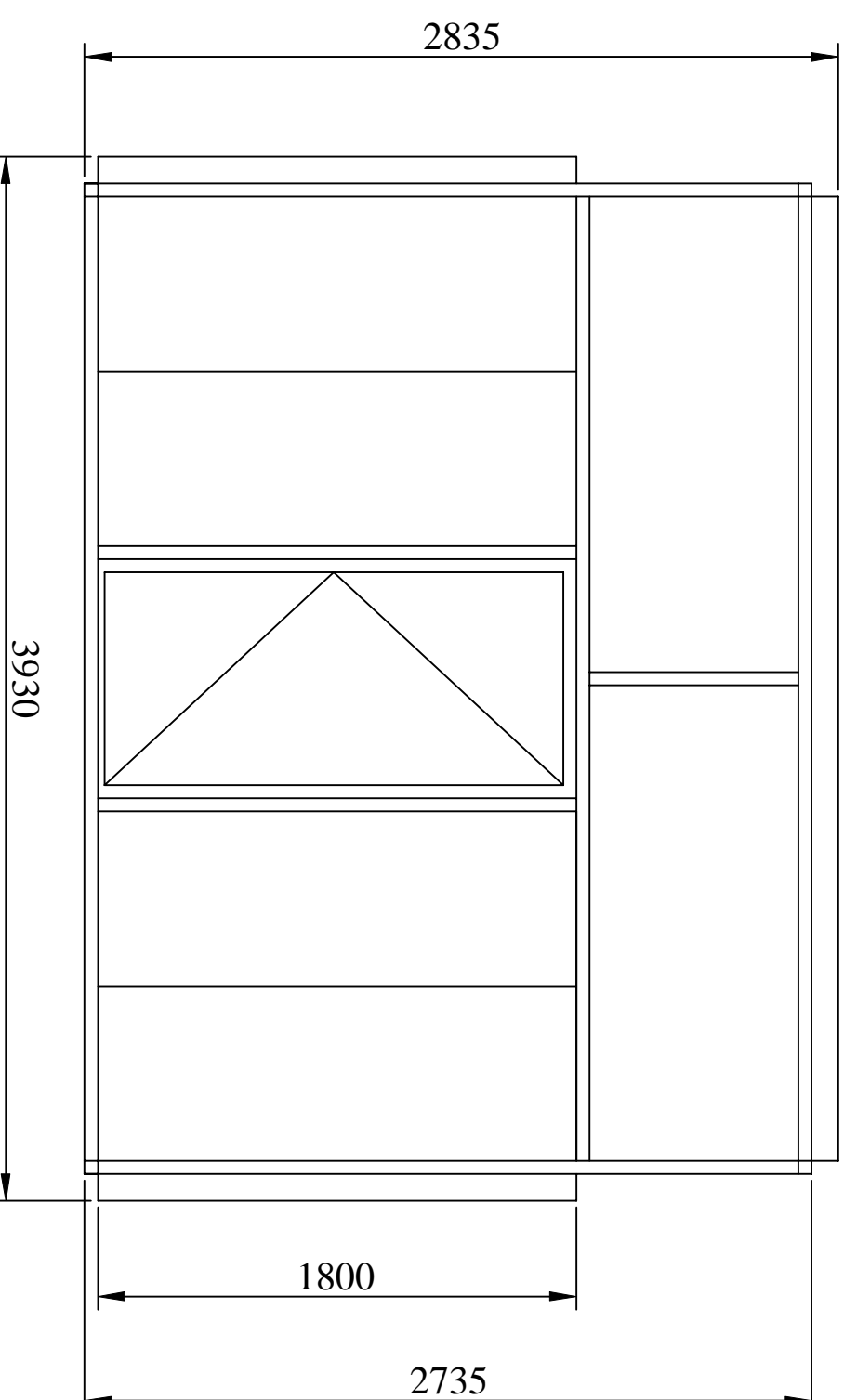

FRONT/REAR ELEVATION

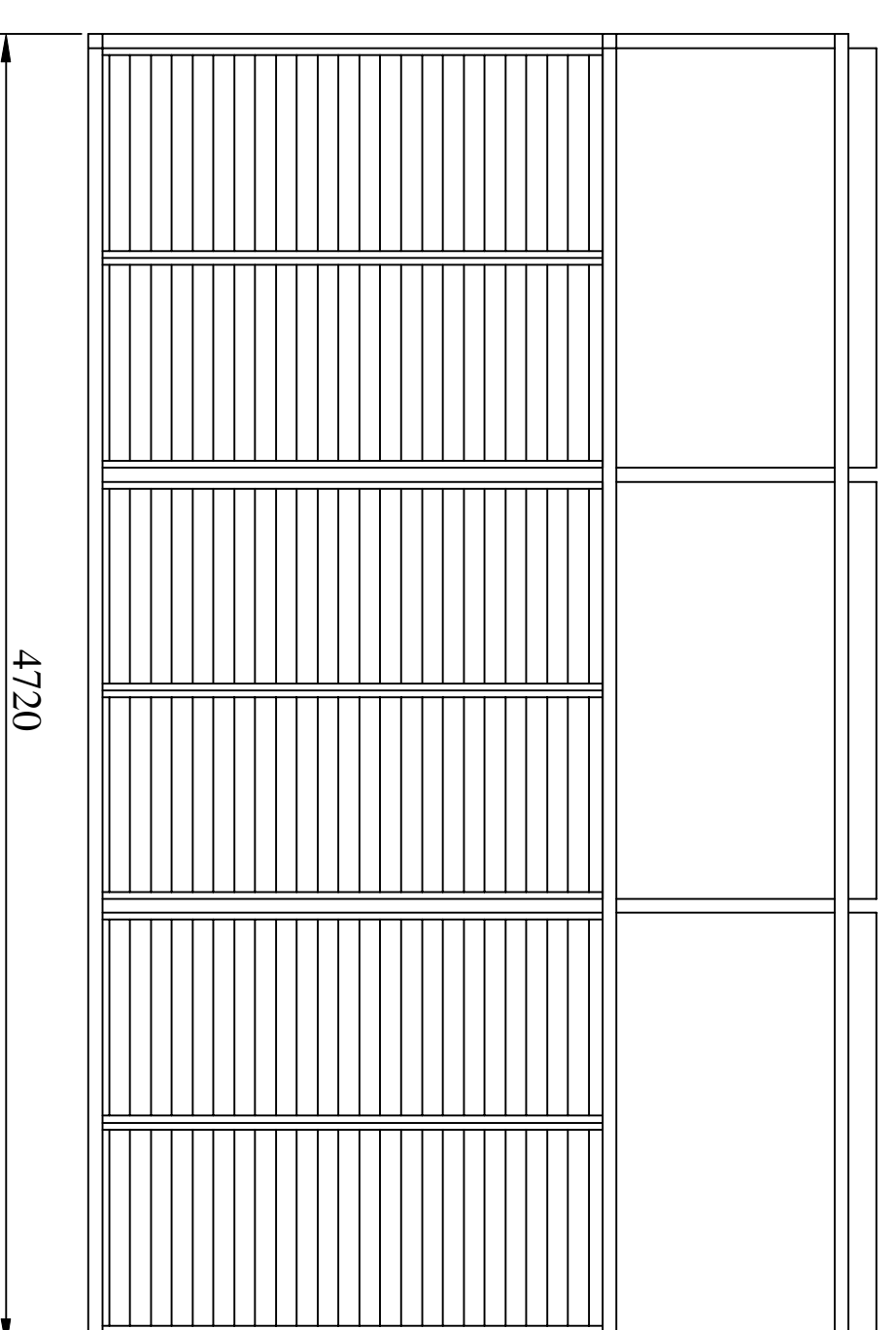

RIGHT HAND END VIEW

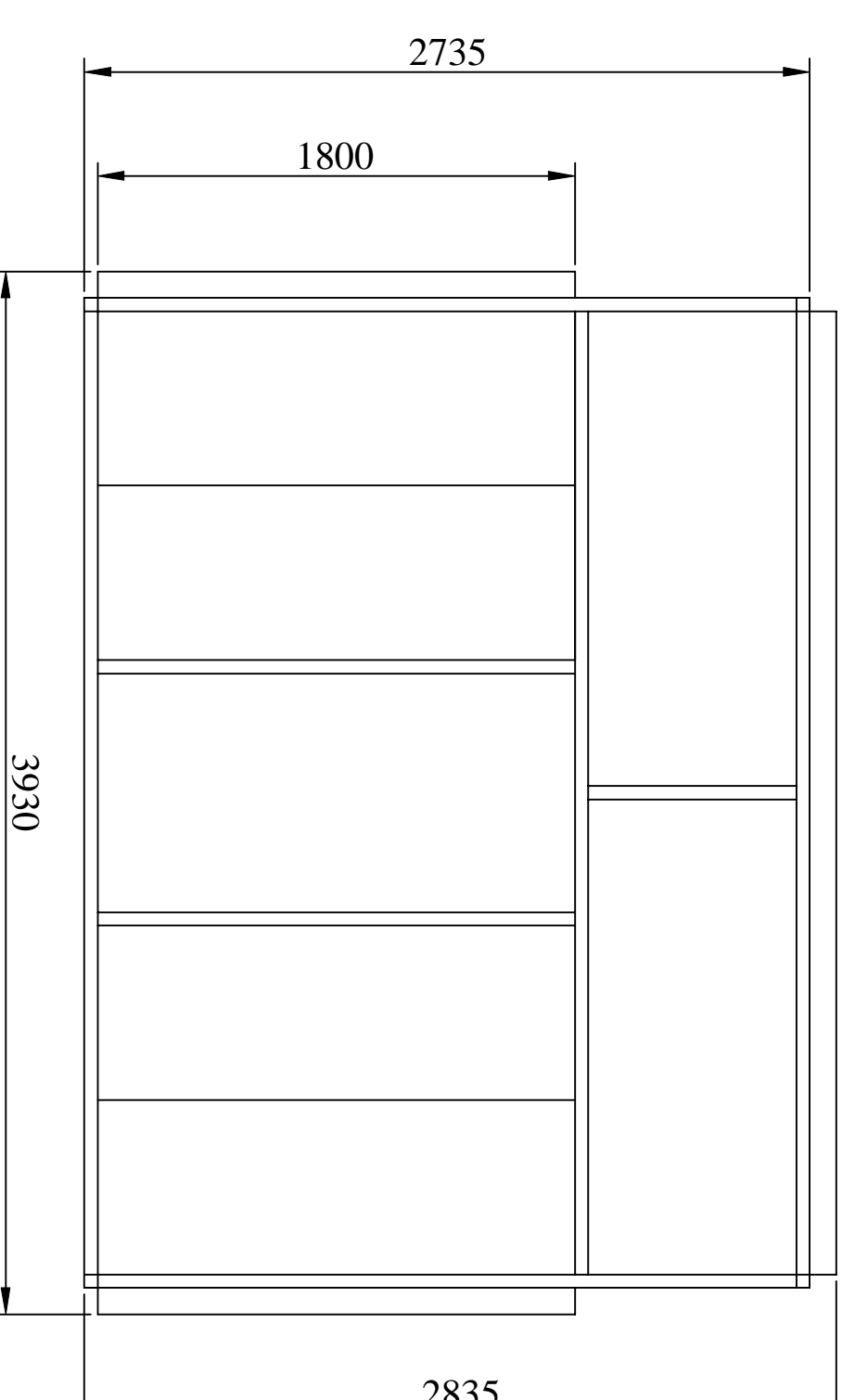

Rev	Amendment	Date
A	Sizes and Units Changed	14/10/24

 First Angle Projection unless stated	Scale 1: @ A1
---	------------------

Title
Acoustic Treatment Proposal

Project
101 Bayham Street, London NW1
OAG

Client
OOB Interiors Limited

Drawing Number
Q10150 - 100

Rev.
A

CONABEARE ACOUSTICS
11 Chiltern Enterprise Centre,
Station Road, Treadle,
Berkshire RG7 4AA
T:0118 930 3650 F:0118 930 3912
E:sales@conabeare.co.uk

Date: 18-09-2024
Issue 18-09-2024
Tender XXXX

Drawn By: slm
Checked By: XXX

The information contained on this drawing/specification is the property of Conabeare Acoustics Limited and may not be reproduced or enclosed to a third party without the written permission of Conabeare Acoustics Limited.