

1 Granby Terrace Bridge to Euston Throat Retained Cut Corner Detail - Perspective
Not to scale

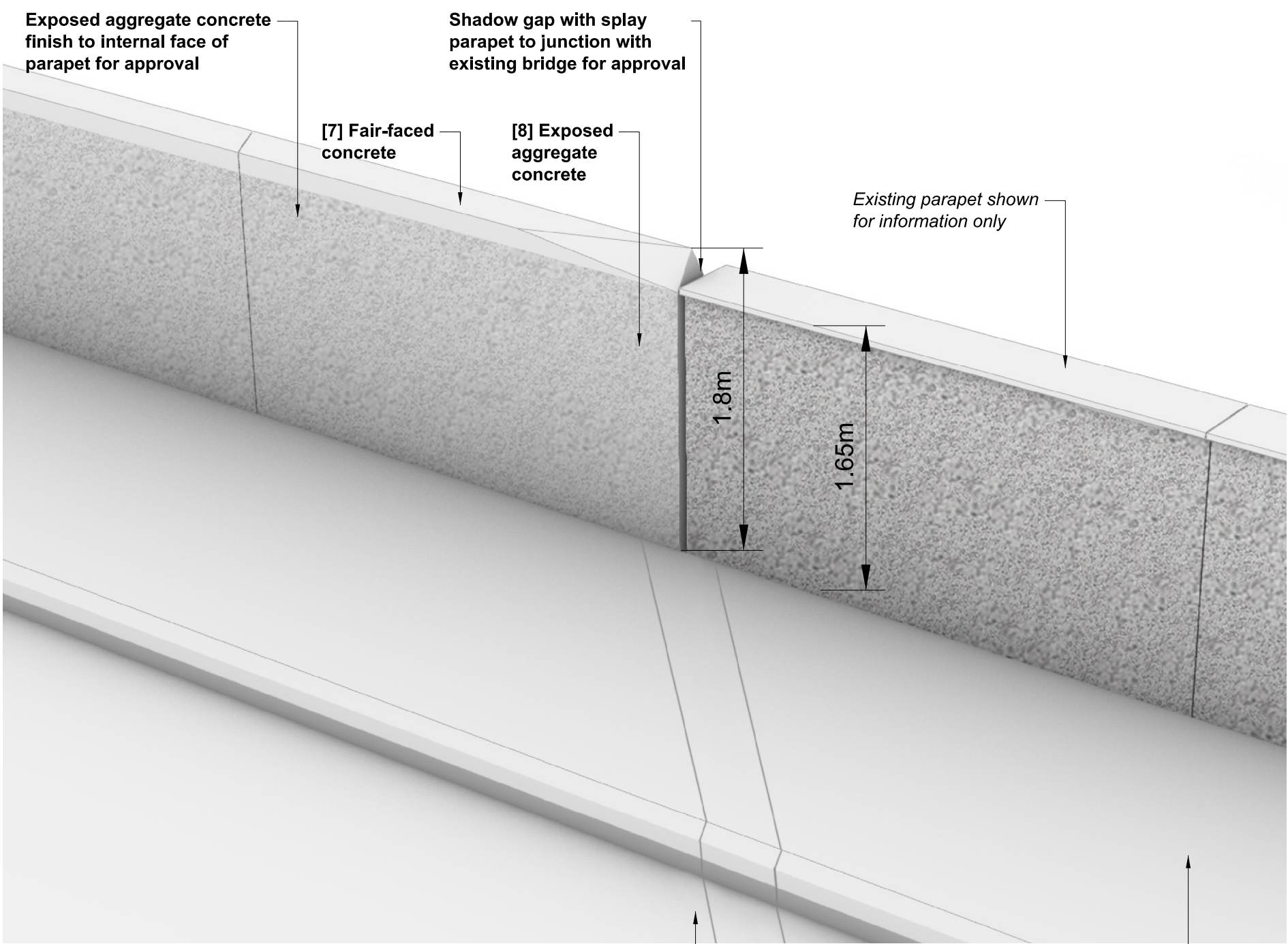

4 Parapet Transition Detail - Perspective
Not to scale

Proposed Granby Terrace Bridge extension for approval

Existing Granby Terrace Bridge for information only



7 Proposed Fair-faced Concrete Finish to External Face of Parapet



8 Proposed Exposed Aggregate Concrete Finish to Internal Face of Parapet

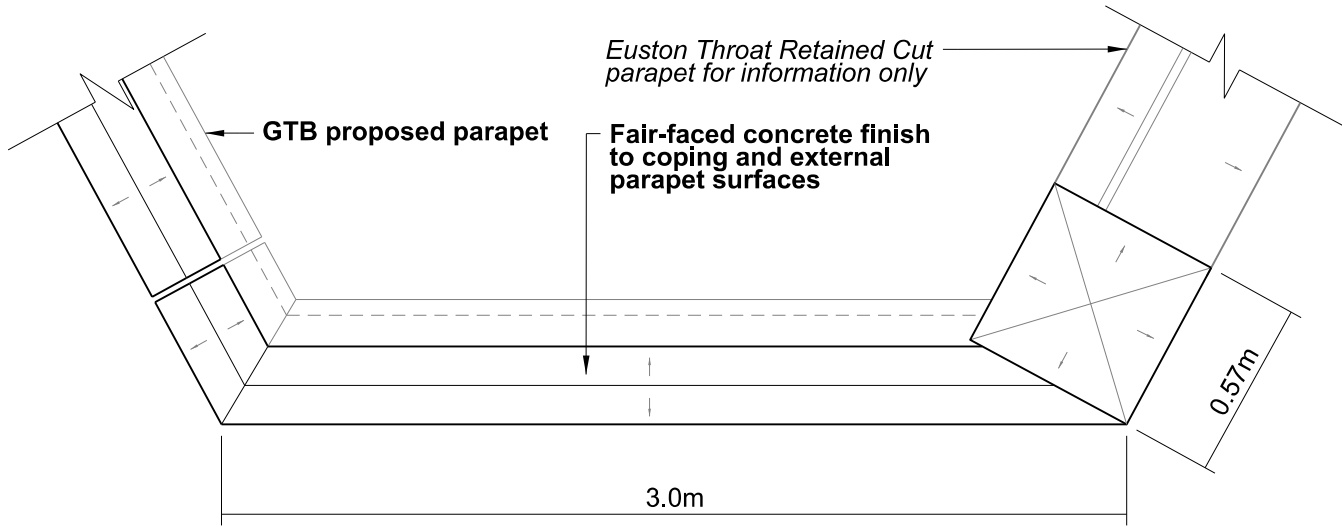

2 Granby Terrace Bridge to Euston Throat Retained Cut Corner Detail - Plan
1:25

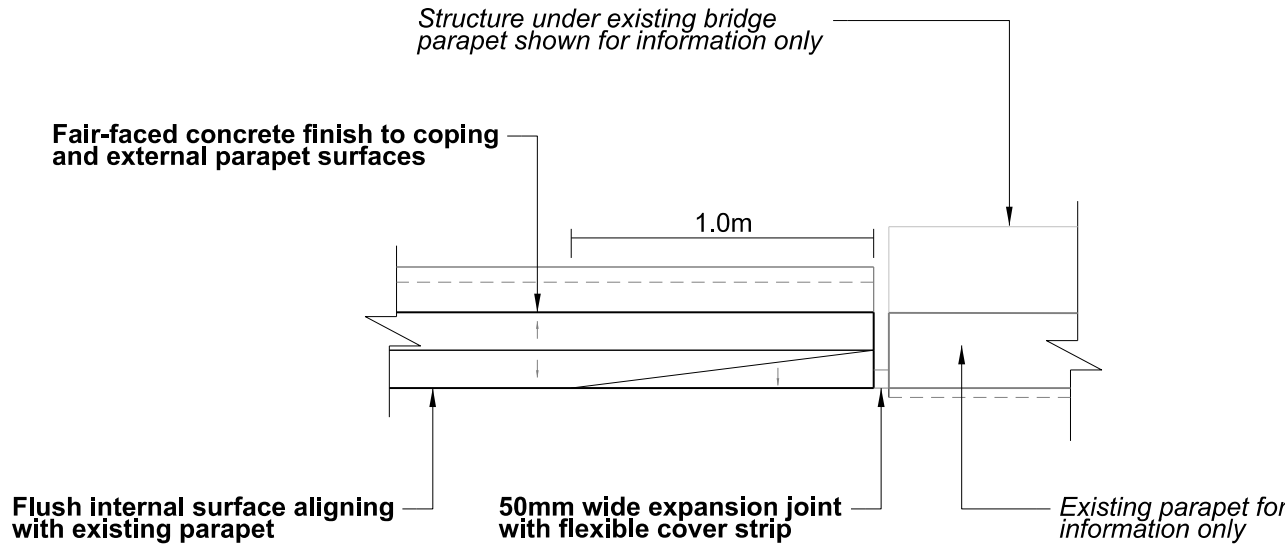

5 Parapet Transition Detail - Plan
1:25

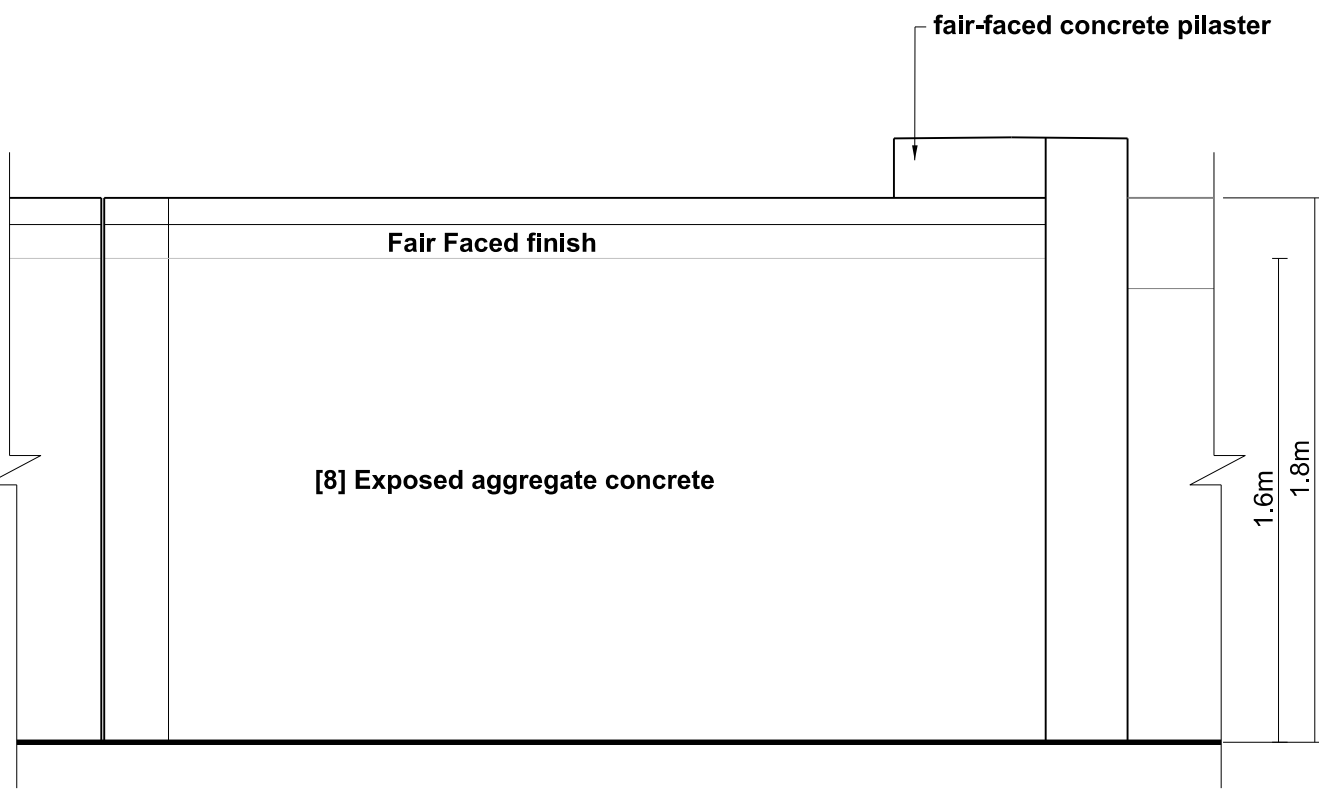

3 Granby Terrace Bridge to Euston Throat Retained Cut Corner Detail - Elevation
1:25

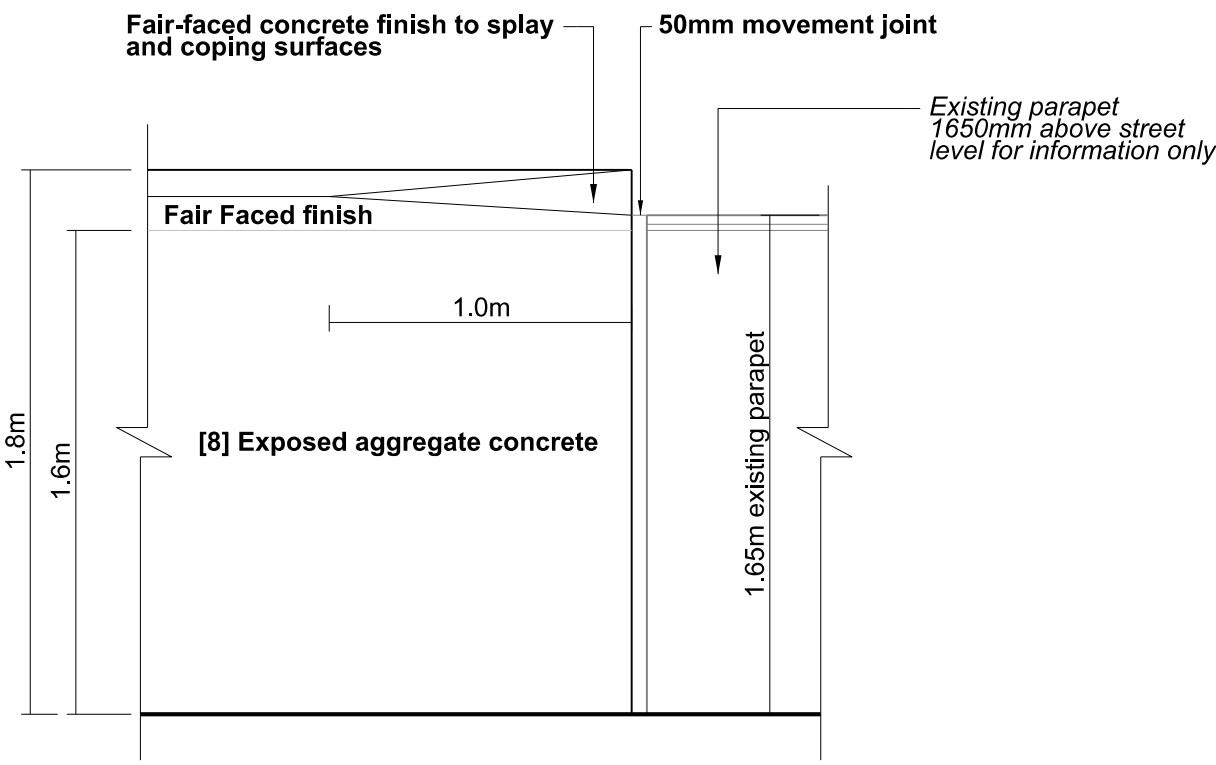

6 Parapet Transition Detail - Elevation
1:25

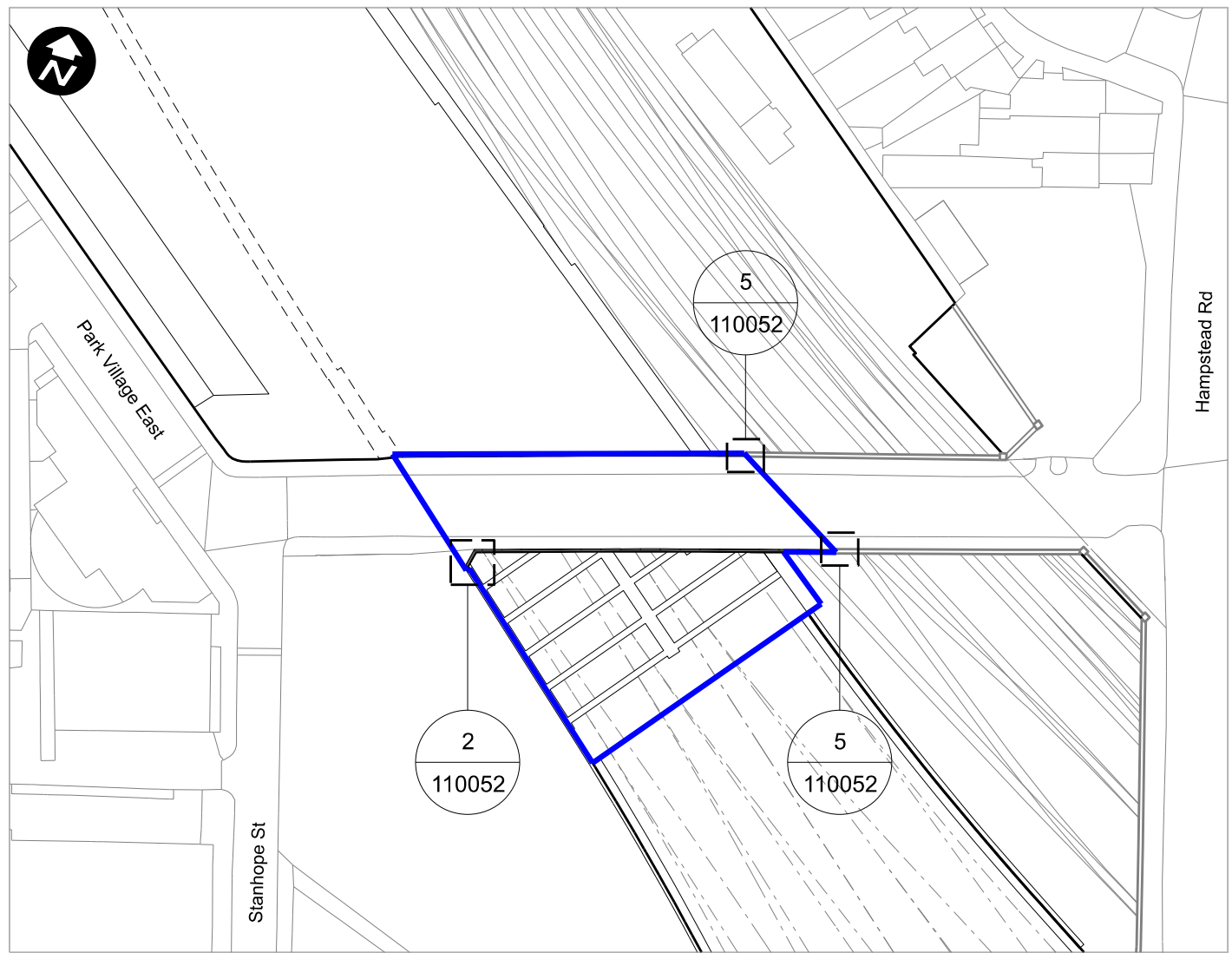

9 Keyplan
1:1000

ISSUED FOR ACCEPTANCE

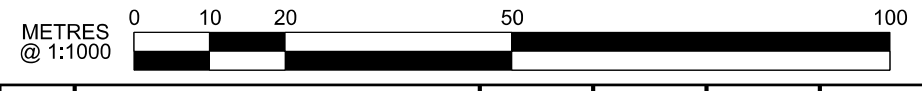

Key

Application Boundary

						HS2 accepts no responsibility for any circumstances which arise from the reproduction of this document after alteration, amendment or abbreviation or if it is issued in part or issued incompletely in any way.	Legends/Notes: G1. All dimensions are in millimetres unless noted otherwise. G2. All levels are in metres relative to OD (Ordnance Datum, Newlyn) unless noted otherwise. G3. Chainages are expressed in metres and measured from Euston Station. G4. Global coordinates are indicated by Eastings (E) and Northings (N) to the project snake grid. G5. All angles are in degrees (0°360°) unless noted otherwise. G6. Dimensions are not to be scaled from the drawing. G7. For the scope of works by the rail systems contractor, as indicatively shown on the drawings, refer to VI 100 G8. The current design is based on Project Master Alignment (PMA) 2.0
						© Crown Copyright and database right 2018. All rights reserved. Ordnance Survey Licence number 100049190	
P01	GTB_Schedule 17 Final Submission	JX	VD	12/10/20	12/10/20	© Crown Copyright material is reproduced with the permission of Land Registry under delegated authority from the Controller of HMSO.	
P02	GTB_Schedule 17 Final Re-Submission	JX	VD	07/12/20	07/12/20	This material was last updated on 2018 and may not be copied, distributed, sold or published without the formal permission of Land Registry. Only an official copy of a title plan or register obtained from the Land Registry may be used for legal or other official purposes.	
P03	GTB_Schedule 17 Final Re-Submission A	JX	VD	19/01/21	19/01/21		
Rev	Description	Drawn	Checked	Con App	HS2 App	Scale with caution as distortion can occur.	

HS2

Registered in England Registration No. 06791686
Registered office: 2 Snow Hill, Queensway, Birmingham, B4 6GA

OFFICIAL

Creator/Originator
SCS JV - Design House

Zone	Granby Terrace Bridge			Project/Contract		
Design Stage	Detailed Design			HS2-MWCC SCS Sector S1		
Drawing Title	Granby Terrace Bridge Schedule 17 Plans and Specifications Parapet Details For Approval			Discipline/Function Architectural		
Date	J Xu		Checked	V.De Siqueira	Approved	
	21/01/21		Scale	AS SHOWN	Size	
Drawing No.		1MC03-SCJ_SDH-AR-DGA-SS01_SL12-110052				Rev.
						P03