

DRAWING INFORMATION		
Rev.	Purpose	Date
-	Issued for Planning	13.11.2024

Studio Three Architects Limited. All construction works to comply with British Standards and Building Regulations requirements. Any errors on drawings or omissions should be reported to Studio Three. This drawing cannot be used to calculate areas for the purposes of valuation. All measurements should be checked on site. These drawings should not be scaled.

Drawing Legend	
Existing key	
	Existing
	Existing flat roof
	Existing slate roof
	Existing joist direction
	9 Northington St. property Not part of application
	Existing brickwork
	Existing tile floor
	Existing carpet

Demolition key	
	Demolition
	Demolition
	Demolition

- Demolition General Notes:**
- Remove all non original floor finishes in preparation for new
  - Remove areas of non original, dropped ceiling and raised access floors associated with the buildings use as an office
  - Remove emergency lighting associated with the use of the building as an office
  - Remove modern light fittings associated with the use of the building as an office
  - Remove non original internal partitions, fixtures and fittings as shown
  - Remove modern radiators in preparation for new cast iron radiators

- Demolition Notes:**
- D1** Remove non original French doors and modify opening in preparation for new
  - D2** Remove non original window and modify opening in preparation for new french doors
  - D3** Remove section of non original floor, to re install opening in original staircase location
  - D4** Demolish area of non original floor and staircase in preparation for new adjusted floor level

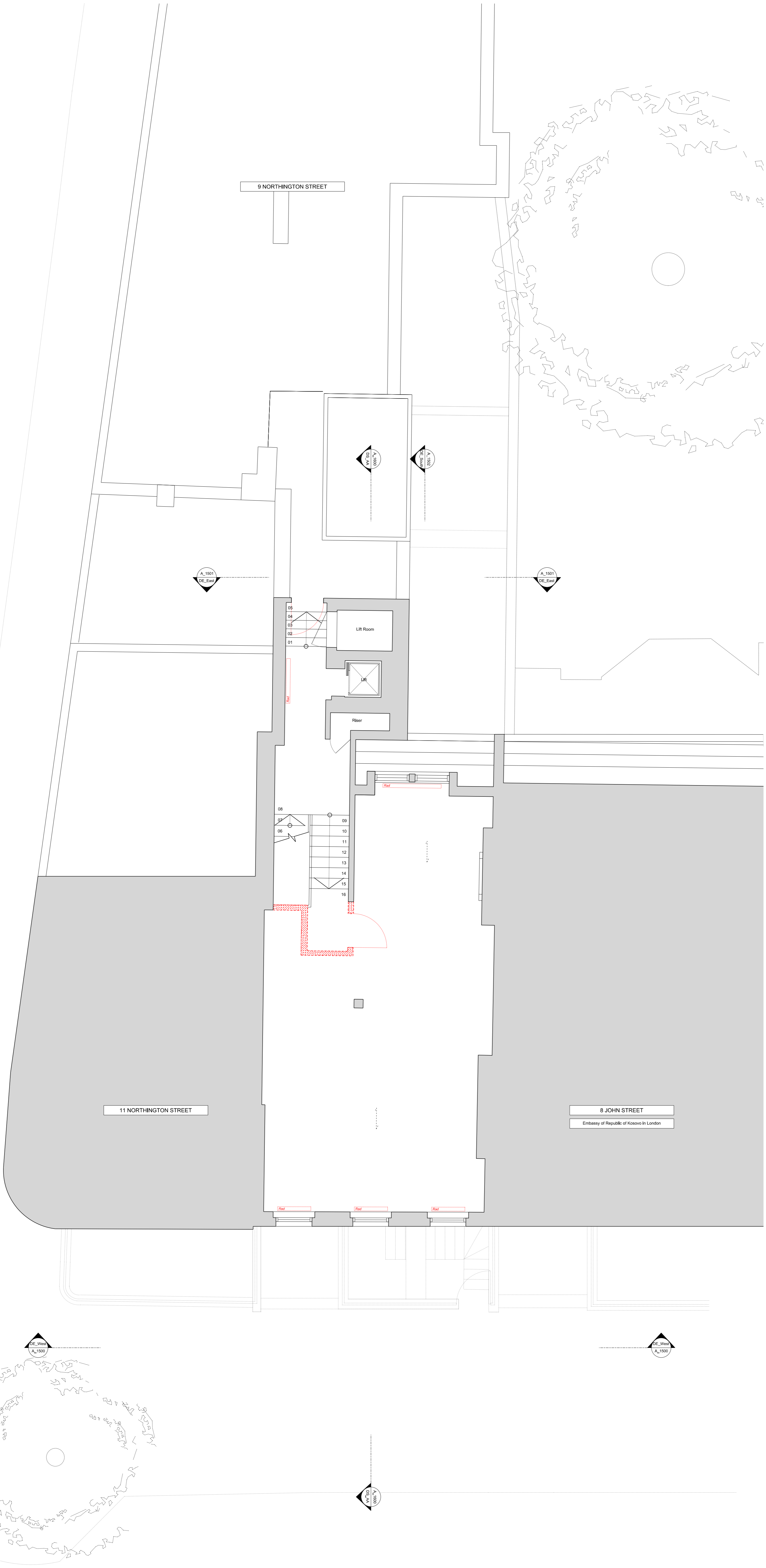

Phase

# PLANNING

Drawing title  
**Demolition Third Floor Plan**

Drawing No.	A_1403	Rev.	-
Drawn	LP	Approved	AA
First revision	13.11.2024	Updated	---

**STUDIO THREE**  
 97 Charlotte Street, London, W1T 4QA <https://www.studiothreearchitects.com>

Project No. 23093 9 John St. Address 9 John Street London WC1N 2ES

Client GFZ Ltd. Scale 1:50 @ A1 / 1:100 @ A3

