

BROOKFIELD  
PRIMARY SCHOOL

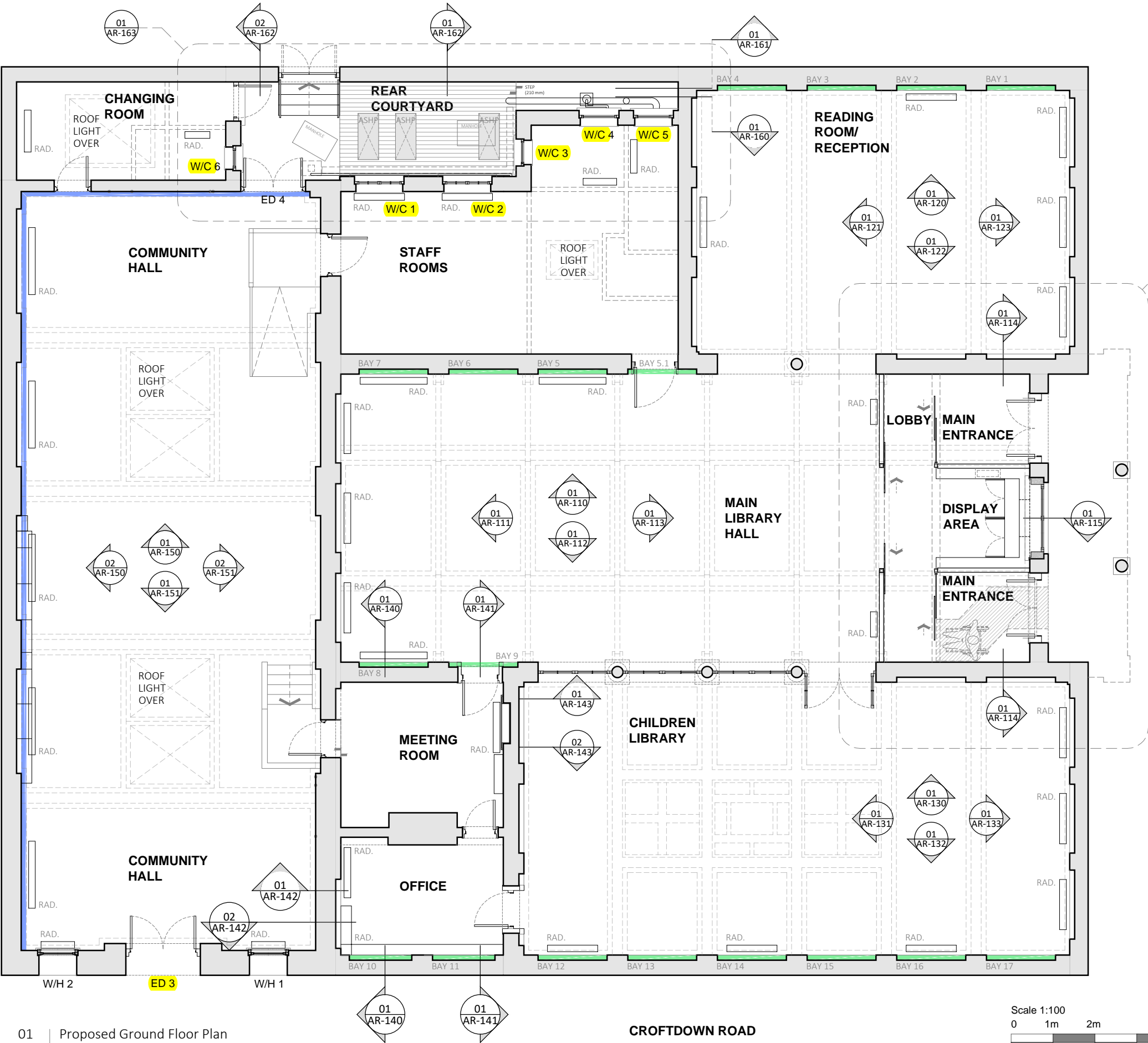

This drawing is copyright & the property of Chris Potter Associates Ltd & must not be copied in whole or in part without their written permission. Copyright is reserved. ©

This drawing must not be scaled. The Contractor is to report all dimensional discrepancies & errors to the Contract Administrator prior to construction commencing.

This drawing is to be read in conjunction with all specifications/schedule of works and all other associated documents. All works described and / or reasonably inferable from the same are deemed included in the contract sum.

**BUILDING OUTLINE**

**WEST ELEVATION**

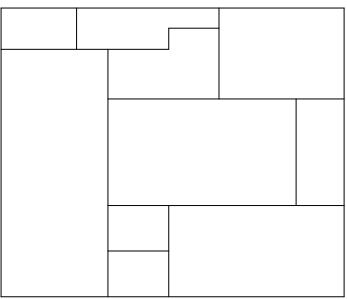

**KEY:**  
↓ or ↗ AR-000  
--- DRAWING NO.  
--- ELEVATION

**NOTES:**

- FOR WALL INSULATION PLAN AND DETAILS, PLEASE DRAWING REF. NO. 0616-CP02 AND 0616-CP03 AND APPENDIX 10.  
WOODFIBRE INSULATION WITH LIME PLASTER TO CURVED RECESSED ARCHES.  
METAL STUD INSULATED WALL LINING.
- EXISTING PIPE RUNS & CONDUIT OMITTED FOR CLARITY.
- FOR SECONDARY GLAZING DETAILS AND SPECIFICATION, PLEASE REFER TO SELECTAGLAZ REPORT NO. KB/E/73081/R0/0 AND APPENDIX 8.  
SECONDARY GLAZING HORIZONTAL SLIDING (SERIES 10 SLIMLINE).
- FOR HEATING & VENTILATION LAYOUTS AND SPECIFICATION, PLEASE REFER TO FLOH DRAWINGS AND APPENDIX 11

-	issue for planning	22.11.2023
Revisions/Status	Comments	Dates
○ Feasibility	○ Tender	○ For Client Approval
● Planning	○ Construction	○ Preliminary
○ Building Regulations	○ As Built	
Client	Camden Council	Date Nov 23
Project Title	Highgate Library Chester Road, London N19 5DH	Drawn IC
Drawing Title	Proposed Ground Floor Plan	Approved BB
		Scale 1:100 @A3
		Job No. 0955
		Dwg No. AR-101



South West Office: 3 Hearnston Street, Devon, EX33 2JS Ph: 01271 615 450  
South East Office: 20-22 Wenlock Road, London, N1 7GU Ph: 0203 934 0000  
E: info@chrispotter.co.uk  
W: www.chrispotter.co.uk

01 | Proposed Ground Floor Plan  
AR-101 | Scale 1:100 @A3

CROFTDOWN ROAD

