

WEST HEATH ROAD

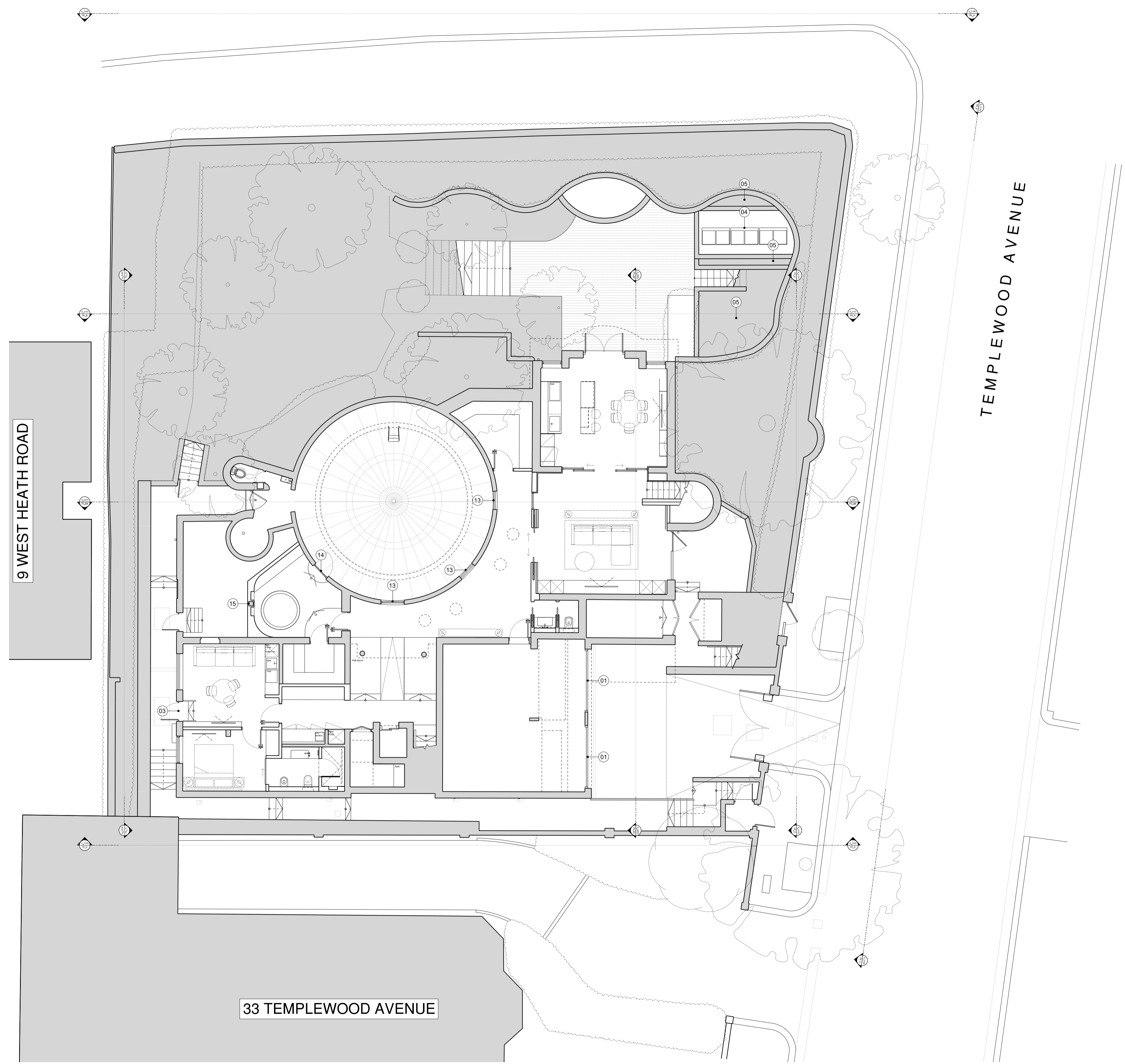

9 WEST HEATH ROAD



33 TEMPLEWOOD AVENUE

TEMPLEWOOD AVENUE

Rev.	Purpose	Date

Studio Three Architects Limited. All construction works to comply with British Standards and Building Regulations requirements. Any errors on drawings or omissions should be reported to Studio Three. This drawing cannot be used to calculate areas for the purposes of valuation. All measurements should be checked on site. These drawings should not be scaled.

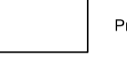
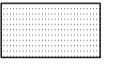
Legends & Notes

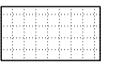
	Existing		Proposed wall / partition
	Brick		Metal Roof
	Tiles		

- Proposal Notes
- Refurbishment:
1. New up-and-over garage doors within existing opening, bronze coloured finish.
  2. New front entrance door within existing opening, bronze coloured finish.
  3. New external door within existing opening, bronze coloured finish.
  4. New external A/C condenser unit.
  5. New landscape and built-in planters to screen external A/C condenser unit.
- First Floor Extension:
6. First floor extension inset from the building perimeter constructed in red bricks to match existing.
  7. New parapets in red brick and stone to match existing. Reference existing details.
  8. New flat roof.
  9. New metal framed, double glazed window, bronze coloured finish.
  10. New solar panels on flat roof.
  11. New canopy above front door entrance in red brick to match existing.
  12. New metal framed, double glazed doors, bronze coloured finish.
- Works to Listed Swimming Pool:
13. New bronze coloured, metal framed window.
  14. New bronze coloured, glass metal framed door.
  15. New relocated column.
  16. Reinstatement of earth mound around retained pool.
  17. Existing sun 'tubes' extended to provide natural light through the earth mound.

Phase  
**PLANNING**

Drawing title  
Proposed Lower Ground Floor Plan  
**DRAFT**

Drawing No.	A_1990	Rev.	-
Drawn	MV	Approved	RD
First revision	00.00.2024	Updated	00.00.0000

**STUDIO THREE**  
31 Percy Street, London, W1T 2DD <https://www.studiothreearchitects.com>

Project No. 23088 Address Boncara 35 Templewood Avenue London NW3 7UY

Client Andrea Sambo  
Scale 1:100 @ A1 / 1:200 @ A3



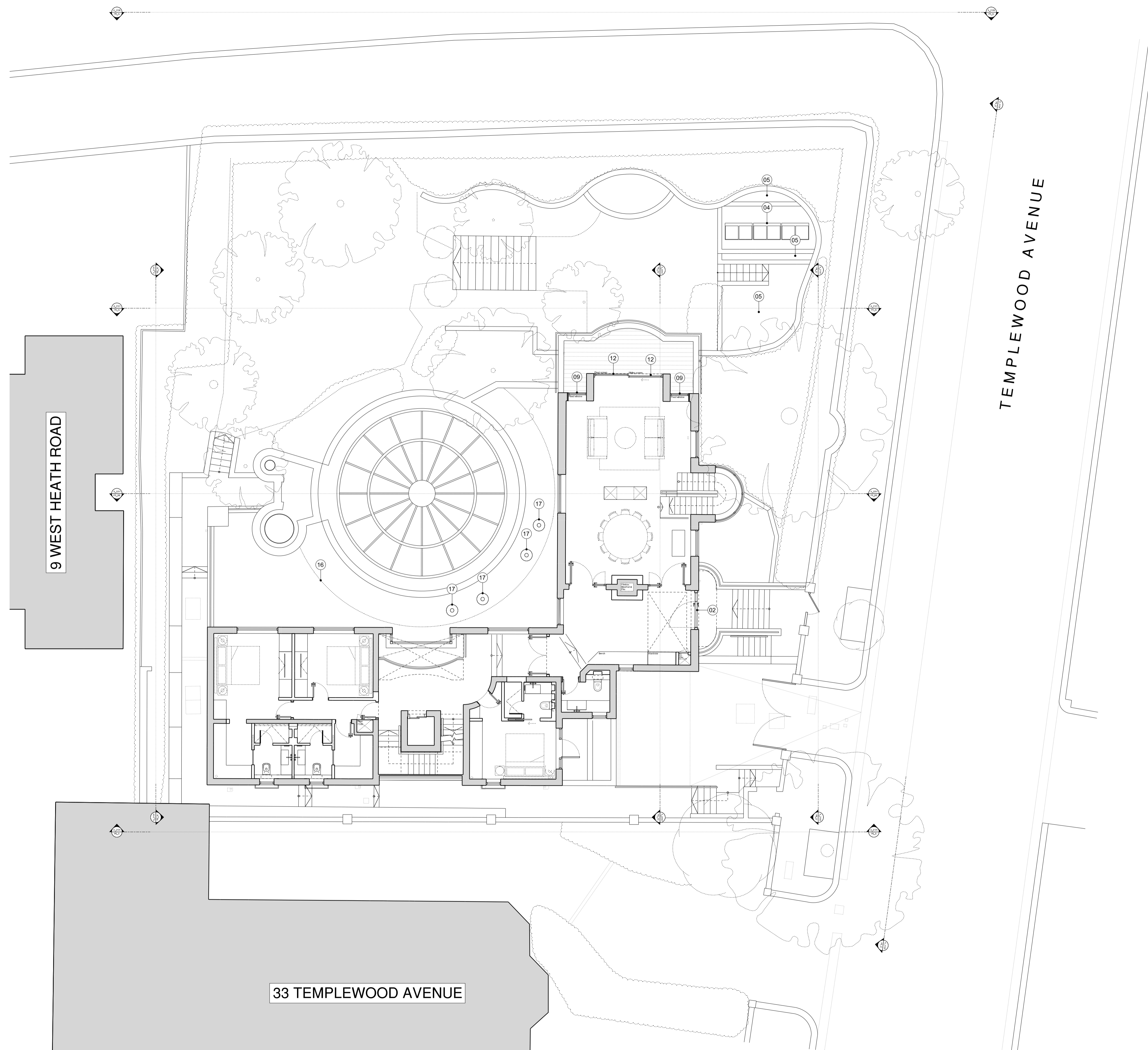

WEST HEATH ROAD



Rev.	Purpose	Date

Studio Three Architects Limited. All construction works to comply with British Standards and Building Regulations requirements. Any errors on drawings or omissions should be reported to Studio Three. This drawing cannot be used to calculate areas for the purposes of valuation. All measurements should be checked on site. These drawings should not be scaled.

Legends & Notes

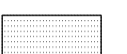
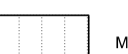
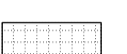
	Existing		Proposed wall / partition
	Brick		Metal Roof
	Tiles		

- Proposal Notes
- Refurbishment:
1. New up-and-over garage doors within existing opening, bronze coloured finish.
  2. New front entrance door within existing opening, bronze coloured finish.
  3. New external door within existing opening, bronze coloured finish.
  4. New external A/C condenser unit.
  5. New landscape and built-in planters to screen external A/C condenser unit.
- First Floor Extension:
6. First floor extension inset from the building perimeter constructed in red bricks to match existing.
  7. New parapets in red brick and stone to match existing. Reference existing details.
  8. New flat roof.
  9. New metal framed, double glazed window, bronze coloured finish.
  10. New solar panels on flat roof.
  11. New canopy above front door entrance in red brick to match existing.
  12. New metal framed, double glazed doors, bronze coloured finish.
- Works to Listed Swimming Pool:
13. New bronze coloured, metal framed window.
  14. New bronze coloured, glass metal framed door.
  15. New relocated column.
  16. Reinstatement of earth mound around retained pool.
  17. Existing sun 'tubes' extended to provide natural light through the earth mound.

Phase  
**PLANNING**

Drawing title  
Proposed Upper Ground Floor Plan  
**DRAFT**

Drawing No.	A_2000	Rev.	
Drawn	MV	Approved	RD
First revision	00.00.2024	Updated	00.00.0000

**STUDIO THREE**  
31 Percy Street, London, W1T 2DD <https://www.studiothreearchitects.com>

Project No. 23088 Address Boncara 35 Templewood Avenue London NW3 7UY

Client Andrea Sambo  
Scale 1:100 @ A1 / 1:200 @ A3

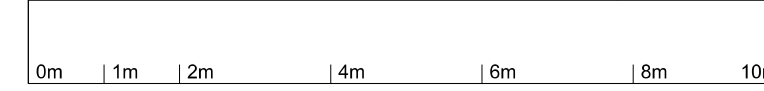



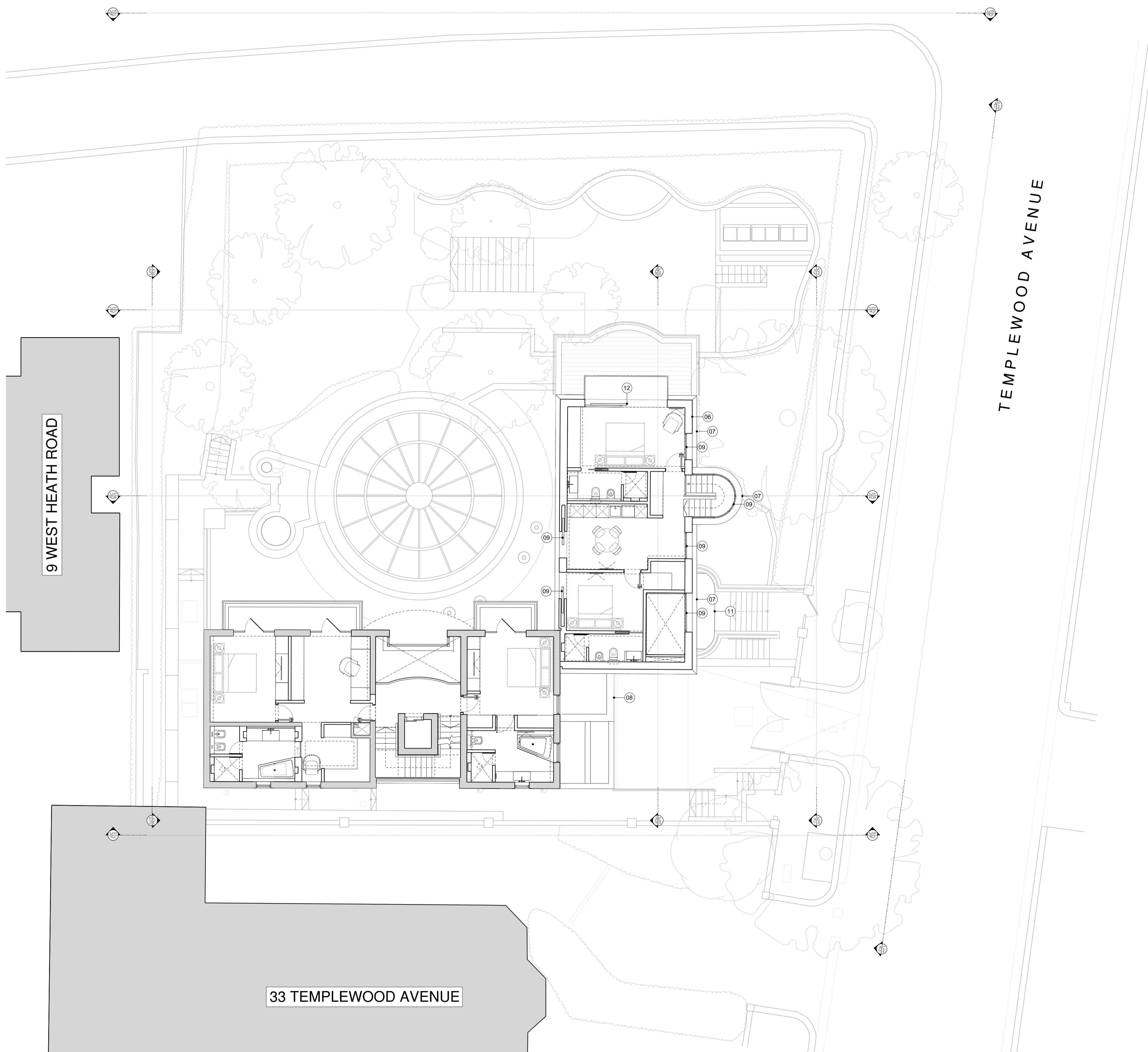

WEST HEATH ROAD



Rev.	Purpose	Date

Studio Three Architects Limited. All construction works to comply with British Standards and Building Regulations requirements. Any errors on drawings or omissions should be reported to Studio Three. This drawing cannot be used to calculate areas for the purposes of valuation. All measurements should be checked on site. These drawings should not be scaled.

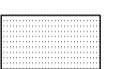
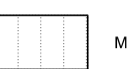
Legends & Notes

	Existing		Proposed wall / partition
	Brick		Metal Roof
	Tiles		

- Proposal Notes
- Refurbishment:
1. New up-and-over garage doors within existing opening, bronze coloured finish.
  2. New front entrance door within existing opening, bronze coloured finish.
  3. New external door within existing opening, bronze coloured finish.
  4. New external A/C condenser unit.
  5. New landscape and built-in planters to screen external A/C condenser unit.
- First Floor Extension:
6. First floor extension inset from the building perimeter constructed in red bricks to match existing.
  7. New parapets in red brick and stone to match existing. Reference existing details.
  8. New flat roof.
  9. New metal framed, double glazed window, bronze coloured finish.
  10. New solar panels on flat roof.
  11. New canopy above front door entrance in red brick to match existing.
  12. New metal framed, double glazed doors, bronze coloured finish.
- Works to Listed Swimming Pool:
13. New bronze coloured, metal framed window.
  14. New bronze coloured, glass metal framed door.
  15. New relocated column.
  16. Reinstatement of earth mound around retained pool.
  17. Existing sun 'tubes' extended to provide natural light through the earth mound.

Phase  
**PLANNING**

Drawing title  
Proposed First Floor Plan  
**DRAFT**

Drawing No.	A_2001	Rev.	A
Drawn	MV	Approved	RD
First revision	00.00.2024	Updated	00.00.0000

**STUDIO THREE**  
31 Percy Street, London, W1T 2DD <https://www.studiothreearchitects.com>

Project No. 23088 Address Boncara 35 Templewood Avenue London NW3 7UY

Client Andrea Sambo  
Scale 1:100 @ A1 / 1:200 @ A3





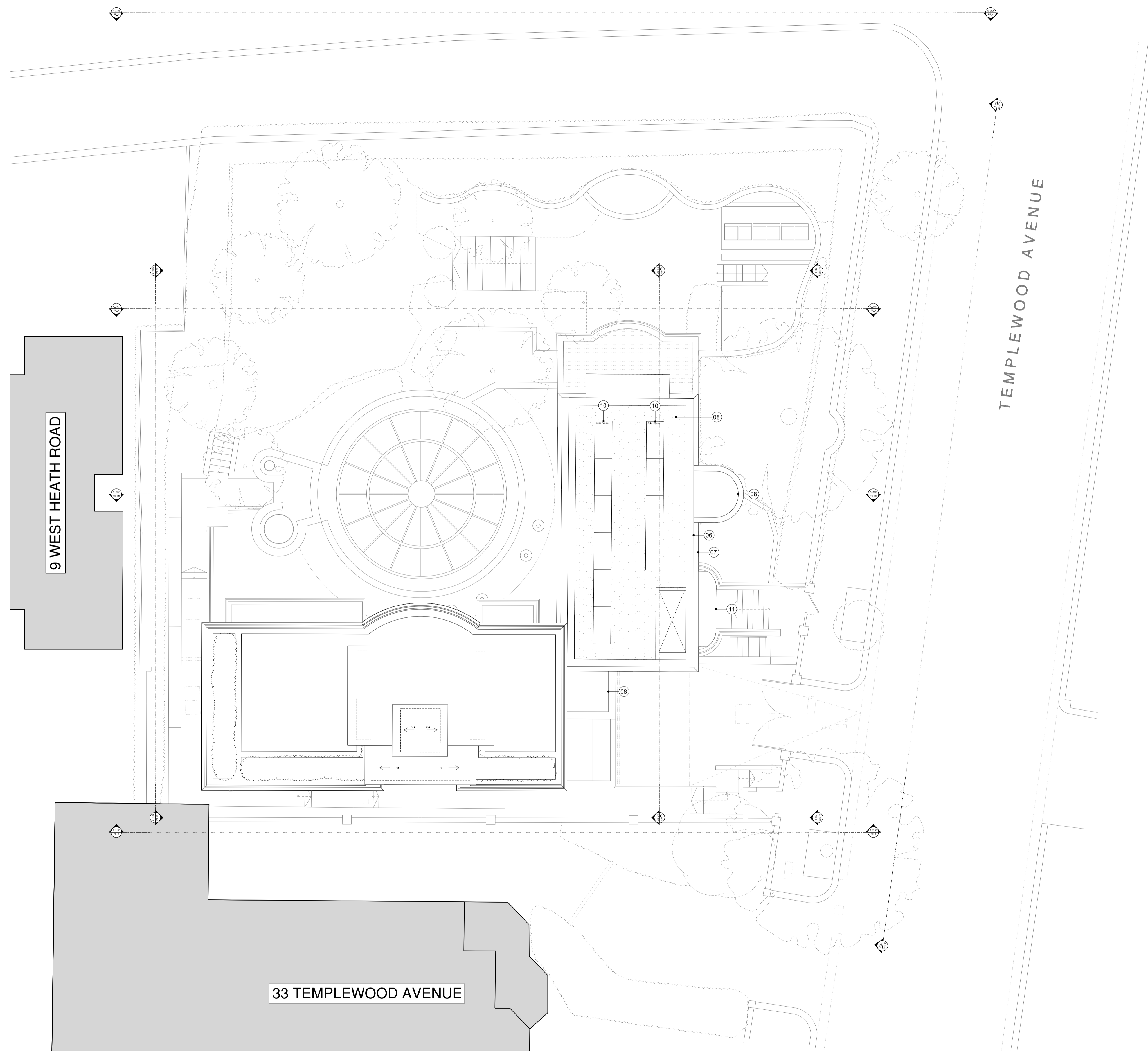

WEST HEATH ROAD



Rev.	Purpose	Date

Studio Three Architects Limited. All construction works to comply with British Standards and Building Regulations requirements. Any errors on drawings or omissions should be reported to Studio Three. This drawing cannot be used to calculate areas for the purposes of valuation. All measurements should be checked on site. These drawings should not be scaled.

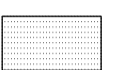
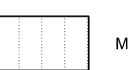
Legends & Notes

	Existing		Proposed wall / partition
	Brick		Metal Roof
	Tiles		

- Proposal Notes
- Refurbishment:
1. New up-and-over garage doors within existing opening, bronze coloured finish.
  2. New front entrance door within existing opening, bronze coloured finish.
  3. New external door within existing opening, bronze coloured finish.
  4. New external A/C condenser unit.
  5. New landscape and built-in planters to screen external A/C condenser unit.
- First Floor Extension:
6. First floor extension inset from the building perimeter constructed in red bricks to match existing.
  7. New parapets in red brick and stone to match existing. Reference existing details.
  8. New flat roof.
  9. New metal framed, double glazed window, bronze coloured finish.
  10. New solar panels on flat roof.
  11. New canopy above front door entrance in red brick to match existing.
  12. New metal framed, double glazed doors, bronze coloured finish.
- Works to Listed Swimming Pool:
13. New bronze coloured, metal framed window.
  14. New bronze coloured, glass metal framed door.
  15. New relocated column.
  16. Reinstatement of earth mound around retained pool.
  17. Existing sun 'tubes' extended to provide natural light through the earth mound.

Phase  
**PLANNING**

Drawing title  
Proposed Roof Plan  
**DRAFT**

Drawing No.	A_2003	Rev.	
Drawn	MV	Approved	RD
First revision	00.00.2024	Updated	00.00.0000

**STUDIO THREE**  
31 Percy Street, London, W1T 2DD <https://www.studiothreearchitects.com>

Project No. 23088  
Address Boncara  
35 Templewood Avenue  
London NW3 7UY

Client Andrea Sambo  
Scale 1:100 @ A1 / 1:200 @ A3  
N

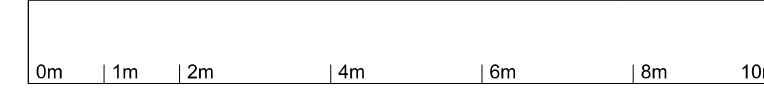



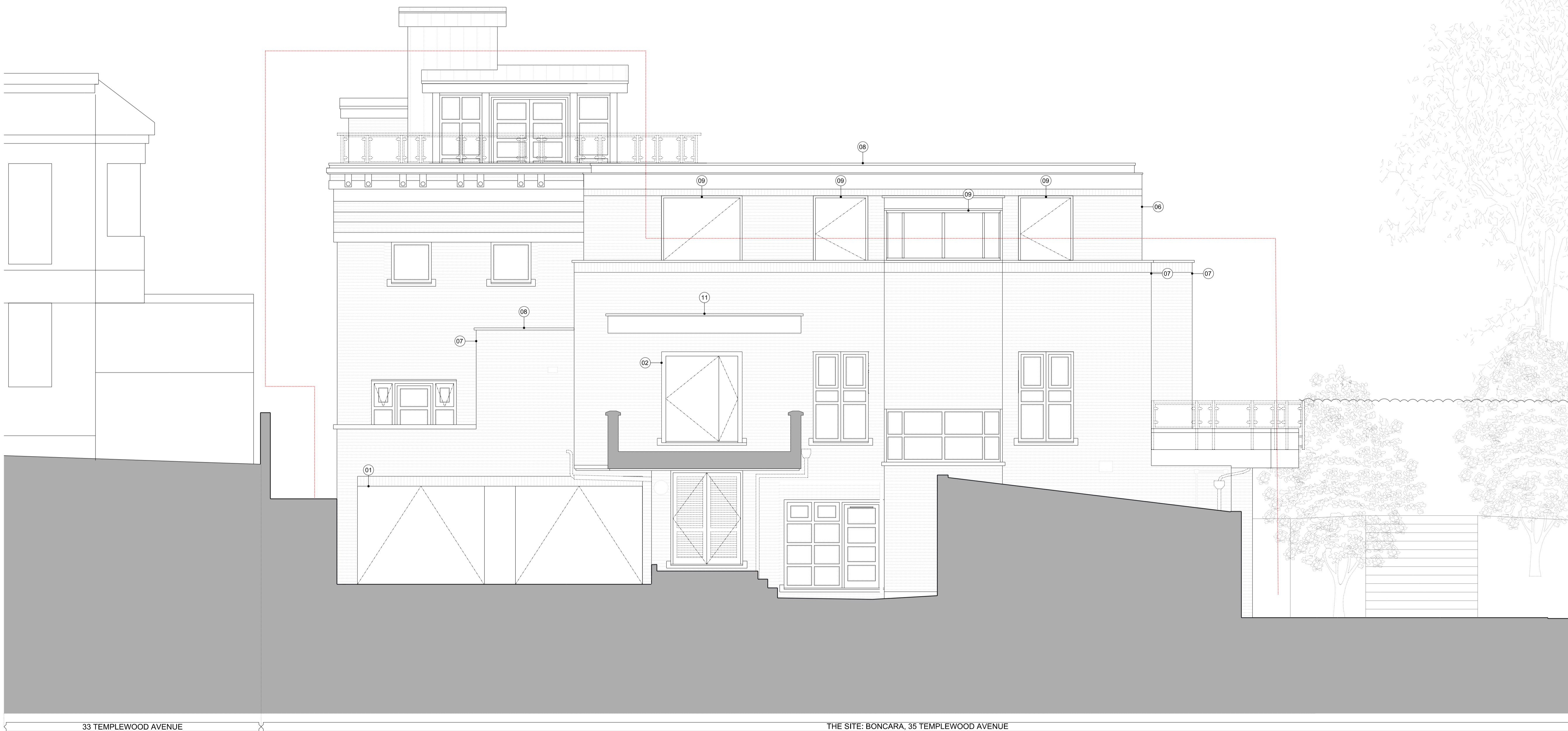





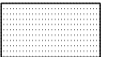

Rev.	Purpose	Date

Studio Three Architects Limited. All construction works to comply with British Standards and Building Regulations requirements. Any errors on drawings or omissions should be reported to Studio Three. This drawing cannot be used to calculate areas for the purposes of valuation. All measurements should be checked on site. These drawings should not be scaled.

Legends & Notes

 Existing	 Proposed wall / partition
 Brick	 Metal Roof
 Tiles	 Outline of consented scheme REF: 20201025P

- Proposal Notes
- Refurbishment:
1. New up-and-over garage doors within existing opening, bronze coloured finish.
  2. New front entrance door within existing opening, bronze coloured finish.
  3. New external door within existing opening, bronze coloured finish.
  4. New external AC condenser unit.
  5. New landscape and built-in planters to screen external AC condenser unit.
- First Floor Extension:
6. First floor extension inset from the building perimeter constructed in red bricks to match existing.
  7. New parapets in red brick and stone to match existing. Reference existing detail.
  8. New flat roof.
  9. New metal framed, double glazed window, bronze coloured finish.
  10. New solar panels on flat roof.
  11. New canopy above front door entrance in red brick to match existing.
  12. New metal framed, double glazed doors, bronze coloured finish.
- Works to Listed Swimming Pool:
13. New bronze coloured, metal framed window.
  14. New bronze coloured, glass metal framed door.
  15. New relocated column.
  16. Reinstatement of earth mound around retained pool.
  17. Existing sun 'tubes' extended to provide natural light through the earth mound.

Phase

# PLANNING

Drawing title

Proposed East Elevation

## DRAFT

Drawing No.	A_2100	Rev.	
Drawn	MV	Approved	RD
First revision	00.00.2024	Updated	00.00.0000

# STUDIO THREE

31 Percy Street, London, W1T 2DD <https://www.studiothreearchitects.com>

Project No. 23088 Address Boncara 35 Templewood Avenue London NW3 7UY

Client Andrea Sambo

Scale 1:50 @ A1 / 1:100 @ A3



Rev.	Purpose	Date

Studio Three Architects Limited. All construction works to comply with British Standards and Building Regulations requirements. Any errors on drawings or omissions should be reported to Studio Three. This drawing cannot be used to calculate areas for the purposes of valuation. All measurements should be checked on site. These drawings should not be scaled.

Legends & Notes

	Existing		Proposed wall / partition
	Brick		Metal Roof
	Tiles		Outline of consented scheme REF: 20201025P

- Proposal Notes
- Refurbishment:
1. New up-and-over garage doors within existing opening, bronze coloured finish.
  2. New front entrance door within existing opening, bronze coloured finish.
  3. New external door within existing opening, bronze coloured finish.
  4. New external AC condenser unit.
  5. New landscape and built-in planters to screen external AC condenser unit.
- First Floor Extension:
6. First floor extension inset from the building perimeter constructed in red bricks to match existing.
  7. New parapets in red brick and stone to match existing. Reference existing detail.
  8. New flat roof.
  9. New metal framed, double glazed window, bronze coloured finish.
  10. New solar panels on flat roof.
  11. New canopy above front door entrance in red brick to match existing.
  12. New metal framed, double glazed doors, bronze coloured finish.
- Works to Listed Swimming Pool:
13. New bronze coloured, metal framed window.
  14. New bronze coloured, glass metal framed door.
  15. New relocated column.
  16. Reinstatement of earth mound around retained pool.
  17. Existing sun 'tubes' extended to provide natural light through the earth mound.

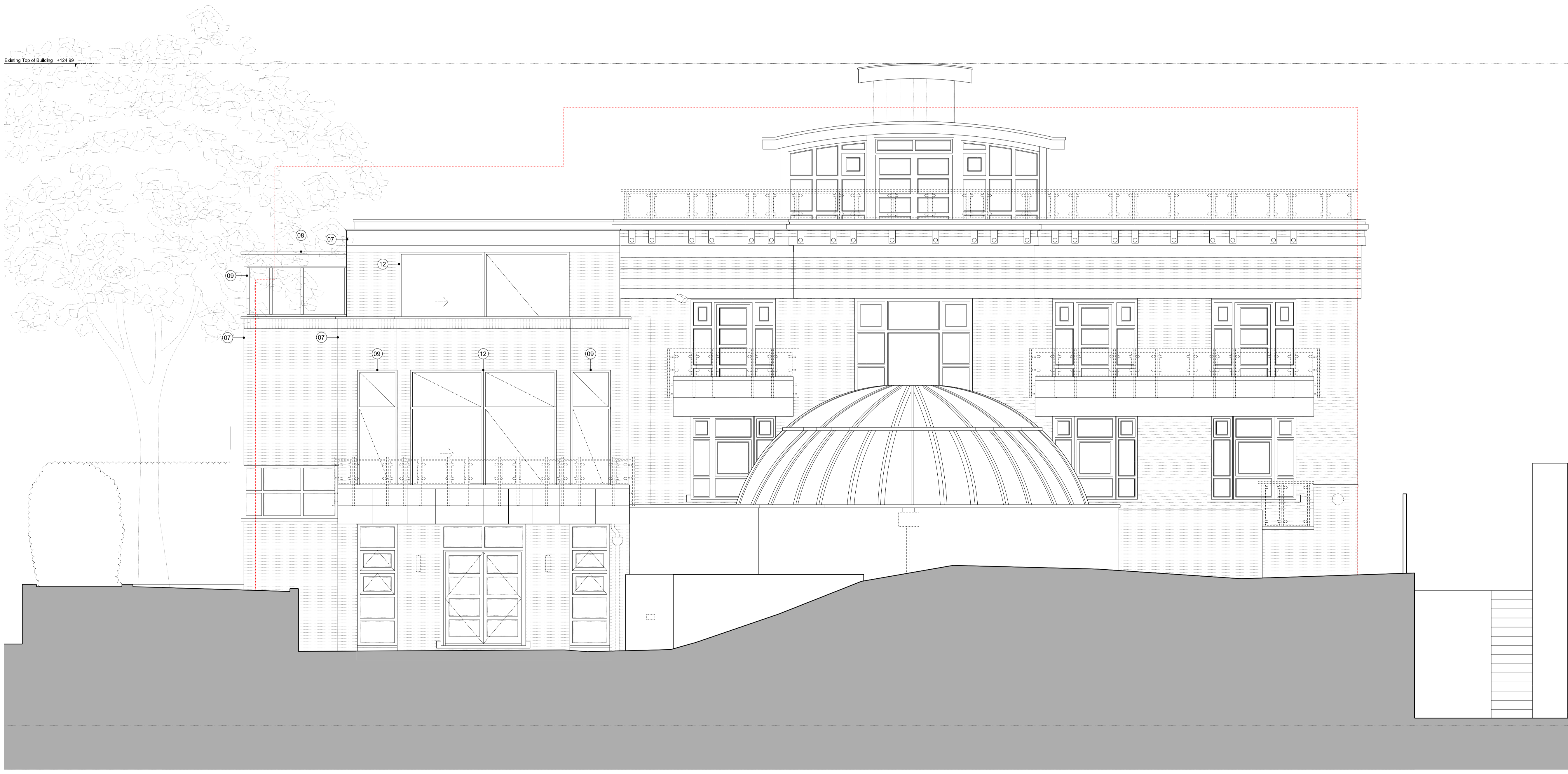

Phase

# PLANNING

Drawing title

Proposed North Elevation 1

## DRAFT

Drawing No.	A_2101	Rev.	
Drawn	MV	Approved	RD
First revision	00.00.2024	Updated	00.00.0000

# STUDIO THREE

31 Percy Street, London, W1T 2DD <https://www.studiothreearchitects.com>

Project No. 23088 Address Boncara  
35 Templewood Avenue  
London NW3 7UY

Client Andrea Sambo

Scale 1:50 @ A1 / 1:100 @ A3





THE SITE: BONCARA, 35 TEMPLEWOOD AVENUE 9 WEST HEATH ROAD



Rev.	Purpose	Date

Studio Three Architects Limited. All construction works to comply with British Standards and Building Regulations requirements. Any errors on drawings or omissions should be reported to Studio Three. This drawing cannot be used to calculate areas for the purposes of valuation. All measurements should be checked on site. These drawings should not be scaled.

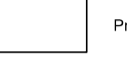
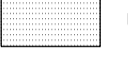
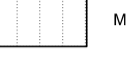
Legends & Notes

	Existing		Proposed wall / partition
	Brick		Metal Roof
	Tiles		Outline of consented scheme REF: 20201025P

- Proposal Notes
- Refurbishment:
1. New up-and-over garage doors within existing opening, bronze coloured finish.
  2. New front entrance door within existing opening, bronze coloured finish.
  3. New external door within existing opening, bronze coloured finish.
  4. New external AC condenser unit.
  5. New landscape and built-in planters to screen external AC condenser unit.
- First Floor Extension:
6. First floor extension inset from the building perimeter constructed in red bricks to match existing.
  7. New parapets in red brick and stone to match existing. Reference existing detail.
  8. New flat roof.
  9. New metal framed, double glazed window, bronze coloured finish.
  10. New solar panels on flat roof.
  11. New canopy above front door entrance in red brick to match existing.
  12. New metal framed, double glazed doors, bronze coloured finish.
- Works to Listed Swimming Pool:
13. New bronze coloured, metal framed window.
  14. New bronze coloured, glass metal framed door.
  15. New relocated column.
  16. Reinstatement of earth mound around retained pool.
  17. Existing sun 'tubes' extended to provide natural light through the earth mound.

Existing Top of Building +124.99

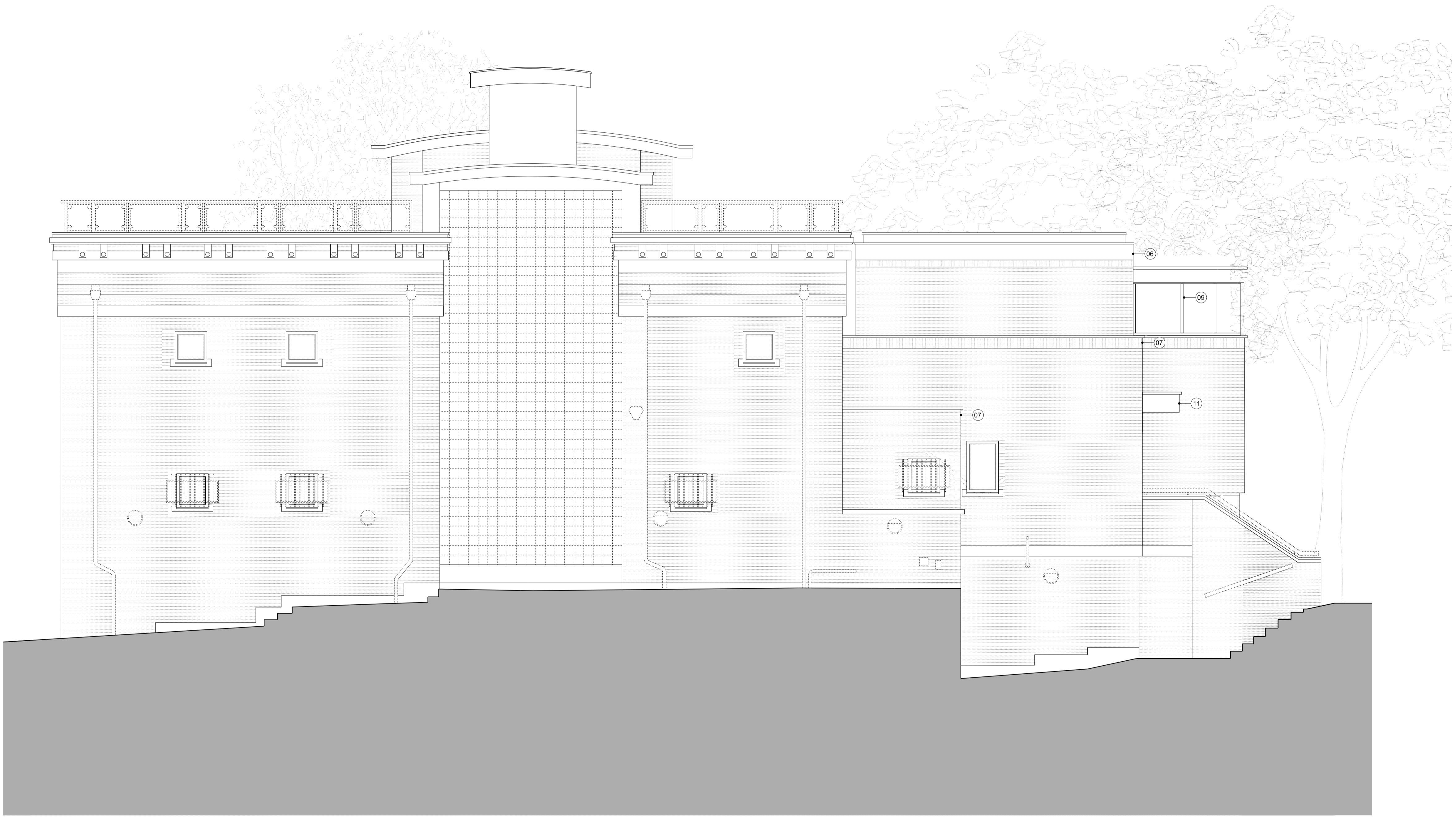

THE SITE: BONCARA, 35 TEMPLEWOOD AVENUE

Phase

# PLANNING

Drawing title

Proposed South Elevation

## DRAFT

Drawing No.	A_2103	Rev.	
Drawn	MV	Approved	RD
First revision	00.00.2024	Updated	00.00.0000

# STUDIO THREE

31 Percy Street, London, W1T 2DD <https://www.studiothreearchitects.com>

Project No. 23088 Address Boncara 35 Templewood Avenue London NW3 7UY

Client Andrea Sambo

Scale 1:50 @ A1 / 1:100 @ A3

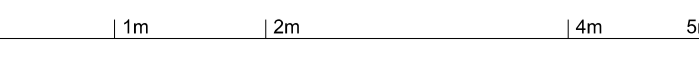









Rev.	Purpose	Date

Studio Three Architects Limited. All construction works to comply with British Standards and Building Regulations requirements. Any errors on drawings or omissions should be reported to Studio Three. This drawing cannot be used to calculate areas for the purposes of valuation. All measurements should be checked on site. These drawings should not be scaled.

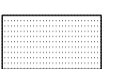
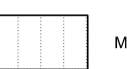
Legends & Notes

	Existing		Proposed wall / partition
	Brick		Metal Roof
	Tiles		Outline of consented scheme REF: 20201025P

- Proposal Notes
- Refurbishment:
1. New up-and-over garage doors within existing opening, bronze coloured finish.
  2. New front entrance door within existing opening, bronze coloured finish.
  3. New external door within existing opening, bronze coloured finish.
  4. New external A/C condenser unit.
  5. New landscape and built-in planters to screen external A/C condenser unit.
- First Floor Extension:
6. First floor extension inset from the building perimeter constructed in red bricks to match existing.
  7. New parapets in red brick and stone to match existing. Reference existing detail.
  8. New flat roof.
  9. New metal framed, double glazed window, bronze coloured finish.
  10. New solar panels on flat roof.
  11. New canopy above front door entrance in red brick to match existing.
  12. New metal framed, double glazed doors, bronze coloured finish.
- Works to Listed Swimming Pool:
13. New bronze coloured, metal framed window.
  14. New bronze coloured, glass metal framed door.
  15. New relocated column.
  16. Reinstatement of earth mound around retained pool.
  17. Existing sun 'tubes' extended to provide natural light through the earth mound.

Phase

# PLANNING

Drawing title

Proposed West Elevation

## DRAFT

Drawing No.	A_2104	Rev.	
Drawn	MV	Approved	RD
First revision	00.00.2024	Updated	00.00.0000

# STUDIO THREE

31 Percy Street, London, W1T 2DD <https://www.studiothreearchitects.com>

Project No. 23088 Address Boncara 35 Templewood Avenue London NW3 7UY

Client Andrea Sambo

Scale 1:50 @ A1 / 1:100 @ A3

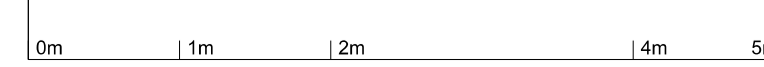







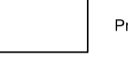

Rev.	Purpose	Date

Studio Three Architects Limited. All construction works to comply with British Standards and Building Regulations requirements. Any errors on drawings or omissions should be reported to Studio Three. This drawing cannot be used to calculate areas for the purposes of valuation. All measurements should be checked on site. These drawings should not be scaled.

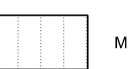
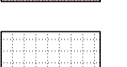
Legends & Notes

	Existing		Proposed wall / partition
	Brick		Metal Roof
	Tiles		Outline of consented scheme REF: 20201025P

- Proposal Notes
- Refurbishment:
1. New up-and-over garage doors within existing opening, bronze coloured finish.
  2. New front entrance door within existing opening, bronze coloured finish.
  3. New external door within existing opening, bronze coloured finish.
  4. New external A/C condenser unit.
  5. New landscape and built-in planters to screen external A/C condenser unit.
- First Floor Extension:
6. First floor extension inset from the building perimeter constructed in red bricks to match existing.
  7. New parapets in red brick and stone to match existing. Reference existing details.
  8. New flat roof.
  9. New metal framed, double glazed window, bronze coloured finish.
  10. New solar panels on flat roof.
  11. New canopy above front door entrance in red brick to match existing.
  12. New metal framed, double glazed doors, bronze coloured finish.
- Works to Listed Swimming Pool:
13. New bronze coloured, metal framed window.
  14. New bronze coloured, glass metal framed door.
  15. New relocated column.
  16. Reinstatement of earth mound around retained pool.
  17. Existing sun 'tubes' extended to provide natural light through the earth mound.

Phase

# PLANNING

Drawing title

Proposed East Street Elevation

## DRAFT

Drawing No.	A_2105	Rev.	
Drawn	MV	Approved	RD
First revision	00.00.2024	Updated	00.00.0000

# STUDIO THREE

31 Percy Street, London, W1T 2DD <https://www.studiothreearchitects.com>

Project No. 23088

Address Boncara  
35 Templewood Avenue  
London NW3 7UY

Client Andrea Sambo

Scale 1:100 @ A1 / 1:200 @ A3

N







Rev.	Purpose	Date

Studio Three Architects Limited. All construction works to comply with British Standards and Building Regulations requirements. Any errors on drawings or omissions should be reported to Studio Three. This drawing cannot be used to calculate areas for the purposes of valuation. All measurements should be checked on site. These drawings should not be scaled.

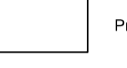
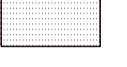
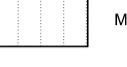
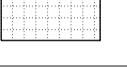
Legends & Notes

 Existing	 Proposed wall / partition
 Brick	 Metal Roof
 Tiles	 Outline of consented scheme REF: 20201025/P

- Proposal Notes
- Refurbishment:
1. New up-and-over garage doors within existing opening, bronze coloured finish.
  2. New front entrance door within existing opening, bronze coloured finish.
  3. New external door within existing opening, bronze coloured finish.
  4. New external A/C condenser unit.
  5. New landscape and built-in planters to screen external A/C condenser unit.
- First Floor Extension:
6. First floor extension inset from the building perimeter constructed in red bricks to match existing.
  7. New parapets in red brick and stone to match existing. Reference existing details.
  8. New flat roof.
  9. New metal framed, double glazed window, bronze coloured finish.
  10. New solar panels on flat roof.
  11. New canopy above front door entrance in red brick to match existing.
  12. New metal framed, double glazed doors, bronze coloured finish.
- Works to Listed Swimming Pool:
13. New bronze coloured, metal framed window.
  14. New bronze coloured, glass metal framed door.
  15. New relocated column.
  16. Reinstatement of earth mound around retained pool.
  17. Existing sun 'tubes' extended to provide natural light through the earth mound.

Existing Top of Building =124.99

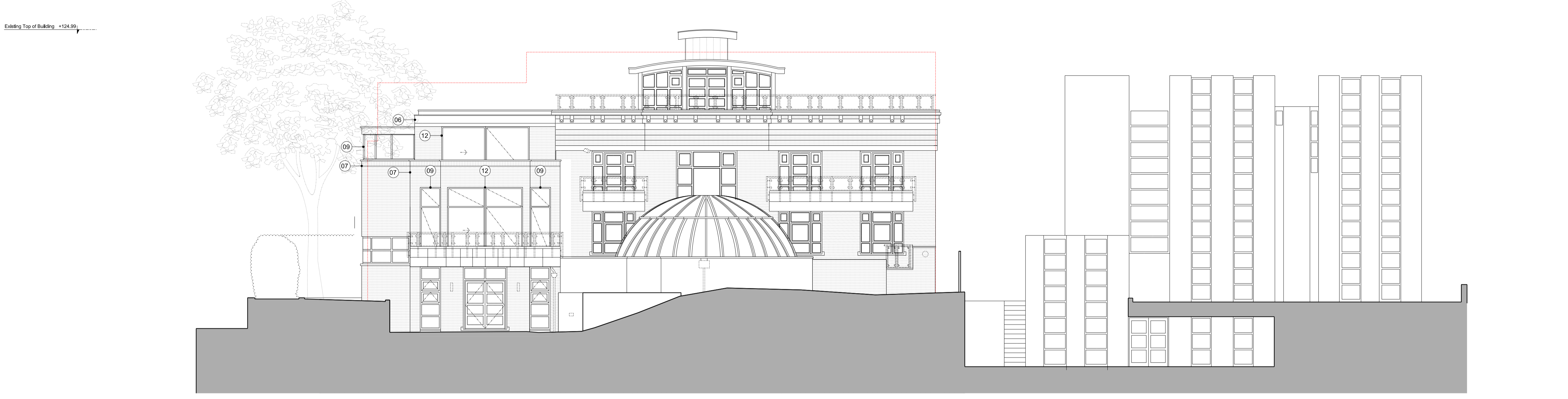

TEMPLEWOOD AVENUE      THE SITE: BONCARA, 35 TEMPLEWOOD AVENUE      9 WEST HEATH ROAD "SCHREIBER HOUSE"

Existing Top of Building =124.99

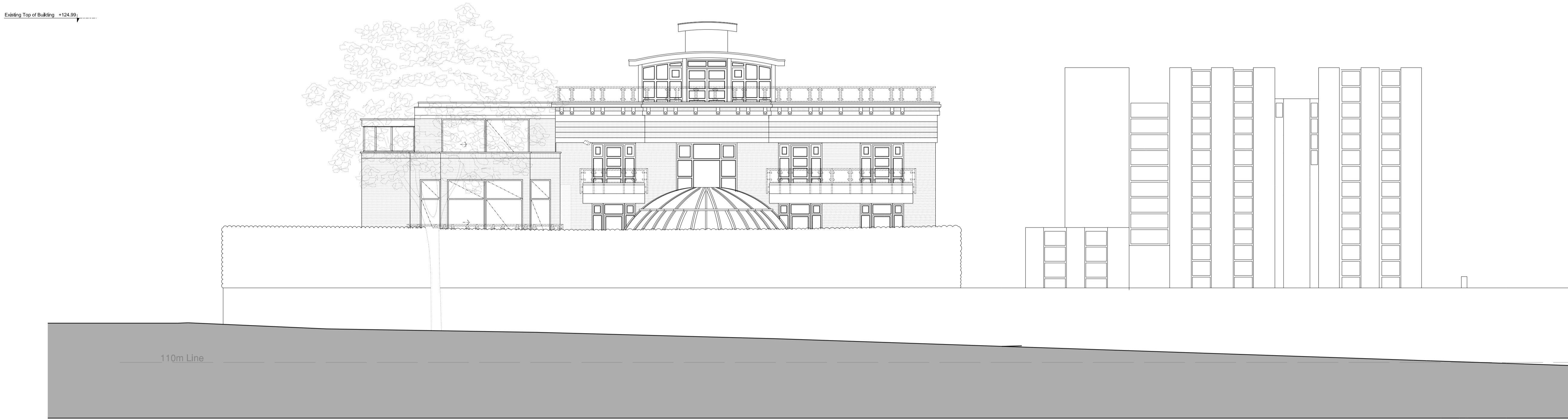

TEMPLEWOOD AVENUE      THE SITE: BONCARA, 35 TEMPLEWOOD AVENUE      9 WEST HEATH ROAD "SCHREIBER HOUSE"

Phase  
**PLANNING**

Drawing title  
Proposed North Street Elevation  
**DRAFT**

Drawing No.	A_2106	Rev.	
Drawn	MV	Approved	RD
First revision	00.00.2024	Updated	00.00.0000

**STUDIO THREE**  
31 Percy Street, London, W1T 2DD      <https://www.studiothreearchitects.com>

Project No. 23088      Address Boncara  
35 Templewood Avenue  
London NW3 7UY

Client Andrea Sambo

Scale 1:100 @ A1 / 1:200 @ A3







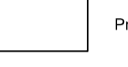
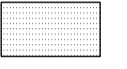

Rev.	Purpose	Date

Studio Three Architects Limited. All construction works to comply with British Standards and Building Regulations requirements. Any errors on drawings or omissions should be reported to Studio Three. This drawing cannot be used to calculate areas for the purposes of valuation. All measurements should be checked on site. These drawings should not be scaled.

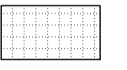
Legends & Notes

	Existing		Proposed wall / partition
	Brick		Metal Roof
	Tiles		Outline of consented scheme REF: 20201025/P

- Proposal Notes
- Refurbishment:
1. New up-and-over garage doors within existing opening, bronze coloured finish.
  2. New front entrance door within existing opening, bronze coloured finish.
  3. New external door within existing opening, bronze coloured finish.
  4. New external A/C condenser unit.
  5. New landscape and built-in planters to screen external A/C condenser unit.
- First Floor Extension:
6. First floor extension inset from the building perimeter constructed in red bricks to match existing.
  7. New parapets in red brick and stone to match existing. Reference existing details.
  8. New flat roof.
  9. New metal framed, double glazed window, bronze coloured finish.
  10. New solar panels on flat roof.
  11. New canopy above front door entrance in red brick to match existing.
  12. New metal framed, double glazed doors, bronze coloured finish.
- Works to Listed Swimming Pool:
13. New bronze coloured, metal framed window.
  14. New bronze coloured, glass metal framed door.
  15. New relocated column.
  16. Reinstatement of earth mound around retained pool.
  17. Existing sun 'tubes' extended to provide natural light through the earth mound.

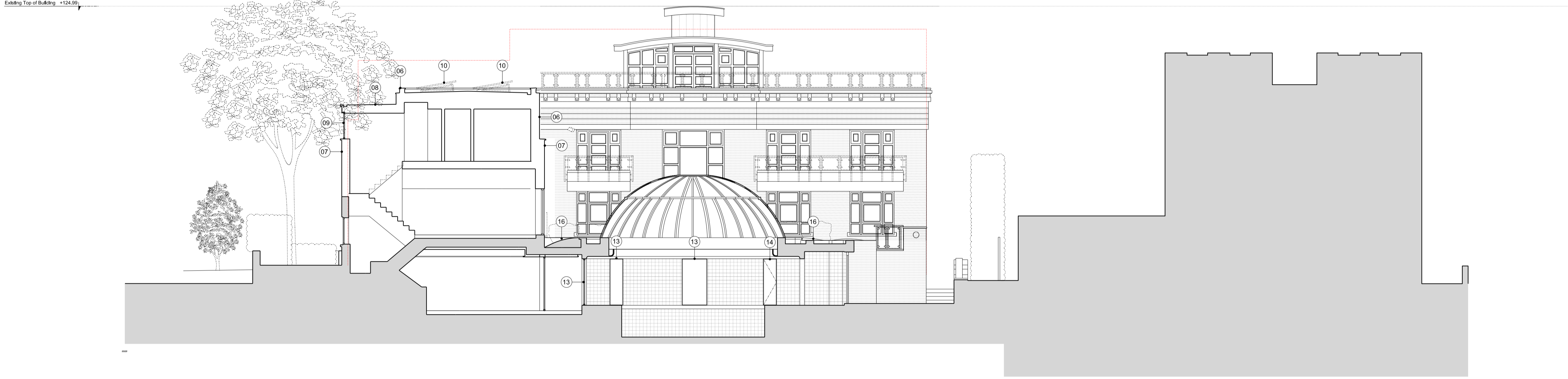

TEMPLEWOOD AVENUE      THE SITE: BONCARA, 35 TEMPLEWOOD AVENUE      9 WEST HEATH ROAD

Phase

# PLANNING

Drawing title

Proposed Section B-B

## DRAFT

Drawing No.	A_2201	Rev.	
Drawn	MV	Approved	RD
First revision	00.00.2024	Updated	00.00.0000

# STUDIO THREE

31 Percy Street, London, W1T 2DD      <https://www.studiothreearchitects.com>

Project No. 23088      Address Boncara  
35 Templewood Avenue  
London NW3 7UY

Client Andrea Sambo



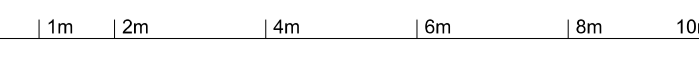



Scale 1:100 @ A1 / 1:200 @ A3

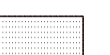

Rev.	Purpose	Date

Studio Three Architects Limited. All construction works to comply with British Standards and Building Regulations requirements. Any errors on drawings or omissions should be reported to Studio Three. This drawing cannot be used to calculate areas for the purposes of valuation. All measurements should be checked on site. These drawings should not be scaled.

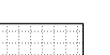
Legends & Notes

	Existing		Proposed wall / partition
	Brick		Metal Roof
	Tiles		Outline of consented scheme REF: 20201025/P

Proposal Notes

- Refurbishment:**
1. New up-and-over garage doors within existing opening, bronze coloured finish.
  2. New front entrance door within existing opening, bronze coloured finish.
  3. New external door within existing opening, bronze coloured finish.
  4. New external A/C condenser unit.
  5. New landscape and built-in planters to screen external A/C condenser unit.
- First Floor Extension:**
6. First floor extension inset from the building perimeter constructed in red bricks to match existing.
  7. New parapets in red brick and stone to match existing. Reference existing details.
  8. New flat roof.
  9. New metal framed, double glazed window, bronze coloured finish.
  10. New solar panels on flat roof.
  11. New canopy above front door entrance in red brick to match existing.
  12. New metal framed, double glazed doors, bronze coloured finish.
- Works to Listed Swimming Pool:**
13. New bronze coloured, metal framed window.
  14. New bronze coloured, glass metal framed door.
  15. New relocated column.
  16. Reinstatement of earth mound around retained pool.
  17. Existing sun 'tubes' extended to provide natural light through the earth mound.



Phase  
**PLANNING**

Drawing title  
**Proposed Section E-E**  
**DRAFT**

Drawing No.	A_2204	Rev.	
Drawn	MV	Approved	RD
First revision	00.00.2024	Updated	00.00.0000

**STUDIO THREE**

Project No.	23088	Address	Boncara 35 Templewood Avenue London NW3 7UY
Client	Andrea Sambo		
Scale	1:100 @ A1 / 1:200 @ A3		
0m   1m   2m   4m   6m   8m   10m			



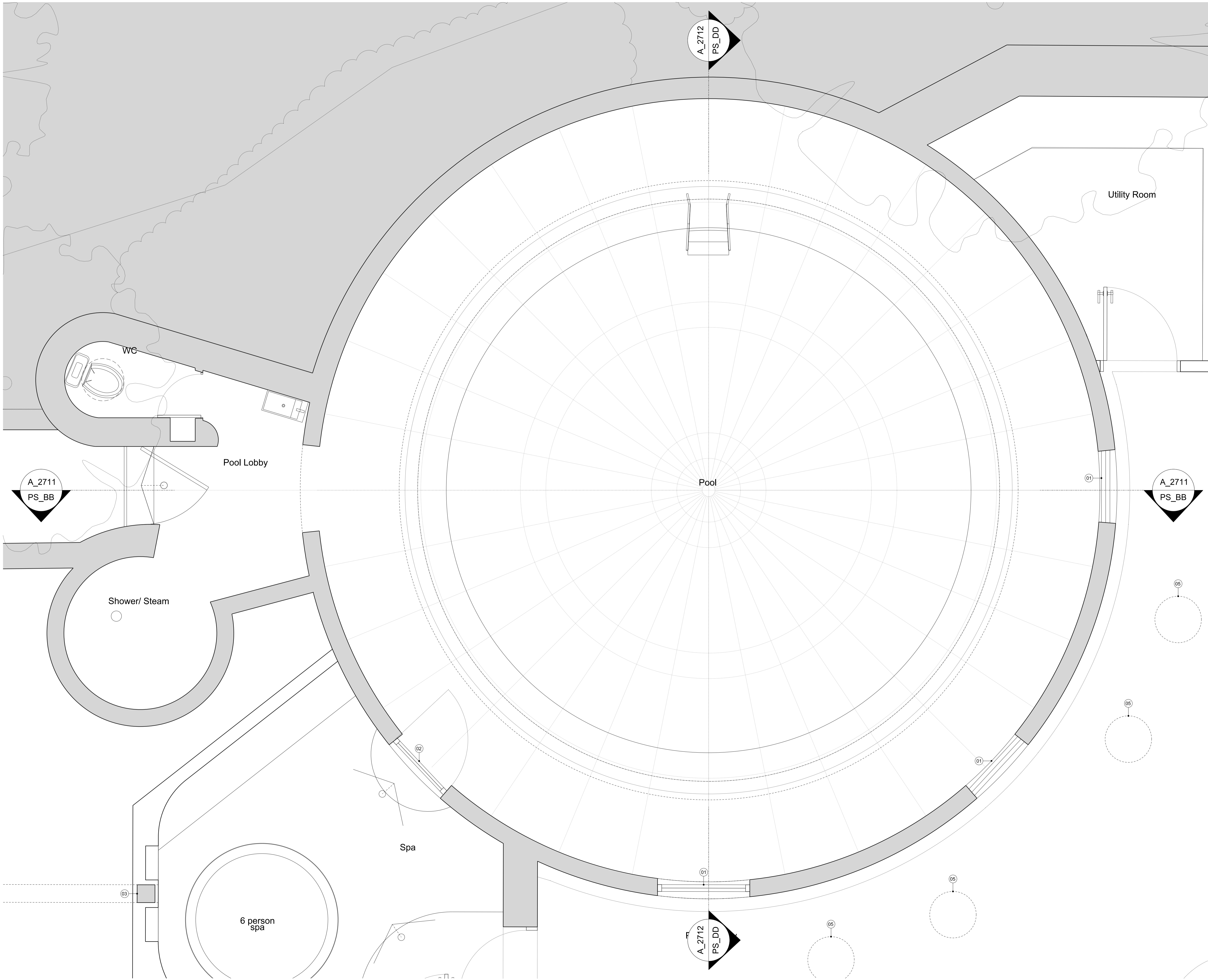

Rev.	Purpose	Date

Studio Three Architects Limited. All construction works to comply with British Standards and Building Regulations requirements. Any errors on drawings or omissions should be reported to Studio Three. This drawing cannot be used to calculate areas for the purposes of valuation. All measurements should be checked on site. These drawings should not be scaled.

Legends & Notes

	Existing		Proposed wall / partition
	Brick		Metal Roof
	Tiles		

- Proposed Works to Listed Swimming Pool
1. New bronze coloured, metal framed window.
  2. New bronze coloured, glass metal framed door.
  3. New relocated column.
  4. Reinstatement of earth mound around retained pool.
  5. Existing rooflights extended to provide natural light through the earth mound.
- Refer to Outline Schedule of Work for full description of proposed alterations.

Phase

# PLANNING

Drawing title: Proposed Listed Swimming Pool Plan

## DRAFT

Drawing No.	A_2710	Rev.	
Drawn	MV	Approved	RD
First revision	00.00.2024	Updated	00.00.0000

# STUDIO THREE

31 Percy Street, London, W1T 2DD <https://www.studiothreearchitects.com>

Project No. 23088 Address Boncara 35 Templewood Avenue London NW3 7UY

Client Andrea Sambo

Scale 1:20 @ A1 / 1:40 @ A3

0m | 0.2m | 0.5m | 1m | 1.5m | 2m



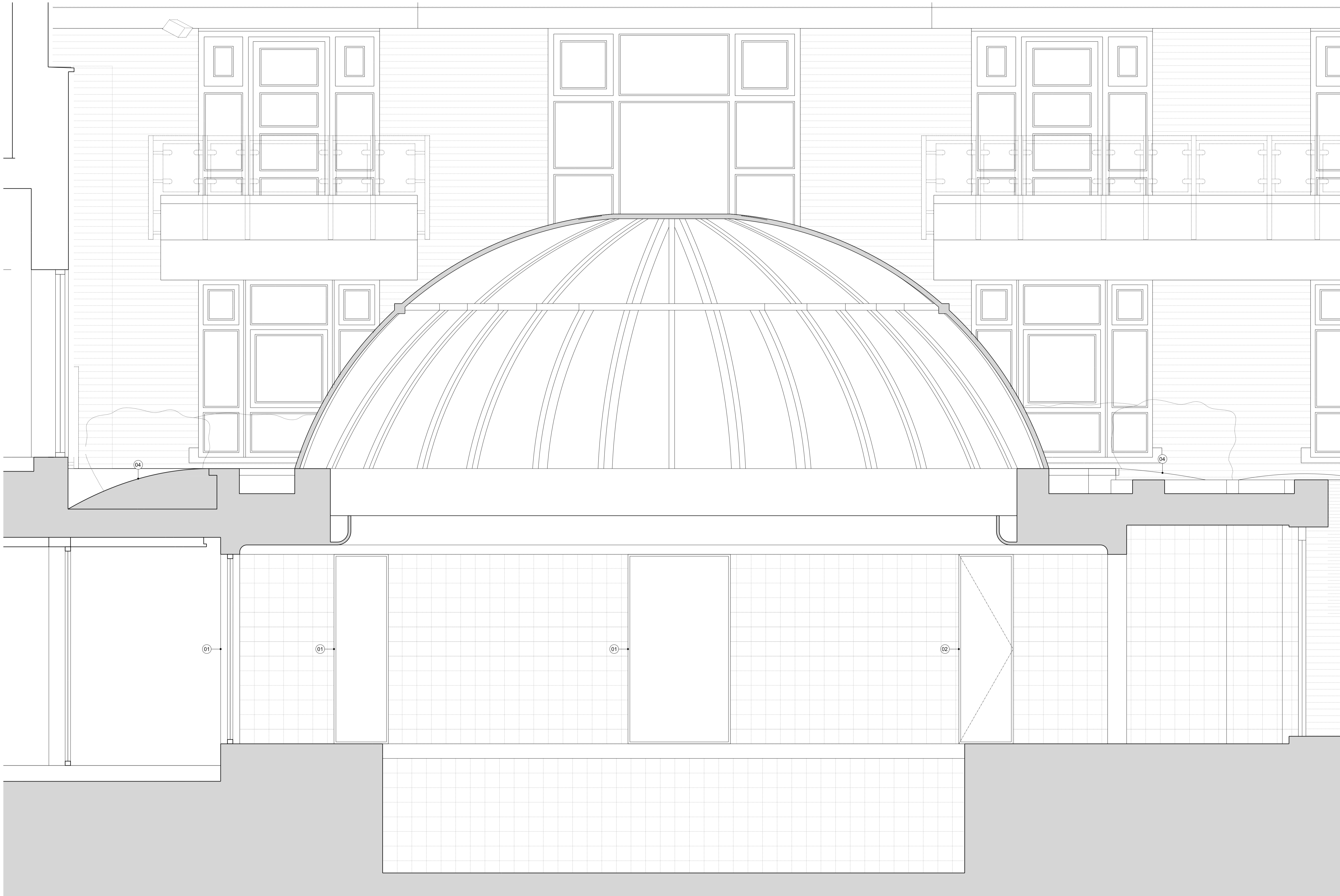





Rev.	Purpose	Date

Studio Three Architects Limited. All construction works to comply with British Standards and Building Regulations requirements. Any errors on drawings or omissions should be reported to Studio Three. This drawing cannot be used to calculate areas for the purposes of valuation. All measurements should be checked on site. These drawings should not be scaled.

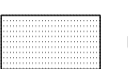
Legends & Notes

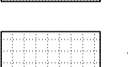
	Existing		Proposed wall / partition
	Brick		Metal Roof
	Tiles		

- Proposed Works to Listed Swimming Pool
1. New bronze coloured, metal framed window.
  2. New bronze coloured, glass metal framed door.
  3. New relocated column.
  4. Reinstatement of earth mound around retained pool.
  5. Existing rooflights extended to provide natural light through the earth mound.
- Refer to Outline Schedule of Work for full description of proposed alterations.

Phase

# PLANNING

Drawing title  
**Proposed Listed Swimming Pool**  
 Internal Elevations 1 of 2

**DRAFT**

Drawing No.	A_2711	Rev.	
Drawn	MV	Approved	RD
First revision	00.00.2024	Updated	00.00.0000

## STUDIO THREE

31 Percy Street, London, W1T 2DD <https://www.studiothreearchitects.com>

Project No. 23088 Address Boncara  
 35 Templewood Avenue  
 London NW3 7UY

Client **Andrea Sambo**

Scale 1:20 @ A1 / 1:40 @ A3

0m | 0.2m | 0.5m | 1m | 1.5m | 2m



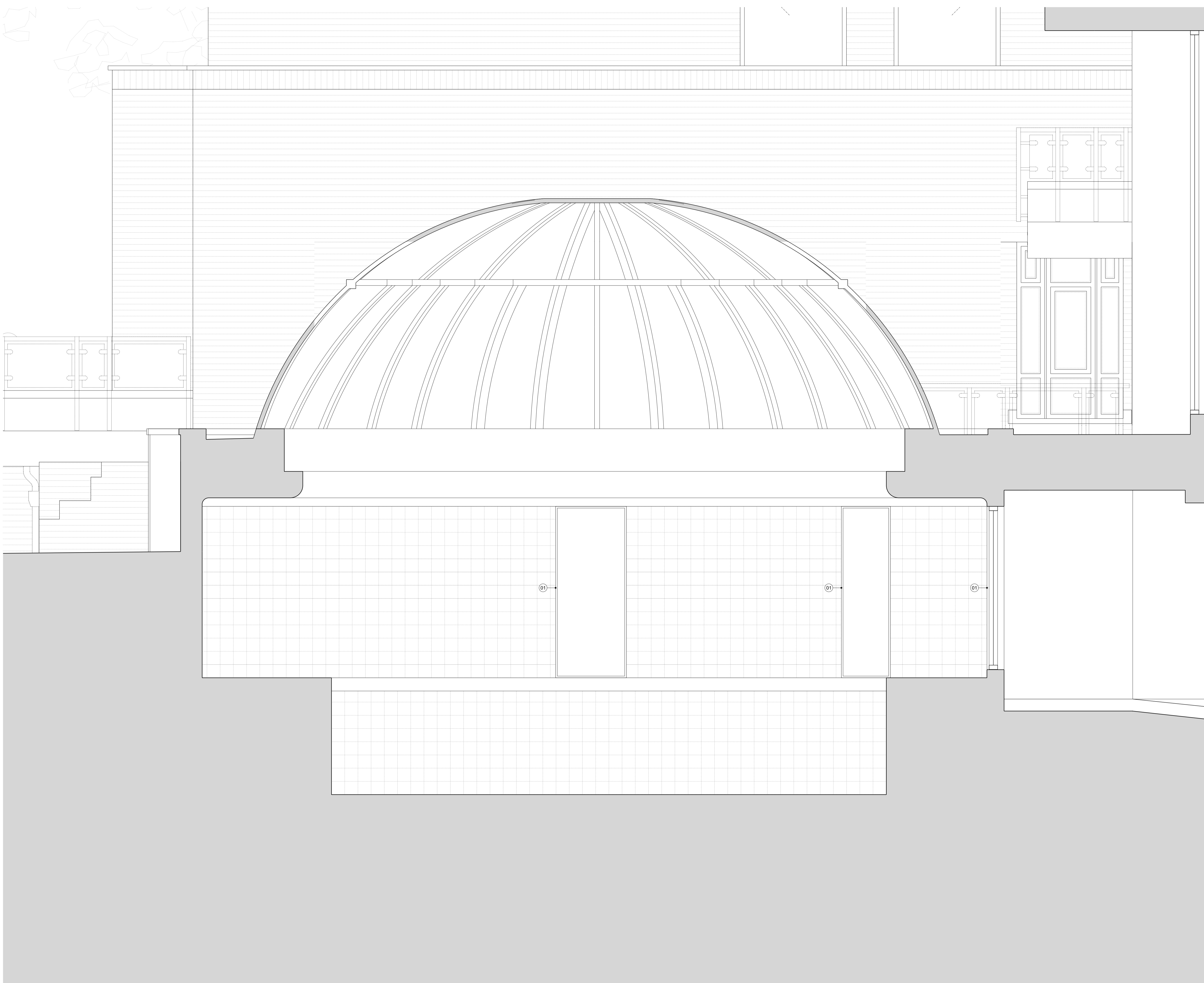





Rev.	Purpose	Date

Studio Three Architects Limited. All construction works to comply with British Standards and Building Regulations requirements. Any errors on drawings or omissions should be reported to Studio Three. This drawing cannot be used to calculate areas for the purposes of valuation. All measurements should be checked on site. These drawings should not be scaled.

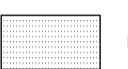
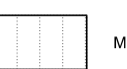
Legends & Notes

	Existing		Proposed wall / partition
	Brick		Metal Roof
	Tiles		

- Proposed Works to Listed Swimming Pool
1. New bronze coloured, metal framed window.
  2. New bronze coloured, glass metal framed door.
  3. New relocated column.
  4. Reinstatement of earth mound around retained pool.
  5. Existing rooflights extended to provide natural light through the earth mound.
- Refer to Outline Schedule of Work for full description of proposed alterations.

Phase

# PLANNING

Drawing title  
 Proposed Listed Swimming Pool  
 Internal Elevations 2 of 2

**DRAFT**

Drawing No.	A_2712	Rev.	
Drawn	MV	Approved	RD
First revision	00.00.2024	Updated	00.00.0000

## STUDIO THREE

31 Percy Street, London, W1T 2DD <https://www.studiothreearchitects.com>

Project No. 23088 Address Boncara  
 35 Templewood Avenue  
 London NW3 7UY

Client Andrea Sambo

Scale 1:20 @ A1 / 1:40 @ A3

0m | 0.2m | 0.5m | 1m | 1.5m | 2m