





© This drawing is the property of Miltiadou Cook Mitzman architects. No disclosure or copy of it may be made without the written permission of Miltiadou Cook Mitzman architects.

For construction purposes:

- Do not scale this drawing.
- All dimensions and levels to be checked on site.
- Discrepancies to be reported to Miltiadou Cook Mitzman architects before proceeding.
- If in any doubt about information on this drawing contact Miltiadou Cook Mitzman architects.

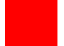
REVISION NUMBER	DATE	BY	NOTES
P1	02/02/2024	OS	Issued for planning
P2	15/05/2024	OS	Issued revisions for planning
P3	13/12/2024	OS	Issued for planning

 PROPOSED BUILD UP
 EXISTING BUILD UP
 DEMOLITION
 JOISTS DIRECTION

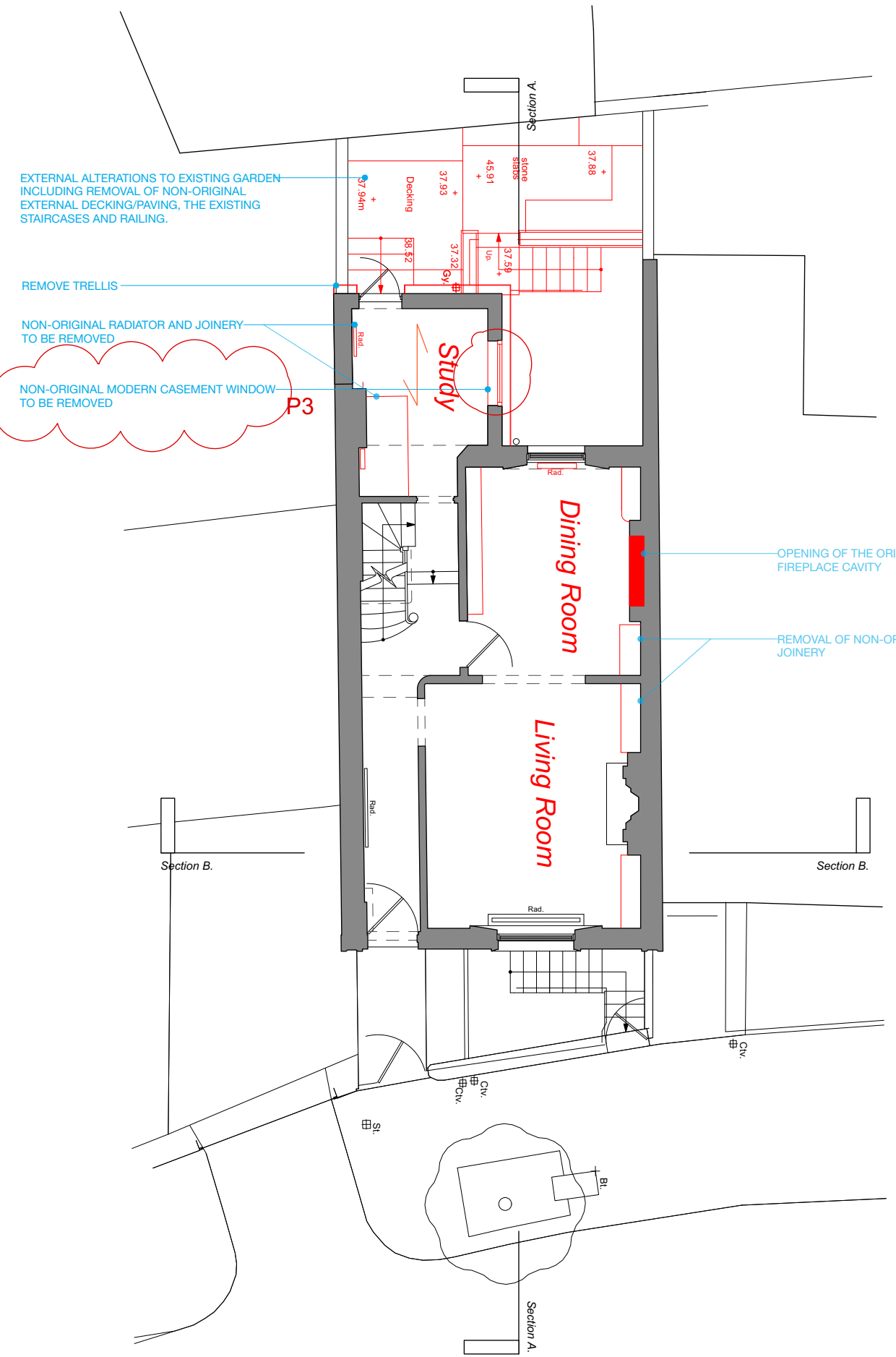

1 Ground Floor Plan-Existing & Demolition
1:100

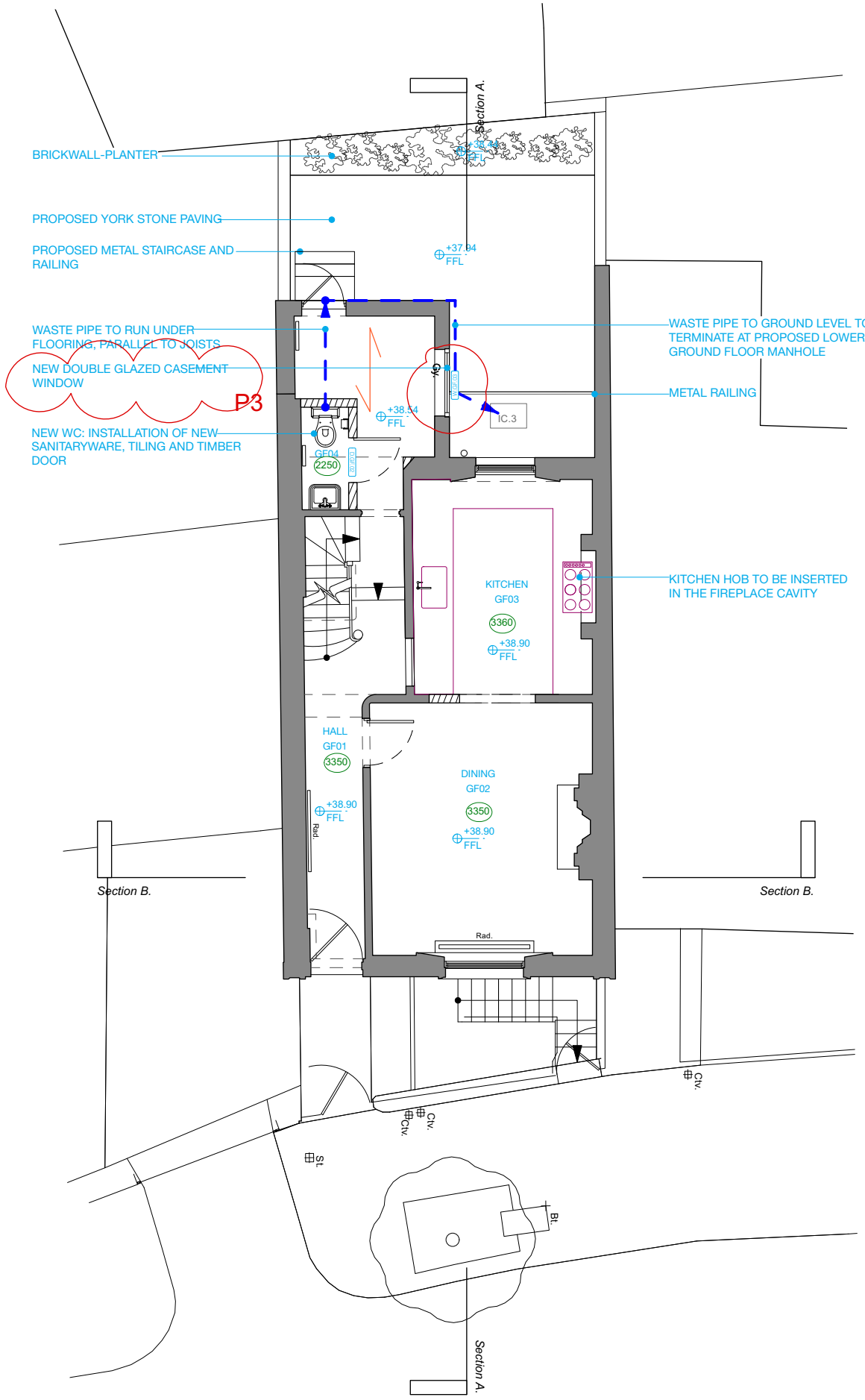

2 Ground Floor Plan-Proposed
1:100

 0 0.5 1.0 M

MILTIADOU COOK MITZMAN architects llp
MCMa

020 7722 8525 office@mcma.design www.mcma.design
10-12 Emerald Mews London WC1N 3QA

CLIENT
Ian & Susan Ferguson

PROJECT
7 Sharpleshall Street, NW1 8YL

SHEET TITLE
Ground Floor Plan-Existing, Demolition and Proposed

SCALE
AS NOTED@A3

DATE CREATED **FILE REFERENCE**

DRAWING NUMBER	REVISION
408-DWG-002	P3