

NOTES

- This drawing to be read in conjunction with the design risk assessment prepared by Craft Architects Limited.
- This drawing to be read in conjunction with all relevant drawings and specifications produced by CA and other members of the design team.
- All dimensions are in millimetres unless otherwise stated.
- Do not scale this drawing.
- Any discrepancies in dimensions are to be reported to the architect immediately.
- All information subject to detailed site survey, it is the duty of the contractor and his agent to check all dimensions on site.
- This drawing is the copyright © of Craft Architects, do not reproduce without permission.

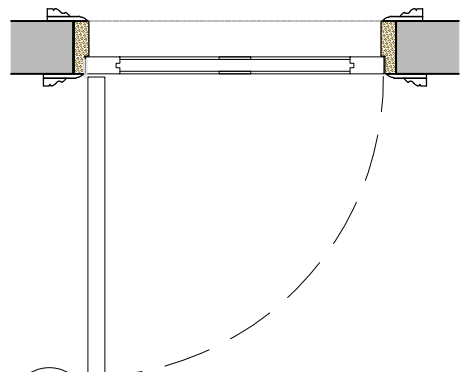

01 Typical Proposed Door
- 1 : 20 @ A3

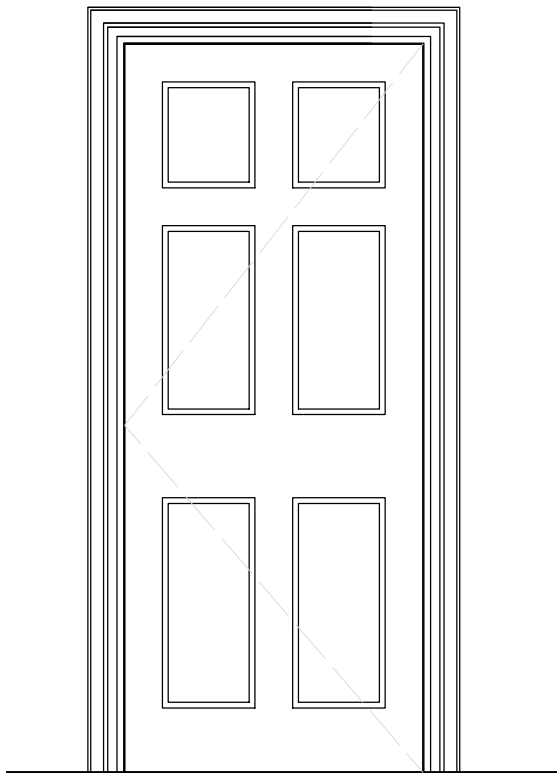
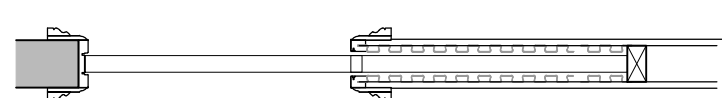
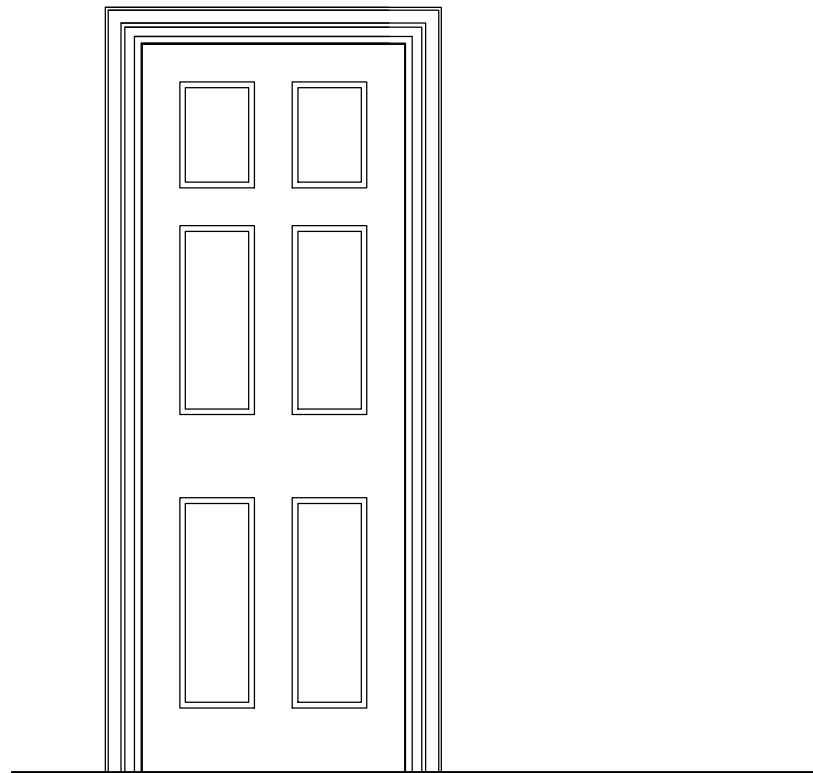

02 Pocket Door
- 1 : 20 @ A3

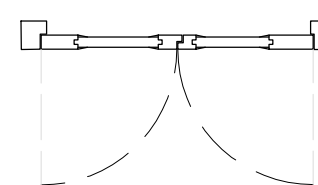
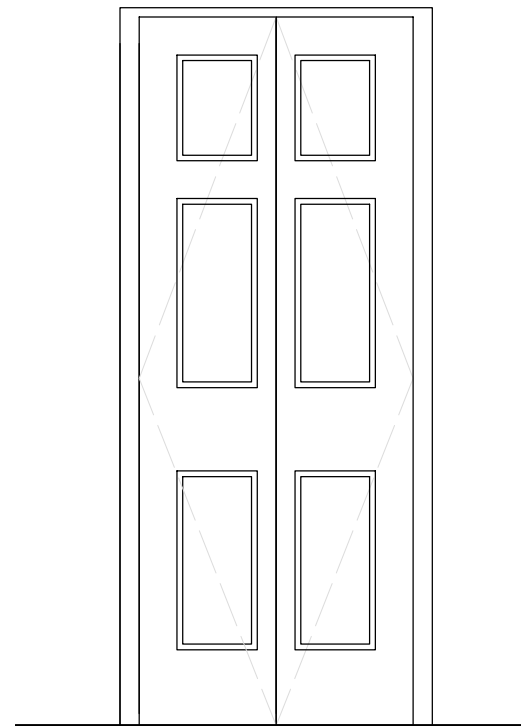

03 Proposed Jib Door
- 1 : 20 @ A3

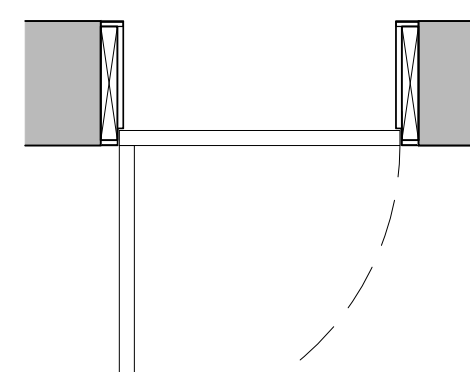
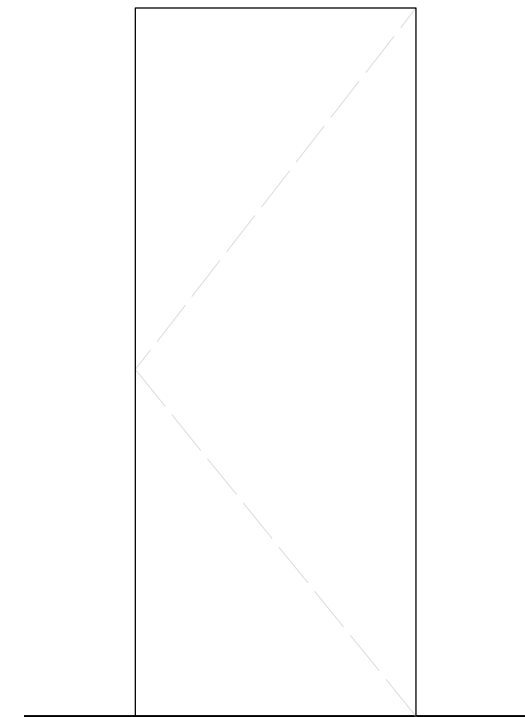

04 Proposed Jib Door
- 1 : 20 @ A3

DOOR SCHEDULE

CODE	ROOM	FLOOR	RETAINED/ PROPOSED	TYPE	NOTES
DB.01	Pantry	Basement	Proposed	Swing Door	
DB.02	Ensuite	Basement	Proposed	Swing Door	
DB.03	Bedroom	Basement	Proposed	Swing Door	
DB.04	Hallway	Basement	Proposed	Swing Door	
DG.01	Reception Room	Ground	Proposed	Jib Door	
DG.02	Basement Stair	Ground	Proposed	Double Door	
DG.03	Main Entrance	Ground	Proposed	External Swing Door	
DG.04	Kitchen	Ground	Proposed	External Double Door	Glass and Timber
DG.05	Kitchen	Ground	Proposed	Swing Door	Consented
DG.06	Kitchen	Ground	Proposed	Swing Door	
DG.07	Dining	Ground	Proposed	Double Door	Glass and Timber
GF.02	Cloakroom	Ground	Retained	Swing Door	
GF.03	TV Room	Ground	Retained	Swing Door	
GF.07	Study	Ground	Retained	Swing Door	
GF.08	Reception Room	Ground	Retained	Swing Door	
1F.02	Bedroom 1	First	Retained	Swing Door	
1F.03	Shower Room	First	Retained	Swing Door	
1F.04	Landing	First	Retained	Swing Door	
1F.08	Master Dressing	First	Retained	Swing Door	
1F.09	Master Bedroom	First	Retained	Swing Door	
DF.01	Ensuite	First	Proposed	Pocket Door	
2F.02	Bathroom	Second	Retained	Swing Door	
2F.03	Bedroom 3	Second	Retained	Swing Door	
2F.04	Bedroom 2	Second	Retained	Swing Door	

/ 18/11/24 ISSUED FOR PLANNING & LBC AMu
REV DATE DESCRIPTION DRAWN BY

PLANNING APPLICATION

project title
9 The Mount
London NW3 6SZ

Drawing Title

PROPOSED
DOOR SCHEDULE [1 / 2]

drawing number revision

2405 PA PR 3025 /

scale
1:20 @A3

date / drawn by / checked by
05.01.2024 / AMu / CA

415 Cocoa Building
The Biscuit Factory
Drummond Road
London, SE16 4DG
Tel. 020 8037 9322
www.craftarchitects.co.uk

CRAFT
ARCHITECTS