

THIS DRAWING IS PROTECTED BY COPYRIGHT - FIGURED DIMENSIONS ONLY TO BE TAKEN FROM THIS DRAWING. DIMENSIONS TO BE CHECKED ON SITE AND ANY DISCREPANCIES REPORTED TO THE ARCHITECT IMMEDIATELY.

PURPOSE OF ISSUE: (I)Info/Comment (S)Sign Off (P)Planning (B)Building Control (T)Tender (C)Construction (F)Final Revision

Rev	Rev Date	Revision Description	Drawn/Checked	Purpose of Issue
/	17/10/2024	Issued for Planning.	CR/FY	P
A	18/11/2024	Issued for Comment.	JD/FY	I

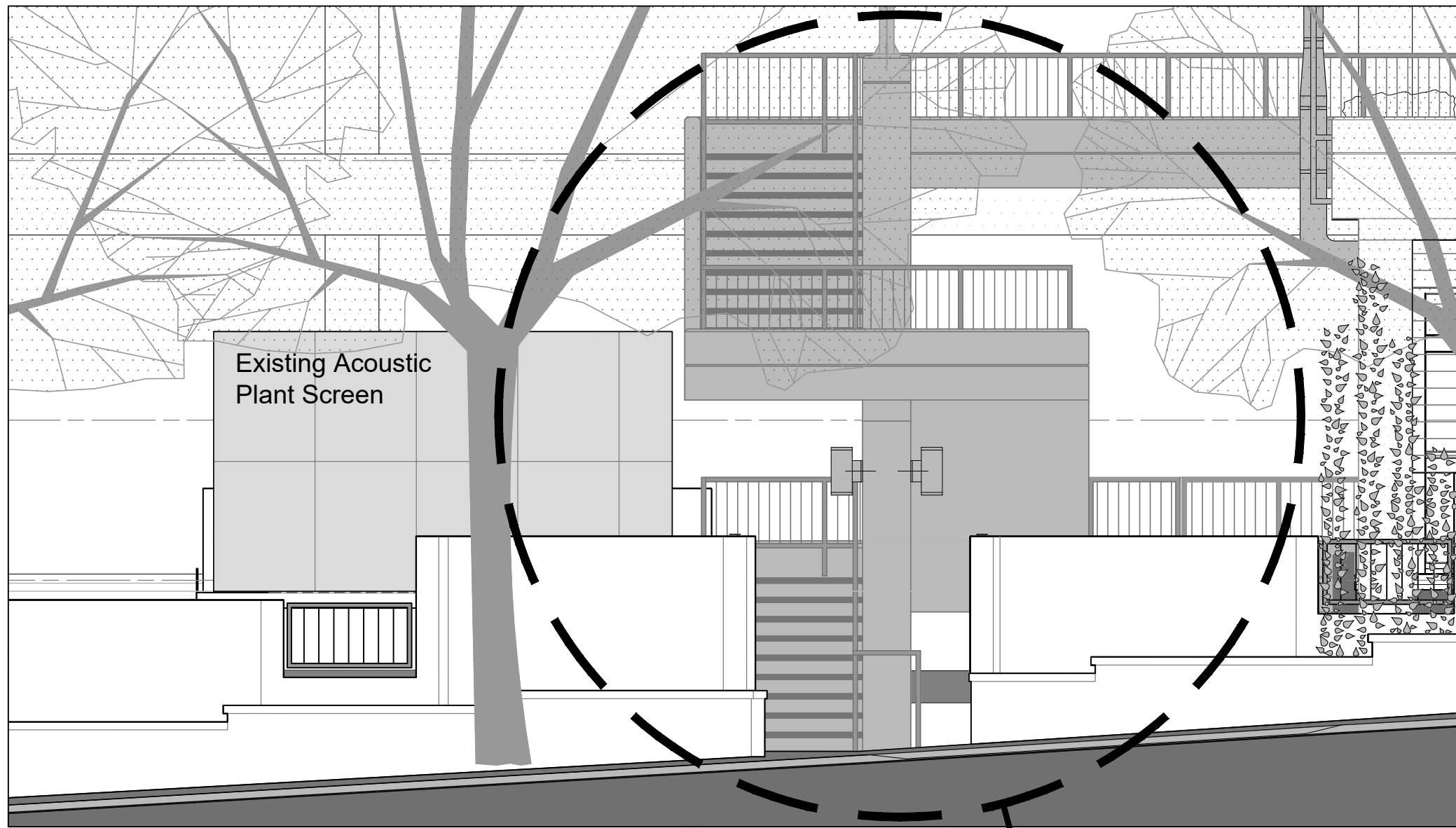

Site Plan 1:2500

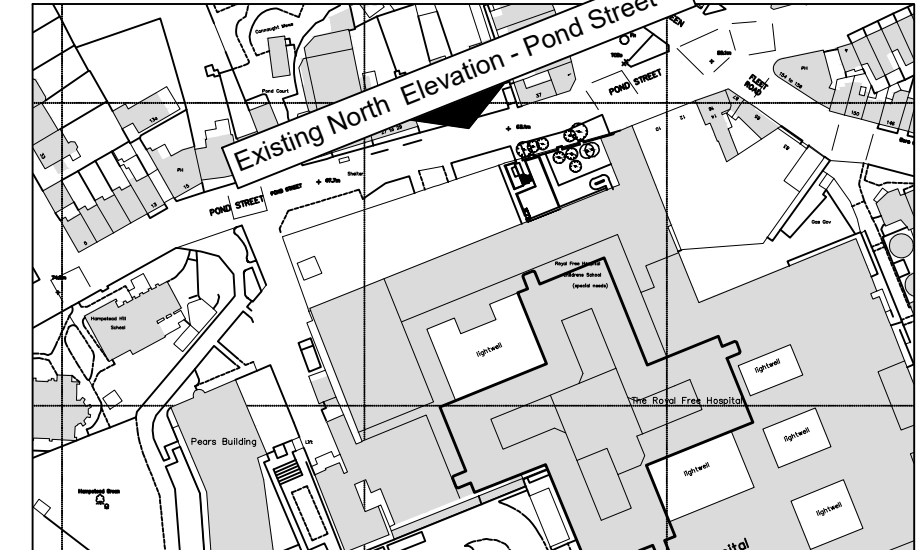

01 Existing North Elevation - View from Pond Street
(02)014 1:50 @ A3



02 Existing North Elevation - View from Pond Street
(02)014 1:200 @ A3

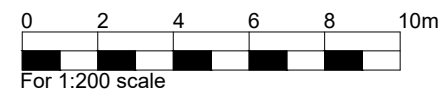

FOR COMMENT

Existing North Elevation Pond Street	23040 JOB NUMBER	(02)014 DRAWING NUMBER	A REV
Royal Free London Autoclave Equipment Replacement	Oct 2024 DATE	1:200 & 1:50@A3 SCALE	

Ansell & Bailey Ltd Chartered Architects 99-101 Farringdon Road London EC1R 3BN 020 7387 0141 architects@ansellandbailey.com

ANSELL + BAILEY