

New vent cowl to roof -  
vent rises from below ~  
160 l/s

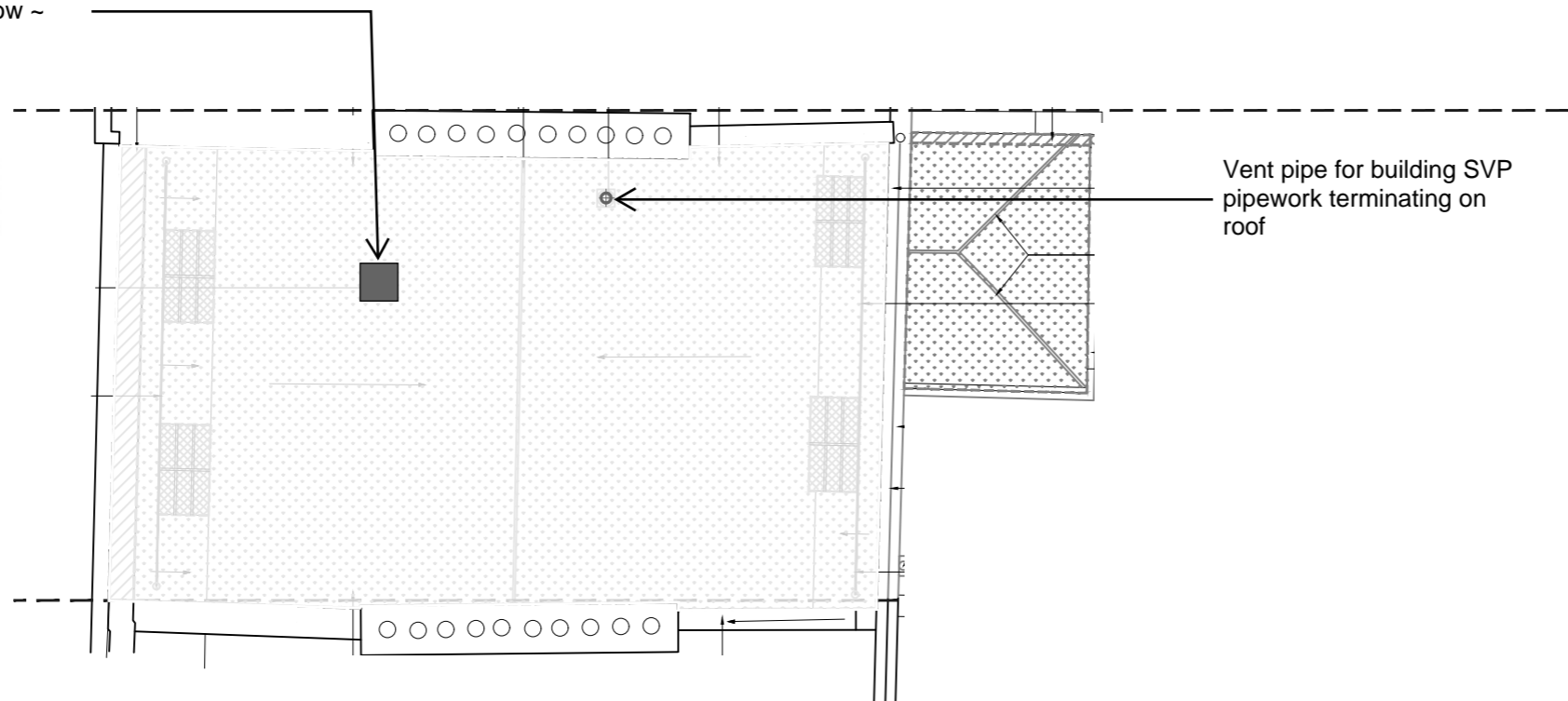

Ø250mm Slate Roof  
Terminal



Vent pipe for building SVP  
pipework terminating on  
roof

**NOTE**

1. Service risers to be formed to provide concealed routing for ventilation ductwork and other services as part of the payout alteration work. Riser construction to meet the performance requirements as set out within the fire safety statement in order to resist the spread of fire between and floors and rooms.

2. Room layouts reflect previously consented scheme application ref. 2024/1614/L and 2024/1264/P.

**GENERAL NOTES**

1. DO NOT SCALE FROM THIS DRAWING
2. THE CONTRACTOR MUST VERIFY ALL DIMENSIONS, TOLERANCES AND REFERENCES BEFORE PROCEEDING WITH WORKS
3. ANY DISCREPANCY FOUND BETWEEN THIS DRAWING AND OTHER DOCUMENTS MUST BE REPORTED TO THE CONTRACT ADMINISTRATOR
4. REMOVE THIS DRAWING FROM CURRENCY WHEN REVISED DRAWING IS ISSUED
5. COPYRIGHT OF DESIGNS SHOWN ON THIS DRAWING REMAIN WITH ELEMENTA CONSULTING LTD.
6. THIS DRAWING IS TO BE READ IN CONJUNCTION WITH THE SPECIFICATION AND ALL OTHER CONTRACT PROJECT DOCUMENTS
7. THE CONTRACTOR SHALL REFER TO ARCHITECTS OR INTERIOR DESIGN DRAWINGS INCLUDING REFLECTED CEILING PLANS AND OTHER SPECIALIST DRAWINGS FOR SETTING OUT ALL VISIBLE WALL AND CEILING MOUNTED EQUIPMENT

**Legend**

LTHW = Low Temperature Hot Water  
 DHW = Domestic Hot Water  
 BCWS = Boosted Cold Water Services  
 VRF = Variable Refrigerant Flow  
 SVP = Soil Vent Pipe  
 AAV = Air Admittance Valve  
 SH = Shower  
 WHB = Wash Hand Basin  
 WC = Water Closet  
 L/L = Low Level  
 H/L = High Level

A1 ORIGINAL SIZE DRAWING			
PO2	Stage 2	SAC	27/11/2024
PO1	Stage 2	SAC	19/11/2024
No.	REVISION	CHK	DATE

**Introba**  
 London Design Studio  
 150 Holborn  
 London, EC1N 2NS  
 t: +44(0)203 6979300  
 e: hello@introba.com  
 www.introba.com

CLIENT  
**Garth Hotel Limited**

PROJECT  
**69 Gower Street**

TITLE  
**Roof - Proposed Combined Services Sketch**

DATE CREATED 2024.09.04	SCALE
DESIGNED TDB	CHECKED TH
APPROVED SAC	
SUITABILITY CODE S2	SUITABILITY DESCRIPTION Preliminary

DRAWING STATUS  
**Stage 2**

DRAWING No. 10499-IRB-XX-RFS-P-5101	REVISION P01
--	-----------------