

Ordnance Survey, (c) Crown Copyright 2022. All rights reserved. Licence number 100022432

FIGURE 1: LOCATION PLAN  
SCALE 1:1250

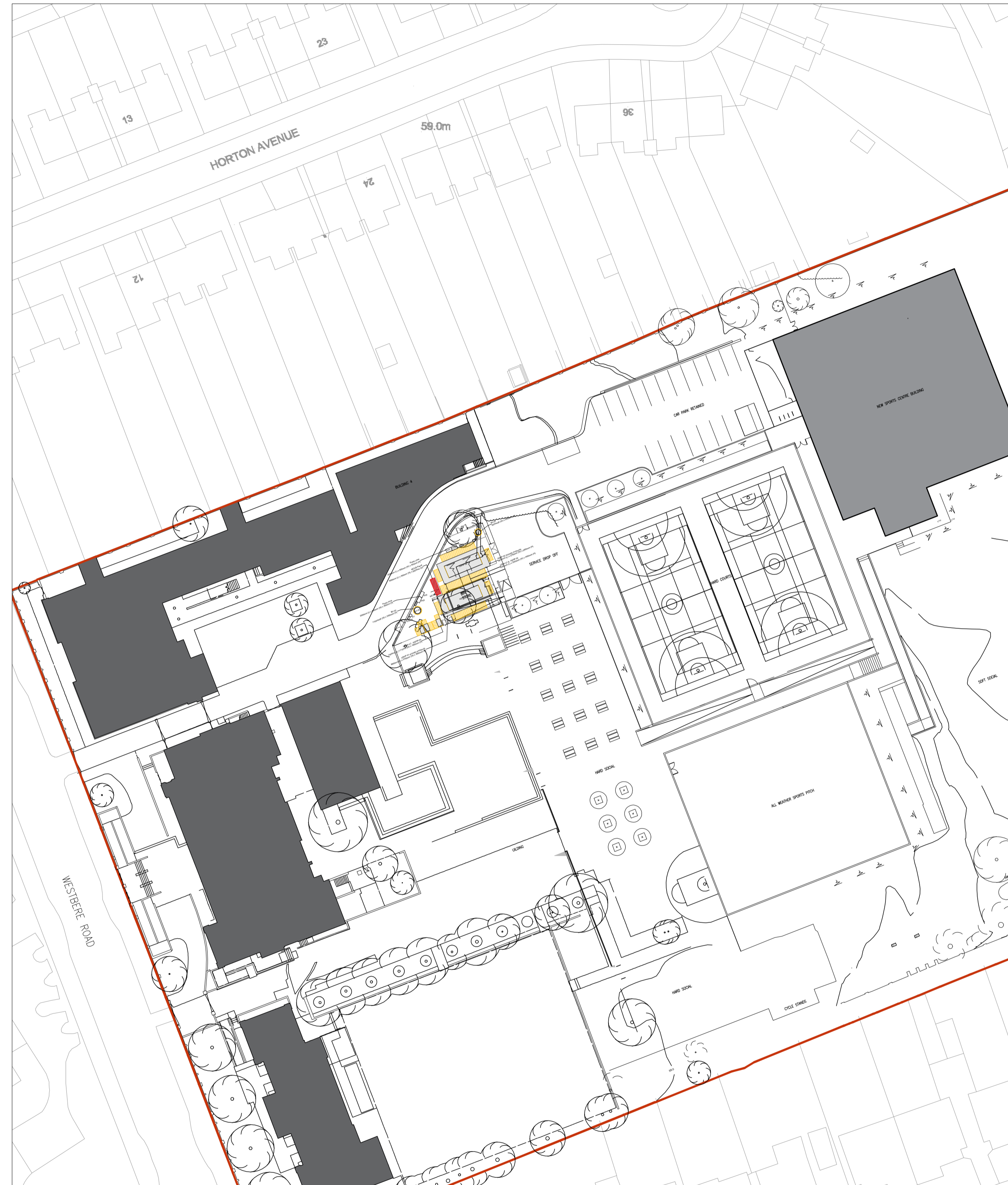

FIGURE 2: BLOCK PLAN  
SCALE 1:500

General Notes

1. Contractor to check all dimensions on site. Should any discrepancies be identified between the dimensions, and or details determined on site, and those shown on the relevant drawings, the architect shall be notified immediately, and his instructions obtained prior to the commencement of work.
2. The Contractor shall be responsible for the design and implementation of all temporary works, and the safety and stability of new works and adjacent structures during construction.
3. Where a product is specified to be obtained from a manufacturer supplier, the contractor shall install the product in accordance with the instructions supplied by the manufacturer.
4. Should there be any variation between the work specified on the drawings and the manufacturers instructions, the contractor shall refer the matter to the architect before proceeding.

**EN-PLAN**

PLANNING & ARCHITECTURE

No.	Revision/Issue	Date

Firm Name and Address  
 en-plan  
 missenden  
 back lane  
 bomere heath  
 nr shrewsbury  
 shropshire  
 sy4 3ph  
 tel: 07931 541 804

Project Name and Address  
 Hampstead School

Project  
 cl opud application  
 Date  
 07.11.2024  
 Scale  
 N/A

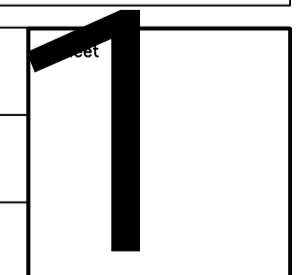
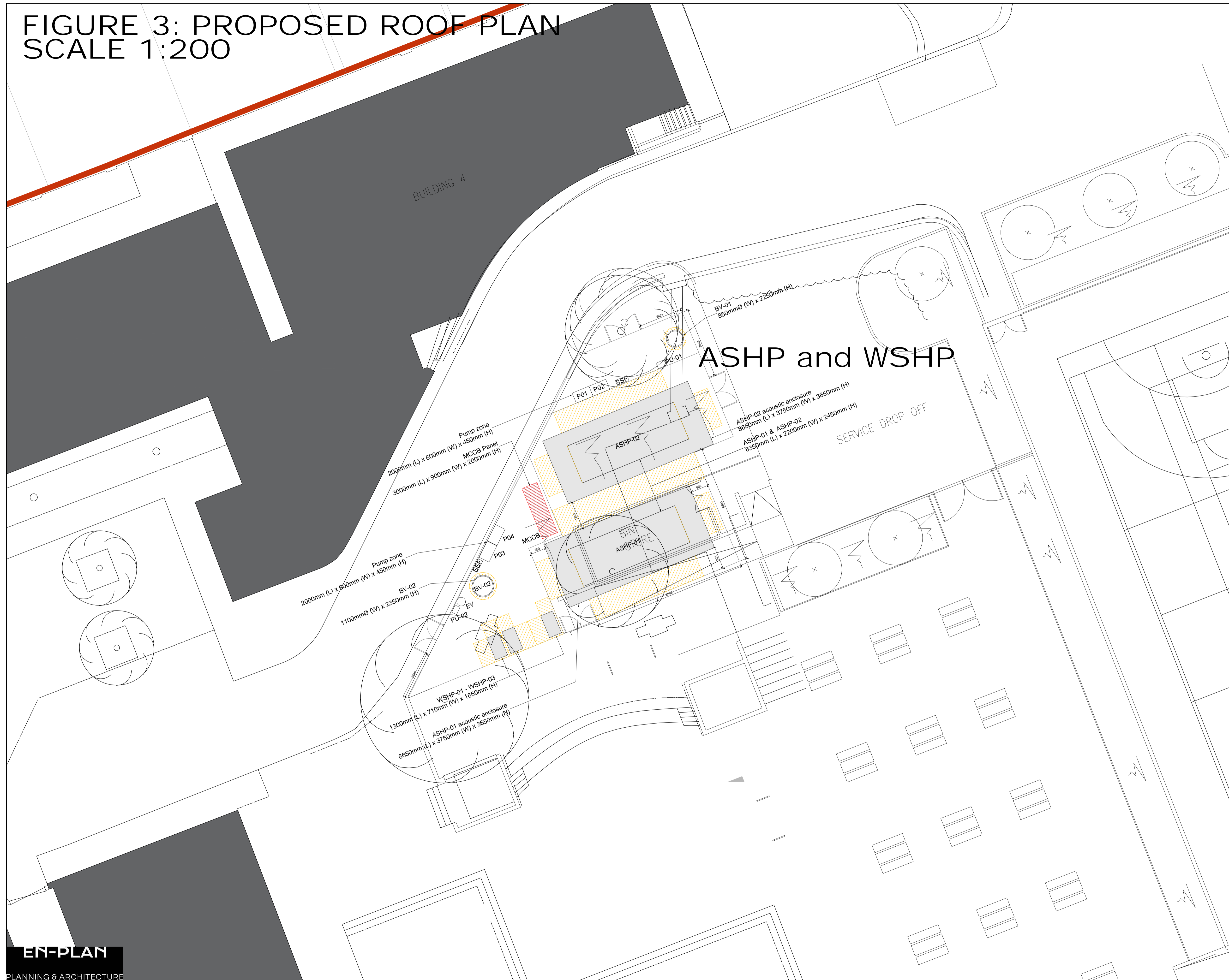



FIGURE 3: PROPOSED ROOF PLAN  
SCALE 1:200



General Notes

1. Contractor to check all dimensions on site. Should any discrepancies be identified between the dimensions, and or details determined on site, and those shown on the relevant drawings, the architect shall be notified immediately, and his instructions obtained prior to the commencement of work.
2. The Contractor shall be responsible for the design and implementation of all temporary works, and the safety and stability of new works and adjacent structures during construction.
3. Where a product is specified to be obtained from a manufacturer supplier, the contractor shall install the product in accordance with the instructions supplied by the manufacturer.
4. Should there be any variation between the work specified on the drawings and the manufacturers instructions, the contractor shall refer the matter to the architect before proceeding.

**EN-PLAN**  
PLANNING & ARCHITECTURE

No.	Revision/Issue	Date

Firm Name and Address  
**en-plan**  
 missenden  
 back lane  
 bomere heath  
 nr shrewsbury  
 shropshire  
 sy4 3ph  
 tel: 07931 541 804

Project Name and Address  
 Hampstead School

Project  
 cl opud appl ication  
 Date  
 21.05.2024  
 Scale  
 N/A

**2**



FIGURE 4: PROPOSED ASHP AND WSHP DETAIL  
SCALE 1:30

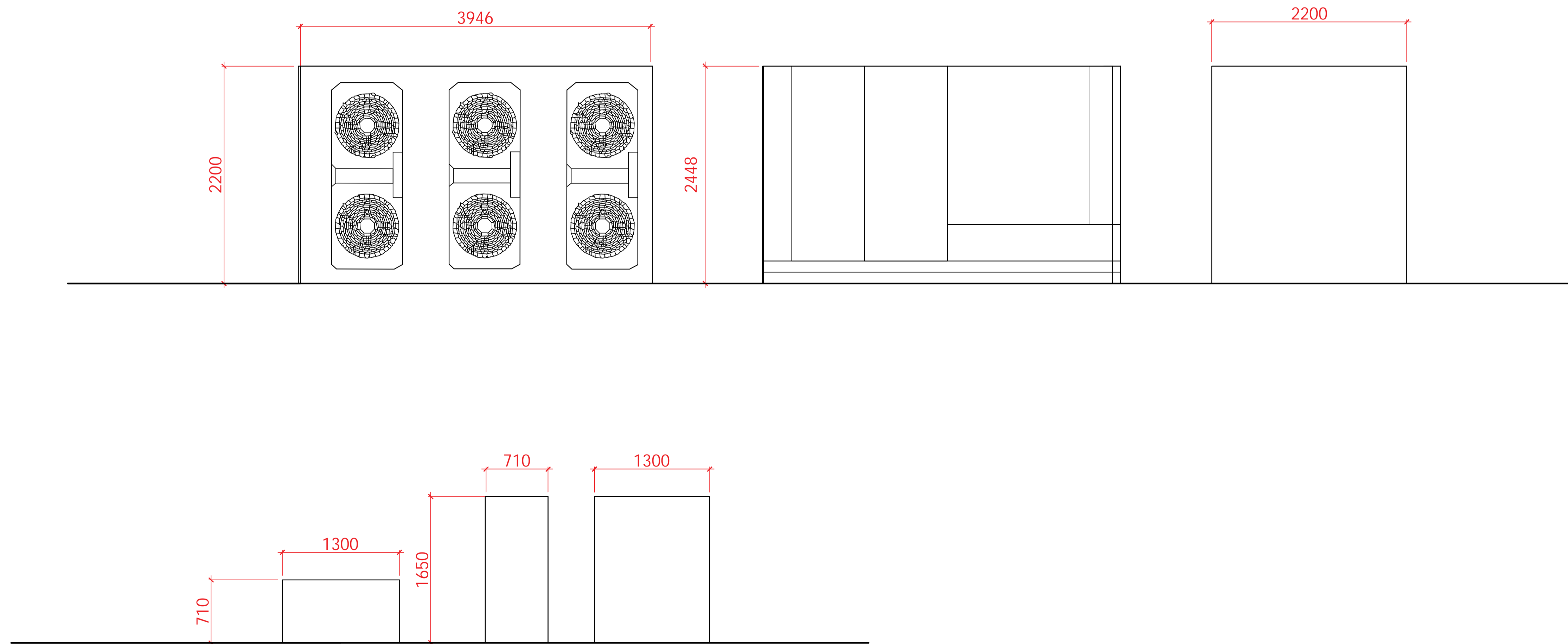

General Notes

1. Contractor to check all dimensions on site. Should any discrepancies be identified between the dimensions, and or details determined on site, and those shown on the relevant drawings, the architect shall be notified immediately, and his instructions obtained prior to the commencement of work.
2. The Contractor shall be responsible for the design and implementation of all temporary works, and the safety and stability of new works and adjacent structures during construction.
3. Where a product is specified to be obtained from a manufacturer supplier, the contractor shall install the product in accordance with the instructions supplied by the manufacturer.
4. Should there be any variation between the work specified on the drawings and the manufacturers instructions, the contractor shall refer the matter to the architect before proceeding.

EN-PLAN

PLANNING & ARCHITECTURE

No.	Revision/Issue	Date

Firm Name and Address  
en-plan  
missenden  
back lane  
bomere heath  
nr shrewsbury  
shropshire  
sy4 3ph  
tel: 07931 541 804

Project Name and Address  
Hampstead School

Project  
clouid application  
Date  
07.11.2024  
Scale  
N/A

3