

Note: No proposed works at South of Basement Level 2 B2

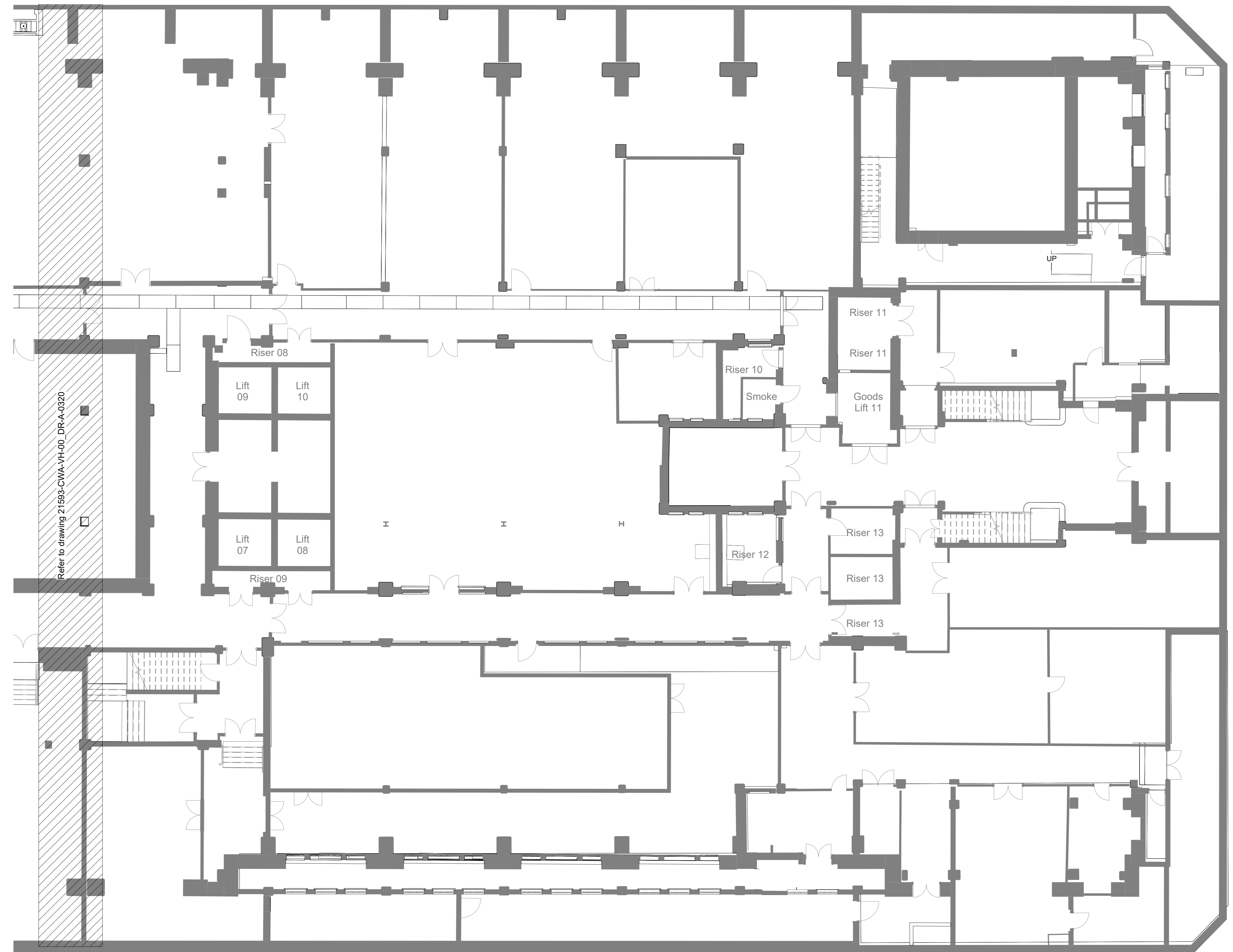

2 -02 Basement(02) - South
1 : 100

- Proposed Partition Locations
- - - Proposed flexible partition locations. (Minimum laboratory width = 3 meters)
- Drainage Positions - Proposed drainage penetrations in slab
- Ramps - Proposed 'illustrative' location of transition in level from slab to raised access floor. Location dependent on final tenant fit out.

Note
For all items being removed, please refer to demolition drawings 21569-0340 - 0556
Existing services in modernised areas to be altered, refer to services consultant drawings and reports for details.

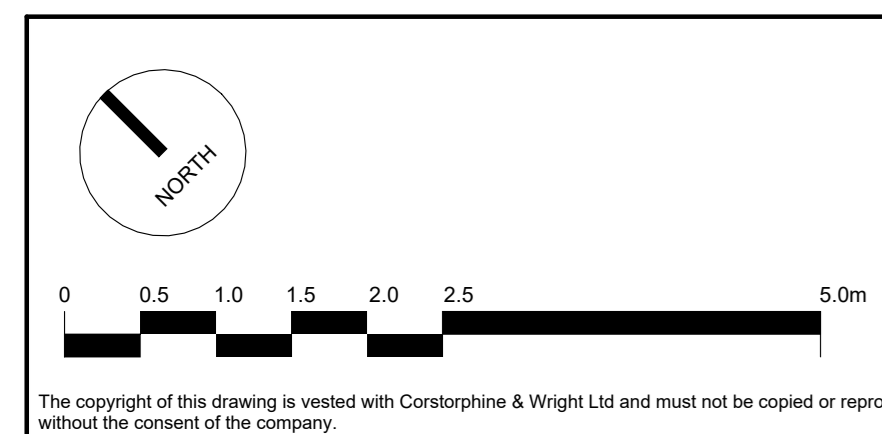

DIS: PLANNING REVISED
EP-00 FOR PLANNING
Rev: Description

26/09/2022 TI RS
01/07/2022 RS ATJ
Date Draw: CJK

Client:
Oxford Victoria House Ltd.

Project:
21593 - Victoria House
Drawing Title:
Proposed - Basement Level 2 (South)
Drawing Status:
CONSENTED

Corstorphine & Wright

London Studio
One Market Street, London, W1T 3JA
020 7463 0200

corstorphinewright.com

Drawing No:
21593-CWA-VH-00-DR-A-0321

Revision
P-01

Drawn: ATJ
Checked: RS
Paper Size: A0
Scale: 1 : 100

Date:
01/07/2022