

DO NOT SCALE FOR CONSTRUCTION PURPOSES.  
 THE CONTRACTOR IS TO CHECK AND VERIFY ALL BUILDING AND SITE DIMENSIONS, LEVELS AND SEWER INVERT LEVELS AT CONNECTION POINTS BEFORE WORK STARTS.  
 THIS DRAWING IS TO BE READ AND CHECKED IN CONJUNCTION WITH ENGINEERS AND OTHER SPECIALIST DRAWINGS.  
 THE DRAWING AND THE WORKS DEPICTED ARE THE COPYRIGHT OF PHILIP MEADOWCROFT ARCHITECTS LTD AND MAY NOT BE REPRODUCED EXCEPT BY WRITTEN PERMISSION.

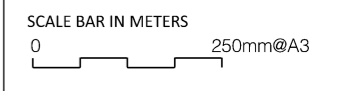

NOTES:  
 External Glazing System to be by Smart Aluminium. The entire external glazing system and interfaces including: watertightness, air permeability, weather sealing, thermal breaks, flashings, fascias, cover plates to be Contractors Design denoted by red box

- 1 Wall insulation: Rockwool Full Fill insulation 125mm thick. [M21/210]
- 2 Wall insulation: Rockwool Full Fill insulation 100mm thick or to suit. [M21/211]
- 3 Glass fibre insulation within encasement [M21/212]
- 4 Perforated ppc aluminium panels fixed in front opening window to allow secure ventilation of the ground floor space. Ppc perforated aluminium panel with thyme leaf motif matches the QE2 Centre.

G+0.02 ENTRANCE LOBBY

G+0.01 STORY STUDIO CAFE

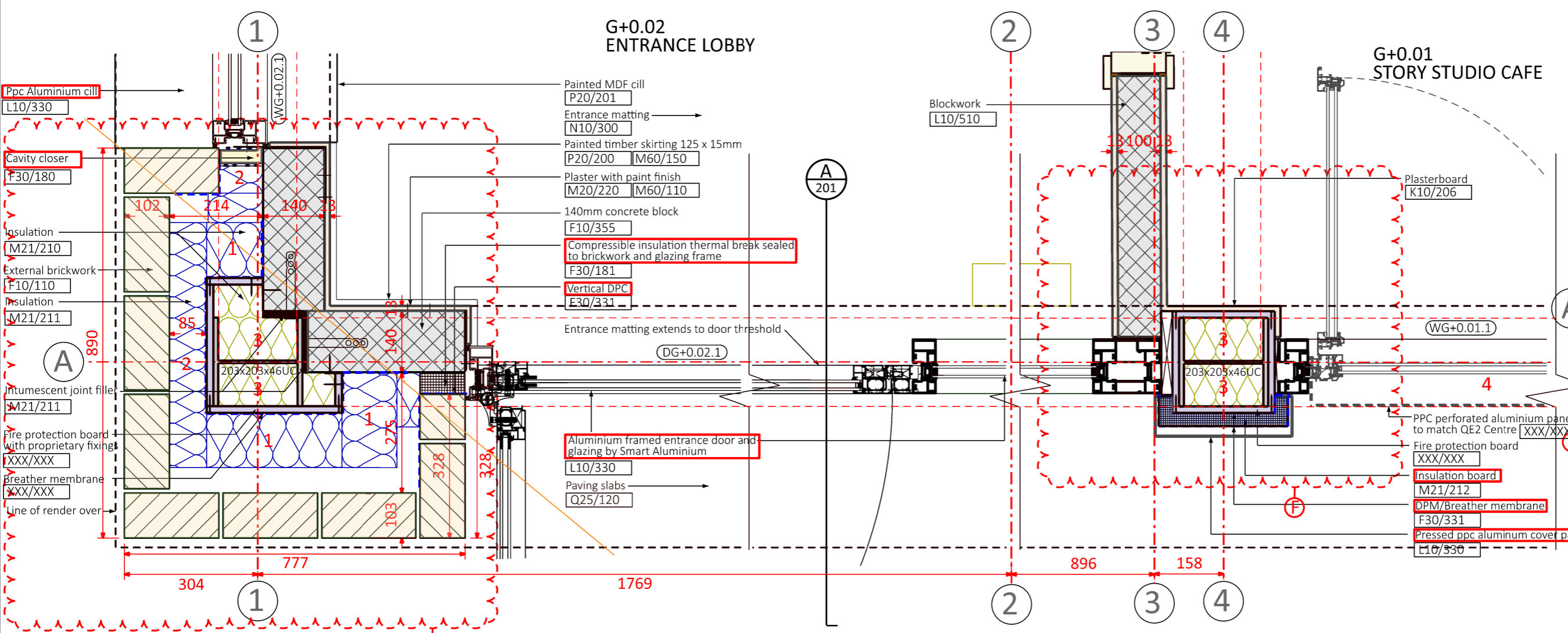

1 Plan Detail 1  
 1:10 @ A3

2 Plan Detail 2  
 1:10 @ A3

G+0.01 STORY STUDIO CAFE

+20.650 FFL

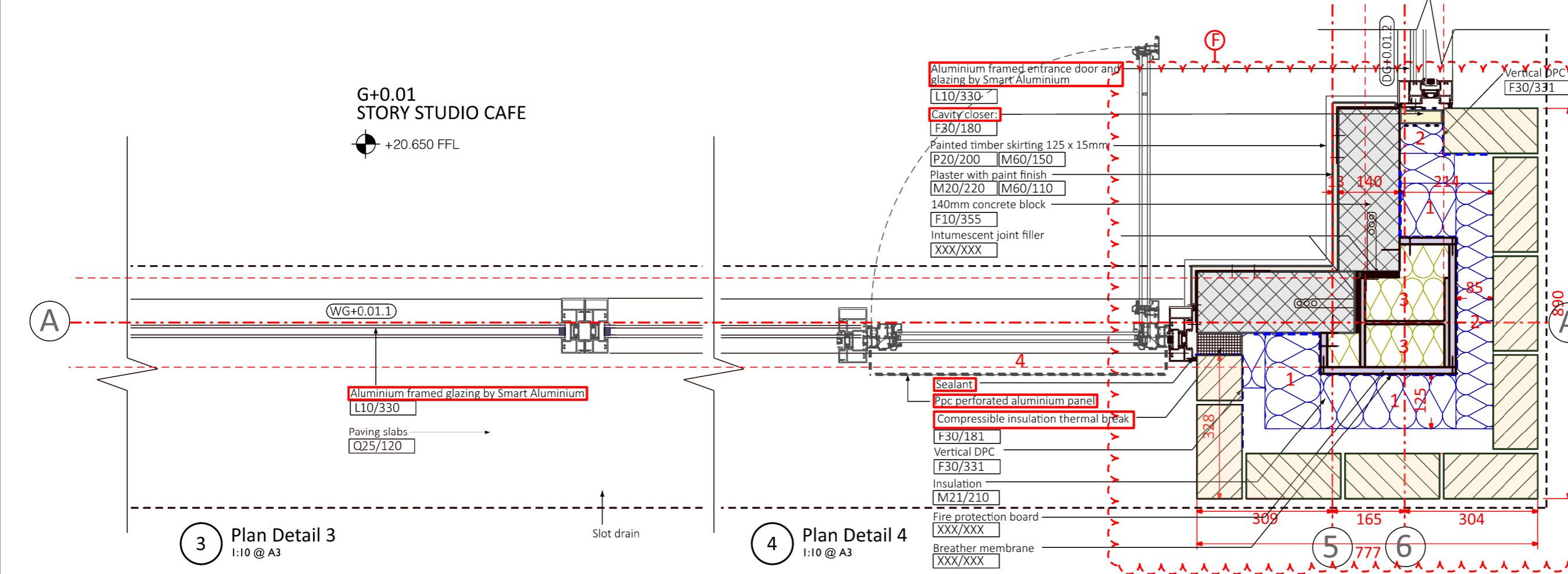

3 Plan Detail 3  
 1:10 @ A3

4 Plan Detail 4  
 1:10 @ A3

REV	DATE	DESCRIPTION
IF	25/11/24	Fire protection, notes
E	06/10/24	Dims and details adjusted
D	16/08/24	Construction Issue. Notes added details amended
C	02/07/24	Notes, spec refs, steel insulation omitted
B	31/05/24	Tender issue
A	09/05/24	Notes and details

PHILIP MEADOWCROFT ARCHITECTS  
 33 GREENWOOD PLACE  
 LONDON, NW5 1LB  
 +44 (0)207 693 8514  
 www.philipmeadowcroftarchitects.co.uk

JOB  
 CORAM GREGORY HOUSE

DRG  
 Proposed South-east facade.  
 Ground floor G+0  
 External Wall Details - Sheet 1

SCALE  
 1:5 @ A1  
 1:10 @ A3

DATE  
 10/05/2024

DRAWN BY  
 PM

CHECKED BY  
 PM

STATUS  
 TENDER

DRG NO  
 2110-P1-400 F

REV