

Mix sized recycled stone with staggered bond. Spaced evenly and neatly with minimum joint of 5mm and maximum 15mm. Overall width including mortar is 320mm wide. Joints filled with lime mortar. Note: Any stone with rough edge or corner avoid using to prevent trip hazard. Replace with new smooth stones laid evenly for wheelchair access areas.

- 240 x 160 x 85 mm (Type 1)
- 290 x 165 x 82 mm (Type 2)
- 150 x 145 x 85 mm (Type 3)
- 270 x 142 x 85 mm (Type 4)
- 225 x 135 x 83 mm (Type 5)

1 001 E1: PAVING EDGE BORDER RECYCLED STONE PLAN SCALE 1:20

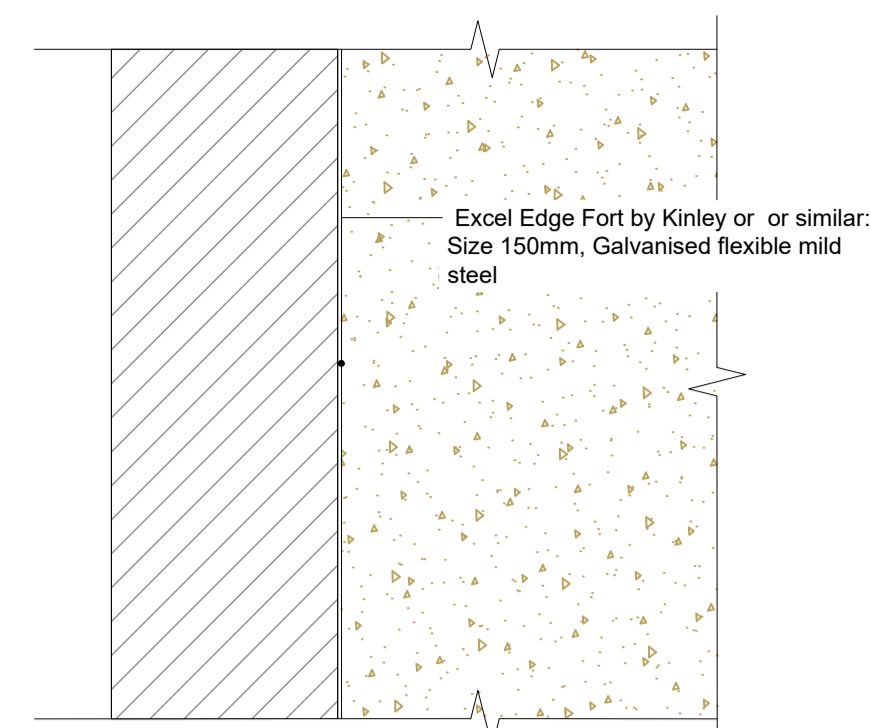

Excel Edge Fort by Kinley or similar. Size 150mm, Galvanised flexible mild steel

3 001 E2: METAL EDGE PLAN SCALE 1:20

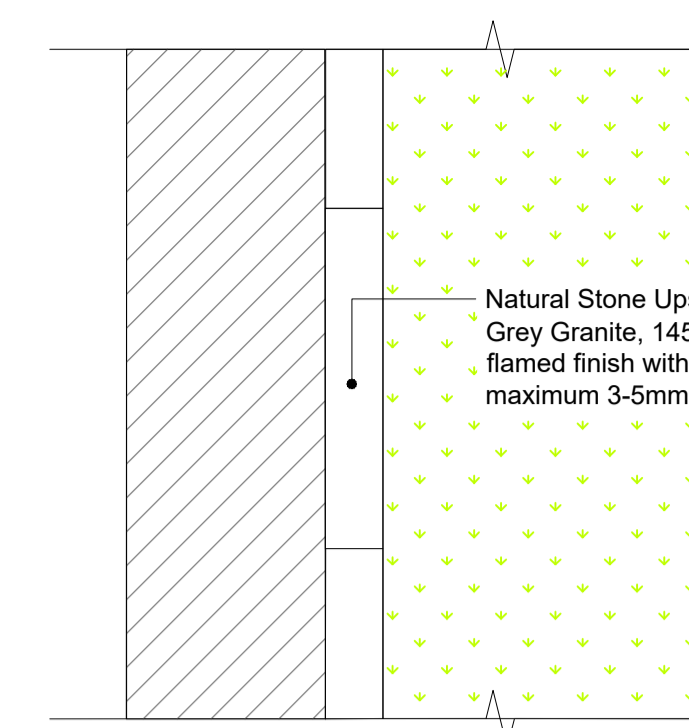

Natural Stone Upstand Kerb: Grey Granite, 145x250x900mm, flamed finish with sawn finish to joint, chamfered top edge, maximum 3-5mm wide laid

5 001 E3: 145MM WIDE UPSTAND NATURAL STONE KERB PLAN SCALE 1:20

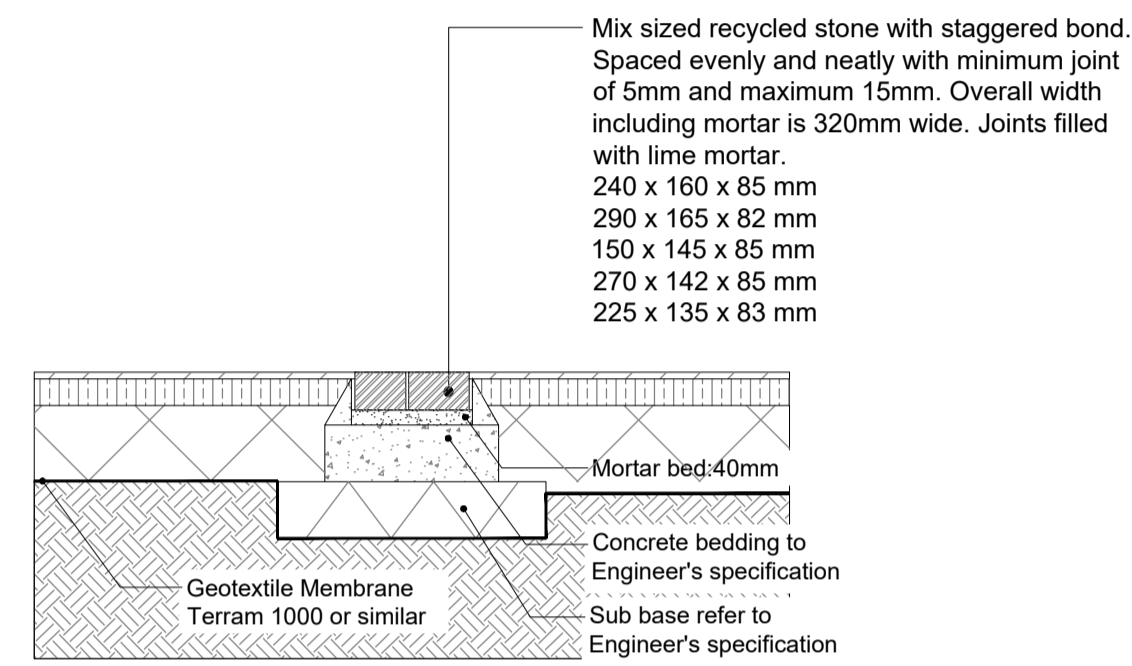

Mix sized recycled stone with staggered bond. Spaced evenly and neatly with minimum joint of 5mm and maximum 15mm. Overall width including mortar is 320mm wide. Joints filled with lime mortar.

- 240 x 160 x 85 mm
- 290 x 165 x 82 mm
- 150 x 145 x 85 mm
- 270 x 142 x 85 mm
- 225 x 135 x 83 mm

2 001 E1: PAVING EDGE BORDER RECYCLED STONE SECTION SCALE 1:20

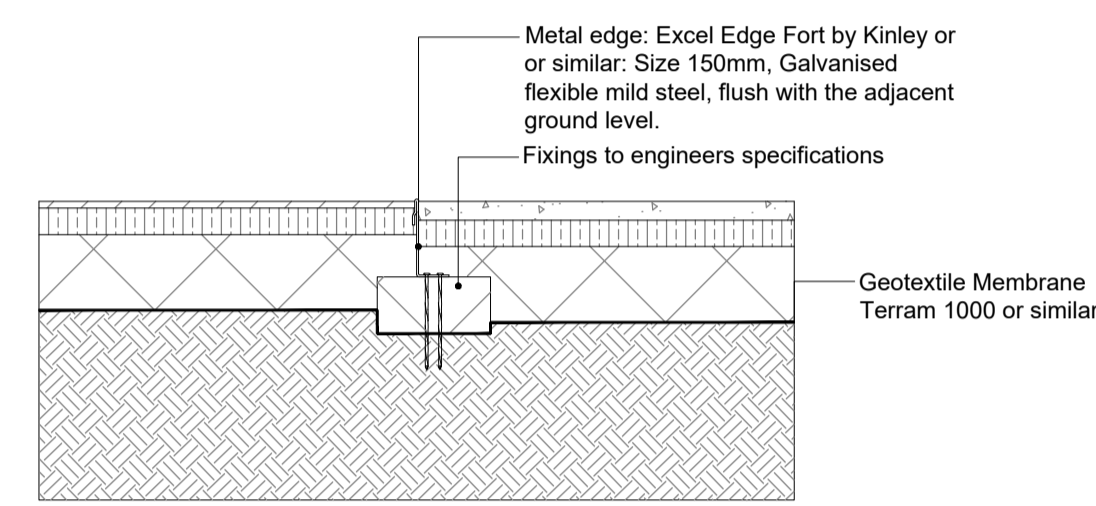

Metal edge: Excel Edge Fort by Kinley or similar. Size 150mm, Galvanised flexible mild steel, flush with the adjacent ground level. Fixings to engineers specifications

4 001 E2: METAL EDGE - FLUSH SECTION SCALE 1:20

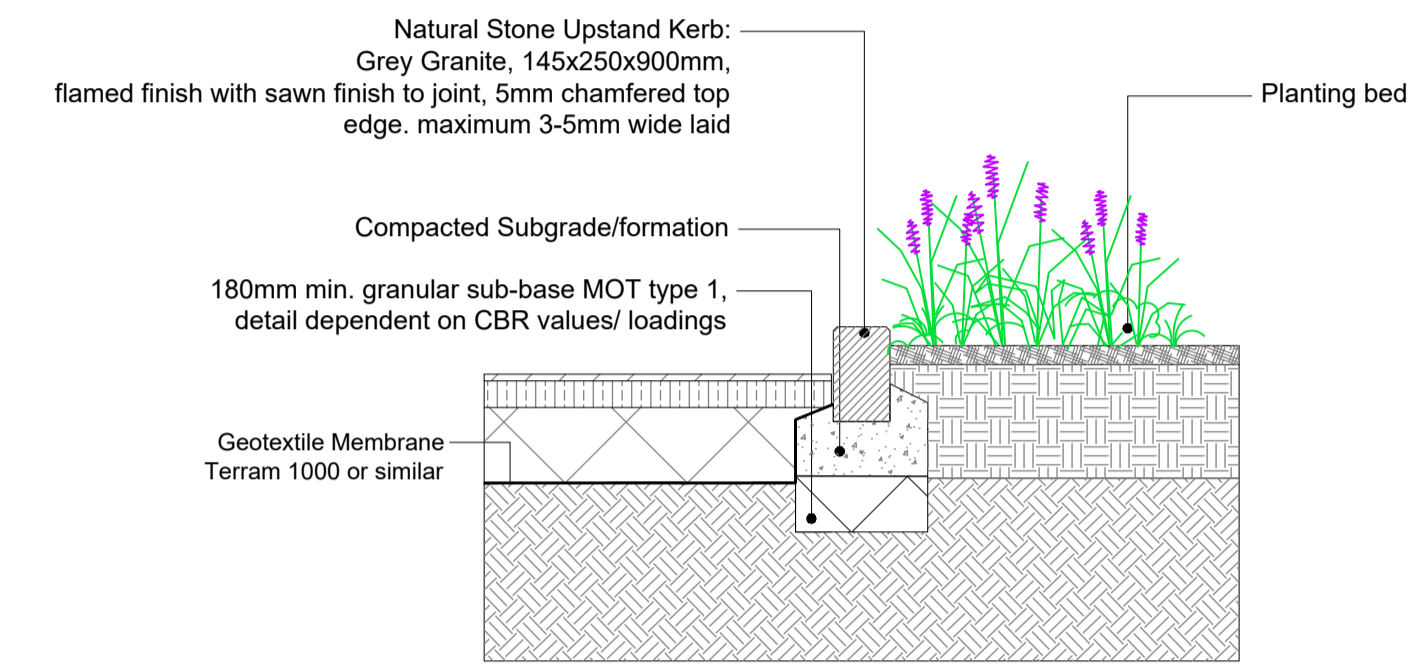

Natural Stone Upstand Kerb: Grey Granite, 145x250x900mm, flamed finish with sawn finish to joint, 5mm chamfered top edge, maximum 3-5mm wide laid

Planting bed  
Compacted Subgrade/formation  
180mm min. granular sub-base MOT type 1, detail dependent on CBR values/ loadings

6 001 E3: 145MM WIDE UPSTAND NATURAL STONE KERB SECTION SCALE 1:20

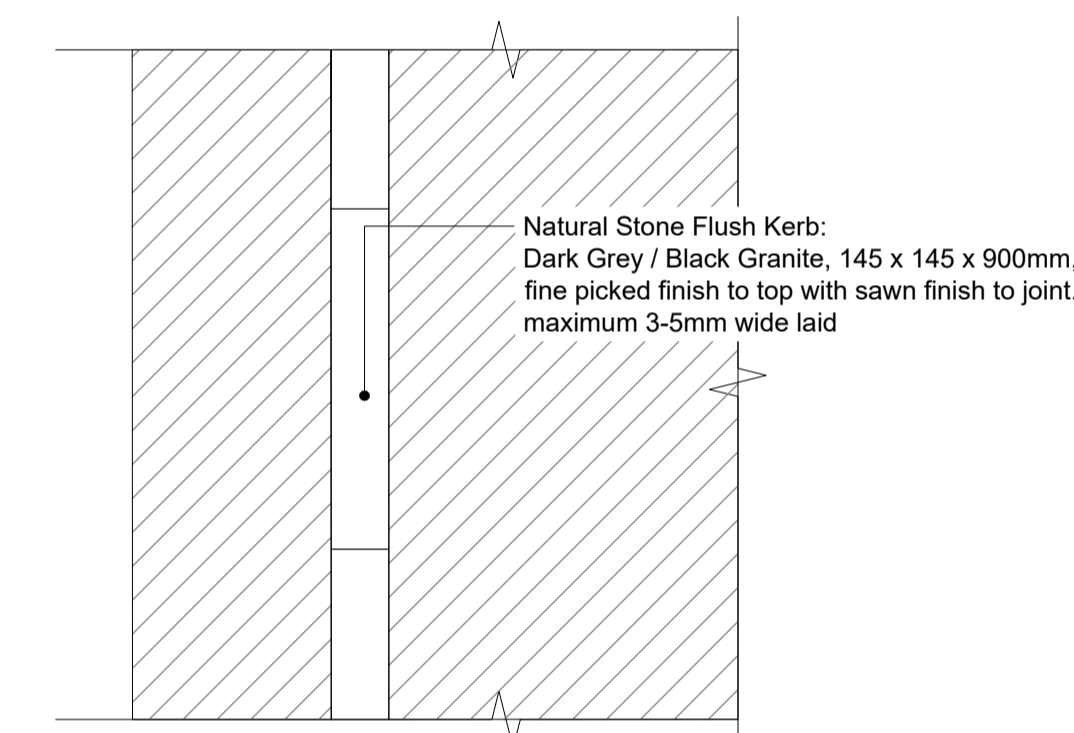

Natural Stone Flush Kerb: Dark Grey / Black Granite, 145 x 145 x 900mm, fine picked finish to top with sawn finish to joint, maximum 3-5mm wide laid

7 001 E4: 145MM WIDE NATURAL STONE FLUSH KERB PLAN SCALE 1:20

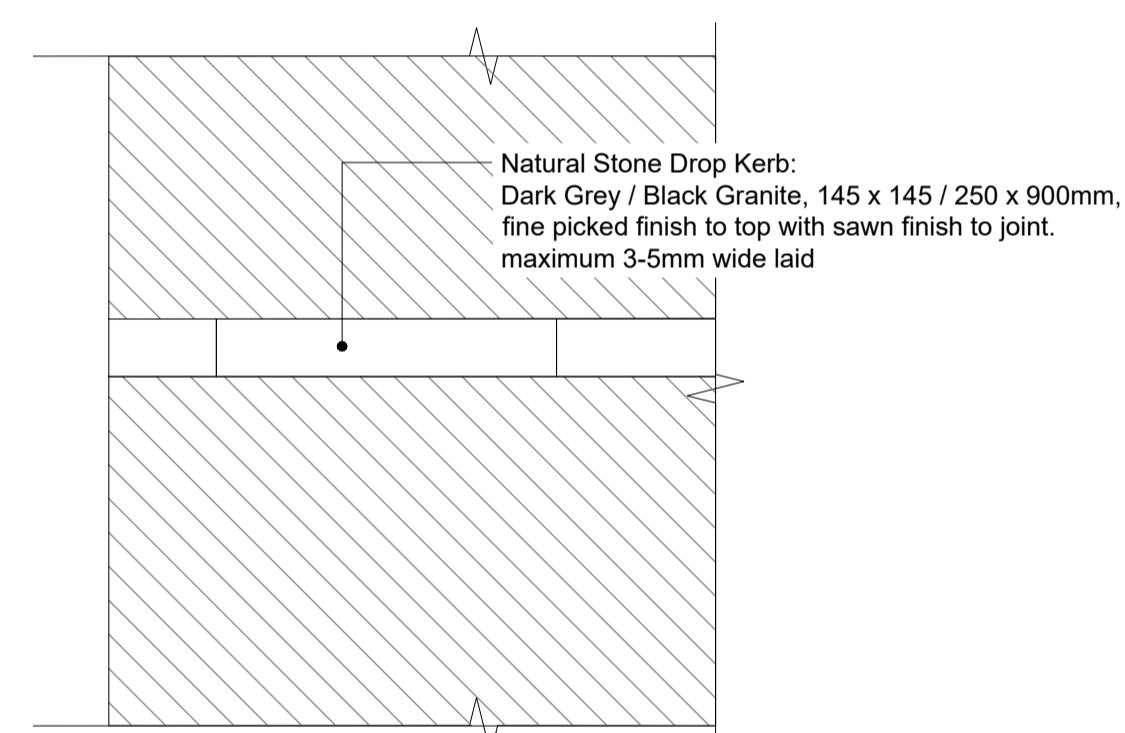

Natural Stone Drop Kerb: Dark Grey / Black Granite, 145 x 145 / 250 x 900mm, fine picked finish to top with sawn finish to joint, maximum 3-5mm wide laid

9 001 E5: 145MM WIDE NATURAL STONE DROP KERB PLAN SCALE 1:20

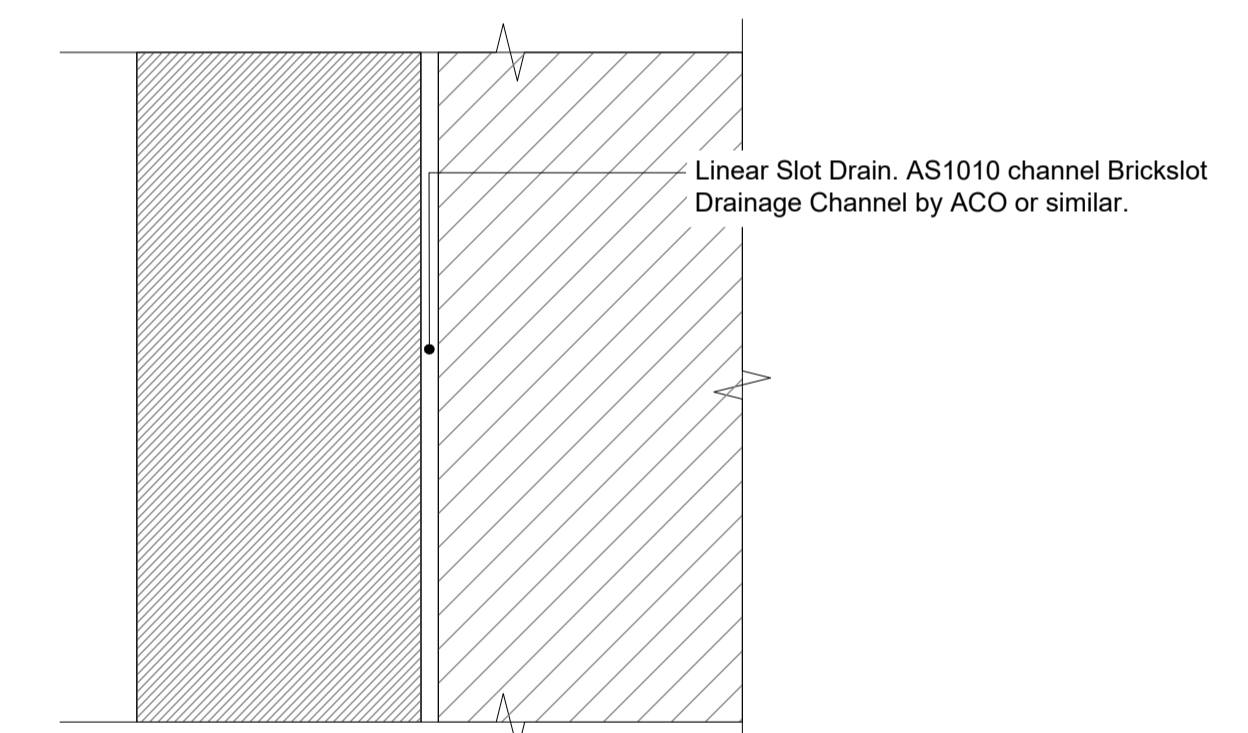

Linear Slot Drain. AS1010 channel Brickslot Drainage Channel by ACO or similar.

11 001 D1: LINEAR DRAIN ACO MULTIDRAIN PLAN SCALE 1:20

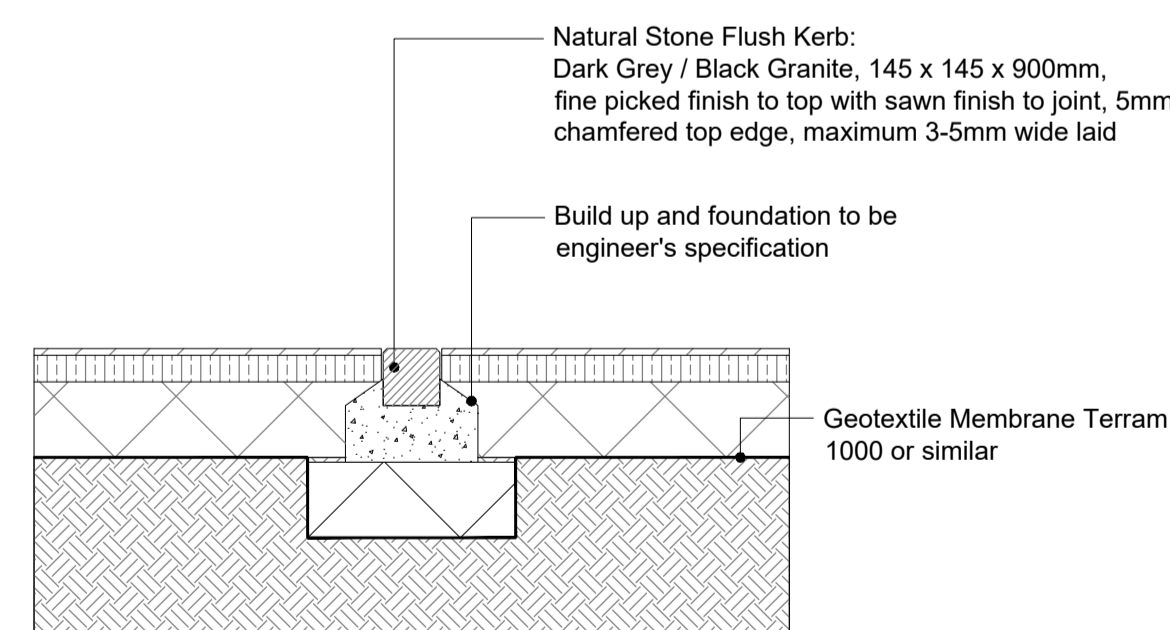

Natural Stone Flush Kerb: Dark Grey / Black Granite, 145 x 145 x 900mm, fine picked finish to top with sawn finish to joint, 5mm chamfered top edge, maximum 3-5mm wide laid

Build up and foundation to be engineer's specification

Geotextile Membrane Terram 1000 or similar

8 001 E4: 145MM WIDE NATURAL STONE FLUSH KERB SECTION SCALE 1:20

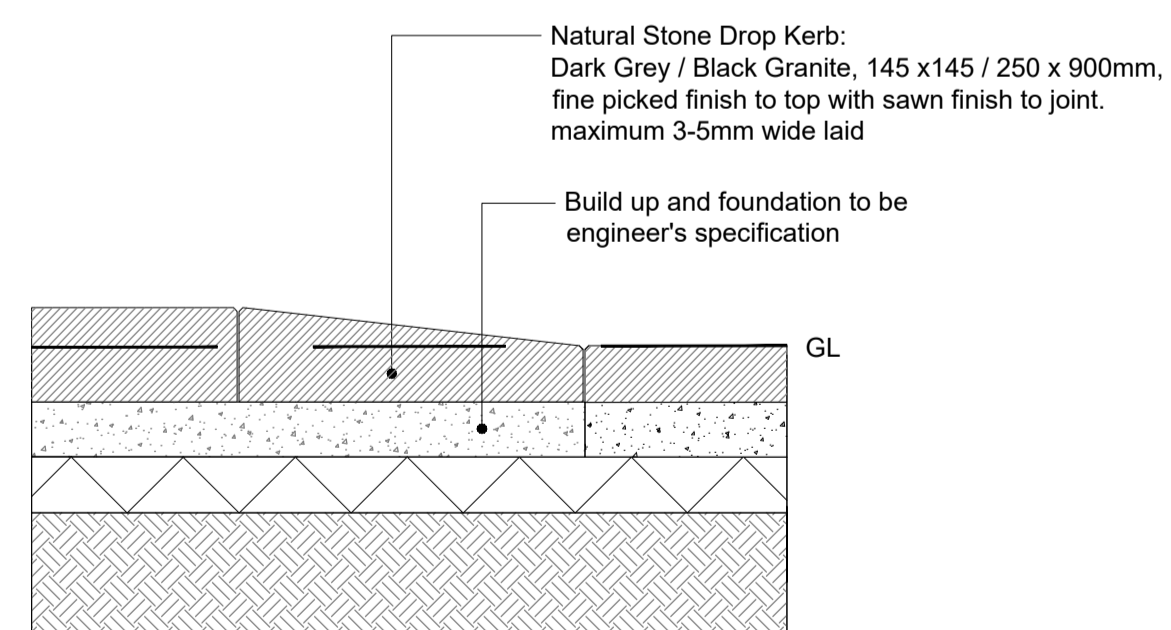

Natural Stone Drop Kerb: Dark Grey / Black Granite, 145 x 145 / 250 x 900mm, fine picked finish to top with sawn finish to joint, maximum 3-5mm wide laid

Build up and foundation to be engineer's specification

GL

10 001 E5: 145MM WIDE NATURAL STONE DROP KERB SECTION SCALE 1:20

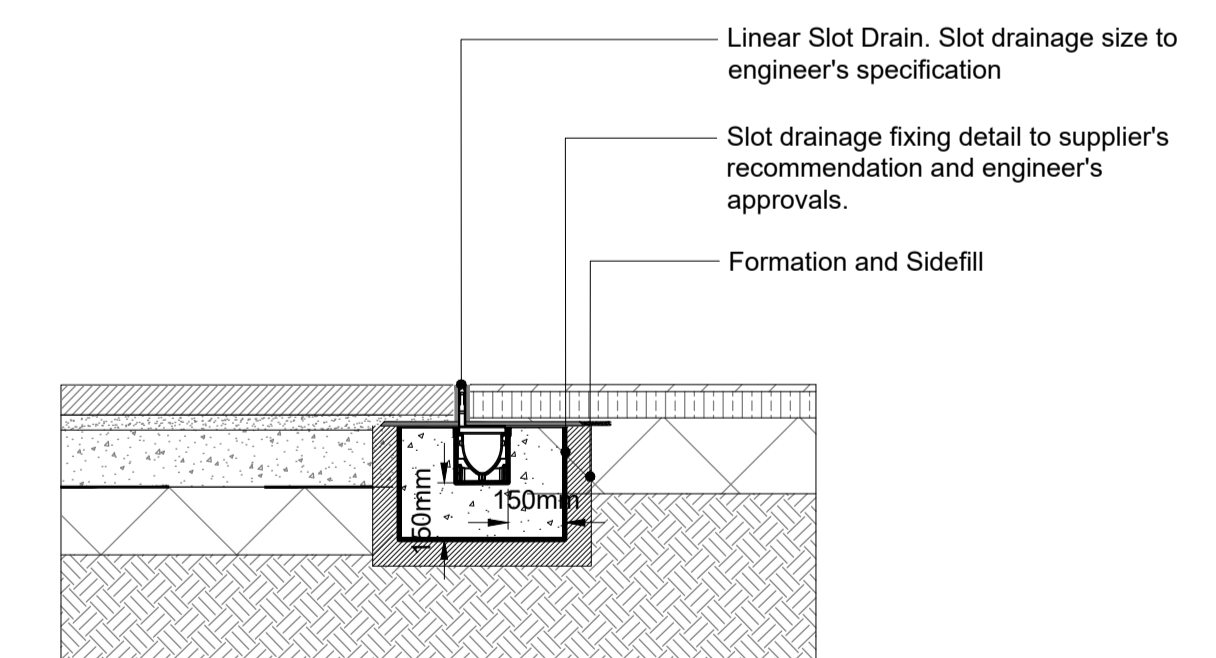

Linear Slot Drain. Slot drainage size to engineer's specification

Slot drainage fixing detail to supplier's recommendation and engineer's approvals.

Formation and Sidefill

12 001 D1: LINEAR DRAIN ACO MULTIDRAIN SECTION SCALE 1:20

Rev	Description	Drawn	Checked	Approved	Con Acc	Scale with caution as distortion can occur.
C01	First Submission	MP	KM	DW		HS2 accepts no responsibility for any circumstances which arise from the reproduction of this document after alteration, amendment or abbreviation or if it is issued in part or issued incompletely in any way.
C02	Stage 4 Submission	MP	KM	DW		© Crown Copyright and database right 2020. All rights reserved. Ordnance Survey Licence number 100049190
C03	Stage 4 Design Update	MP	KM	DW		© Crown Copyright material is reproduced with the permission of Land Registry under delegated authority from the Controller of HMSO. This material was last updated on 2020 and may not be copied, distributed, sold or published without the formal permission of Land Registry. Only an official copy of a title plan or register obtained from the Land Registry may be used for legal or other official purposes.

- Legends/Notes:
- This drawing to be read in conjunction with GA drawings 1CP01-MDS\_LDE-LS-DGA-SS08\_SL23\_GF-000003 and Landscape Specification 1CP01-MDS\_LDE-LS-SPE-SS08\_SL23\_GF-000001.
  - Do not scale from drawing, use figured dimensions only and all dimensions to be checked onsite.
  - Build up details refer to the Engineer's detail drawing 1CP01-MDS\_FBM-ST-DDE-SS08\_SL23-000021.
  - Please note the above details are suggested details for tender only, the final base designs are currently by others.

# HS2

Registered in England  
Registration No. 06791686  
Registered office:  
2 Snow Hill, Queensway,  
Birmingham, B4 6GA

Official

Stage	Project/Contract	Creator/Originator	Sub Originator	
4	1CP01	MDS	LDA DESIGN	
Drawing Title	Work Package Description	Discipline/Function	System description	
SS08	SL23	LS	DDE	
Drawing Title	Drawn by	Checked by	Approved by	Date
Kerb and Edge Details	MP	KM	DW	28/03/24
Scale	Size	Suitability	Rev.	
1:20	A1	S6	C03	
Drawing No.	1CP01-MDS_LDE-LS-DDE-SS08_SL23_GF-000001			