

All dimensions to be checked on site; Figured dimensions to be read in preference to scaled.

Brock Carmichael accepts no responsibility for and does not permit any unauthorised amendments to or reproduction of the drawing. This drawing and associated copyright remains the property of Brock Carmichael unless otherwise agreed.

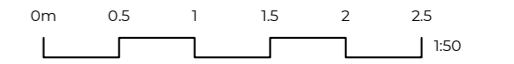

Date	Revision	Initials	Notes
19.04.24	S1 P1	JDW	PRELIMINARY PLANNING ISSUE
19.08.24	S1 P2	JDW	GROUND FLOOR LEVEL UPDATED TO TAKE ACCOUNT OF HISTORIC FLOODING LEVELS

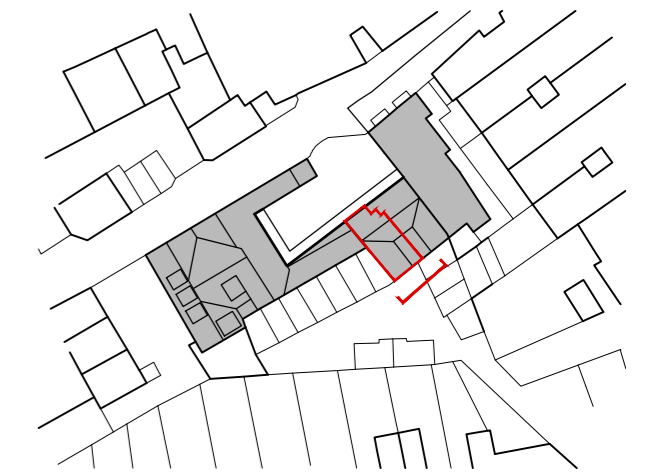

Existing & Proposed Rear Elevation
1:50@A2



Brock Carmichael
19 Old Hall Street
Liverpool, L3 9JQ
brockcarmichael.co.uk
+44 (0) 151 242 6222

PLANNING

Client: Natasha Orchant
BCA Project Ref: 23 033 2 Salmon Mews
Drawing Title: Existing and Proposed Rear Elevation
Drawing Reference: 23033-BCA-XX-XX-DR-A-05002

Drawn By: JDW
Checked By: CB
Date: 19 04 24
Status: S1
Revision: P2
Scale: A2
1:50