

- 1. **silencer** of fresh air in system providing the minimum insertion loss values outlined in Table 6.1 of noise assessment report.
  - 2. **Acoustic MPC450EC Supply Air Fan**
  - 3. air in riser leading to duct work into ground floor ventilation system at ceiling level
  - 4. cold room condensers:  
1101x444x662mm (4-1)  
**on basement court yard ground level**  
876x430x606mm (4-2)  
**mounted on rear wall by anti-vibration brakets**
  - 5. **Silent Louvre (acoustic enclosure)**
  - 6. flat roof
  - 7. air in duct work leading to basement area
  - 8. internal extraction system for ground floor on high level leading to outlet on rear external wall
- flat roof of single storey extension on basement level; new plants to be installed on top of flat roof with acoustic louver panels enclosure subject to acoustic surveyor's details
- 2 nos of new A/C outdoor units (below) pile up on wall and supported by anti-vibration brakets
- Ventilation system details refer to M&E plans 1554 - 1 & 1554 - 2

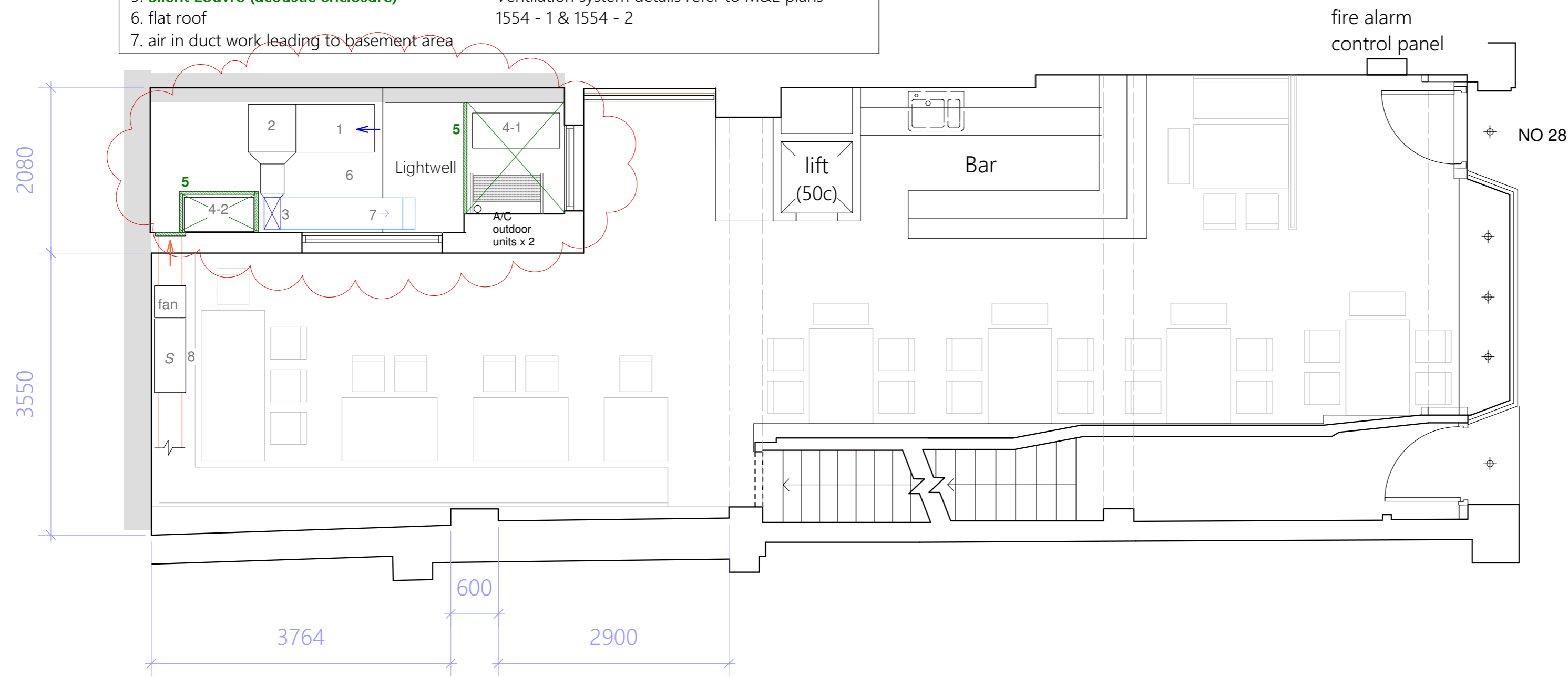

DISCLAIMER:  
ALL DIMENSIONS SUBJECT  
TO MEASUREMENTS ON SITE.  
CONTRACTORS TO INFORM  
OF ANY MAJOR  
DISCREPANCIES.

**NEW IMAGE DESIGN**  
2A Tiverton Road  
London N18 1DW  
Tel: 02083456883

Project Site:  
28 Store Street,  
Fitzovia, WC1E 7BS

Client:  
HeySun Ltd

Drawing Title:  
Proposed GF Plan

Drawing No.:  
634(a)/PL/04

Date: May/2024	Scale: 1:50 @ A2	Rev: B
-------------------	---------------------	-----------